

RECEIVED

NEW MEXICO OIL CONSERVATION COMMISSION

MAY 11 1972

O. C. C.
ARTESIA, OFFICE

Form C-101
Revised 1-1-65

30-005-60216

NO. OF COPIES RECEIVED	6
DISTRIBUTION	
SANTA FE	1
FILE	1
U.S.G.S.	2
LAND OFFICE	1
OPERATOR	1

5A. Indicate Type of Lease	
STATE <input checked="" type="checkbox"/>	FEE <input type="checkbox"/>
5. State Oil & Gas Lease No.	
K-6428-1	

APPLICATION FOR PERMIT TO DRILL, DEEPEN, OR PLUG BACK

1a. Type of Work			7. Unit Agreement Name		
b. Type of Well DRILL <input checked="" type="checkbox"/> DEEPEN <input type="checkbox"/> PLUG BACK <input type="checkbox"/> OIL WELL <input type="checkbox"/> GAS WELL <input checked="" type="checkbox"/> OTHER <input type="checkbox"/> SINGLE ZONE <input checked="" type="checkbox"/> MULTIPLE ZONE <input type="checkbox"/>			8. Farm or Lease Name		
2. Name of Operator Mountain States Petroleum Corporation			9. Well No. 1		
3. Address of Operator P. O. Box 1936 Roswell, New Mexico 88201			10. Field and Pool, or Wildcat Wildcat		
4. Location of Well UNIT LETTER F LOCATED 1980 FEET FROM THE North LINE AND 1980 FEET FROM THE West LINE OF SEC. 20 TWP. 4 S RGE. 27 E NMPM			12. County Chaves		
19. Proposed Depth 6500			19A. Formation Miss.		20. Rotary or C.T. Rotary
21. Elevations (Show whether DF, RT, etc.)		21A. Kind & Status Plug. Bond Blanket	21B. Drilling Contractor WEK Drilling Co.		22. Approx. Date Work will start 5-15-72

23.

PROPOSED CASING AND CEMENT PROGRAM

SIZE OF HOLE	SIZE OF CASING	WEIGHT PER FOOT	SETTING DEPTH	SACKS OF CEMENT	EST. TOP
17 1/2	13 3/8	48	35	2 cu.yds.	circ
12 1/4 - 11	8 5/8	24	1200	350	circ
7 7/8	4 1/2	9.5-10.5-13.5	6500	200	-

APPROVAL VALID
FOR 90 DAYS UNLESS
DRILLING COMMENCED,
EXPIRES 8-15-72

IN ABOVE SPACE DESCRIBE PROPOSED PROGRAM: IF PROPOSAL IS TO DEEPEN OR PLUG BACK, GIVE DATA ON PRESENT PRODUCTIVE ZONE AND PROPOSED NEW PRODUCTIVE ZONE. GIVE BLOWOUT PREVENTER PROGRAM, IF ANY.

I hereby certify that the information above is true and complete to the best of my knowledge and belief.

Signed W. A. Gressett Title Engineer Date 5-10-72
(This space for State Use)

APPROVED BY W. A. Gressett TITLE OIL AND GAS INSPECTOR DATE MAY 15 1972

CONDITIONS OF APPROVAL, IF ANY:

adequate blowout preventer be used;

Cement must be circulated to
surface behind 8.5/8" casing

NEW MEXICO OIL CONSERVATION COMMISSION
WELL LOCATION AND ACREAGE DEDICATION PLAT

MAY 11 1972

Form C-102
Supersedes C-128
Effective 1-1-65

All distances must be from the outer boundaries of the Section.

G. C. C.

Operator Mountain States Petroleum Corp.		Lease State		ARTESIA, OFFICE		Well No. 1
Unit Letter F	Section 20	Township 4 S	Range 27 E	County Chaves		
Actual Footage Location of Well: 1980 feet from the North line and 1980 feet from the West line						
Ground Level Elev.	Producing Formation Miss		Pool Wildcat		Dedicated Acreage: 320 Acres	

1. Outline the acreage dedicated to the subject well by colored pencil or hachure marks on the plat below.
2. If more than one lease is dedicated to the well, outline each and identify the ownership thereof (both as to working interest and royalty).
3. If more than one lease of different ownership is dedicated to the well, have the interests of all owners been consolidated by communitization, unitization, force-pooling, etc?

☐ Yes ☒ No If answer is "yes," type of consolidation Will be communitized if productive

If answer is "no," list the owners and tract descriptions which have actually been consolidated. (Use reverse side of this form if necessary.)

No allowable will be assigned to the well until all interests have been consolidated (by communitization, unitization, forced-pooling, or otherwise) or until a non-standard unit, eliminating such interests, has been approved by the Commission.

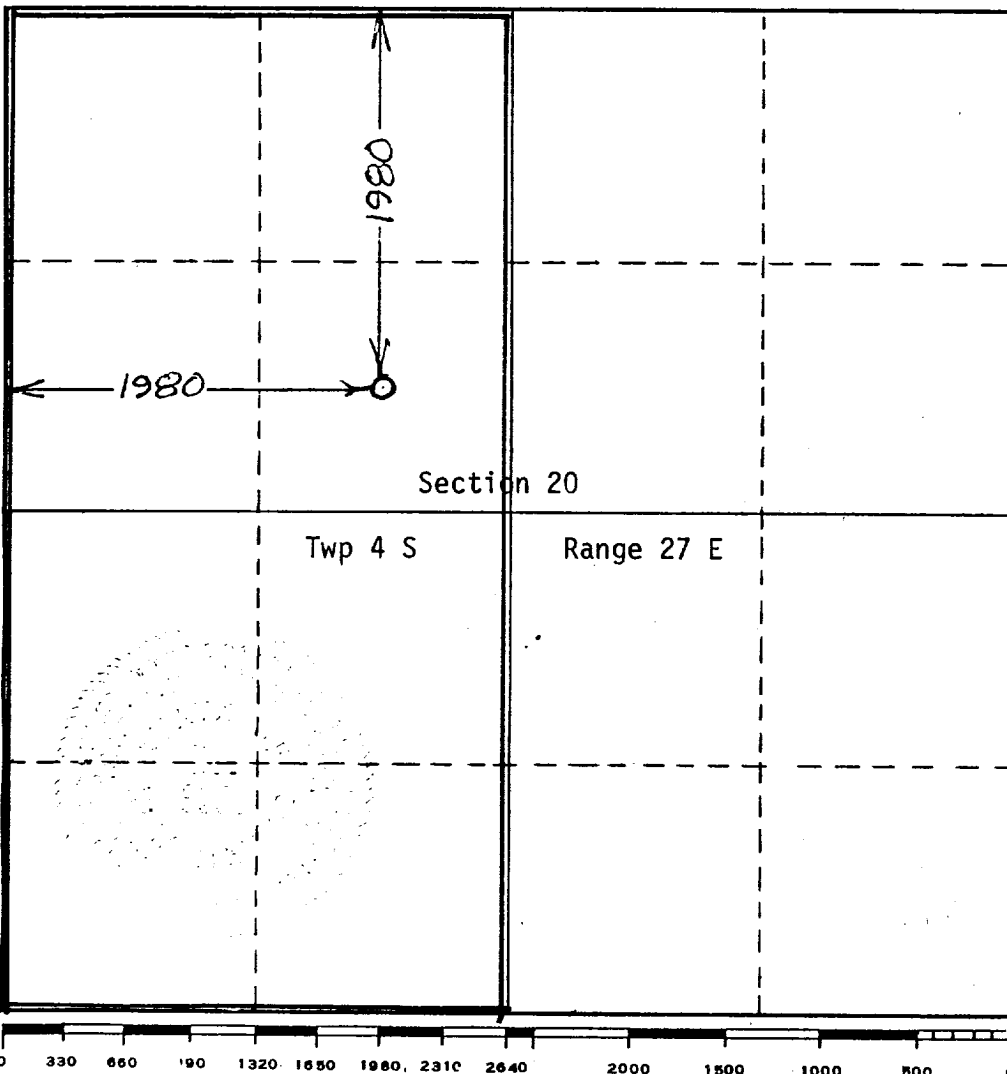

CERTIFICATION

I hereby certify that the information contained herein is true and complete to the best of my knowledge and belief.

KC Haver

Name

GEOLOGIST

Position

Company

MOUNTAIN STATES

Date

5-10-72

I hereby certify that the well location shown on this plat was plotted from field notes of actual surveys made by me or under my supervision, and that the same is true and correct to the best of my knowledge and belief.

C. B. Anderson

Date Surveyed

5-10-72

Registered Professional Engineer
and/or Land Surveyor

3650

Certificate No.

RECEIVED

NEW MEXICO OIL CONSERVATION COMMISSION
WELL LOCATION AND ACREAGE DEDICATION PLAT

Form C-102
Supersedes C-128
Effective 1-1-65

MAY 15 1972

All distances must be from the outer boundaries of the Section.

Operator Mountain States Petroleum Corp.		Lease State		Well No. 1	
Unit Letter F	Section 20	Township 4 S	Range 27 E	County Chaves	
Actual Footage Location of Well: 1980 feet from the North line and 1980 feet from the West line					
Ground Level Elev.	Producing Formation Miss	Pool Wildcat	Dedicated Acreage: 320 Acres		

1. Outline the acreage dedicated to the subject well by colored pencil or hatchure marks on the plat below.
2. If more than one lease is dedicated to the well, outline each and identify the ownership thereof (both as to working interest and royalty).
3. If more than one lease of different ownership is dedicated to the well, have the interests of all owners been consolidated by communitization, unitization, force-pooling, etc?

☐ Yes ☒ No If answer is "yes," type of consolidation Will be communitized if productive

If answer is "no," list the owners and tract descriptions which have actually been consolidated. (Use reverse side of this form if necessary.)

No allowable will be assigned to the well until all interests have been consolidated (by communitization, unitization, forced-pooling, or otherwise) or until a non-standard unit, eliminating such interests, has been approved by the Commission.

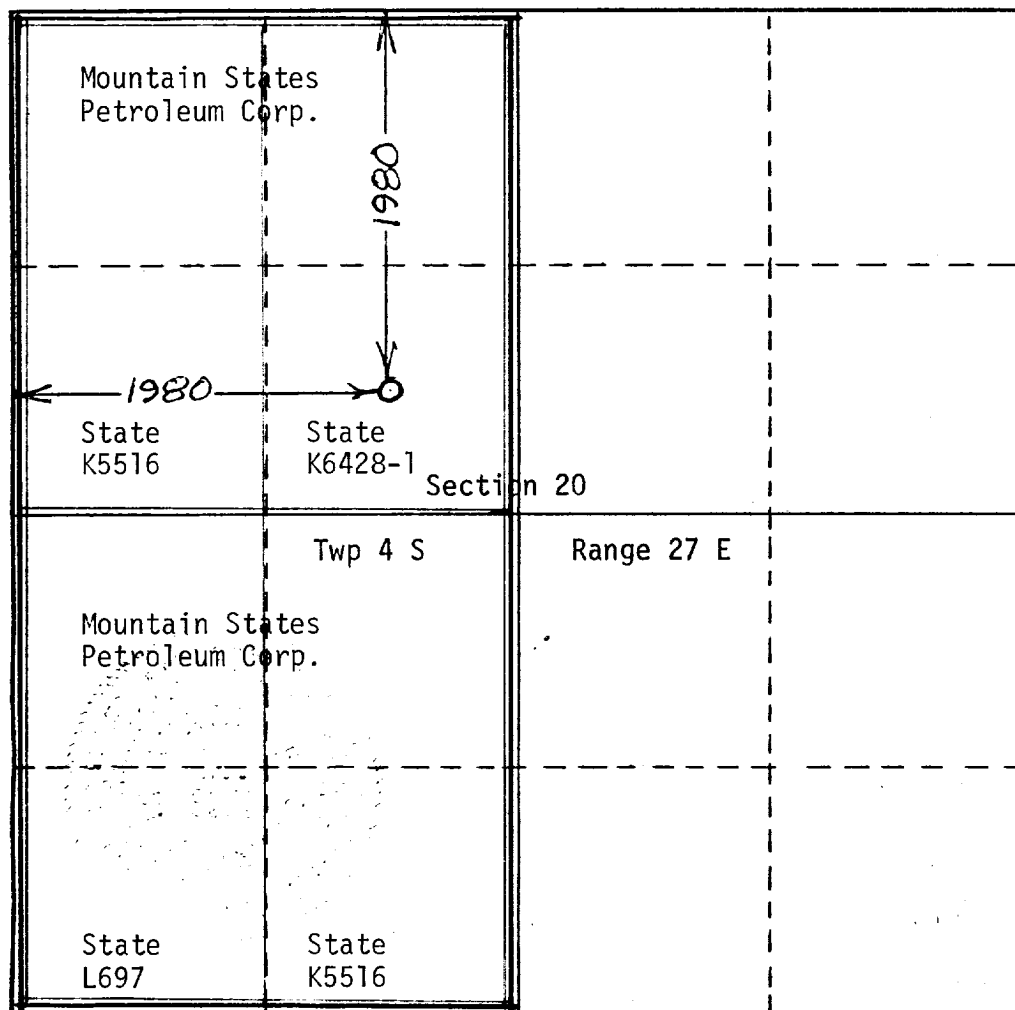

CERTIFICATION

I hereby certify that the information contained herein is true and complete to the best of my knowledge and belief.

KC Havenor

Name

GEOLOGIST

Position

Company

MOUNTAIN STATES

Date

5-10-72

I hereby certify that the well location shown on this plat was plotted from field notes of actual surveys made by me or under my supervision, and that the same is true and correct to the best of my knowledge and belief.

C. J. Anderson

Date Surveyed

5-10-72

Registered Professional Engineer and/or Land Surveyor

3650

Certificate No.

