

ENSERCH EXPLORATION, INC.

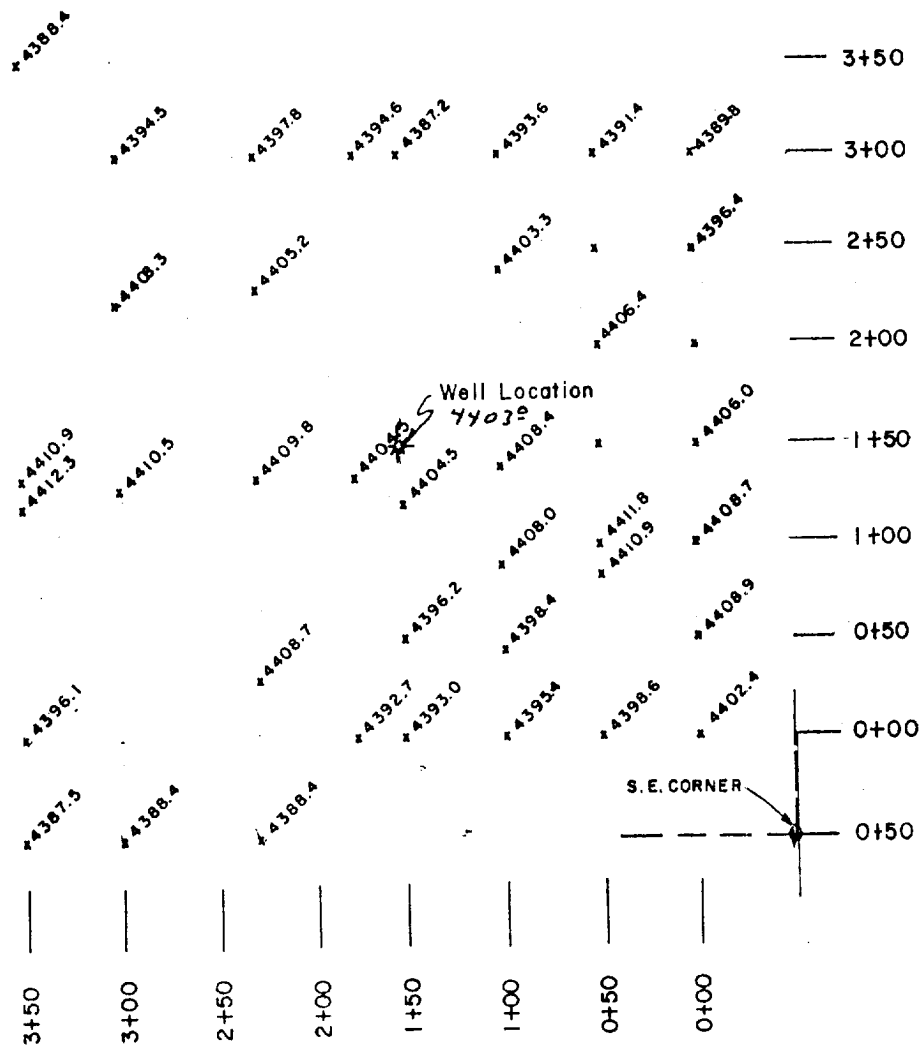

I HEREBY CERTIFY THAT THIS PLAT WAS MADE FROM NOTES TAKEN IN THE FIELD IN A BONA FIDE SURVEY MADE UNDER MY SUPERVISION, AND THAT THE SAME IS TRUE AND CORRECT TO THE BEST OF MY KNOWLEDGE AND BELIEF.

John W. West
 JOHN W. WEST N.M. P.E. & L.S. NO. 678
 TEXAS R.P.S. NO. 1138
 PARICK A. ROMERO N.M. L.S. NO. 8665
 TEXAS R.P.S. NO. 2100
 RONALD J. EIDSON N.M. L.S. NO. 2239
 TEXAS R.P.S. NO. 1863

ENSERCH EXPLORATION, INC.

TOPOGRAPHIC MAP OF AREA AROUND KENNA FEDERAL 30, NO. 1
 LOCATED 1980' FROM NORTH AND 660' FROM EAST LINES
 OF SEC. 30, TOWNSHIP 4 SOUTH, RANGE 29 EAST

CHAVES COUNTY, NEW MEXICO
 JOHN W. WEST ENGINEERING COMPANY
 CONSULTING ENGINEERS HOBBS, NEW MEXICO

Scale: 1" = 100'	Drawn by: MORGAN
Date: 3 FEB., 1980	Sheet 1 of 1 Sheets