

OF COPIES RECEIVED	
DISTRIBUTION	
ANTA FE	1
LE	1
S.G.S.	2
AND OFFICE	1
PERATOR	1

NEW MEXICO OIL CONSERVATION COMMISSION

30-005-60908
Form C-101
Revised 1-1-65

MAR 18 1981

5A. Indicate Type of Lease
STATE FEE

5. State Oil & Gas Lease No.
LG-6675



7. Unit Agreement Name

8. Farm or Lease Name
Round Top State

9. Well No.
2

10. Field and Pool, or Wildcat
Undesignated Abo



12. County
Chaves



19. Proposed Depth
3500'

19A. Formation
Abo

20. Rotary or C.T.
Rotary

Elevations (Show whether DF, RT, etc.)
3996.9' GR

21A. Kind & Status Plug. Bond
Blanket

21B. Drilling Contractor
Dual

22. Approx. Date Work will start
June 15, 1981

APPLICATION FOR PERMIT TO DRILL, DEEPEN, OR PLUG BACK

Type of Work

DRILL DEEPEN PLUG BACK

Type of Well
OIL WELL GAS WELL OTHER

SINGLE ZONE MULTIPLE ZONE

Name of Operator

Mesa Petroleum Co.

Address of Operator

1000 Vaughn Building / Midland, Texas 79701

Location of Well

UNIT LETTER I LOCATED 1980 FEET FROM THE South LINE

660 FEET FROM THE East LINE OF SEC. 9 TWP. 7S RGE. 23E NMPM

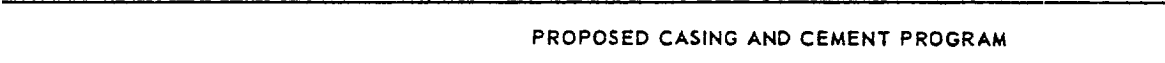
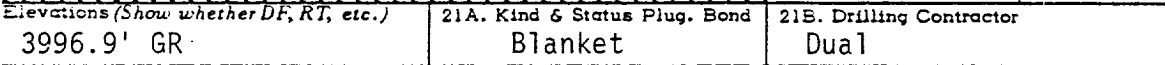

PROPOSED CASING AND CEMENT PROGRAM

SIZE OF HOLE	SIZE OF CASING	WEIGHT PER FOOT	SETTING DEPTH	SACKS OF CEMENT	EST. TOP
17 1/2"	13 3/8"	48#	800'	500	Surface
11"	8 5/8"	24#	1600'	600	Sufficient to
7 7/8"	4 1/2"	10.5#	3500'	500	Cover all Pay

Propose to drill 17 1/2" hole to 300' using air. Will set 13 3/8" surface casing and cement to surface. Will reduce hole to 11" and drill to 1600' to set 8 5/8" intermediate casing if water zones have been encountered or omit if not needed. Will nipple up ram type BOPs and reduce hole to 7 7/8" and drill to total depth with air, foam, or mud as required. After log evaluation, 4 1/2" casing may be run and cemented back to surface casing or with sufficient kinds and amounts to isolate and seal off any fresh water, oil, or gas zones encountered.

Gas sales are not dedicated.

XC: NMOCD (6), TLS, Cen Rcds, Acctg, Hobbs Office, MEC, MAH, Partners, File.

APPROVAL VALID FOR 180 DAYS
PERMIT EXPIRES 9-20-81
UNLESS DRILLING UNDERWAY

APL 12-1
APL 10-1
3-20

PLEASE DESCRIBE PROPOSED PROGRAM: IF PROPOSAL IS TO DEEPEN OR PLUG BACK, GIVE DATA ON PRESENT PRODUCTIVE ZONE AND PROPOSED NEW PRODUCTION. GIVE BLOWOUT PREVENTER PROGRAM, IF ANY.

I hereby certify that the information above is true and complete to the best of my knowledge and belief.

R. E. Martin Title Regulatory Coordinator Date March 16, 1981

(This space for State Use)

APPROVED BY Mike Wilkerson TITLE OIL AND GAS INSPECTOR DATE MAR 20 1981

CONDITIONS OF APPROVAL, IF ANY: If 8 5/8" is set it must be cemented back at least 100' inside the 13 3/8" +
Top cement specified by manufacturer

Notify NMOCD in sufficient time for review of casing

MEXICO OIL CONSERVATION COMMISS.
WELL LOCATION AND ACREAGE DEDICATION PLAT

Form C-102
Supersedes C-128
Effective 1-4-65

All distances must be from the outer boundaries of the Section.

Operator Mesa Petroleum Co.		Lease Round Top State		Well No. 2
Unit Letter I	Section 9	Township 7 South	Range 23 East	County Chaves
Actual Footage Location of Well: 1980 feet from the south line and 660 feet from the east line				
Ground Level Elev. 3996.9	Producing Formation Abo	Pool wildcat Abo Undesignated		Dedicated Acreage: SE/4 160 Acres

1. Outline the acreage dedicated to the subject well by colored pencil or hachure marks on the plat below.
2. If more than one lease is dedicated to the well, outline each and identify the ownership thereof (both as to working interest and royalty).
3. If more than one lease of different ownership is dedicated to the well, have the interests of all owners been consolidated by communitization, unitization, force-pooling, etc?

Yes No If answer is "yes," type of consolidation _____

If answer is "no," list the owners and tract descriptions which have actually been consolidated. (Use reverse side of this form if necessary.) _____

No allowable will be assigned to the well until all interests have been consolidated (by communitization, unitization, forced-pooling, or otherwise) or until a non-standard unit, eliminating such interests, has been approved by the Commission.

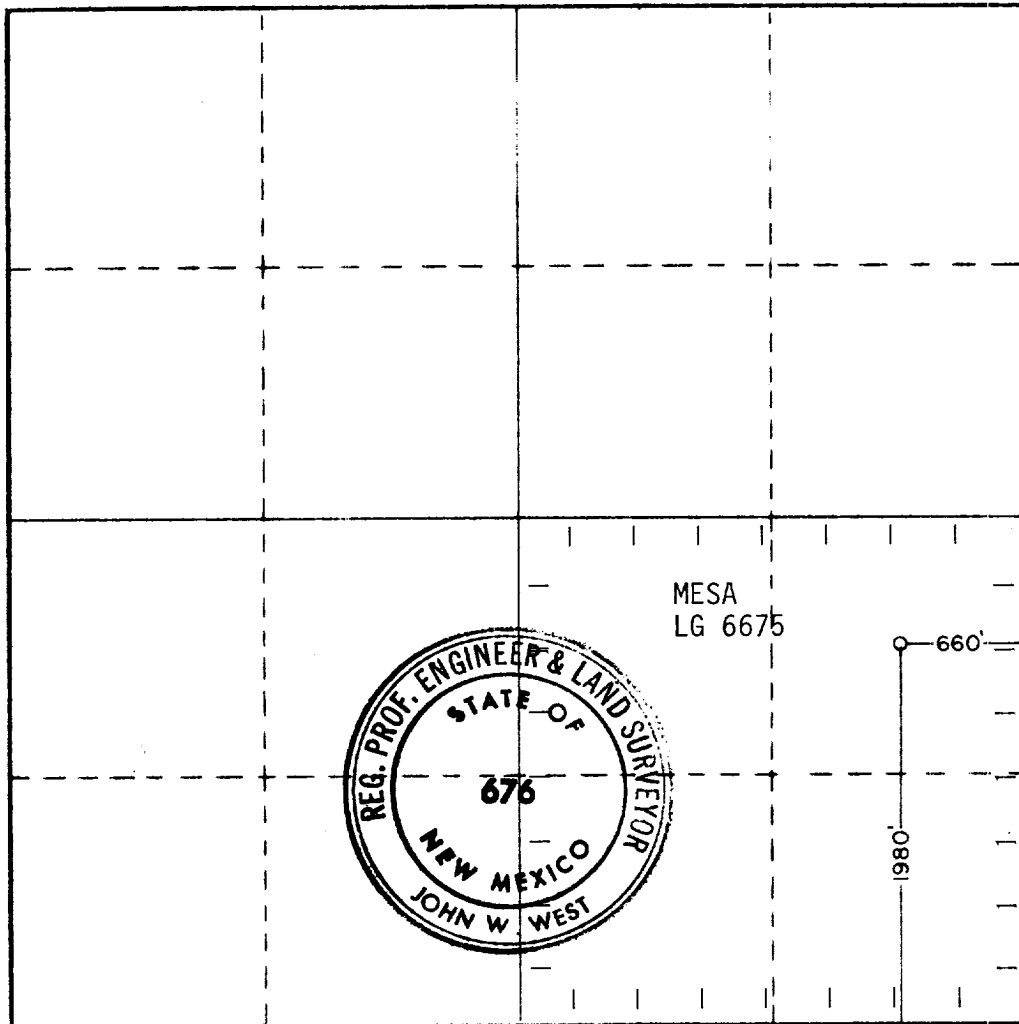

CERTIFICATION

I hereby certify that the information contained herein is true and complete to the best of my knowledge and belief.

R. E. Mathis

Name R. E. Mathis
Position Regulatory Coordinator
Company Mesa Petroleum Co.
Date March 16, 1981

I hereby certify that the well location shown on this plat was plotted from field notes of actual surveys made by me or under my supervision, and that the same is true and correct to the best of my knowledge and belief.

Date Surveyed 3-5-81
Registered Professional Engineer and/or Land Surveyor <i>John W. West</i>
Certificate No. JOHN W. WEST 676 PATRICK A. ROMERO 6663 Ronald J. Eidson 3239

