

STATE OF NEW MEXICO
ENERGY AND MINERALS DEPARTMENT

OIL CONSERVATION DIVISION
P. O. BOX 2088
SANTA FE, NEW MEXICO 87501

30-005-60961

Form C-101
Revised 10-1-78

NO. OF COPIES RECEIVED	
DISTRIBUTION	
SANTA FE	1
FILE	1
U.S.G.S.	2
LAND OFFICE	
OPERATOR	1

MAY 8 1981

O. C. D.
ARTESIA OFFICE

5A. Indicate Type of Lease
STATE ☐ PEE ☒

5. State Oil & Gas Lease No.

APPLICATION FOR PERMIT TO DRILL, DEEPEN, OR PLUG BACK

a. Type of Work

DRILL ☒

DEEPEN ☐

PLUG BACK ☐

b. Type of Well

OIL WELL ☒

GAS WELL ☐

OTHER ☐

SINGLE ZONE ☐

MULTIPLE ZONE ☐

c. Name of Operator

Stevens Oil Company

d. Address of Operator

P. O. Box 2203, Roswell, New Mexico

7. Unit Agreement Name

8. Farm or Lease Name

O'Brien "N"

9. Well No.

2-Y

10. Field and Pool, or Wildcat
Twin Lakes-San Andres
Assoc.

e. Location of Well

UNIT LETTER M LOCATED 540 FEET FROM THE South LINE

AND 480 FEET FROM THE West LINE OF SEC. 32 TWP. 8S RGE. 29E

17. County

Chaves

19. Proposed Depth

2950'

19A. Formation

San Andres

20. Rotary or C.T.

Rotary

21. Elevation (give whether D.R., K.I., e. c.)

3974.7 GL, 3984.7 KB

21A. Kind & Status Plug. Bond

Statewide

21B. Drilling Contractor

Stewart Brothers

22. Approx. Date Work will start

5-7-81

23.

PROPOSED CASING AND CEMENT PROGRAM

SIZE OF HOLE	SIZE OF CASING	WEIGHT PER FOOT	SETTING DEPTH	SACKS OF CEMENT	EST. TOP
12 1/4"	8 5/8"	24#	130'	75 sacks	circ.
7 7/8"	4 1/2"	9.5#	2950'	175 sacks	2000'

Will drill with water and mud to T.D., log, and if indicated productive, case to T.D. and perforate in producing intervals.

Adequate blowout preventers will be used.

APPROVAL VALID FOR 180 DAYS
PERMIT EXPIRES 11-11-81
UNLESS DRILLING UNDERWAY

IN ABOVE SPACE DESCRIBE PROPOSED PROGRAM; IF PROPOSAL IS TO DEEPEN OR PLUG BACK, GIVE DATA ON PRESENT PRODUCTIVE ZONE AND PROPOSED NEW PRODUCTIVE ZONE. GIVE BLOWOUT PREVENTER PROGRAM, IF ANY.

hereby certify that the information above is true and complete to the best of my knowledge and belief.

Signed W. A. Gressett Title Owner Date 5-7-81

(This space for State Use)

APPROVED BY W. A. Gressett TITLE SUPERVISOR, DISTRICT II DATE MAY 11 1981

CONDITIONS OF APPROVAL, IF ANY:

N MEXICO OIL CONSERVATION COMMISS
WELL LOCATION AND ACREAGE DEDICATION PLAT

Form C-102
 Supersedes C-128
 Effective 1-1-65

All distances must be from the outer boundaries of the Section

Operator Stevens Oil Company			Lease O'Brien "N"		Well No. 2Y
Tract Letter M	Section 32	Township 8 South	Range 29 East	County Chaves	
Acres: Footage Location of Well: 540 feet from the south line and 480 feet from the west line					
Ground Level Elev. 3974.7	Producing Formation San Andres		Pool Twin Lakes-San Andres Assoc.		Dedicated Acreage 40

1. Outline the acreage dedicated to the subject well by colored pencil or hachure marks on the plat below
2. If more than one lease is dedicated to the well, outline each and identify the ownership thereof (both as to working interest and royalty).
3. If more than one lease of different ownership is dedicated to the well, have the interests of all owners been consolidated by communitization, unitization, force-pooling, etc?

☐ Yes ☐ No If answer is "yes," type of consolidation _____

If answer is "no," list the owners and tract descriptions which have actually been consolidated. (Use reverse side of this form if necessary.) _____

No allowable will be assigned to the well until all interests have been consolidated (by communitization, unitization, forced-pooling, or otherwise) or until a non-standard unit, eliminating such interests, has been approved by the Commission.

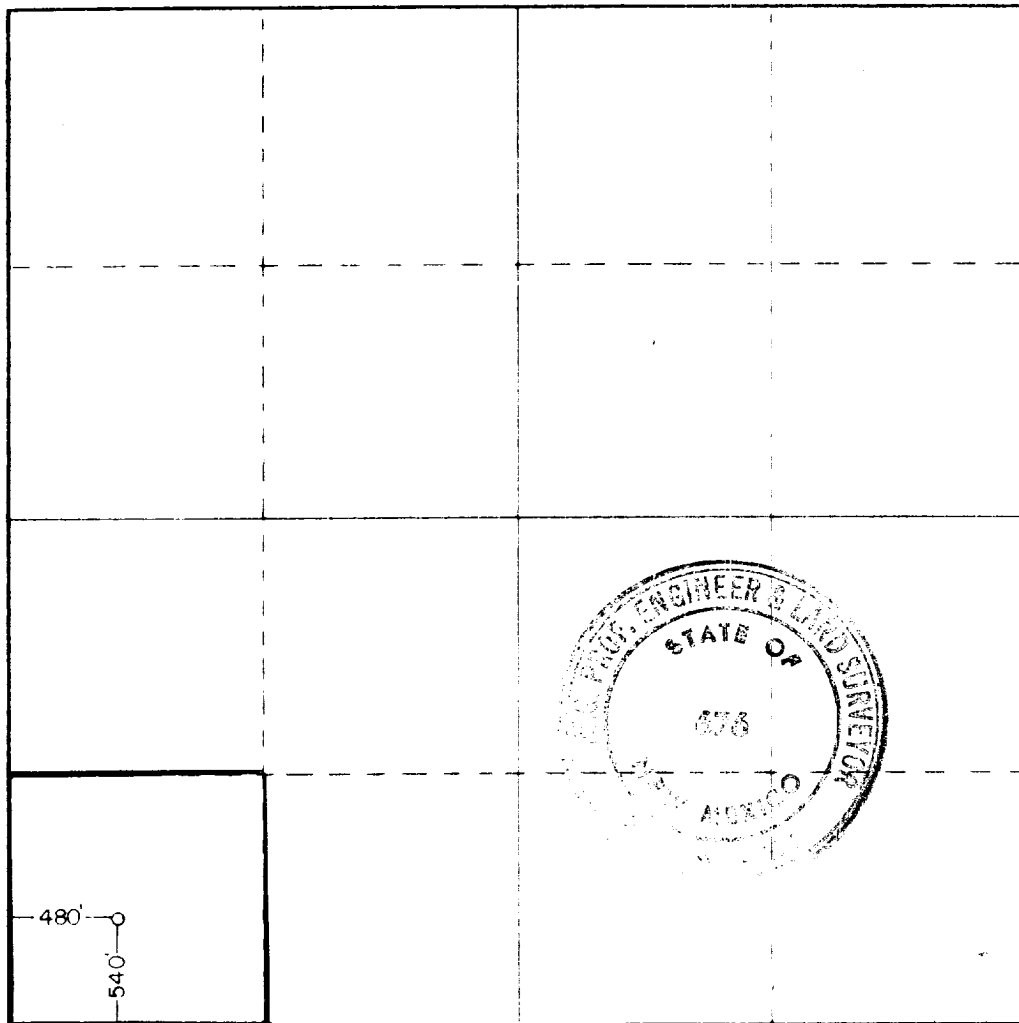

CERTIFICATION

I hereby certify that the information contained herein is true and complete to the best of my knowledge and belief

Signature: *Donald J. Eidson*

Owner

Company: **Stevens Oil Company**

Date: **5-7-81**

I hereby certify that the well location shown on this plat was plotted from field notes of actual surveys made by me or under my supervision, and that the same is true and correct to the best of my knowledge and belief.

Date Surveyed: **5-6-81**

Registered Professional Engineer and Land Surveyor

Signature: *John W. West*

Certificate No.	JOHN W. WEST	676
	PATRICK A. ROMERO	6663
	Ronald J. Eidson	3239

