

JUN 4 1981

O. C. D.

ARTESIA OFFICE

30-005-60983  
Form C-101  
Revised 10-1-78

NO. OF COPIES RECEIVED	
DISTRIBUTION	
SANTA FE	1
FILE	1
U.S.G.S.	2
LAND OFFICE	
OPERATOR	1

5A. Indicate Type of Lease STATE <input type="checkbox"/> FEE <input checked="" type="checkbox"/>
5. State Oil & Gas Lease No.
7. Unit Agreement Name
8. Farm or Lease Name O'Brien "L"
9. Well No. 7
10. Field and Pool, or Wildcat Twin Lakes-San Andres Assoc.
12. County Chaves

APPLICATION FOR PERMIT TO DRILL, DEEPEN, OR PLUG BACK

1. Type of Work  
DRILL ☒ DEEPEN ☐ PLUG BACK ☐

2. Type of Well  
OIL WELL ☒ GAS WELL ☐ OTHER ☐  
SINGLE ZONE ☐ MULTIPLE ZONE ☐

Name of Operator  
Stevens Oil Company  
Address of Operator  
P. O. Box 2203, Roswell, New Mexico 88210

Location of Well  
UNIT LETTER E LOCATED 1650 FEET FROM THE North LINE  
330 FEET FROM THE West LINE OF SEC. 5 TWP. 9-S RGE. 29-E NMP. 10

19. Proposed Depth 2950'	19A. Formation San Andres	20. Rotary or C.T. Rotary
21A. Kind & Status Plug. Bond Statewide	21B. Drilling Contractor Artesia Fishing Tool	22. Approx. Date Work will start 6-4-81

3. PROPOSED CASING AND CEMENT PROGRAM

SIZE OF HOLE	SIZE OF CASING	WEIGHT PER FOOT	SETTING DEPTH	SACKS OF CEMENT	EST. TOP
12 1/2"	8 5/8"	20#	130'	75 sacks	Circ.
7 7/8"	4 1/2"	9.5#	2950'	175 sacks	2000'

Will drill with water and mud to T.D., log, and if indicated productive, case to T.D. and perforate in producing intervals.

Adequate blowout preventers will be used.

APPROVAL VALID FOR 180 DAYS  
PERMIT EXPIRES 12-10-81  
UNLESS DRILLING UNDERWAY

ABOVE SPACE DESCRIBE PROPOSED PROGRAM: IF PROPOSAL IS TO DEEPEN OR PLUG BACK, GIVE DATA ON PRESENT PRODUCTIVE ZONE AND PROPOSED NEW PRODUCTIVE ZONE. GIVE BLOWOUT PREVENTER PROGRAM, IF ANY.

I hereby certify that the information above is true and complete to the best of my knowledge and belief.

Signed [Signature] Title Owner Date 6-3-81  
(This space for State Use)

APPROVED BY [Signature] TITLE SUPERVISOR, DISTRICT II DATE JUN 10 1981  
CONDITIONS OF APPROVAL, IF ANY:

**NEW MEXICO OIL CONSERVATION COMMISSION  
WELL LOCATION AND ACREAGE DEDICATION PLAT**

Form C-102  
Supersedes C-128  
Effective 1-1-65

All distances must be from the outer boundaries of the Section

Operator <b>Stevens Oil Co.</b>			Lease <b>O'Brien "L"</b>		Well No. <b>7</b>
Tract Letter <b>E</b>	Section <b>5</b>	Township <b>9South</b>	Range <b>29E 30W</b>	County <b>Chaves</b>	

Actual Footage Location of Well: <b>1650</b> feet from the <b>North</b> line and <b>330</b> feet from the <b>West</b> line					
Ground Level Elev. <b>3961'</b>	Producing Formation <b>San Andres</b>	Pool <b>WMA Twin Lakes-San Andres Assoc.</b>	Dedicated Acreage: <b>40</b> Acres		

- 1 Outline the acreage dedicated to the subject well by colored pencil or hatchure marks on the plat below.
- 2 If more than one lease is dedicated to the well, outline each and identify the ownership thereof (both as to working interest and royalty).
- 3 If more than one lease of different ownership is dedicated to the well, have the interests of all owners been consolidated by communitization, unitization, force-pooling, etc?

☐ Yes    ☐ No    If answer is "yes," type of consolidation \_\_\_\_\_

If answer is "no," list the owners and tract descriptions which have actually been consolidated. (Use reverse side of this form if necessary.) \_\_\_\_\_

No allowable will be assigned to the well until all interests have been consolidated (by communitization, unitization, forced-pooling, or otherwise) or until a non-standard unit, eliminating such interests, has been approved by the Commission.

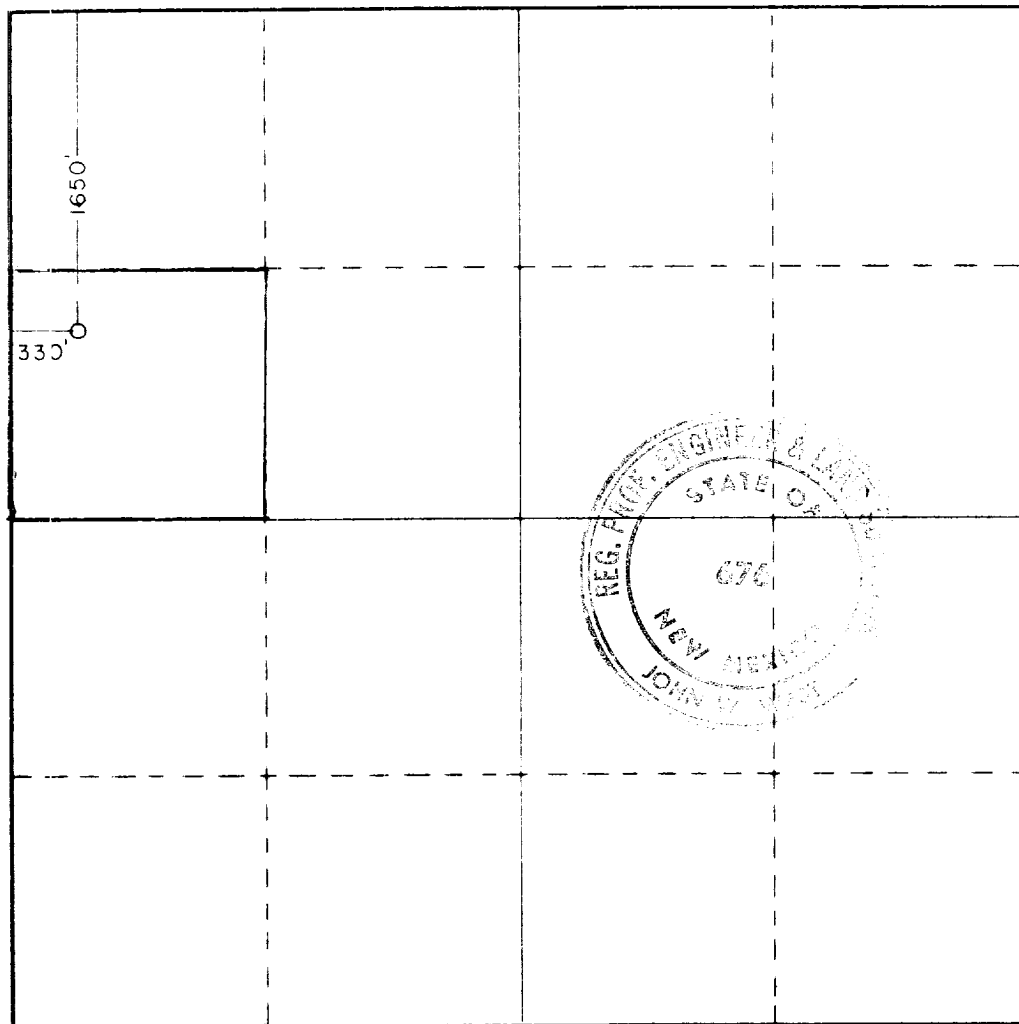

**CERTIFICATION**

I hereby certify that the information contained herein is true and complete to the best of my knowledge and belief.

Name \_\_\_\_\_

Position \_\_\_\_\_

**Owner**

Company \_\_\_\_\_

**Stevens Oil Company**

Date \_\_\_\_\_

**6-3-81**

I hereby certify that the well location shown on this plat was plotted from field notes of actual surveys made by me or under my supervision, and that the same is true and correct to the best of my knowledge and belief.

Date Surveyed \_\_\_\_\_

**April 28, 1981**

Registered Professional Engineer and/or Land Surveyor

Certificate No. \_\_\_\_\_

**JOHN W. WEST 676  
PATRICK A. ROMERO 6863  
Ronald J. Eidson 3239**

0 330 660 990 1320 1650 1980 2310 2640 2000 1500 1000 500 0