

NO. OF COPIES RECEIVED	
DISTRIBUTION	
SANTA FE	1
FILE	1
U.S.G.S.	2
LAND OFFICE	1
OPERATOR	1

P. O. BOX 2088  
SANTA FE, NEW MEXICO 87501

JUN 09 1981

O. C. D.

ARTESIA OFFICE

Form C-101  
Revised 10-1-78

5A. Indicate Type of Lease

STATE ☒ FEE ☐

5. State Oil & Gas Lease No.

LG-4354

7. Unit Agreement Name

8. Farm or Lease Name

Cockleburr "RD" State

9. Well No.

1

10. Field and Pool, or Wildcat

Wildcat Unit

12. County

Chaves

APPLICATION FOR PERMIT TO DRILL, DEEPEN, OR PLUG BACK

Type of Work

DRILL ☒

DEEPEN ☐

PLUG BACK ☐

Type of Well

OIL WELL ☐

GAS WELL ☒

OTHER

SINGLE ZONE ☐

MULTIPLE ZONE ☐

Name of Operator

Yates Petroleum Corporation

Address of Operator

207 South 4th Street, Artesia, NM 88210

Location of Well

UNIT LETTER FM LOCATED 660 FEET FROM THE South LINE

660 FEET FROM THE West LINE OF SEC. 17 TWP. 7s RGE. 25e NMPM

Elevations (Show whether DF, RT, etc.)

3806.2 GL

21A. Kind & Status Plug. Bond

Blanket

19. Proposed Depth

4350' ±

19A. Formation

Abo

20. Rotary or C.T.

Rotary

21B. Drilling Contractor

LaRue #1

22. Approx. Date Work will start

ASAP

PROPOSED CASING AND CEMENT PROGRAM

SIZE OF HOLE	SIZE OF CASING	WEIGHT PER FOOT	SETTING DEPTH	SACKS OF CEMENT	EST. TOP
7 1/2"	13 3/8"	48# J-55	Approx. 400'	400 sx.	circulate
2 1/2"	8 5/8"	24# J-55	Approx. 1400'	800 sx.	circulate
3 3/4" or 7 7/8"	5 1/2" or 4 1/2"	15.5 or 10.5#	TD 4300'	300 sx.	

We propose to drill and test the Abo and intermediate formations. Approximately 400' of surface casing will be set and cement circulated to shut off gravel and caving. Casing will be set approximately 100' below the Roswell Water Basin (250' - 300'). Intermediate casing will be run and if commercial, 5 1/2 or 4 1/2 production casing will be run and cemented with adequate cement, perforated and stimulated as needed for production.

WELL PROGRAM: FW gel and LCM to 1400', Brine KCL to 3250' KCL Drispak and Starch to TD.  
MW 10-10.2, Vis. 34-39, WL 14-7.

WELL PROGRAM: BOP's will be installed on 8 5/8" casing and tested daily.

WELL NOT DEDICATED.

APPROVAL VALID FOR 180 DAYS  
PERMIT EXPIRES 12-10-81  
UNLESS DRILLING UNDERWAY

BELOW SPACE DESCRIBE PROPOSED PROGRAM: IF PROPOSAL IS TO DEEPEN OR PLUG BACK, GIVE DATA ON PRESENT PRODUCTIVE ZONE AND PROPOSED NEW PRODUCTION ZONE. GIVE BLOWOUT PREVENTER PROGRAM, IF ANY.

I hereby certify that the information above is true and complete to the best of my knowledge and belief.

*[Signature]*  
(This space for State Use)

Title Geographer

Date 6-8-81

APPROVED BY *[Signature]* TITLE SUPERVISOR, DISTRICT II

DATE JUN 10 1981

CONDITIONS OF APPROVAL, IF ANY:

Cement will be pumped to  
surface behind 13 3/8" & 8 5/8" casing

Notify N.M.O.C.C. in sufficient  
time to witness cementing  
the 8 5/8" casing

**MEXICO OIL CONSERVATION COMMISSION  
WELL LOCATION AND ACREAGE DEDICATION PLAT**

Form C-102  
Superseded C-128  
Effective 1-1-85

All distances must be from the outer boundaries of the Section.

Operator <b>YATES PETROLEUM CORPORATION</b>			Lease <b>Cockleburr "RD" State</b>		Well No. <b>1</b>
Unit Letter <b>M</b>	Section <b>17</b>	Township <b>7 South</b>	Range <b>25 East</b>	County <b>Chaves</b>	
Actual Footage Location of Well: <b>660</b> feet from the <b>South</b> line and <b>660</b> feet from the <b>West</b> line					
Ground Level Elev. <b>3806.2</b>	Producing Formation <b>Abo</b>		Pool <b>Undes. Abo</b>		Dedicated Acreage: <b>160</b> Acres

1. Outline the acreage dedicated to the subject well by colored pencil or hachure marks on the plat below.
2. If more than one lease is dedicated to the well, outline each and identify the ownership thereof (both as to working interest and royalty).
3. If more than one lease of different ownership is dedicated to the well, have the interests of all owners been consolidated by communitization, unitization, force-pooling, etc?

☐ Yes    ☐ No    If answer is "yes," type of consolidation \_\_\_\_\_

If answer is "no," list the owners and tract descriptions which have actually been consolidated. (Use reverse side of this form if necessary.) \_\_\_\_\_

No allowable will be assigned to the well until all interests have been consolidated (by communitization, unitization, forced-pooling, or otherwise) or until a non-standard unit, eliminating such interests, has been approved by the Commission.

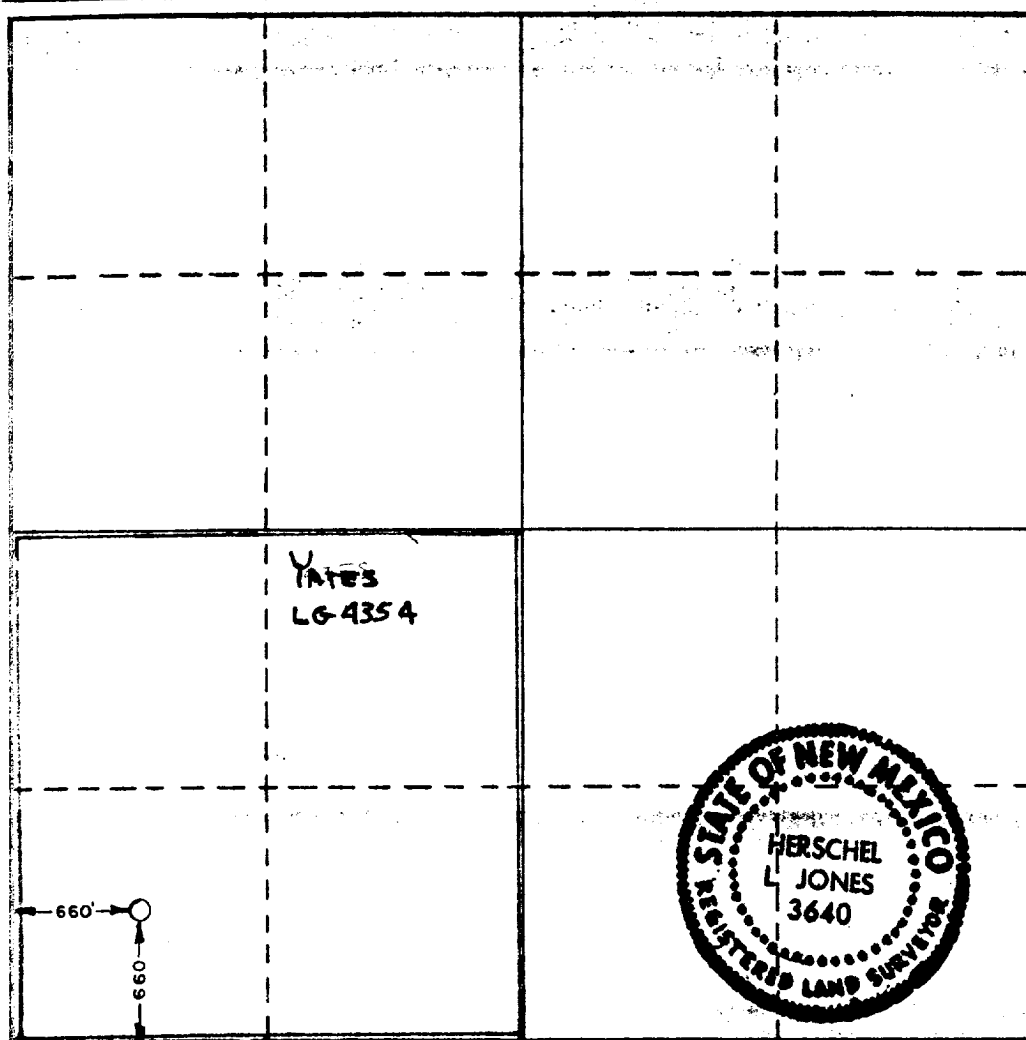

**CERTIFICATION**

I hereby certify that the information contained herein is true and complete to the best of my knowledge and belief.

*[Signature]*  
Name

**Gliserio Rodriguez**

Position

**Geographer**

Company

**Yates Petroleum Corporation**

Date

**5/27/81**

I hereby certify that the well location shown on this plat was plotted from field notes of actual surveys made by me or under my supervision, and that the same is true and correct to the best of my knowledge and belief.

Date Surveyed

**May 16, 1981**

Registered Professional Engineer and/or Land Surveyor

*[Signature]*

Certificate No.

**3640**

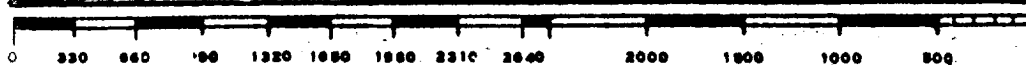

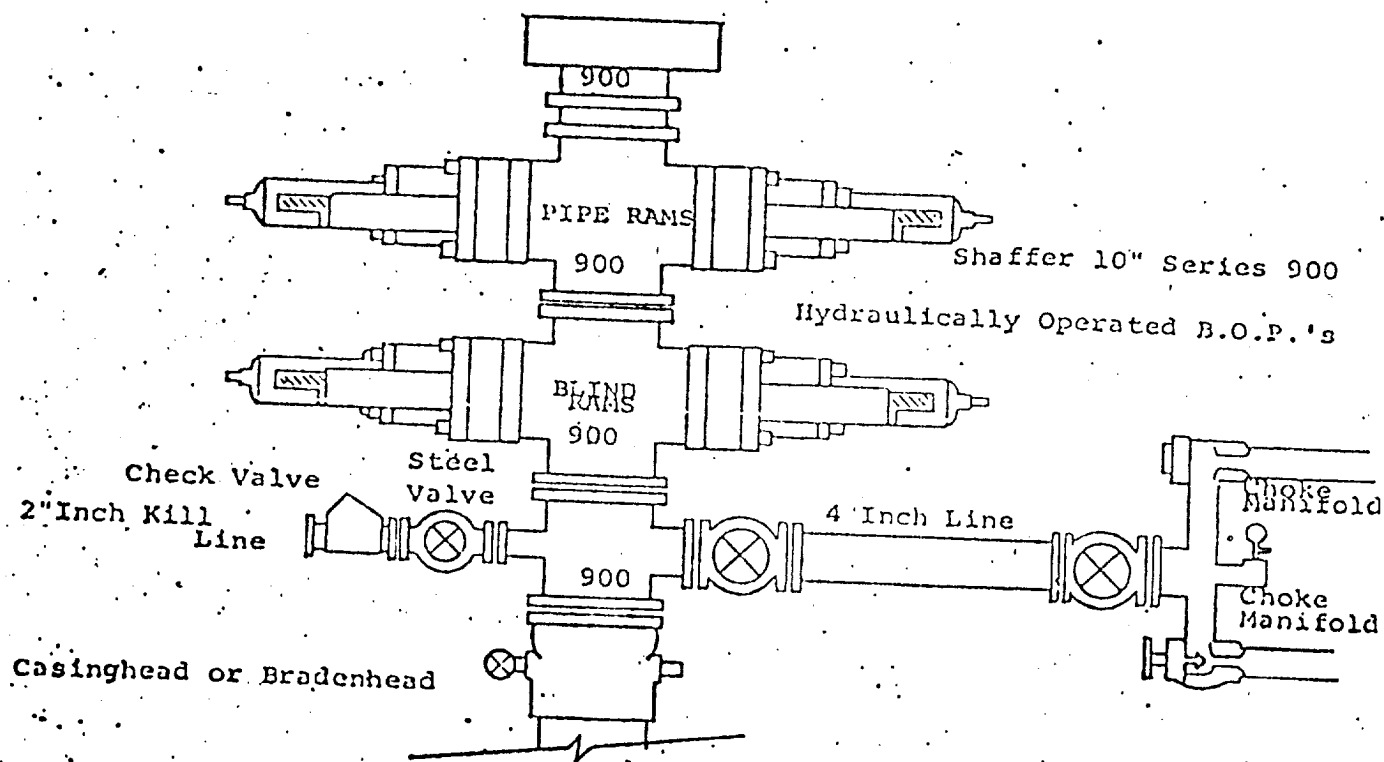

THE FOLLOWING CONSTITUTE MINIMUM BLOWOUT PREVENTER REQUIREMENTS

1. All preventers to be hydraulically operated with secondary manual controls installed prior to drilling out from under casing.
2. Choke outlet to be a minimum of 4" diameter.
3. Kill line to be of all steel construction of 2" minimum diameter.
4. All connections from operating manifolds to preventers to be all steel. hole or tube a minimum of one inch in diameter.
5. The available closing pressure shall be at least 15% in excess of that required with sufficient volume to operate the B.O.P.'s.
6. All connections to and from preventer to have a pressure rating equivalent to that of the B.O.P.'s.
7. Inside blowout preventer to be available on rig floor.
8. Operating controls located a safe distance from the rig floor.
9. Hole must be kept filled on trips below intermediate casing. Operator not responsible for blowouts resulting from not keeping hole full.
10. D. P. float must be installed and used below zone of first gas intrusion.