

STATE OF NEW MEXICO  
OIL AND MINERALS DEPARTMENT

OIL CONSERVATION DIVISION

P. O. BOX 2088

SANTA FE, NEW MEXICO 87501

JUL 9 1981

O. C. D.  
ARTESIA, OFFICE

30-005-61024  
Form C-101  
Revised 10-1-78

NO. OF COPIES RECEIVED	
DISTRIBUTION	
SANTA FE	1
FILE	1
U.S.G.S.	2
LAND OFFICE	
OPERATOR	

5A. Indicate Type of Lease  
STATE ☐ FEDERAL ☒

5. State Oil & Gas Lease No.

APPLICATION FOR PERMIT TO DRILL, DEEPEN, OR PLUG BACK

Type of Work

Type of Well DRILL ☒ DEEPEN ☐ PLUG BACK ☐  
OIL WELL ☐ GAS WELL ☒ OTHER ☐ SINGLE ZONE ☐ MULTIPLE ZONE ☐

Name of Operator

Yates Petroleum Corporation

Address of Operator

207 South 4th Street, Artesia, NM 88210

Location of Well

UNIT LETTER F LOCATED 1980 FEET FROM THE North LINE

1980 FEET FROM THE West LINE OF SEC. 31 TWP. 6S RGE. 25e NMPM

7. Unit Agreement Name

8. Farm or Lease Name

Snell QZ

9. Well No.

1

10. Field and Pool, or Wildcat

Abo

17. County

Chaves

19. Proposed Depth

4400'

19A. Formation

Abo

20. Rotary or C.T.

Rotary

Elevations (Show whether DT, RT, etc.)

3911.1 GL

21A. Kind & Status Plug. Bond

Blanket

21B. Drilling Contractor

L & M #2

22. Approx. Date Work will start

ASAP

PROPOSED CASING AND CEMENT PROGRAM

SIZE OF HOLE	SIZE OF CASING	WEIGHT PER FOOT	SETTING DEPTH	SACKS OF CEMENT	EST. TOP
17 1/2"	13 3/8"	48# J-55	850'	800 sx.	circulate
7 7/8"	5 1/2" or 4 1/2"	15.5# or 10.5#	TD	450 sx.	

We propose to drill and test the Abo and intermediate formations. Approximately 850' of surface casing will be set and cement circulated to shut off gravel and caving. If needed (lost circulation) 8 5/8" intermediate casing will be run to 1500' and cemented with enough cement calculated to tie back to the surface casing. A temperature survey will be run. If commercial, production casing will be run and cemented with adequate cover, perforate and stimulate as needed for production.

MUD PROGRAM: FW gel and LCM to 1500', Brine KCL to 3200', KCL Drispak & Starch to TD.  
MW 10-10.2, Vis. 34-39, WL 14-7

BOP PROGRAM: BOP's will be installed on 13 3/8" casing and tested daily.

GAS NOT DEDICATED.

APPROVAL VALID FOR 180 DAYS  
PERMIT EXPIRES 1-13-82  
UNLESS DRILLING UNDERWAY

BOVE SPACE DESCRIBE PROPOSED PROGRAM: IF PROPOSAL IS TO DEEPEN OR PLUG BACK, GIVE DATA ON PRESENT PRODUCTIVE ZONE AND PROPOSED NEW PROD. ZONE. GIVE BLOWOUT PREVENTER PROGRAM, IF ANY.

by certify that the information above is true and complete to the best of my knowledge and belief.

by [Signature] Title Geographer Date 7-8-81

(This space for State Use)

MOVED BY [Signature] TITLE SUPERVISOR, DISTRICT II DATE JUL 13 1981

DITIONS OF APPROVAL, IF ANY:

STATE OF NEW MEXICO  
ENERGY AND MINERALS DEPARTMENT

LAND CONSERVATION DIVISION

P. O. BOX 2088  
SANTA FE, NEW MEXICO 87501

Form C-101  
Revised 10-1-78

NO. OF COPIES RECEIVED	
DISTRIBUTION	
SANTA FE	
FILE	
U.S.G.S.	
LAND OFFICE	
OPERATOR	

JUL 2 1981

5A. Indicate Type of Lease  
STATE ☐ FEE ☒

5. State Oil & Gas Lease No.

APPLICATION FOR PERMIT TO DRILL, DEEPEN, OR PLUG BACK

Type of Work

Type of Well DRILL ☒ DEEPEN ☐ PLUG BACK ☐  
OIL WELL ☐ GAS WELL ☒ OTHER ☐ SINGLE ZONE ☐ MULTIPLE ZONE ☐

Name of Operator

Artesia Petroleum Corporation

Address of Operator

207 S. 4th Street, Artesia, NM 88210

Location of Well

UNIT LETTER F LOCATED 1980' FEET FROM THE North LINE

1980' FEET FROM THE West LINE OF SEC. 31 TWP. 6S RGE. 25E NMPM

7. Unit Agreement Name

8. Farm or Lease Name

Snell OZ

9. Well No.

1

10. Field and Pool, or Wildcat

Abo

12. County

Chaves

19. Proposed Depth	19A. Formation	20. Rotary or C.T.
4400'	Abo	Rotary
21A. Kind & Status Plug. Bond	21B. Drilling Contractor	22. Approx. Date Work will start
Blanket	L & M #2	ASAP

Elevations (Show whether DF, KT, etc.)

3911.1' GL

PROPOSED CASING AND CEMENT PROGRAM

SIZE OF HOLE	SIZE OF CASING	WEIGHT PER FOOT	SETTING DEPTH	SACKS OF CEMENT	EST. TOP
17 1/2"	13 3/8"	48# J-55	850'	800 sx.	circulate
7 7/8"	5 1/2" or 4 1/2"	15.5# or 10.5 #	TD	450 sx.	circulate

We propose to drill and test the Abo and intermediate formations. Approximately 850' of surface casing will be set and cement circulated to shut off gravel and caving. If needed (lost circulation), 8 5/8" intermediate casing will be run to 1400' and cement circulated. If commercial, production casing will be run and cemented with adequate cover, perforate and stimulate as needed for production.

MUD PROGRAM: FW gel and LCM to 1500', Brine KCL to 3200', KCL Drispak & Starch to TD. MW 10-10.2, Vis. 34-39, WL 14-7.

BOP PROGRAM: BOP's will be installed on 13 3/8" casing and tested daily.

GAS NOT DEDICATED.

ABOVE SPACE DESCRIBE PROPOSED PROGRAM; IF PROPOSAL IS TO DEEPEN OR PLUG BACK, GIVE DATA ON PRESENT PRODUCTIVE ZONE AND PROPOSED NEW PRODUCTIVE ZONE. GIVE BLOWOUT PREVENTER PROGRAM, IF ANY.

I hereby certify that the information above is true and complete to the best of my knowledge and belief.

Glenn Rodriguez Title Geographer Date 7-2-81  
(This space for State Use)

APPROVED BY \_\_\_\_\_ TITLE SUPERVISOR, DISTRICT II DATE JUL 1 8 1981

REVISIONS OF APPROVAL, IF ANY:

MEXICO OIL CONSERVATION COMMISSION  
WELL LOCATION AND ACREAGE DEDICATION PLAT

Form C-102  
Supersedes C-128  
Effective 1-1-65

All distances must be from the outer boundaries of the Section.

Operator <b>YATES PETROLEUM CORPORATION</b>		Lease <b>Snell "QZ"</b>		Well No. <b>1</b>
Unit Letter <b>"F"</b>	Section <b>31</b>	Township <b>6 South</b>	Range <b>25 East</b>	County <b>Chaves</b>
Actual Footage Location of Well:				
1980 feet from the North		line and	1980 feet from the West	line
Ground Level Elev. <b>3911.1</b>	Producing Formation <b>Abo</b>	Pool <b>Undes. Abo</b>	Dedicated Acreage: <b>160</b> Acres	

1. Outline the acreage dedicated to the subject well by colored pencil or hachure marks on the plat below.
2. If more than one lease is dedicated to the well, outline each and identify the ownership thereof (both as to working interest and royalty).
3. If more than one lease of different ownership is dedicated to the well, have the interests of all owners been consolidated by communitization, unitization, force-pooling, etc?

☐ Yes ☐ No If answer is "yes," type of consolidation \_\_\_\_\_

If answer is "no," list the owners and tract descriptions which have actually been consolidated. (Use reverse side of this form if necessary.) \_\_\_\_\_

No allowable will be assigned to the well until all interests have been consolidated (by communitization, unitization, forced-pooling, or otherwise) or until a non-standard unit, eliminating such interests, has been approved by the Commission.

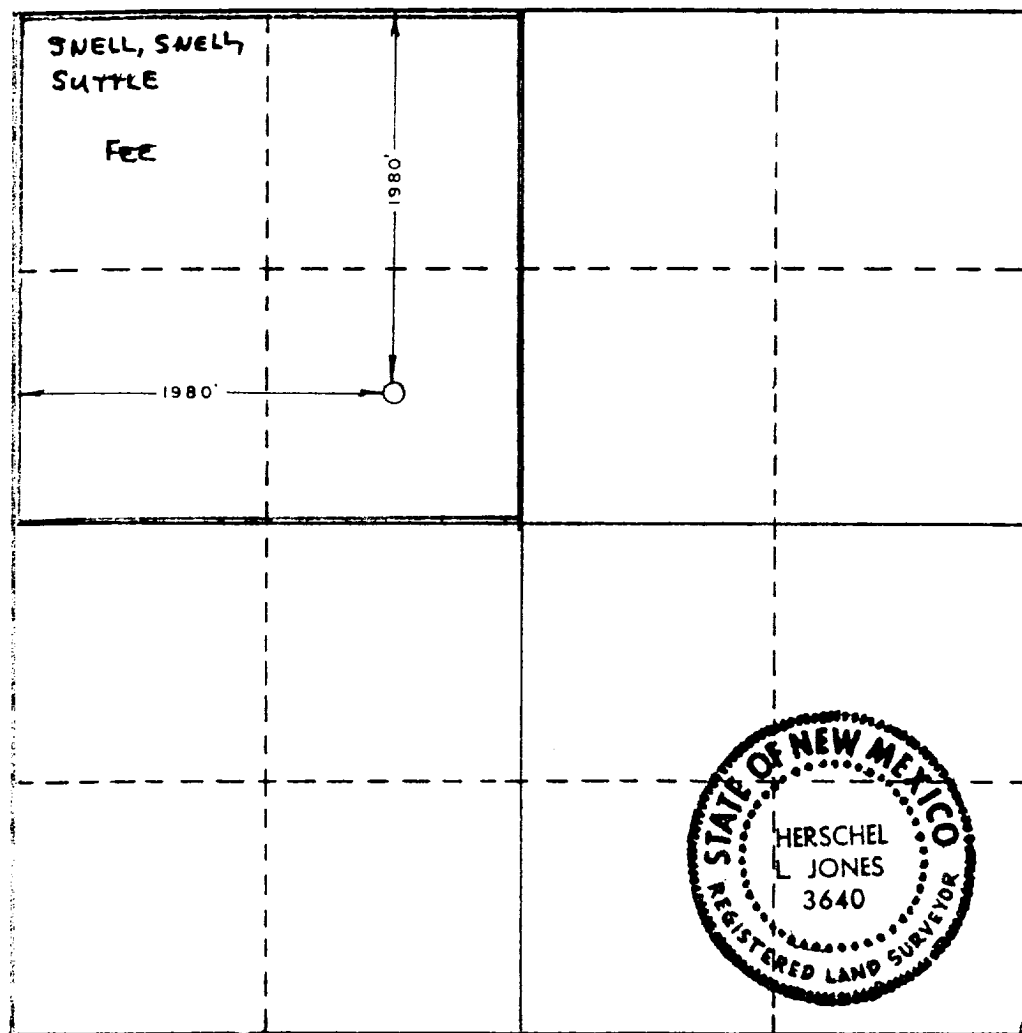

**CERTIFICATION**

I hereby certify that the information contained herein is true and complete to the best of my knowledge and belief.

*[Signature]*  
Name  
**Gliserio Rodriguez**  
Position  
**Geographer**  
Company  
**Yates Petroleum Corporation**  
Date  
**5/27/81**

I hereby certify that the well location shown on this plat was plotted from field notes of actual surveys made by me or under my supervision, and that the same is true and correct to the best of my knowledge and belief.

Date Surveyed  
**May 16, 1981**

Registered Professional Engineer and/or Land Surveyor

Certificate No.  
**3640**



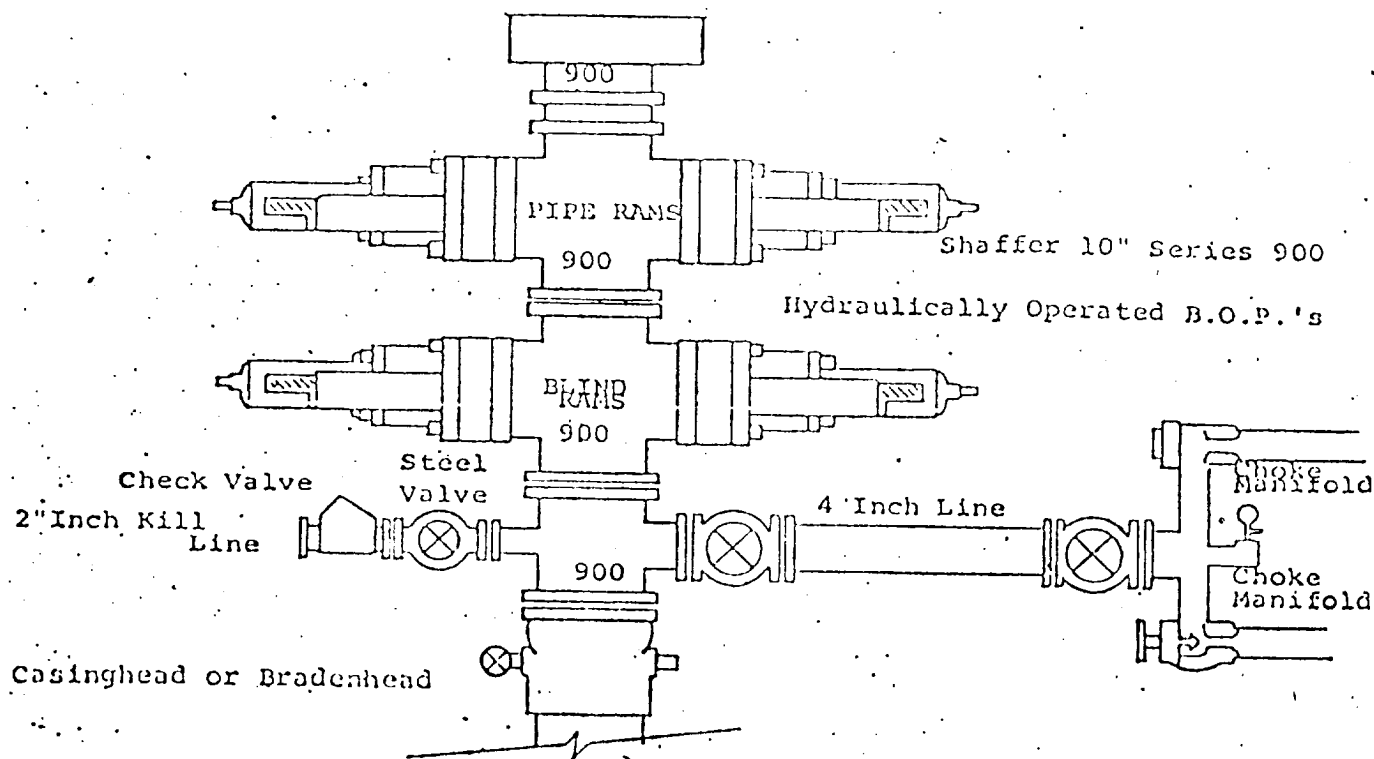

THE FOLLOWING CONSTITUTE MINIMUM BLOWOUT PREVENTER REQUIREMENTS

1. All preventers to be hydraulically operated with secondary manual controls installed prior to drilling out from under casing.
2. Choke outlet to be a minimum of 4" diameter.
3. Kill line to be of all steel construction of 2" minimum diameter.
4. All connections from operating manifolds to preventers to be all steel. hole or tube a minimum of one inch in diameter.
5. The available closing pressure shall be at least 15% in excess of that required with sufficient volume to operate the B.O.P.'s.
6. All connections to and from preventer to have a pressure rating equivalent to that of the B.O.P.'s.
7. Inside blowout preventer to be available on rig floor.
8. Operating controls located a safe distance from the rig floor.
9. Hole must be kept filled on trips below intermediate casing. Operator not responsible for blowouts resulting from not keeping hole full.
10. D. P. float must be installed and used below zone of first gas intrusion.