

NO. OF COPIES RECEIVED	
DISTRIBUTION	
SANTA FE	<input checked="" type="checkbox"/>
FILE	<input checked="" type="checkbox"/>
U.S.G.S.	<input checked="" type="checkbox"/>
LAND OFFICE	<input checked="" type="checkbox"/>
OPERATOR	<input checked="" type="checkbox"/>

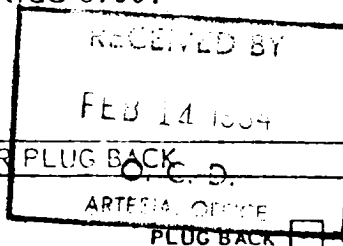

5A. Indicate Type of Lease
STATE ☐ FEE ☒
5. State Oil & Gas Lease No.

APPLICATION FOR PERMIT TO DRILL, DEEPEN, OR PLUG BACK

1a. Type of Work

b. Type of Well DRILL ☒ DEEPEN ☐OIL WELL ☐ GAS WELL ☒ OTHERSINGLE ZONE ☐ MULTIPLE ZONE ☐

2. Name of Operator

Yates Petroleum Corporation

3. Address of Operator

207 S. 4th, Artesia, New Mexico 88210

4. Location of Well

UNIT LETTER C LOCATED 660 FEET FROM THE North LINE

AND 1980

FEET FROM THE West LINE OF SEC. 31 TWP. 6S RGE. 25E NADP

7. Unit Agreement Name

8. Farm or Lease Name

Snell "QZ"

9. Well No.

1

10. Field and Pool, or Wildcat

Pecos Slope Abo

17. County

Chaves

11. Elevations (Show whether Dr, RT, etc.)	21A. Kind & Status Plug. Bond	19. Proposed Depth	19A. Formation	13. Rotary or C.T.
3911.1' GL 2878.1'	Blanket	4400'	Abo	Rotary
21B. Drilling Contractor	22. Approx. Date Work will start			
L&M #2	ASAP			

23.

PROPOSED CASING AND CEMENT PROGRAM

SIZE OF HOLE	SIZE OF CASING	WEIGHT PER FOOT	SETTING DEPTH	SACKS OF CEMENT	EST. TOP
14 3/4"	10 3/4"	40.5# J-55	850'	800 sx	circ
7 7/8"	4 1/2"	9.5# J-55	TD	450 sx	circ

We propose to drill and test the Abo and intermedidate formations. Approximately 850' of surface casing will be set and cement circulated to shut off gravel and caving. If needed (lost circulation) 8 5/8" intermediate casing will be run to 1500' and cemented with enough cement calculated to tie back into the surface casing. If commercial, production casing will be run and cemented with adequate cover, perforated and stimulated as needed for production.

MUD PROGRAM: FW gel/LCM to 1500', Brine to 3200', KCL/driskpak/starch to TD. MW 10-10.2, Vis 34-49, WL 14-7.

BOP PROGRAM: BOP's will be installed at offset and teted daily.

GAS NOT DEDICATED.

APPROVAL VALID FOR 180 DAYS
PERMIT EXPIRES 8-15-84
UNLESS DRILLING UNDERWAY

4. ABOVE SPACE DESCRIBE PROPOSED PROGRAM; IF PROPOSAL IS TO DEEPEN OR PLUG BACK, GIVE DATA ON PRESENT PRODUCTIVE ZONE AND PROPOSED NEW PRODUCTION ZONE. GIVE BLOWOUT PREVENTER PROGRAM, IF ANY.

I hereby certify that the information above is true and complete to the best of my knowledge and belief.

Signed Stewart Kobig Title Regulatory Agent Date 2/10/84

(This space for State Use)

APPROVED BY Mike Walker TITLE OIL AND GAS INSPECTOR DATE FEB 15 1984

CONDITIONS OF APPROVAL, IF ANY:

Post
FD 10-17-Book
2-17-84

NEW MEXICO OIL CONSERVATION COMMISSION
WELL LOCATION AND ACREAGE DEDICATION PLAT

Form C-102
Supersedes C-128
Effective 1-1-65

All distances must be from the outer boundaries of the Section.

Operator YATES PETROLEUM CORPORATION			Lease SNELL "QZ"		Well No. 1
Unit Letter C	Section 31	Township 6 South	Range 25 East	County Chaves	
Actual Footage Location of Well: 1980 feet from the West line and 660 feet from the North line					
Ground Level Elev. 3878.2	Producing Formation Abo		Pool Pecos Slope Abo		Dedicated Acreage: 160 Acres

1. Outline the acreage dedicated to the subject well by colored pencil or hachure marks on the plat below.
2. If more than one lease is dedicated to the well, outline each and identify the ownership thereof (both as to working interest and royalty).
3. If more than one lease of different ownership is dedicated to the well, have the interests of all owners been consolidated by communitization, unitization, force-pooling, etc?

☐ Yes ☐ No If answer is "yes," type of consolidation _____

If answer is "no," list the owners and tract descriptions which have actually been consolidated. (Use reverse side of this form if necessary.) _____

No allowable will be assigned to the well until all interests have been consolidated (by communitization, unitization, forced-pooling, or otherwise) or until a non-standard unit, eliminating such interests, has been approved by the Commission.

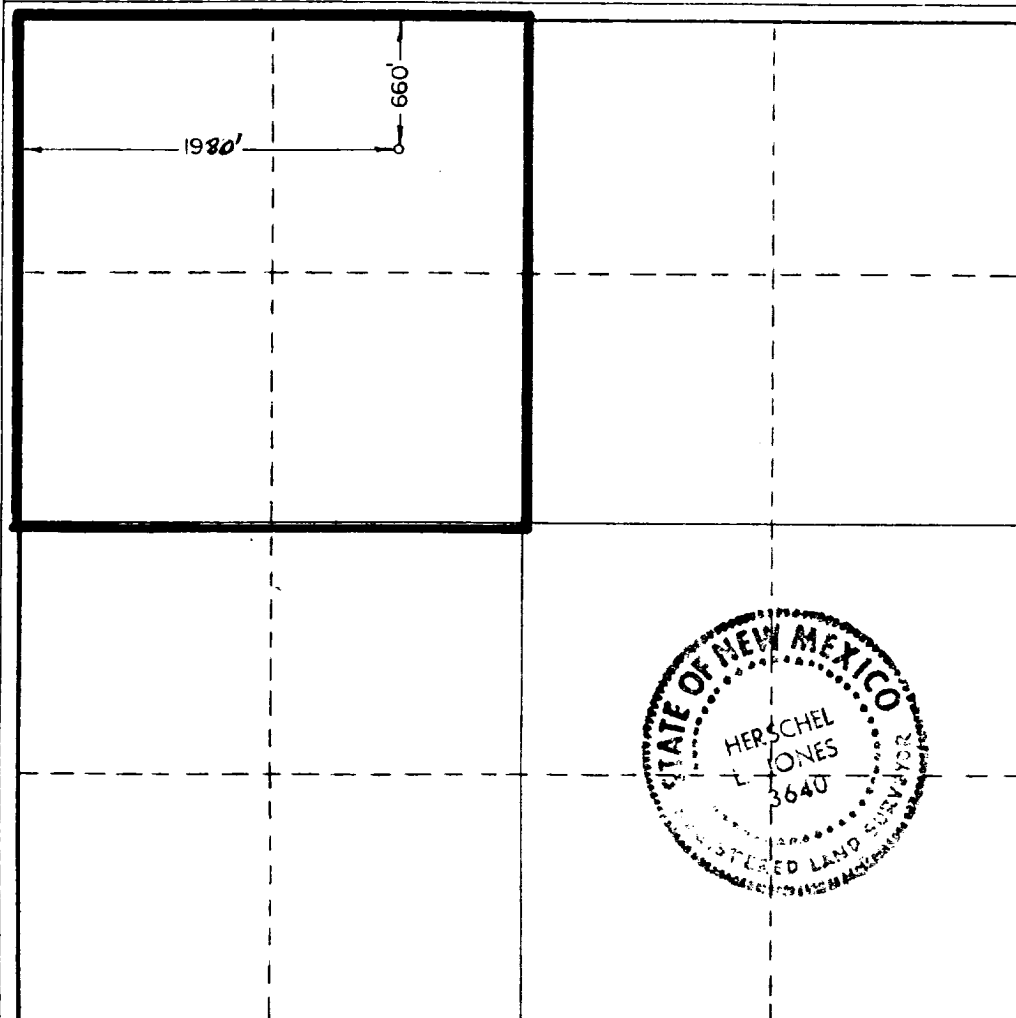

CERTIFICATION

I hereby certify that the information contained herein is true and complete to the best of my knowledge and belief.

Gliserio Rodriguez
Name

Gliserio Rodriguez

Position

Regulatory Agent

Company

Yates Petroleum Corp.

Date

2/10/84

I hereby certify that the well location shown on this plat was plotted from field notes of actual surveys made by me or under my supervision, and that the same is true and correct to the best of my knowledge and belief.

Date Surveyed

2/2/84

Registered Professional Engineer and/or Land Surveyor

Herschel L. Jones
Certificate No. 3640

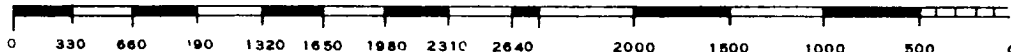

EXHIBIT B

BOP DIAGRAM

