

STATE OF NEW MEXICO  
ENERGY AND MINERALS DEPARTMENT

CONSERVATION DIVISION

P. O. BOX 2088  
SANTA FE, NEW MEXICO 87501

30-005-61033

Form C-101  
Revised 10-1-78

NO. OF COPIES RECEIVED	
DISTRIBUTION	
SANTA FE	1
FILL	1
U.S.G.S.	1
LAND OFFICE	1
OPERATOR	1

APPLICATION FOR PERMIT TO DRILL, DEEPEN, OR PLUG BACK

1a. Type of Work  
b. Type of Well  
OIL WELL ☒ GAS WELL ☐ OTHER ☐  
c. Name of Operator  
Stevens Operating Corporation  
d. Address of Operator  
P. O. Box 2203, Roswell, New Mexico 88201  
e. Location of Well  
UNIT LETTER M LOCATED 990 FEET FROM THE South LINE  
AND 330' FEET FROM THE West LINE OF SEC. 8 5 TWP. 9S RGE. 29E

5A. Indicate Type of Lease  
STATE ☐ FEDERAL ☒  
5. State Oil & Gas Lease No.  
7. Unit Agreement Name  
8. Farm or Lease Name  
O'Brien "FF"  
9. Well No.  
6  
10. Field and Pool or Wildcat  
Twin Lakes-San Andres Assoc.  
12. County  
Chaves

19. Proposed Depth  
2950'  
15A. Formation  
San Andres  
20. Rotary or C.T.  
Rotary  
21. Elevations (show whether DT, HT, etc.)  
3920.9 GR, 3925.9 KB  
21A. Kind & Status Plug. Bond  
Statewide  
21B. Drilling Contractor  
Artesia Fishing Tool  
22. Approx. Date Work will start  
8-15-81

PROPOSED CASING AND CEMENT PROGRAM

SIZE OF HOLE	SIZE OF CASING	WEIGHT PER FOOT	SETTING DEPTH	SACKS OF CEMENT	EST. TOP
12 1/4"	8 5/8"	20#	130'	75	Circ.
7 7/8"	4 1/2"	9.5#	2950'	200	2000

Will drill with water and mud to T. D., log, and if indicated productive, case to TD and perforate in producing intervals.

Adequate blowout preventers will be used.

APPROVAL VALID FOR 180 DAYS  
PERMIT EXPIRES 1-20-82  
UNLESS DRILLING UNDERWAY

IN ABOVE SPACE DESCRIBE PROPOSED PROGRAM; IF PROPOSAL IS TO DEEPEN OR PLUG BACK, GIVE DATA ON PRESENT PRODUCTIVE ZONE AND PROPOSED NEW PRODUCTIVE ZONE; GIVE BLOWOUT PREVENTER PROGRAM, IF ANY.

I hereby certify that the information above is true and complete to the best of my knowledge and belief.

Signed Richard G. Hutton Title President Date 7-16-81

(This space for State Use)

APPROVED BY W. A. Gressett TITLE SUPERVISOR, DISTRICT II DATE JUL 20 1981

CONDITIONS OF APPROVAL, IF ANY:

**N MEXICO OIL CONSERVATION COMMISS**  
**WELL LOCATION AND ACREAGE DEDICATION PLAT**

Form C-102  
 Supersedes C-128  
 Effective 1-1-65

All distances must be from the outer boundaries of the Section.

Operator <b>Stevens Operating Corporation</b> <del>Stevens Oil Co.</del>			Lease <b>O'Brien FF</b>		Well No. <b>6</b>
Unit Letter <b>M</b>	Section <b>8 5</b>	Township <b>9 South</b>	Range <b>29 East</b>	County <b>Chaves</b>	
Actual Footage Location of Well: <b>990</b> feet from the <b>south</b> line and <b>330</b> feet from the <b>west</b> line					
Ground Level Elev. <b>3920.9</b>	Producing Formation <b>San Andres</b>		Pool <b>Und Twin Lakes-San Andres Assoc.</b>	Dedicated Acreage: <b>40</b>	

1. Outline the acreage dedicated to the subject well by colored pencil or hachure marks on the plat below.
2. If more than one lease is dedicated to the well, outline each and identify the ownership thereof (both as to working interest and royalty).
3. If more than one lease of different ownership is dedicated to the well, have the interests of all owners been consolidated by communitization, unitization, force-pooling, etc?

☐ Yes ☐ No If answer is "yes;" type of consolidation \_\_\_\_\_

If answer is "no;" list the owners and tract descriptions which have actually been consolidated. (Use reverse side of this form if necessary.) \_\_\_\_\_

No allowable will be assigned to the well until all interests have been consolidated (by communitization, unitization, forced-pooling, or otherwise) or until a non-standard unit, eliminating such interests, has been approved by the Commission.

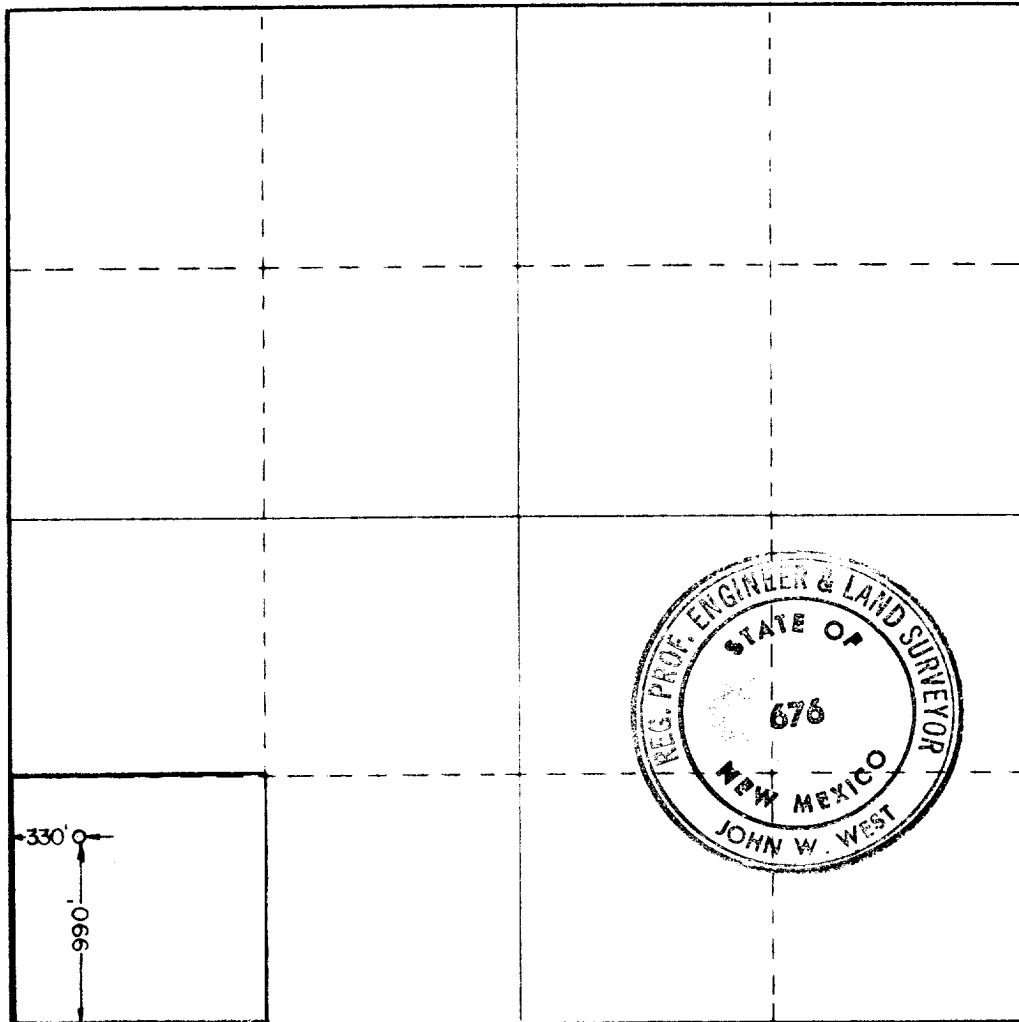

**CERTIFICATION**

I hereby certify that the information contained herein is true and complete to the best of my knowledge and belief

Name *Ronald J. Eidson*  
 Position **President**  
 Company **Stevens Operating Corporation**  
 Date **7-16-81**

I hereby certify that the well location shown on this plat was plotted from field notes of actual surveys made by me or under my supervision, and that the same is true and correct to the best of my knowledge and belief.

Date Surveyed **5-27-81**  
 Registered Professional Engineer and/or Land Surveyor  
*John W. West*  
 Certificate No. **JOHN W. WEST 676**  
**PATRICK A. ROMERO 6665**  
**Ronald J. Eidson 3239**