

STATE OF NEW MEXICO  
ENERGY AND MINERALS DEPARTMENT

WATER CONSERVATION DIVISION  
P. O. BOX 2088  
SANTA FE, NEW MEXICO 87501

30-005-61034  
Form C-101  
Revised 10-1-78

NO. OF COPIES RECEIVED	
DISTRIBUTION	
SANTA FE	
FILE	
U.S.G.S.	
LAND OFFICE	
OPERATOR	

JUL 9 1981

O. C. D.

ARTESIA OFFICE

APPLICATION FOR PERMIT TO DRILL, DEEPEN, OR PLUG BACK

Type of Work

DRILL ☒

DEEPEN ☐

PLUG BACK ☐

Type of Well

OIL WELL ☐

GAS WELL ☒

OTHER

SINGLE ZONE ☐

MULTIPLE ZONE ☐

Name of Operator

Yates Petroleum Corporation

Address of Operator

207 South 4th Street, Artesia, New Mexico 88210

Location of Well

UNIT LETTER K LOCATED 1980' FEET FROM THE South LINE

1980' FEET FROM THE West LINE OF SEC. 10 TWP. 9 RGE. 26 NMPM

5A. Indicate Type of Lease

STATE ☐

FEE ☒

5. State Oil & Gas Lease No.

7. Unit Agreement Name

8. Farm or Lease Name

McConkey HX

9. Well No.

2

10. Field and Pool, or Wildcat

Abo

12. County

Chaves

19. Proposed Depth

5230

19A. Formation

Abo

20. Rotary or C.T.

Rotary

Elevations (Show whether DF, KI, etc.)

3841.0

21A. Kind & Status Plug. Bond

Blanket

21B. Drilling Contractor

LaRue #2

22. Approx. Date Work will start

ASAP

PROPOSED CASING AND CEMENT PROGRAM

SIZE OF HOLE	SIZE OF CASING	WEIGHT PER FOOT	SETTING DEPTH	SACKS OF CEMENT	EST. TOP
12 1/2	8 5/8	24# K-55	Approx. 1550'	750 sx	Circulate
7 7/8	4 1/2	15.5 or 10.5#	TD 5230'	500 sx	

We propose to drill and test the Abo and intermediate formations. 8 5/8 casing will be run to a depth of 1550' circulated and cemented. If commercial, production casing will be run and cemented with adequate cover, perforate and stimulate as needed for production.

MUD PROGRAM: FW gel and LCM to 155', brine KCL to 3250', KCL drispak and starch to 4350', flosal-driskak KCL to TD. MW 10-10.2, Vis 34-39, WL 10-20.

BOP PROGRAM: BOP's will be installed on 8 5/8" casing and tested daily.

GAS NOT DEDICATED.

APPROVAL VALID FOR 180 DAYS  
PERMIT EXPIRES 1-20-82  
UNLESS DRILLING UNDERWAY

BOVE SPACE DESCRIBE PROPOSED PROGRAM: IF PROPOSAL IS TO DEEPEN OR PLUG BACK, GIVE DATA ON PRESENT PRODUCTIVE ZONE AND PROPOSED NEW PRODUCTIVE ZONE. GIVE BLOWOUT PREVENTER PROGRAM, IF ANY.

I hereby certify that the information above is true and complete to the best of my knowledge and belief.

By [Signature] Title Reg. Mgr. Date 7-9-81

(This space for State Use)

APPROVED BY W.A. Gressitt TITLE SUPERVISOR, DISTRICT II DATE JUL 20 1981

CONDITIONS OF APPROVAL, IF ANY:

# NEW MEXICO OIL CONSERVATION COMMISSION WELL LOCATION AND ACREAGE DEDICATION PLAT

Form C-102  
Supersedes C-128  
Effective 1-1-65

All distances must be from the outer boundaries of the Section.

Operator YATES PETROLEUM CORPORATION			Lease MCCONKEY "HX"		Well No. 2
Unit Letter K	Section 10	Township 9	Range 26	County CHAVES	
Actual Footage Location of Well: 1980' feet from the South line and 1980' feet from the West line					
Ground Level Elev. 3841.0	Producing Formation ABO		Pool UNDES. ABO	Dedicated Acreage: 160 Acres	

1. Outline the acreage dedicated to the subject well by colored pencil or hachure marks on the plat below.
2. If more than one lease is dedicated to the well, outline each and identify the ownership thereof (both as to working interest and royalty).
3. If more than one lease of different ownership is dedicated to the well, have the interests of all owners been consolidated by communitization, unitization, force-pooling, etc?

☐ Yes ☒ No If answer is "yes," type of consolidation \_\_\_\_\_

If answer is "no," list the owners and tract descriptions which have actually been consolidated. (Use reverse side of this form if necessary.) \_\_\_\_\_

No allowable will be assigned to the well until all interests have been consolidated (by communitization, unitization, forced-pooling, or otherwise) or until a non-standard unit, eliminating such interests, has been approved by the Commission.

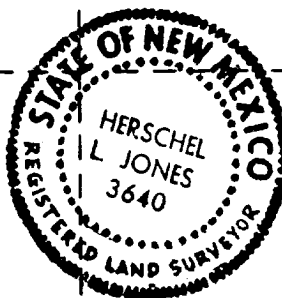
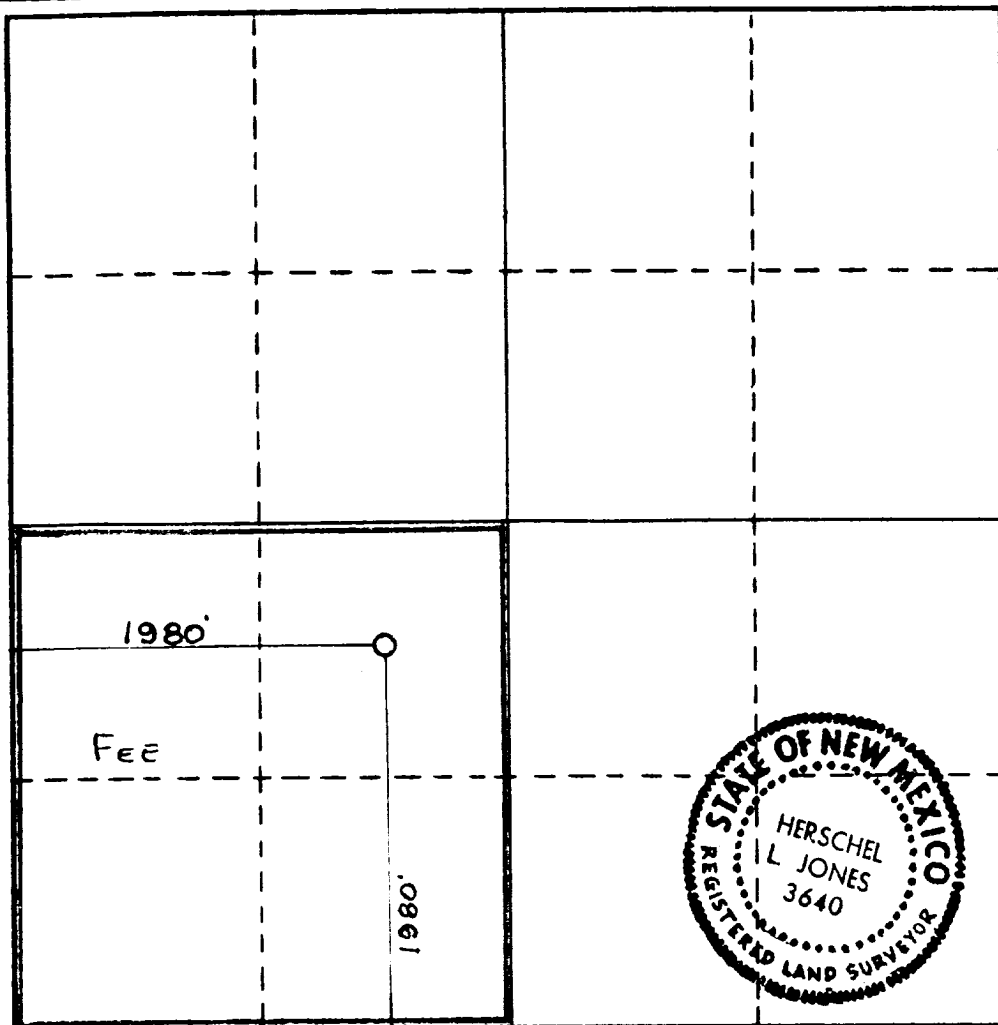

## CERTIFICATION

I hereby certify that the information contained herein is true and complete to the best of my knowledge and belief.

*Gilberto Rodriguez*  
Name

*Regulatory Mgr.*  
Position

*Yates Petroleum Corp.*  
Company

*7-6-81*  
Date

*7-6-81*  
Date

I hereby certify that the well location shown on this plat was plotted from field notes of actual surveys made by me or under my supervision, and that the same is true and correct to the best of my knowledge and belief.

July 8, 1981

Date Surveyed

Registered Professional Engineer and/or Land Surveyor

*Herschel L. Jones*  
Certificate No.

3640

0 330 660 990 1320 1650 1980 2310 2640 2970 3300 3630 3960 4290 4620 4950 5280 5610 5940 6270 6600

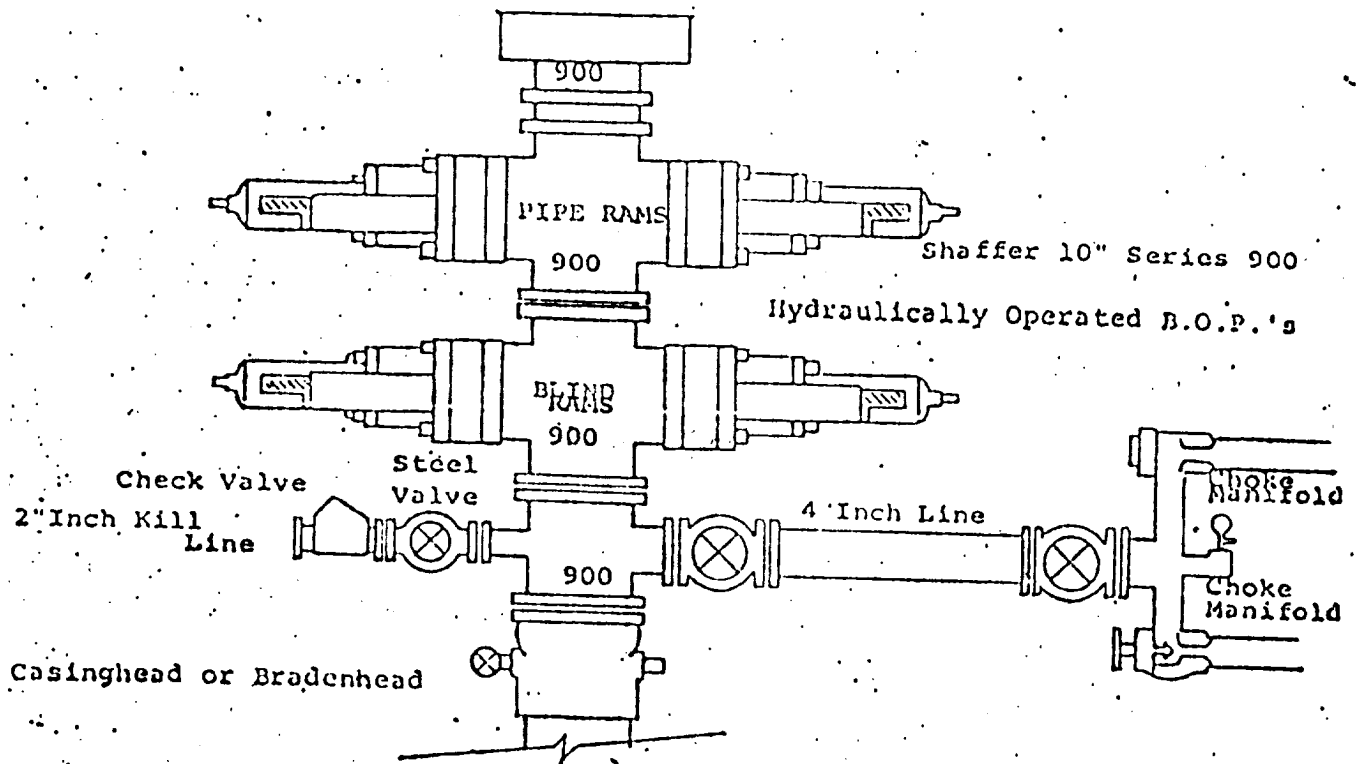

THE FOLLOWING CONSTITUTE MINIMUM BLOWOUT PREVENTER REQUIREMENTS

1. All preventers to be hydraulically operated with secondary manual controls installed prior to drilling out from under casing.
2. Choke outlet to be a minimum of 4" diameter.
3. Kill line to be of all steel construction of 2" minimum diameter.
4. All connections from operating manifolds to preventers to be all steel. hole or tube a minimum of one inch in diameter.
5. The available closing pressure shall be at least 15% in excess of that required with sufficient volume to operate the B.O.P.'s.
6. All connections to and from preventer to have a pressure rating equivalent to that of the B.O.P.'s.
7. Inside blowout preventer to be available on rig floor.
8. Operating controls located a safe distance from the rig floor.
9. Hole must be kept filled on trips below intermediate casing. Operator not responsible for blowouts resulting from not keeping hole full.
10. D. P. float must be installed and used below zone of first gas intrusion.