

CO. OF COPIES RECEIVED	
DISTRIBUTION	
SANTA FE	1
FILE	2
U.S.G.S.	
LAND OFFICE	
OPERATOR	1

AUG 24 1981

O. C. D.

ARTESIA, OFFICE

APPLICATION FOR PERMIT TO DRILL, DEEPEN, OR PLUG BACK

a. Type of Work DRILL <input checked="" type="checkbox"/> DEEPEN <input type="checkbox"/> PLUG BACK <input type="checkbox"/>		5A. Indicate Type of Lease STATE <input type="checkbox"/> FEE <input checked="" type="checkbox"/>	
b. Type of Well OIL WELL <input checked="" type="checkbox"/> GAS WELL <input type="checkbox"/> OTHER <input type="checkbox"/>		6. State Oil & Gas Lease No.	
c. Name of Operator Stevens Operating Corporation ✓		7. Unit Agreement Name	
d. Address of Operator P. O. Box 2203, Roswell, New Mexico 88201		8. Term of Lease Name O'Brien "D"	
e. Location of Well UNIT LETTER A LOCATED 330 FEET FROM THE North LINE 990 FEET FROM THE East LINE OF SEC. 12 TWP. 9S R. 28E		9. Well No. No. 3	
f. 10. Field and Prod. or Well Seat Twin Lakes-San Andres Assoc.		11. County Chaves	
12. Proposed Depth 2950'		13. Formation San Andres	
14. Drilling Contractor Artesia Fishing Tool		15. Date Work will start 8-24-81	
16. Interventions (Show whether Dr., H.I., etc.) 3951.15 GR, 3956.15 KB		17. Approx. Date Work will start	

PROPOSED CASING AND CEMENT PROGRAM

SIZE OF HOLE	SIZE OF CASING	WEIGHT PER FOOT	SETTING DEPTH	SACKS OF CEMENT	EST. TOP
12 1/4	8 5/8"	20#	130'	75	Circ.
7 7/8	4 1/2"	9.5#	2950'	200	2000

Will drill with water and mud to T.D., log, and if indicated productive, case to T.D. and perforate in producing intervals.

Adequate blowout preventers will be used.

Noted ID-1
P-2 + 10-1
8-28-81

APPROVAL VALID FOR 180 DAYS
PERMIT EXPIRES 2-25-82
UNLESS DRILLING UNDERWAY

ABOVE SPACE DESCRIBE PROPOSED PROGRAM; IF PROPOSAL IS TO DEEPEN OR PLUG BACK, GIVE DATA ON PRESENT PRODUCTIVE ZONE AND PROPOSED NEW PRODUCTIVE ZONE. GIVE BLOWOUT PREVENTER PROGRAM, IF ANY.

I hereby certify that the information above is true and complete to the best of my knowledge and belief.

Signed Donald G. Allen Title President Date 8-17-81

(This space for State Use)

APPROVED BY W. A. Grossert TITLE SUPERVISOR, DISTRICT II DATE AUG 25 1981

CONDITIONS OF APPROVAL, IF ANY:

**NEW MEXICO OIL CONSERVATION COMMISSION
WELL LOCATION AND ACREAGE DEDICATION PLAT**

Form C-102
Supersedes C-128
Effective 1-1-65

All distances must be from the outer boundaries of the Section.

Operator Stevens Operating Corporation Stevens Oil Company		Lease O'Brien D		Well No. 3
Unit Letter A	Section 12	Township 9S	Range 28E	County Chaves
Actual Footage Location of Well: <div style="display: flex; justify-content: space-between;"> 330 feet from the North line and 990 feet from the East line </div>				
Ground Level Elev. 3951.15	Producing Formation San Andres	Pool Twin Lakes-San Andres Assoc.	Dedicated Acreage: 40 Acres	

1. Outline the acreage dedicated to the subject well by colored pencil or hachure marks on the plat below.
2. If more than one lease is dedicated to the well, outline each and identify the ownership thereof (both as to working interest and royalty).
3. If more than one lease of different ownership is dedicated to the well, have the interests of all owners been consolidated by communitization, unitization, force-pooling, etc?

☐ Yes ☐ No If answer is "yes," type of consolidation _____

If answer is "no," list the owners and tract descriptions which have actually been consolidated. (Use reverse side of this form if necessary.) _____

No allowable will be assigned to the well until all interests have been consolidated (by communitization, unitization, forced-pooling, or otherwise) or until a non-standard unit, eliminating such interests, has been approved by the Commission.

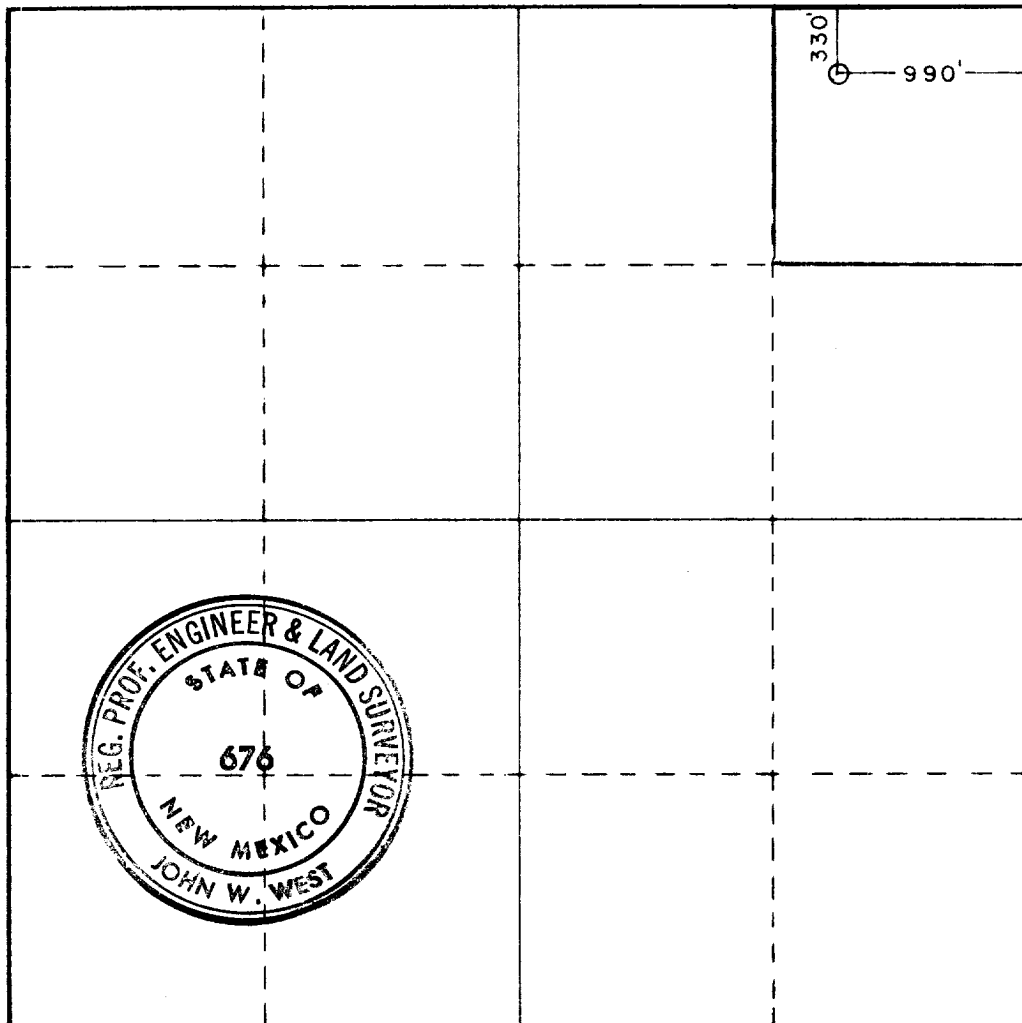

CERTIFICATION

I hereby certify that the information contained herein is true and complete to the best of my knowledge and belief.

Name _____
 Position _____
President
 Company _____
Stevens Operating Corporation

Date _____
8-17-81

I hereby certify that the well location shown on this plat was plotted from field notes of actual surveys made by me or under my supervision, and that the same is true and correct to the best of my knowledge and belief.

November 10, 1980

Date Surveyed _____

Registered Professional Engineer and/or Land Surveyor

Certificate No. **JOHN W. WEST 676**
PATRICK A. ROMERO 6668
Ronald J. Eidson 3239

