

NO. OF COPIES RECEIVED	5
DISTRIBUTION	
SANTA FE	1
FILE	1
U.S.G.S.	2
LAND OFFICE	
OPERATOR	1

NEW MEXICO OIL CONSERVATION COMMISSION

RECEIVED

AUG 31 1981

O. C. D.

ARTESIA OFFICE

Form C-101
Revised 1-1-65

5A. Indicate Type of Lease

STATE ☐ FEE ☒

5. State Oil & Gas Lease No.

APPLICATION FOR PERMIT TO DRILL, DEEPEN, OR PLUG BACK

1a. Type of Work		7. Unit Agreement Name	
b. Type of Well DRILL <input checked="" type="checkbox"/> DEEPEN <input type="checkbox"/> PLUG BACK <input type="checkbox"/> OIL WELL <input checked="" type="checkbox"/> GAS WELL <input type="checkbox"/> OTHER <input type="checkbox"/> SINGLE ZONE <input checked="" type="checkbox"/> MULTIPLE ZONE <input type="checkbox"/>		8. Farm or Lease Name Amonett	
2. Name of Operator Tom L. Ingram		9. Well No. 1-Y	
3. Address of Operator P.O.Box 1757, Roswell, New Mexico 88201		10. Field and Pool, or Wildcat * Wildcat-San Andres	
4. Location of Well UNIT LETTER H LOCATED 2030 FEET FROM THE North LINE AND 660 FEET FROM THE East LINE OF SEC. 21 TWP. 7-S RGE. 28-E NMPM		12. County Chaves	
19. Proposed Depth 2600		19A. Formation San Andres	
20. Rotary or C.T. Rotary		21. Elevations (Show whether DF, RT, etc.) GR. 3971.4	
21A. Kind & Status Plug. Bond State wide		21B. Drilling Contractor Bantam Drilling Co.	
22. Approx. Date Work will start 9-1-81			

23.

PROPOSED CASING AND CEMENT PROGRAM

SIZE OF HOLE	SIZE OF CASING	WEIGHT PER FOOT	SETTING DEPTH	SACKS OF CEMENT	EST. TOP
12-1/4	8-5/8	20	400	200	circ
7-7/8	4-1/2	9.5	2600	150	

Propose to move 50' south of No. 1 because of junked hole (1119' of drill collars, drill pipe and bit in hole).

Drill to TD, log, case, cement, perforate, stimulate and complete.

APPROVAL DATE 8-18-81
PERMIT EXPIRES 3-3-82
UNLESS DRILLING UNDERWAY

IN ABOVE SPACE DESCRIBE PROPOSED PROGRAM: IF PROPOSAL IS TO DEEPEN OR PLUG BACK, GIVE DATA ON PRESENT PRODUCTIVE ZONE AND PROPOSED NEW PRODUCTIVE ZONE. GIVE BLOWOUT PREVENTER PROGRAM, IF ANY.

I hereby certify that the information above is true and complete to the best of my knowledge and belief.

Signed Joseph L. Ingram Title Engineer Date 8-28-81
(This space for State Use)

APPROVED BY W. A. Gressett TITLE SUPERVISOR, DISTRICT II DATE SEP 3 1981

CONDITIONS OF APPROVAL, IF ANY:

NEW MEXICO OIL CONSERVATION COMMISSION
WELL LOCATION AND ACREAGE DEDICATION PLAT

Form O-111
Supersedes O-101
Effective 1-1-77

All distances must be from the outer boundaries of the Section.

Tom L. Ingram			Amonett		Well No. 1-Y
Section	Township	Range	County		
H	21	7-S	28-E Chaves		
Actual Footage Location of Well:					
1900 2030 feet from the NORTH line and		660	feet from the EAST line		
Ground Level Elev.	Producing Formation	Prod.	Dedicated Acreage:		
3971.4	San Andres	Wildcat	40 Acres		

1. Outline the acreage dedicated to the subject well by colored pencil or hachure marks on the plat below.
2. If more than one lease is dedicated to the well, outline each and identify the ownership thereof (both as to working interest and royalty).
3. If more than one lease of different ownership is dedicated to the well, have the interests of all owners been consolidated by communitization, unitization, force-pooling, etc?

☐ Yes ☐ No If answer is "yes," type of consolidation _____

If answer is "no," list the owners and tract descriptions which have actually been consolidated. (Use reverse side of this form if necessary.) _____

No allowable will be assigned to the well until all interests have been consolidated (by communitization, unitization, forced-pooling, or otherwise) or until a non-standard unit, eliminating such interests, has been approved by the Commission.

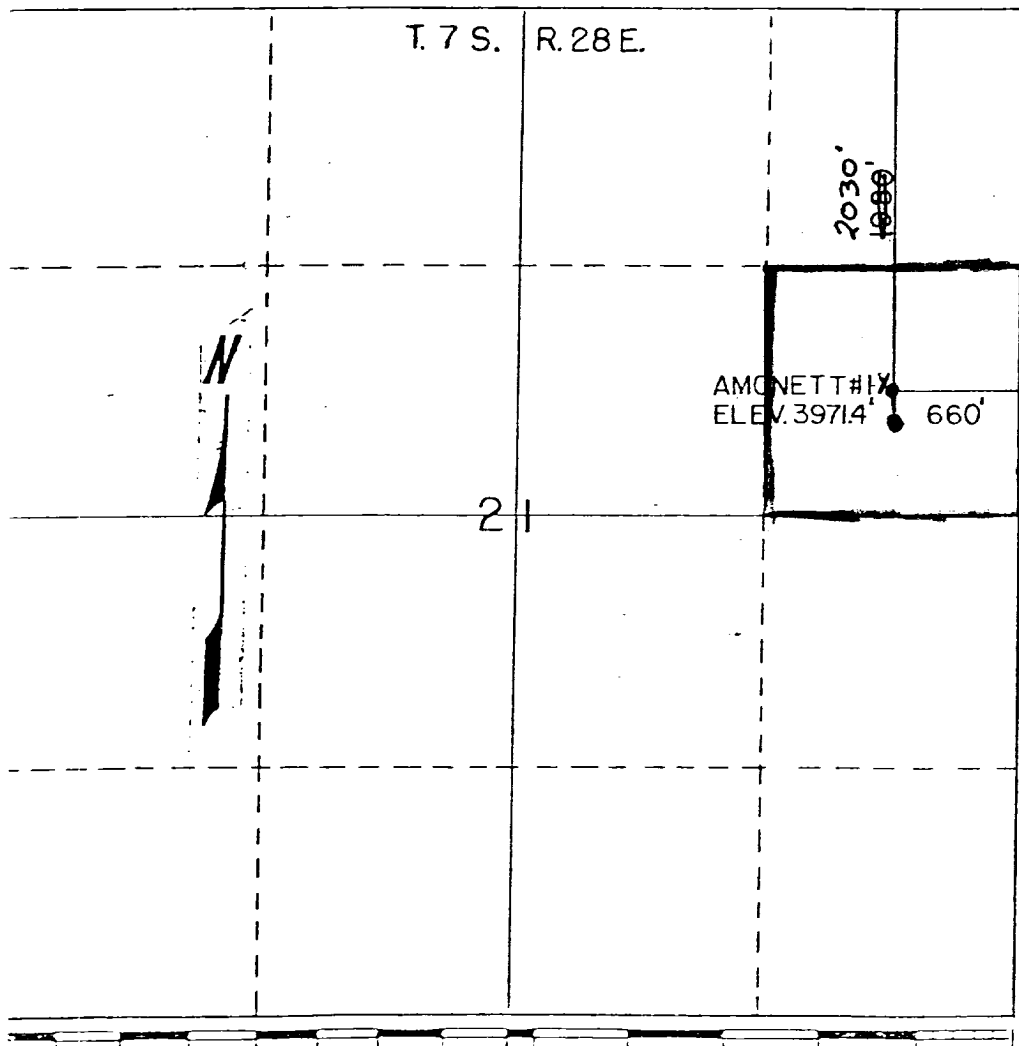

CERTIFICATION	
I hereby certify that the information contained herein is true and complete to the best of my knowledge and belief.	
Name	Tom L. Ingram
Position	Operator
Company	Tom L. Ingram
Date	6-29-81 8-28-81
I hereby certify that the well location shown on this plat was plotted from field notes of actual surveys made by me or under my supervision and that the same is true and correct to the best of my knowledge and belief.	
Date Surveyed	6-26-81
Registered Professional Engineer and/or Land Surveyor	THOMAS T. MANN
Thomas T. Mann, P.E. & L.S. N.M. License No. 277	