

NM OFF. CONS. COMMISSION
Drawn **DD**
Artesia, NM 88210
UNITED STATES
DEPARTMENT OF THE INTERIOR
GEOLOGICAL SURVEY

SUBMIT IN TRIPLICATE
(Other 1. 2. 3. on reverse side)

Form 10-1-10
Budget Edition No. 42 H1425

30-005-61126

APPLICATION FOR PERMIT TO DRILL, DEEPEN, OR PLUG BACK

1a. TYPE OF WORK DRILL <input checked="" type="checkbox"/> DEEPEN <input type="checkbox"/> PLUG BACK <input type="checkbox"/>		5. LEASE DESIGNATION AND SERIAL NO. NM 022584
b. TYPE OF WELL OIL WELL <input type="checkbox"/> GAS WELL <input checked="" type="checkbox"/> OTHER <input type="checkbox"/>		6. IF INDIAN, ALLOTTEE OR TRIBE NAME --
2. NAME OF OPERATOR STEVENS OPERATING CORPORATION (Ph. 505-622-7273)		7. UNIT AGREEMENT NAME --
3. ADDRESS OF OPERATOR P. O. Box 2203, Roswell, New Mexico 86201		8. FARM OR LEASE NAME SUN FEDERAL
4. LOCATION OF WELL (Report location clearly and in accordance with any State requirements) At Surface 660' FSL & 660' FEL Sec. 29-7S-26E At proposed prod. zone same		9. WELL NO. 2
14. DISTANCE IN MILES AND DIRECTION FROM NEAREST TOWN OR POST OFFICE* 22 air miles northeast of Roswell, N. M.		10. FIELD AND POOL, OR WILDCAT Wildcat Abo
15. DISTANCE FROM PROPOSED* LOCATION TO NEAREST PROPERTY OR LEASE LINE, FT. (Also to nearest drlg. unit line, if any) 660'		11. SEC., T., R., M., OR BLK. AND SURVEY OR AREA UL-P Sec. 29-7S-26E
16. NO. OF ACRES IN LEASE 1160		12. COUNTY OR PARISH Chaves
17. NO. OF ACRES ASSIGNED TO THIS WELL 160		13. STATE N. M.
18. DISTANCE FROM PROPOSED* LOCATION TO NEAREST WELL, DRILLING, COMPLETED, OR APPLIED FOR, ON THIS LEASE, FT. 462'		19. PROPOSED DEPTH 4300' Abo
20. ROTARY OR CABLE TOOLS Rotary		21. APPROX. DATE WORK WILL START* Dirt Spud 9-18-81 9-21-81
21. ELEVATIONS (Show whether DF, RT, GR, etc.) 3668 G.L.		

PROPOSED CASING AND CEMENTING PROGRAM

SIZE OF HOLE	SIZE OF CASING	WEIGHT PER FOOT	SETTING DEPTH	QUANTITY OF CEMENT
14 3/4"	10 3/4"	32.75#	900'	Sufficient to circulate
9 7/8"	*	*	1600'	*
7 7/8"	4 1/2"	9.50#	4300'	250 sacks.

* If circulation cannot be maintained while drilling the 9 7/8" hole to 1600', 8 5/8" (24#) intermediate casing will be cemented at 1600' with 200 sacks of cement.

After setting and cementing production string, pay zones will be perforated and stimulated as needed for production.

Attached are: 1. Well Location & Acreage Dedication Plat.
2. Supplemental Drilling Data.
3. Surface Use Plan.

Gas is not dedicated.

IN ABOVE SPACE DESCRIBE PROPOSED PROGRAM: If proposal is to deepen or plug back, give data on present productive zone and proposed new productive zone. If proposal is to drill or deepen directionally, give pertinent data on subsurface locations and measured and true vertical depths. Give blowout preventer program, if any.

24. SIGNED Pat Thompson TITLE Production Clerk DATE Sept. 16, 1981
(This space for Federal or State office use)

PERMIT NO. APPROVED	APPROVAL DATE
APPROVED BY (Orig. Sgd.) GEORGE H. STEWART	TITLE
CONDITIONS OF APPROVAL SEP 18 1981	DATE
FOR JAMES A. GILHAM DISTRICT SUPERVISOR	

*See Instructions On Reverse Side

Journal of Management Education 30(6)

STEVENS OPERATING CORPORATION		SUN-FIELD.	
P	19	7 SOUTH	28 EAST
660		660	660
3668 GL	Abo	Wildcat	160

1. Outline the acreage indicated to the subject well by colored pencil or highlight marks on the plat below.
2. If more than one lease is indicated to the well, outline each and identify the ownership thereof (that is to wit, the interest and royalty).

If more than one lease of different ownership is dedicated to the well, have the interests of all owners been represented by communitization, unitization, force-pooling, etc?

Yes ☐ No ☒ If answer is "yes" type of consolidation _____

If answer is "no," list the owners and tract descriptions which have actually been consipated. If so reverse page of this form if necessary.

3. allowable will be assigned to the well until all interests have been consolidated, by communitization, unitization, or pooled-pooling, or otherwise, or until a non-standard unit, eliminating such interests, has been approved by the Commission.

CERTIFICATION

I hereby certify that the information contained herein is true and complete to the best of my knowledge and belief.

Test of my knowledge and belief

Jan. 1900

James A. Knauf

Agent

Stevens Operating Corporation

9-16-81

I hereby certify that the well shown shown on this plan was plotted from the lines of actual surveys made by me or under my supervision and that the same is true and correct to the best of my knowledge and belief.

9-15-61

Variable	Mean	Standard Deviation	Minimum	Maximum	Skewness	Kurtosis	Normality Test
Age	35.5	10.5	20	55	0.5	3.0	0.95
Gender	1.5	0.5	1	2	0.0	0.0	0.99
Marital Status	1.5	0.5	1	2	0.0	0.0	0.99
Education	15.5	2.5	10	20	0.5	3.0	0.95
Income	1000	200	500	1500	0.5	3.0	0.95
Health	1.5	0.5	1	2	0.0	0.0	0.99
Stress	2.5	1.0	1	4	0.5	3.0	0.95
Life Satisfaction	3.5	1.0	1	5	0.5	3.0	0.95

12

1990

SUPPLEMENTAL DRILLING DATA

STEVENS OPERATING CORPORATION
WELL #2 SUN FEDERAL
SE $\frac{1}{4}$ SE $\frac{1}{4}$ SEC. 29-7S-26E
CHAVES COUNTY, NEW MEXICO

1. SURFACE FORMATION: Permian (Artesia Group).

2. ESTIMATED TOPS OF GEOLOGIC MARKERS:

Queen	150'	Glorietta	1800'
San Andres	600'	Abo	3850'

3. ANTICIPATED POROSITY ZONES:

Water	60'
Oil	1100'
Gas	3950'

4. CASING DESIGN:

<u>Size</u>	<u>Interval</u>	<u>Weight</u>	<u>Grade</u>	<u>Joint</u>	<u>Condition</u>
10 3/4"	0 - 900'	32.75#	K-55	STC	New
8 5/8"	0 - 1600'	24.0 #	K-55	STC	New
4 1/2"	0 - 4300'	9.5 #	K-55	STC	New

5. SURFACE CONTROL EQUIPMENT: A double ram-type preventer (900 series).
A sketch of BOP stack is attached.

6. CIRCULATING MEDIUM:

0 - 900'	Fresh water mud with gel added if needed for viscosity.
900 - TD	Salt water mud, conditioned as necessary for control of viscosity and water loss.

7. AUXILIARY EQUIPMENT: Drill string safety valve.

8. TESTING, LOGGING AND CORING PROGRAMS:

DST's:	As warranted.
Coring:	None Planned.
Logging:	A compensated Neutron/Formation Density Log w/Gamma Ray and a Dual Laterolog/Micro-Spherically Focused Log.

9. ABNORMAL PRESSURES, TEMPERATURES OR GASES: None anticipated.

10. ANTICIPATED DATES: It is planned that drilling operations will commence about September 28, 1981. Duration of drilling and completion operations should be 20 to 60 days.

BLOWOUT PREVENTER SKETCH

Stevens Operating Corporation
Well #2 Sun Federal
660' FSL & 660' FEL Sec. 29-7S-26E

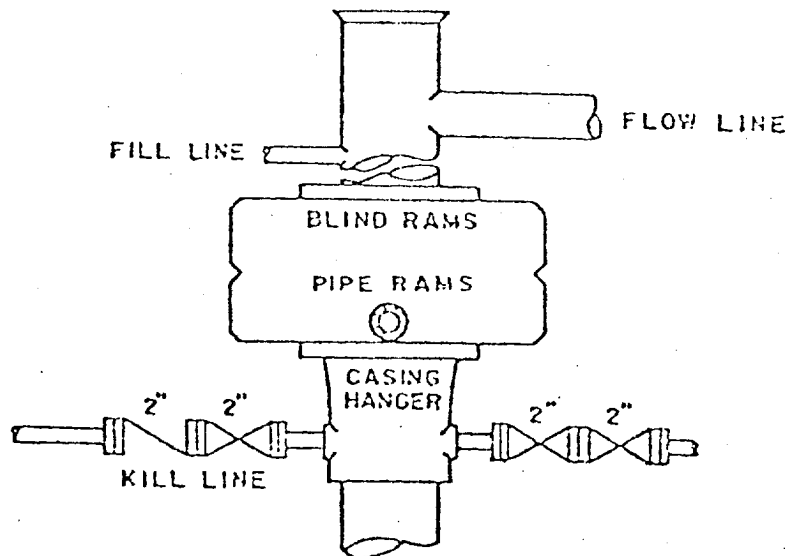

DUAL RAM-TYPE PREVENTER

900 Series

SURFACE USE PLAN

FOR

DRILLING, COMPLETING AND PRODUCING

STEVENS OPERATING CORPORATION
WELL #2 SUN FEDERAL
660' FSL & 660' FEL SEC. 29-7S-26E
CHAVES COUNTY, NEW MEXICO

LOCATED: 22 air miles northeast of Roswell, New Mexico.

FEDERAL LEASE NUMBER: NM 022584

LEASE ISSUED: 6-1-56 for a primary term of 5 years and is in its extended term by production.

RECORD LESSEE: Sun Oil Company

OPERATOR'S AUTHORITY: Designation of Operator from lessee.

BOND COVERAGE: Sun's \$150,000 nation-wide bond.

ACRES IN LEASE: 1160

SURFACE OWNERSHIP: Federal

GRAZING PERMITTEE: H. F. Atkins
Telephone 505-622-2714
Roswell, New Mexico 88201

WELL SPACING: Wildcat. (160-acre spacing for Abo gas.)

EXHIBITS:

- A. County Road Map
- B. Topographic Map
- C. Oil & Gas Map
- D. Sketch of Well Pad

ROAD LOG TO PROPOSED DRILLSITE

STARTING POINT is 16 miles northeast of Roswell, New Mexico on US-70 at Mile Post 352.5. This point is at the old Acme School House Ruin which is 14.12 miles east of US-285.

- 0.00 Turn left (north) through the cattleguard and proceed on county road in a northerly direction for a distance of 5.56 miles to a cattleguard.
- 5.56 Cross cattleguard and continue straight ahead for a distance of 0.10 mile.
- 5.66 Turn left (west) and proceed on old lease road for a distance of 0.47 mile to the south edge of well pad of Well #1 Sun Federal (NE-SE-SE 29-7S-26E).
- 6.13 New road will start at this point. Continue in a south-southwest direction for a distance of 0.06 mile to the southeast corner of proposed well pad.
- 6.19 DRILLSITE (Well #2 Sun Federal).

THIRTEEN POINT PROGRAM

- 1. EXISTING ROADS: Existing roads, which lead to the proposed drillsite, are shown on Exhibits "A" & "B".
- 2. PROPOSED NEW ROAD: Proposed new access road will be 0.06 mile in length. The proposed route, which will originate at mileage 6.13 on the road log and terminate at the southeast corner of the proposed well pad, is shown on Exhibit "B". The proposed location of this new road has been staked and flagged.
 - A. Width: 15 feet with 20 feet R-O-W.
 - B. Surfacing Material: Only material from the roadway will be used for surfacing the new road.
 - C. Road Design: Road construction will consist of blading the proposed roadway and leaving a slight crown down the middle.
 - D. Turnouts: None necessary.

- E. Culverts: None necessary.
- F. Gates, Cattleguards: None necessary.
- 3. LOCATION OF EXISTING WELLS:
 - A. Existing wells in the vicinity of the proposed drillsite are shown on Exhibit "C".
- 4. LOCATION OF EXISTING AND/OR PROPOSED FACILITIES:
 - A. Operator has oil production facilities located on the old well pad.
 - B. If the proposed well is productive, production and storage facilities will be located on the new well pad.
- 5. LOCATION AND TYPE OF WATER SUPPLY:
 - A. It is not planned to drill a water supply well. Water for leasehold operations will be purchased from the nearest commercial source.
- 6. SOURCE OF CONSTRUCTION MATERIALS:
 - A. Material-in-place will be used for construction of the road and well pad.
- 7. METHODS OF HANDLING WASTE DISPOSAL:
 - A. Drill cuttings will be disposed of in the drilling pits.
 - B. Drilling fluids will be allowed to evaporate in the drilling pits until the pits are dry.
 - C. Water produced during tests will be disposed of in the drilling pits.
 - D. Oil produced during tests will be produced into temporary test tanks.
 - E. Trash, waste paper, garbage, and junk will be buried in a trash pit and covered with a minimum of 24 inches of dirt. All waste material will be contained to prevent scattering by the wind. Location of the trash pit is shown on Exhibit "D".
 - F. All trash and debris will be buried or removed from the wellsite within 30 days after finishing each drilling and/or completion operation.

8. ANCILLARY FACILITIES:

- A. None anticipated.

9. WELLSITE LAYOUT:

- A. The wellsite has been surveyed and a 400' x 400' area has been staked and flagged.
- B. The dimensions and relative location of the drill pad, mud pit, and trash pit with respect to the well bore are shown on Exhibit "D".
- C. The well pad is nearly level and will hardly require any cut or fill.
- D. The well pad will not be surfaced with any foreign material but will be constructed from material-in-place.

10. PLANS FOR RESTORATION OF THE SURFACE:

- A. After completion of drilling and/or completion operations, all equipment and other material not needed for operations will be removed. Pits will be filled and the location cleaned of all trash and junk to leave the wellsite in as aesthetically pleasing condition as possible.
- B. Any unguarded pits containing fluids will be fenced until they are filled.
- C. After abandonment, all equipment, trash and junk will be removed and the location cleaned. Any special rehabilitation and/or revegetation requirements of the surface management agency will be complied with and accomplished as expeditiously as possible.

11. OTHER INFORMATION:

- A. Topography: The terrain of the drillsite area is nearly level. Regional slope is to the west toward the Pecos River.
- B. Soil: Top soil is gypsy loam.
- C. Flora & Fauna: The vicinity surrounding the drillsite is semi-arid desert rangeland. Vegetative cover is very sparse. Flora consists primarily of broomweed and range grasses interspersed with mesquite, yucca and other desert plants. The only wildlife observed were lizards and rabbits; however, fauna for this type of habitat also includes snakes, rodents, skunks, coyotes, dove, quail and other small birds.

- D. Ponds & Streams: None. Pecos River is $\frac{1}{2}$ mile to the west.
- E. Residences & Other Structures: Nearest occupied dwelling is 2 miles to the north. Nearest water well is one mile to the north.
- F. Archaeological, Historical & Other Cultural Sites: An archaeological reconnaissance of the well pad and new road area was made by Agency for Conservation Archaeology (ENMU) on 9-15-81 and no significant artifacts were observed.
- G. Land Use: Grazing and occasional hunting.

12. OPERATOR'S REPRESENTATIVE:

Representative responsible for assuring compliance with the approved Surface Use Plan:

Pat Thompson
Production Clerk
118 W. First
Roswell, New Mexico 88201
Office phone 622-7273
Home phone 622-1082

13. CERTIFICATION:

I hereby certify that I, or persons under my direct supervision, have inspected the proposed drillsite and access route; that I am familiar with the conditions which presently exist; that the statements made in this plan are, to the best of my knowledge true and correct; and, that the work associated with the operations proposed herein will be performed by STEVENS OPERATION CORPORATION and its sub-contractors in conformity with this plan and the terms and conditions under which it is approved.

9-16-81

Date

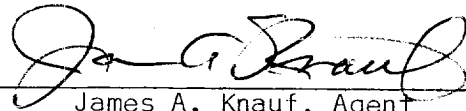

James A. Knauf, Agent
STEVENS OPERATING CORPORATION

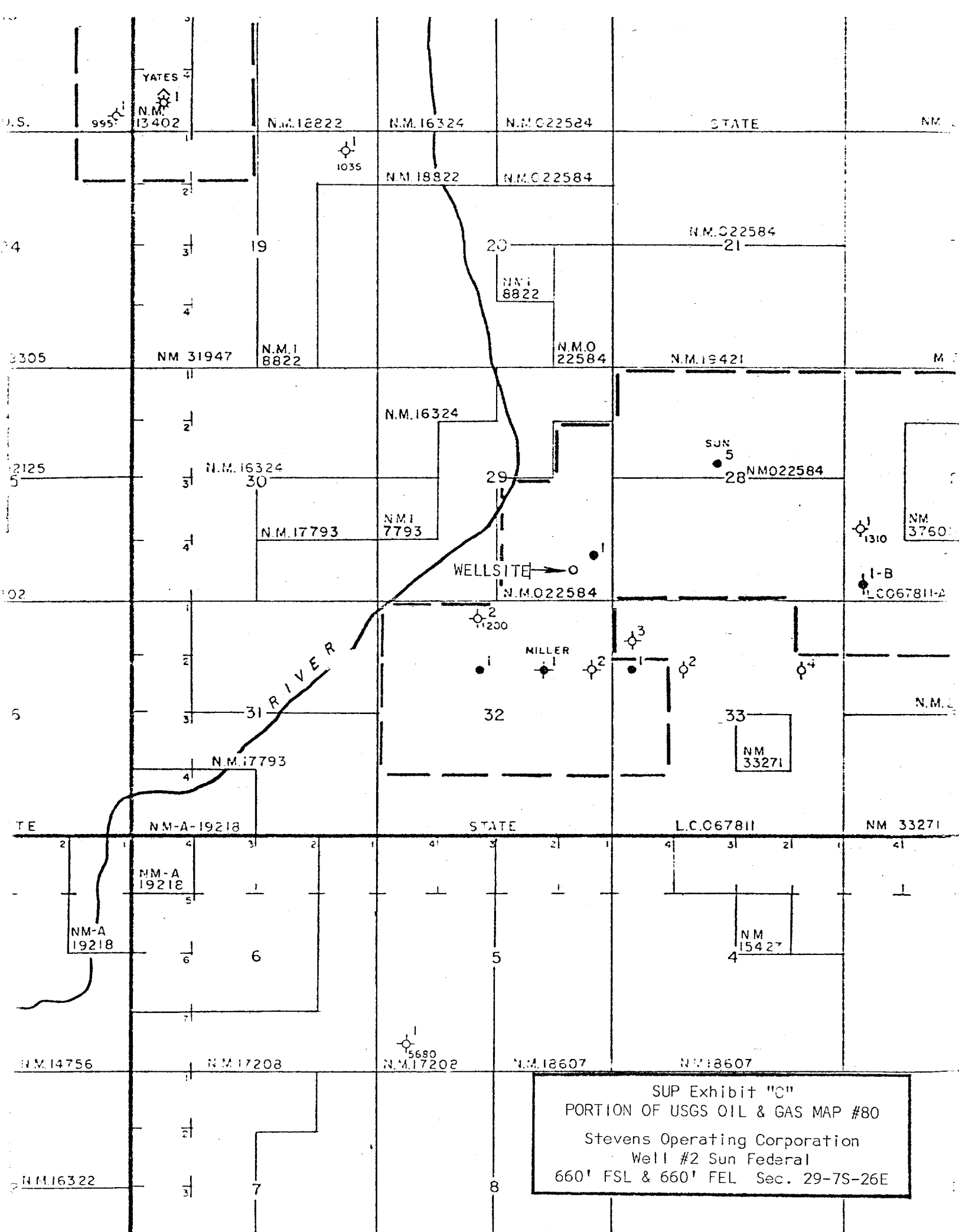

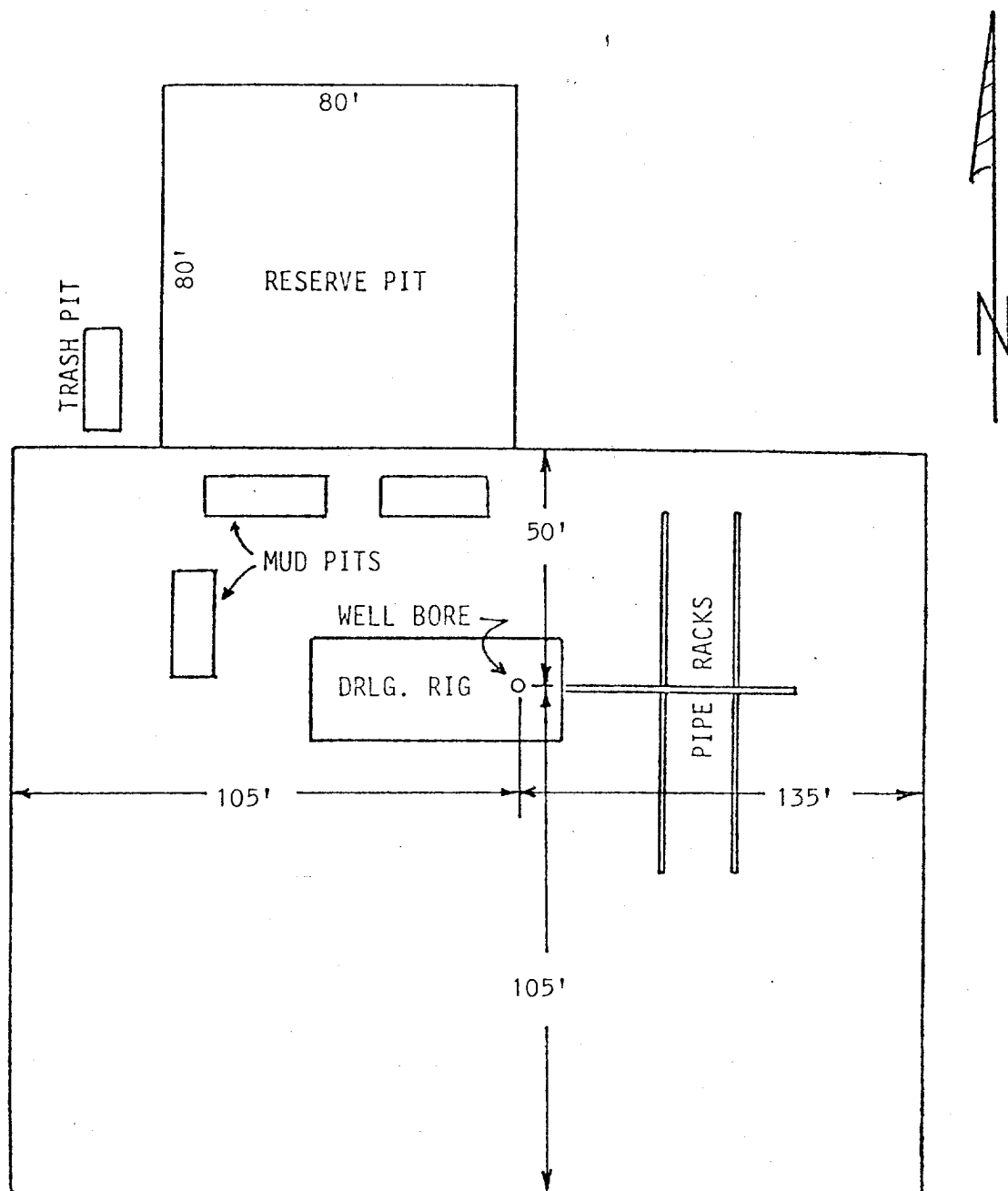

SUP Exhibit "D"
 SKETCH OF WELL PAD
 Stevens Operating Corporation
 Well #2 Sun Federal
 660' FSL & 660' FEL Sec. 29-7S-26E