

NM OIL CONS. COMMISSION
Drawer
Artesia, NEW MEXICO
DEPARTMENT OF THE INTERIOR
GEOLOGICAL SURVEYSUBMIT IN DUPLICATE*
(Other instructions on
reverse side)Form approved.
Budget Bureau No. 42-R1425.

30-005-61140

C/SF

APPLICATION FOR PERMIT TO DRILL, DEEPEN, OR PLUG BACK

1a. TYPE OF WORK
DRILL ☒ DEEPEN ☐ PLUG BACK ☐

b. TYPE OF WELL
OIL WELL ☐ GAS WELL ☒ OTHER ☐ SINGLE ZONE ☒ MULTIPLE ZONE ☐

2. NAME OF OPERATOR
STEVENS OPERATING CORPORATION ✓ (Ph. 505-622-7273)

3. ADDRESS OF OPERATOR
P. O. Box 2203, Roswell, New Mexico 88201

4. LOCATION OF WELL (Report location clearly and in accordance with any State requirements.)
At surface 660' FNL & 660' FWL Sec. 11-7S-25E
At proposed prod. zone same

14. DISTANCE IN MILES AND DIRECTION FROM NEAREST TOWN OR POST OFFICE*
24 air miles north-northeast of Roswell, N. M.

15. DISTANCE FROM PROPOSED* LOCATION TO NEAREST PROPERTY OR LEASE LINE, FT.
(Also to nearest drlg. unit line, if any) 660'

16. NO. OF ACRES IN LEASE
840

17. NO. OF ACRES ASSIGNED TO THIS WELL
160

18. DISTANCE FROM PROPOSED LOCATION* TO NEAREST WELL, DRILLING, COMPLETED, OR APPLIED FOR, ON THIS LEASE, FT.
NA

19. PROPOSED DEPTH
4100' Abo

20. ROTARY OR CABLE TOOLS
Rotary

21. ELEVATIONS (Show whether DF, RT, GR, etc.)
3795 G.L.

22. APPROX. DATE WORK WILL START*
Dirt 9-25-81 Spud 10-1-81

5. LEASE DESIGNATION AND SERIAL NO.
NM-43524

6. IF INDIAN, ALLOTTEE OR TRIBE NAME
--

7. UNIT AGREEMENT NAME
--

8. FARM OR LEASE NAME
EDMONDSON FEDERAL

9. WELL NO.
1

10. FIELD AND POOL, OR WILDCAT
Undesignated Abo

11. SEC., T., R., M., OR BLK. AND SURVEY OR AREA
U.L.D. Sec. 11-7S-25E

12. COUNTY OR PARISH
Chaves

13. STATE
N. M.

23. PROPOSED CASING AND CEMENTING PROGRAM

SIZE OF HOLE	SIZE OF CASING	WEIGHT PER FOOT	SETTING DEPTH	QUANTITY OF CEMENT
14 3/4"	10 3/4"	32.75#	850'	Sufficient to circulate
9 7/8"	*	*	1500'	*
7 7/8"	4 1/2"	9.50#	4100'	200 sacks.

* If circulation cannot be maintained while drilling the 9 7/8" hole to 1500', 8 5/8" (24#) intermediate casing will be cemented at 1500' with 200 sacks of cement.

After setting and cementing production string, pay zones will be perforated and stimulated as needed for production.

Attached are: 1. Well Location & Acreage Dedication Plat
2. Supplemental Drilling Data.
3. Surface Use Plan.

RECEIVED
SEP 21 1981

Gas is not dedicated.

OIL & GAS
U.S. GEOLOGICAL SURVEY
ROSWELL, NEW MEXICO

IN ABOVE SPACE DESCRIBE PROPOSED PROGRAM: If proposal is to deepen or plug back, give data on present production and proposed new productive zone. If proposal is to drill or deepen directionally, give pertinent data on subsurface locations and measured and true vertical depths. Give blowout preventer program, if any.

24. SIGNED Pat Thompson TITLE Production Clerk DATE Sept. 21, 1981
(This space for Federal or State office use)
(Chs. Sgd.) GEORGE H. STEWART APPROVAL DATE _____

PERMIT NO. SEP 30 1981 APPROVED BY JAMES A. CULHAM DISTRICT SUPERVISOR
CONDITIONS OF APPROVAL, IF ANY: _____ TITLE _____ DATE _____

*See Instructions On Reverse Side

**N MEXICO OIL CONSERVATION COMMISSION
WELL LOCATION AND ACREAGE DEDICATION PLAT**

Form C-102
Supersedes C-128
Effective 1-1-85

All distances must be from the outer boundaries of the Section.

Operator Stevens Operating Corp.			Lease Edmondson Fed.		Well No. 1
Unit Letter D	Section 11	Township 7South	Range 25East	County Chaves	
Actual Footage Location of Well: <div style="display: flex; justify-content: space-between;"> 660 feet from the North line and 660 feet from the West line </div>					
Ground Level Elev. 3795.2'	Producing Formation Abo		Pool Undesignated Abo		Dedicated Acreage: 160 Acres

1. Outline the acreage dedicated to the subject well by colored pencil or hachure marks on the plat below.
2. If more than one lease is dedicated to the well, outline each and identify the ownership thereof (both as to working interest and royalty). **Federal Oil & Gas Lease NM-43524 is only lease involved.**
3. If more than one lease of different ownership is dedicated to the well, have the interests of all owners been consolidated by communitization, unitization, force-pooling, etc?

☐ Yes ☐ No If answer is "yes," type of consolidation _____

If answer is "no," list the owners and tract descriptions which have actually been consolidated. (Use reverse side of this form if necessary.) _____

No allowable will be assigned to the well until all interests have been consolidated (by communitization, unitization, forced-pooling, or otherwise) or until a non-standard unit, eliminating such interests, has been approved by the Commission.

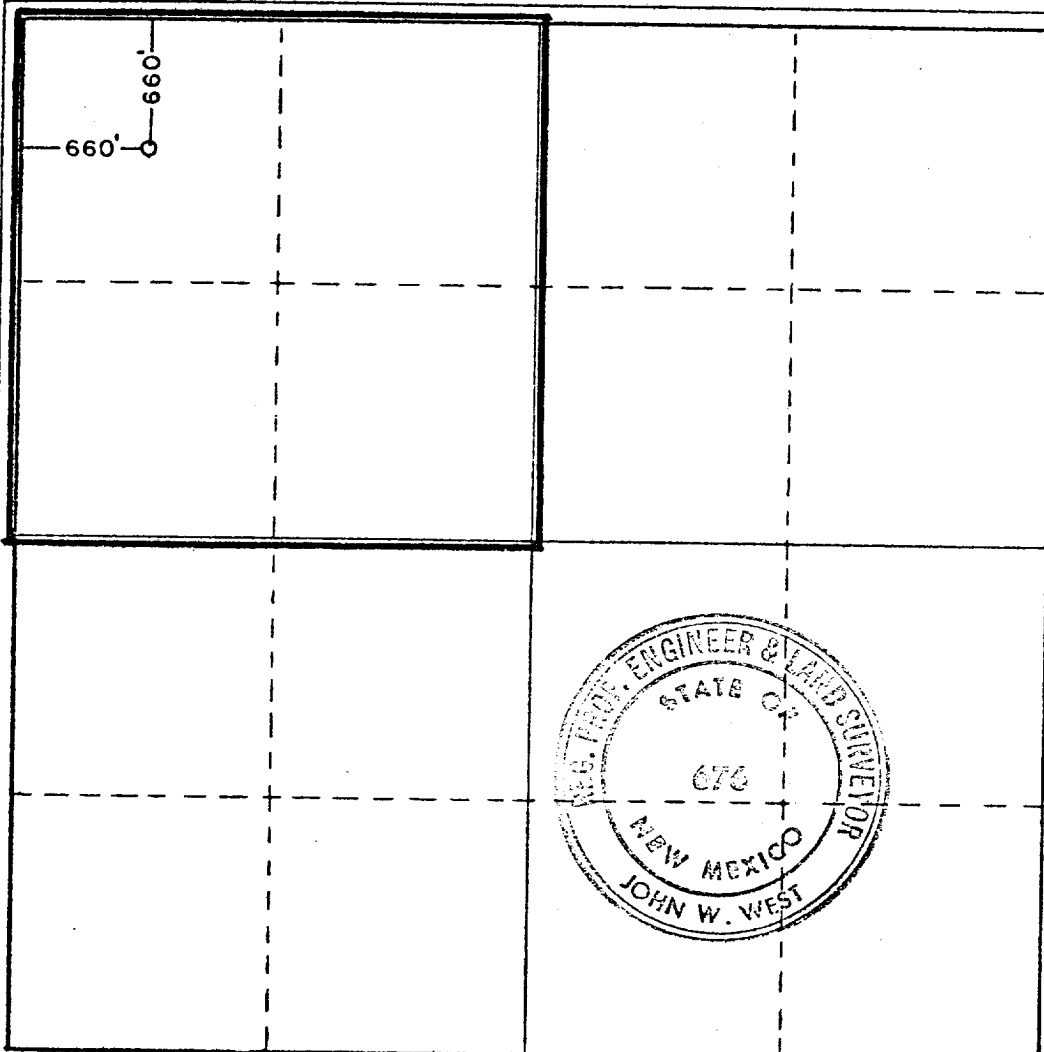

CERTIFICATION

I hereby certify that the information contained herein is true and complete to the best of my knowledge and belief.

Name _____

James A. Knaut

Position _____

Agent

Company _____

STEVENS OPERATING CORP.

Date _____

September 18, 1981

I hereby certify that the well location shown on this plat was plotted from field notes of actual surveys made by me or under my supervision, and that the same is true and correct to the best of my knowledge and belief.

Date Surveyed _____

Aug. 27, 1981

Registered Professional Engineer and/or Land Surveyor

Certificate No. _____

**JOHN W. WEST 676
PATRICK A. ROMERO 6863
Ronald J. Eidson 3239**

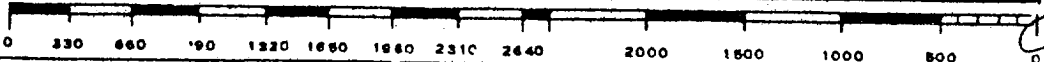

SUPPLEMENTAL DRILLING DATA

STEVENS OPERATING CORPORATION
WELL #1 EDMONDSON FEDERAL
NW $\frac{1}{4}$ NW $\frac{1}{4}$ SEC. 11-7S-25E
CHAVES COUNTY, NEW MEXICO

1. SURFACE FORMATION: Permian (Artesia Group).

2. ESTIMATED TOPS OF GEOLOGIC MARKERS:

San Andres	480'
Glorietta	1570'
Abo	3660'

3. ANTICIPATED POROSITY ZONES:

Water	130'
Oil	970'
Gas	3700'

4. CASING DESIGN:

<u>Size</u>	<u>Interval</u>	<u>Weight</u>	<u>Grade</u>	<u>Joint</u>	<u>Condition</u>
10 3/4"	0 - 850'	32.75#	K-55	STC	New
8 5/8"	0 - 1500'	24.0 #	K-55	STC	New
4 1/2"	0 - 4100'	9.5 #	K-55	STC	New

5. SURFACE CONTROL EQUIPMENT: A double ram-type preventer (900 series).
A sketch of BOP is attached.

6. CIRCULATING MEDIUM:

0 - 850'	Fresh water mud with gel added if needed for viscosity.
850 - TD	Fresh water mud, conditioned as necessary for control of viscosity and water loss.

7. AUXILLARY EQUIPMENT: Drill string safety valve.

8. TESTING, LOGGING AND CORING PROGRAMS:

DST's:	As warranted.
Coring:	None planned.
Logging:	A compensated Neutron/Formation Density Log w/Gamma Ray and a Dual Laterolog/Micro-Spherically Focused Log.

9. ABNORMAL PRESSURES, TEMPERATURES OR GASES: None anticipated.

10. ANTICIPATED DATES: It is planned that drilling operations will commence about September 25, 1981. Duration of drilling and completion operations should be 6 to 45 days.

BLOWOUT PREVENTER SKETCH

Stevens Operating Corporation
Well #1 Edmondson Federal
660' FNL & 660' FWL Sec. 11-7S-25E

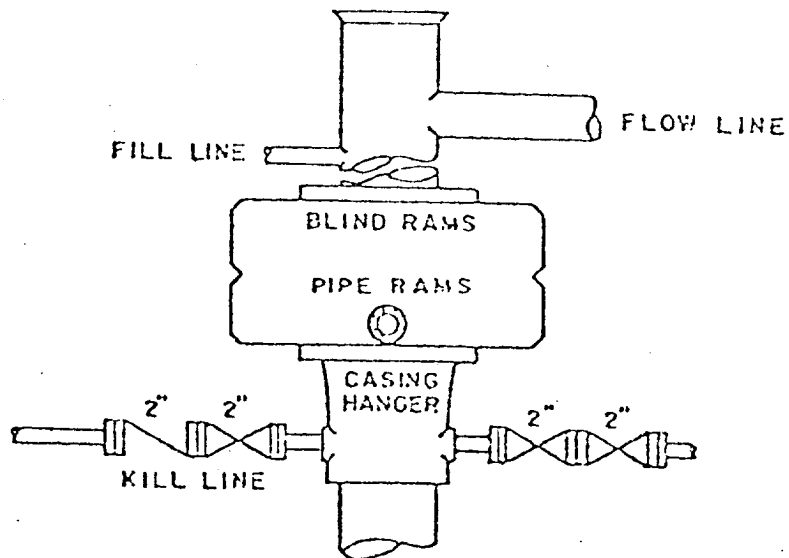

DUAL RAM-TYPE PREVENTER

900 Series

SURFACE USE PLAN
FOR
DRILLING, COMPLETING AND PRODUCING

STEVENS OPERATING CORPORATION
WELL #1 EDMONDSON FEDERAL
660' FNL & 660' FWL SEC. 11-7S-25E
CHAVES COUNTY, NEW MEXICO

LOCATED: 24 air miles north-northeast of Roswell, New Mexico.

FEDERAL LEASE NUMBER: NM-43524

LEASE ISSUED: 8-1-81 for a primary term of 10 years.

RECORD LESSEE: Billy Edmondson

OPERATOR'S AUTHORITY: Designation of Operator from lessee.

BOND COVERAGE: Lessee's \$10,000 Lease Bond

ACRES IN LEASE: 840

SURFACE OWNERSHIP: State of New Mexico

POOL: Undesignated Abo, (160-acre spacing).

EXHIBITS:

- A. County Road Map
- B. Topographic Map
- C. Oil & Gas Map
- D. Sketch of Well Pad
- E. Restoration Requirements for State Land

ROAD LOG TO PROPOSED DRILLSITE

STARTING POINT is north of Roswell on US-285 at Mile Post 122.39 which is 7.71 miles north of the US-70 underpass.

- 0.00 Turn right (east) on county road and proceed in an easterly direction for a distance of 2.62 miles to a fork in road.
- 2.62 Turn left (northeast) on main road and proceed in a northeasterly direction for a distance of 11.99 miles to a fork in road. This point is about in the C-SE-SW 11-7S-25E.
- 14.61 Turn left (west) on bladed oilfield road and proceed in a westerly direction for a distance of 0.25 mile.
- 14.87 New road will start at this point. Turn right (north) and proceed in a northerly direction for a distance of 0.79 mile to the southeast corner of the proposed well pad.
- 15.66 DRILLSITE. Well #1 Edmondson Federal.

THIRTEEN POINT PROGRAM

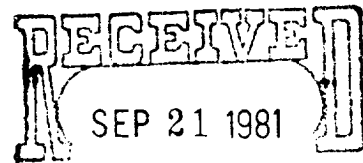

OIL & GAS
U.S. GEOLOGICAL SURVEY
ROSWELL, NEW MEXICO

1. EXISTING ROADS: Existing roads, which lead to the proposed drillsite, are shown on Exhibits "A" & "B".
2. PROPOSED NEW ROAD: Proposed new access road will be 0.79 mile in length. The proposed route, which will originate at mileage 14.87 on the road log and terminate at the southeast corner of the proposed well pad, is shown on Exhibit "B". The proposed location of this new road has been staked and flagged.
 - A. Width: 15 feet with 20 feet R-O-W.
 - B. Surfacing Material: Only material from the roadway will be used for surfacing the new road.
 - C. Road Design: Road construction will consist of blading the proposed roadway and leaving a slight crown down the middle.
 - D. Turnouts: None necessary.
 - E. Culverts: None necessary.
 - F. Gates, Cattleguards: None necessary.

3. LOCATION OF EXISTING WELLS:

- A. Existing wells in the vicinity of the proposed drillsite are shown on Exhibit "C".

4. LOCATION OF EXISTING AND/OR PROPOSED FACILITIES:

- A. There are no production facilities located on the leasehold.
- B. If the proposed well is productive, production and storage facilities will be located on the new well pad.

5. LOCATION AND TYPE OF WATER SUPPLY:

- A. It is not planned to drill a water supply well. Water for leasehold operations will be purchased from the nearest commercial source.

6. SOURCE OF CONSTRUCTION MATERIALS:

- A. Material-in-place will be used for construction of the road and well pad.

7. METHODS OF HANDLING WASTE DISPOSAL:

- A. Drill cuttings will be disposed of in the drilling pits.
- B. Drilling fluids will be allowed to evaporate in the drilling pits until the pits are dry.
- C. Water produced during tests will be disposed of in the drilling pits.
- D. Oil produced during tests will be produced into temporary test tanks.
- E. Trash, waste paper, garbage, and junk will be buried in a trash pit and covered with a minimum of 24 inches of dirt. All waste material will be contained to prevent scattering by the wind. Location of the trash pit is shown on Exhibit "D".
- F. All trash and debris will be buried or removed from the wellsite within 30 days after finishing each drilling and/or completion operation.

8. ANCILLARY FACILITIES:

- A. None anticipated.

9. WELLSITE LAYOUT:

- A. The wellsite has been surveyed and a 400' x 400' area has been staked and flagged.
- B. The dimensions and relative location of the drill pad, mud pit, and trash pit with respect to the well bore are shown on Exhibit "D".
- C. The well pad area is nearly level and will hardly require any cut or fill.
- D. The well pad will not be surfaced with any foreign material but will be constructed from material-in-place.

10. PLANS FOR RESTORATION OF THE SURFACE:

- A. After completion of drilling and/or completion operations, all equipment and other material not needed for operations will be removed. Pits will be filled and the location cleaned of all trash and junk to leave the wellsite in as aesthetically pleasing condition as possible.
- B. Any unguarded pits containing fluids will be fenced until they are filled.
- C. After abandonment, all equipment, trash and junk will be removed and the location cleaned. Any special rehabilitation and/or revegetation requirements of the surface management agency will be complied with and accomplished as expeditiously as possible.

11. OTHER INFORMATION:

- A. Topography: The undisturbed wellsite elevation is 3795 feet and the regional slope is to the east toward the Pecos River.
- B. Soil: Top soil is sandy gypsy loam.
- C. Flora & Fauna: The vicinity surrounding the drillsite is semi-arid desert rangeland. Vegetative cover is sparse. Flora consists primarily of mesquite and range grasses interspersed with other desert plants. The only wildlife observed were rabbits; however, fauna for this type of habitat also includes lizards, snakes, rodents, skunks, coyotes, dove, quail and other small birds.
- D. Ponds & Streams: None. Pecos River is 3 miles to the east.
- E. Residences & Other Structures: Nearest occupied dwelling is 2 miles to the southwest. Nearest water well is 1 mile to the east.

F. Archaeological, Historical & Other Cultural Sites: An archaeological reconnaissance of the well pad and new road area was made by New Mexico Archaeological Services, Inc. on 9-14-81 and no significant artifacts were observed.

G. Land Use: Grazing and occasional hunting.

12. OPERATOR'S REPRESENTATIVE:

Representative responsible for assuring compliance with the approved Surface Use Plan:

Pat Thompson
Production Clerk
118 W. First
Roswell, New Mexico 88201
Office phone 622-7273
Home phone 622-1082

13. CERTIFICATION:

I hereby certify that I, or persons under my direct supervision, have inspected the proposed drillsite and access route; that I am familiar with the conditions which presently exist; that the statements made in this plan are, to the best of my knowledge true and correct; and, that the work associated with the operations proposed herein will be performed by STEVENS OPERATING CORPORATION and its sub-contractors in conformity with this plan and the terms and conditions under which it is approved.

Sept. 18, 1981

Date

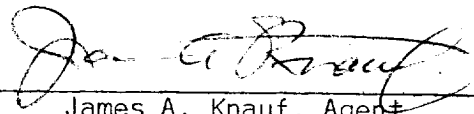

James A. Knauf, Agent
STEVENS OPERATING CORPORATION

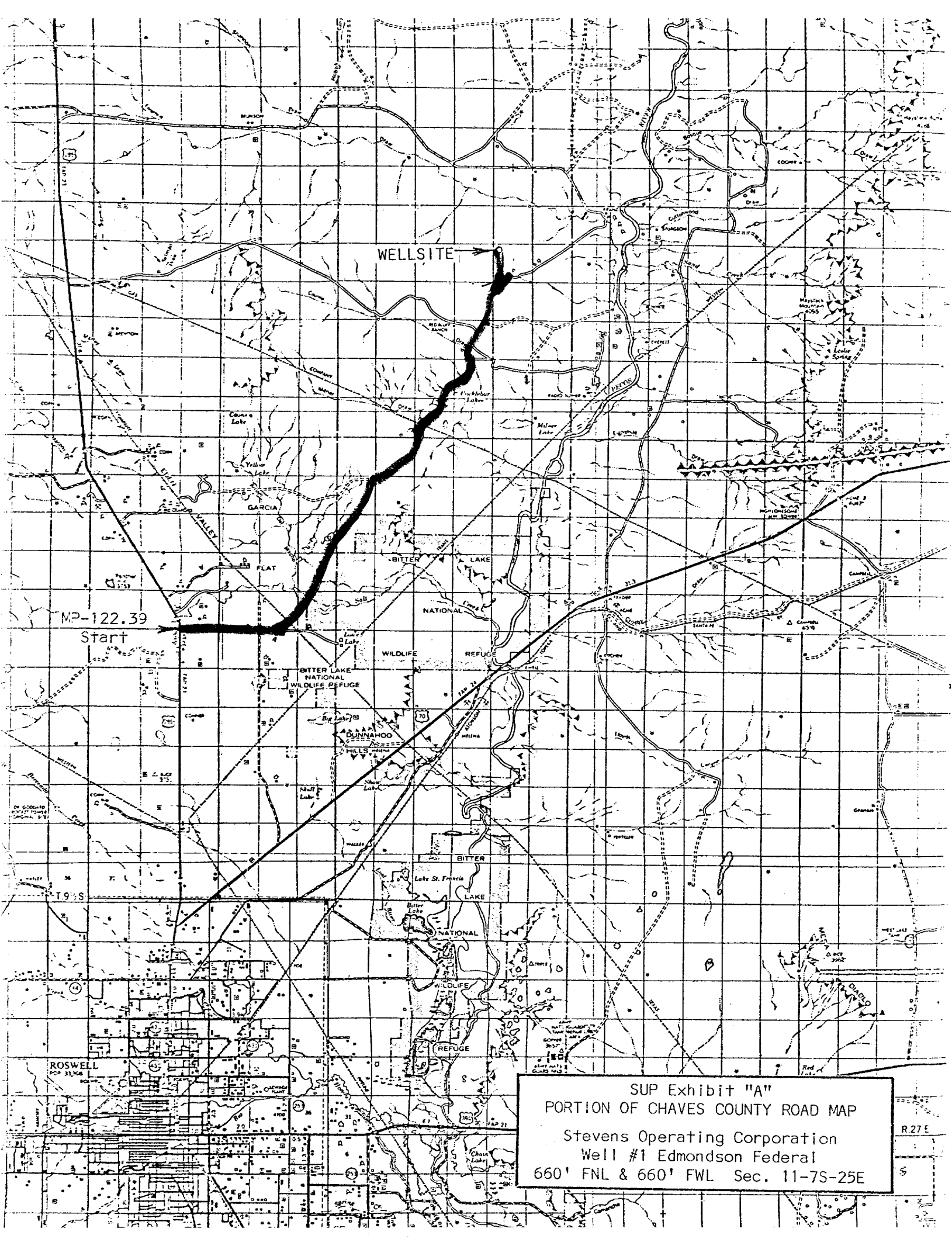

SUP Exhibit "A"
PORTION OF CHAVES COUNTY ROAD MAP
Stevens Operating Corporation
Well #1 Edmondson Federal
660' FNL & 660' FWL Sec. 11-7S-25E

R 27 E

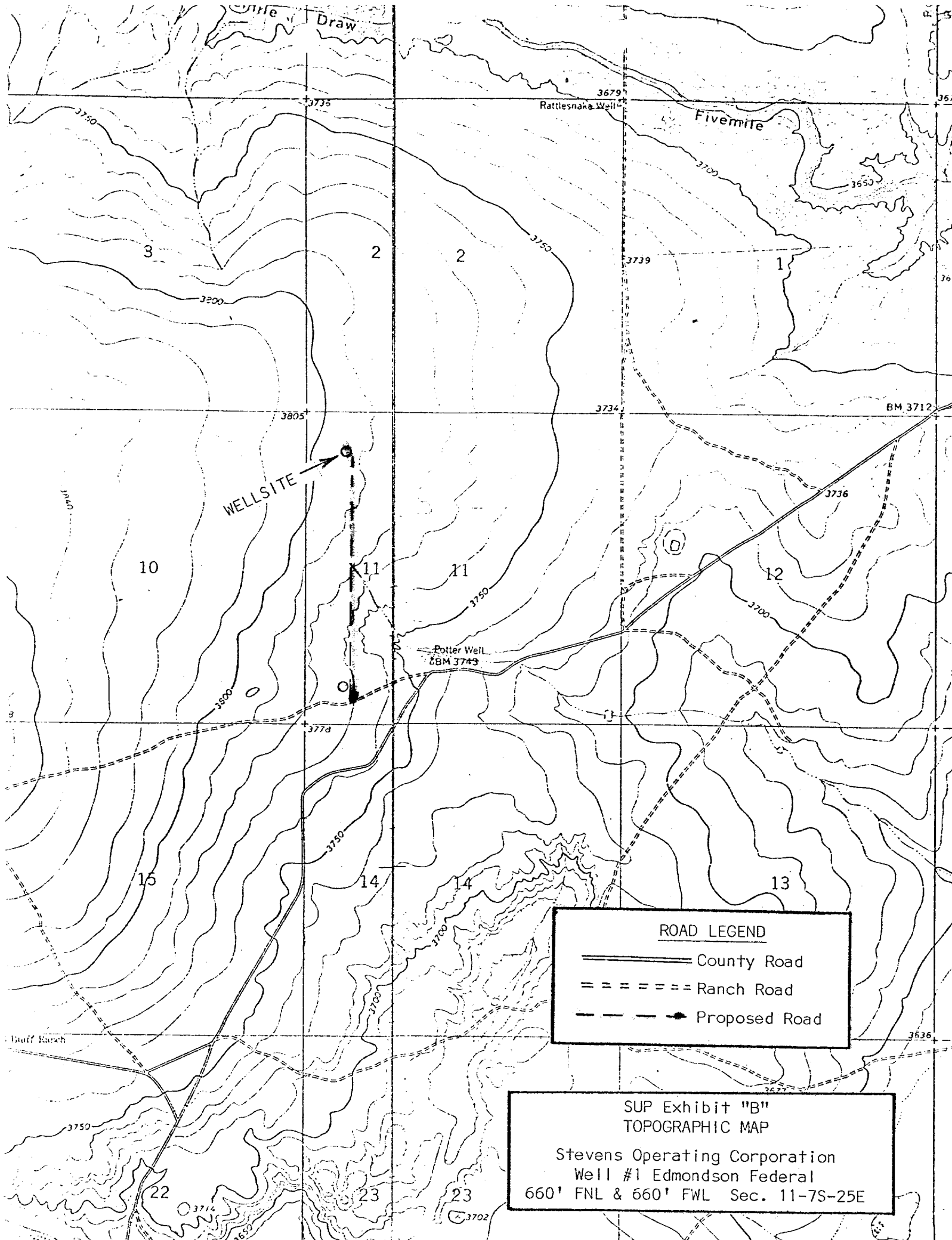

ROAD LEGEND

- County Road
- Ranch Road
- Proposed Road

SUP Exhibit "B"
TOPOGRAPHIC MAP

Stevens Operating Corporation
Well #1 Edmondson Federal
660' FNL & 660' FWL Sec. 11-7S-25E

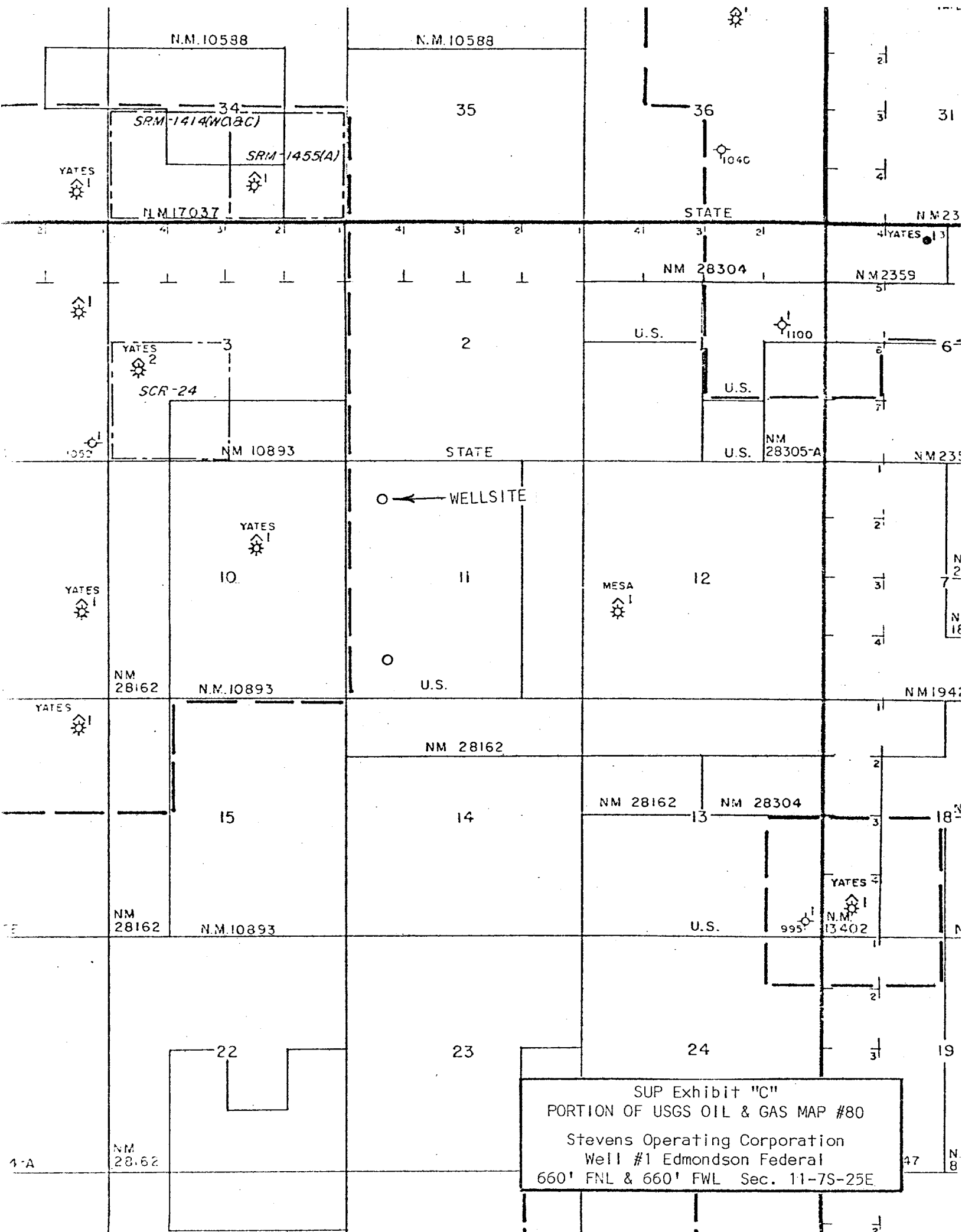

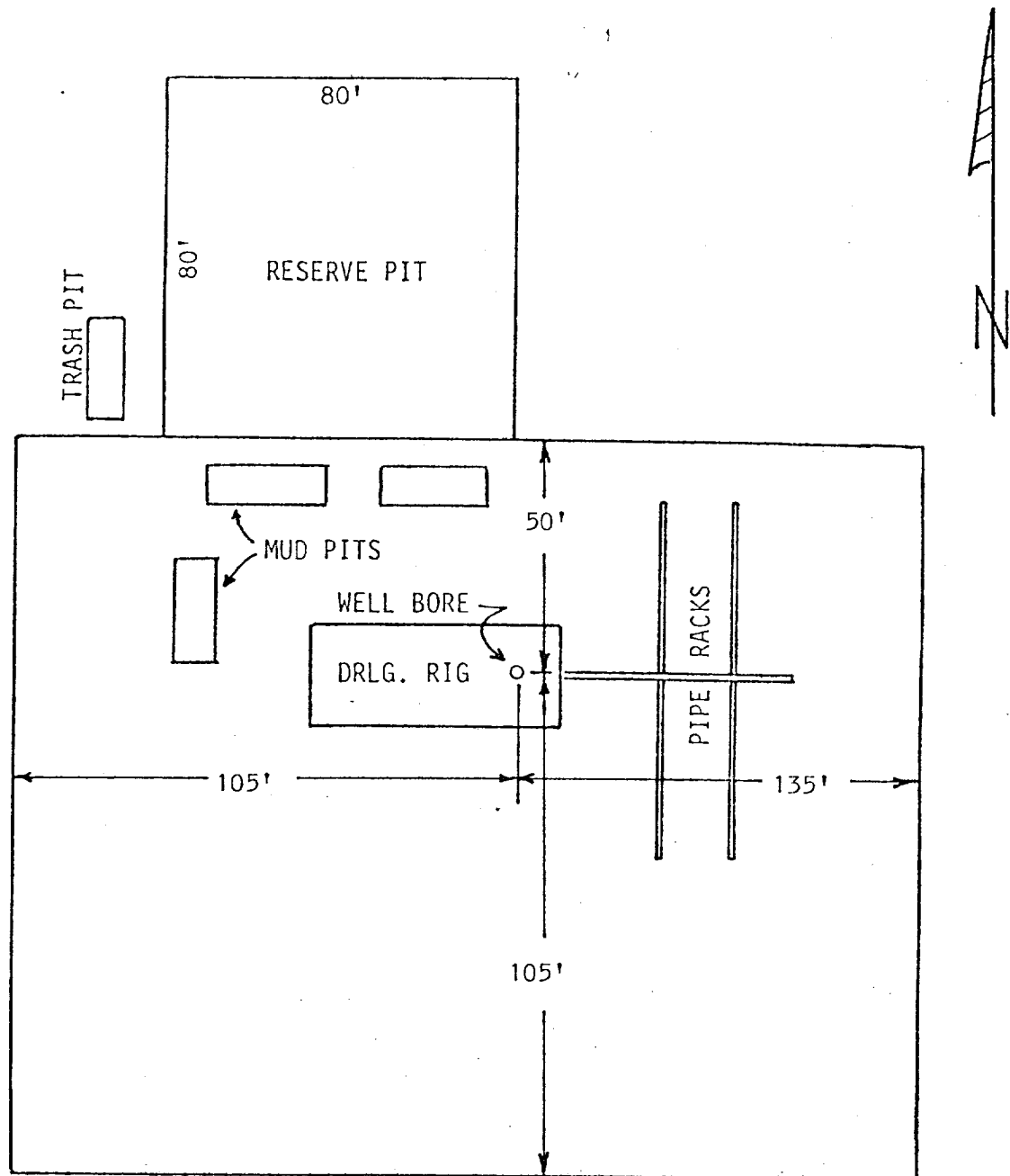

SUP Exhibit "D"
SKETCH OF WELL PAD
Stevens Operating Corporation
Well #1 Edmondson Federal
660' FNL & 660' FWL Sec. 11-7S-25E

RESTORATION REQUIREMENTS FOR NW $\frac{1}{4}$ NW $\frac{1}{4}$ SEC. 11-7S-25E, CHAVES COUNTY, NEW MEXICO

Records show that the above-described tract of land is owned as follows:

Surface: State of New Mexico
Minerals: U. S. Government
Oil & Gas Rights: Stevens Operating Corporation

Mr. Ray Graham of the New Mexico State Land Office advised me that the standard USGS surface abandonment requirements would be satisfactory for land owned by the State of New Mexico on which the minerals were reserved by the U. S. Government.

September 18, 1981



James A. Knauf
Agent for STEVENS OPERATING CORP.

SUP Exhibit "E"

Stevens Operating Corporation
Well #1 Edmondson Federal
660' FNL & 660' FWL Sec. 11-7S-25E