

NO. OF COPIES RECEIVED	
DISTRIBUTION	
SANTA FE	1
FILE	1 ✓
U.S.G.S.	2
LAND OFFICE	
OPERATOR	1

NEW MEXICO OIL CONSERVATION COMMISSION

RECEIVED

OCT 21 1981

O. C. D.

ARTESIA, OFFICE

Form C-101
Revised 1-1-65

5A. Indicate Type of Lease	
STATE <input type="checkbox"/>	FEE <input checked="" type="checkbox"/>

5. State Oil & Gas Lease No.

APPLICATION FOR PERMIT TO DRILL, DEEPEN, OR PLUG BACK

1a. Type of Work		7. Unit Agreement Name	
b. Type of Well DRILL <input checked="" type="checkbox"/> DEEPEN <input type="checkbox"/> PLUG BACK <input type="checkbox"/>		8. Farm or Lease Name BURTIS COM	
2. Name of Operator Mesa Petroleum Co. ✓		9. Well No. #1	
3. Address of Operator 1000 Vaughn Building/Midland, Texas 79701-4493		10. Field and Pool, or Wildcat Undesignated ABO	
4. Location of Well UNIT LETTER I LOCATED 1980 FEET FROM THE South LINE AND 660 FEET FROM THE East LINE OF SEC. 11 TWP. 7S RGE. 25E NMPM		12. County Chaves	
19. Proposed Depth 4400		19A. Formation ABO	20. Rotary or C.T. Rotary
21. Elevations (Show whether DF, RT, etc.) 3725'	21A. Kind & Status Plug. Bond Blanket	21B. Drilling Contractor Dual Drilling	22. Approx. Date Work will start November 16, 1981

23.

PROPOSED CASING AND CEMENT PROGRAM

SIZE OF HOLE	SIZE OF CASING	WEIGHT PER FOOT	SETTING DEPTH	SACKS OF CEMENT	EST. TOP
17 1/2"	13 3/8"	48#	900'	300/200/300	SURFACE
11"	8 5/8"	24#	1600'	500/300	ISOLATE WTR, O&G
7 7/8"	4 1/2"	10.5#	4400'	500/500	COVER ALL PAY

Propose to drill 17 1/2" hole to approximately 900', set 13 3/8" surface casing and cement to surface. Will reduce hole to 11" and drill to 1600' to set 8 5/8" casing. Will reduce hole to 7 7/8", nipple up RAM type BOP's, and drill to total depth. Drilling medium will be air, foam, or mud as required.

Gas Sales are dedicated.

APPROVAL VALID FOR 180 DAYS
PERMIT EXPIRES 4-22-82
UNLESS DRILLING UNDERWAY

XC: NMOCD(6), TLS, CEN RCDS, ACCTG, ROSWELL, MEC, LAND, PARTNERS, FILE, REM

Posted ID-1
API + NL Book
10-23-81

IN ABOVE SPACE DESCRIBE PROPOSED PROGRAM: IF PROPOSAL IS TO DEEPEN OR PLUG BACK, GIVE DATA ON PRESENT PRODUCTIVE ZONE AND PROPOSED NEW PRODUCTIVE ZONE. GIVE BLOWOUT PREVENTER PROGRAM, IF ANY.

I hereby certify that the information above is true and complete to the best of my knowledge and belief.

Signed R. F. Mathis Title REGULATORY COORDINATOR Date 10-19-81

(This space for State Use)

APPROVED BY W. A. Gussitt TITLE SUPERVISOR, DISTRICT II DATE OCT 22 1981

CONDITIONS OF APPROVAL, IF ANY:

Notify N.M.O.C.C. in sufficient
time to witness cementing
the 13 3/8" casing

All distances must be from the outer boundaries of the Section.

Operator Mesa Petroleum Co.		Lease Burtis Com.		Well No. 1
Unit Letter I	Section 11	Township 7 South	Range 25 East	County Chaves
Actual Footage Location of Well:				
1980 feet from the South		660 feet from the East		Line
Ground Level Elev. 3725	Producing Formation ABO	Pool Undesignated	Dedicated Acreage: SE 160 Acres	

1. Outline the acreage dedicated to the subject well by colored pencil or hatchure marks on the plat below.
2. If more than one lease is dedicated to the well, outline each and identify the ownership thereof (both as to working interest and royalty).
3. If more than one lease of different ownership is dedicated to the well, have the interests of all owners been consolidated by communitization, unitization, force-pooling, etc?

☐ Yes ☐ No If answer is "yes," type of consolidation COMMUNITIZATION IN PROGRESS

If answer is "no," list the owners and tract descriptions which have actually been consolidated. (Use reverse side of this form if necessary.)

No allowable will be assigned to the well until all interests have been consolidated (by communitization, unitization, forced-pooling, or otherwise) or until a non-standard unit, eliminating such interests, has been approved by the Division.

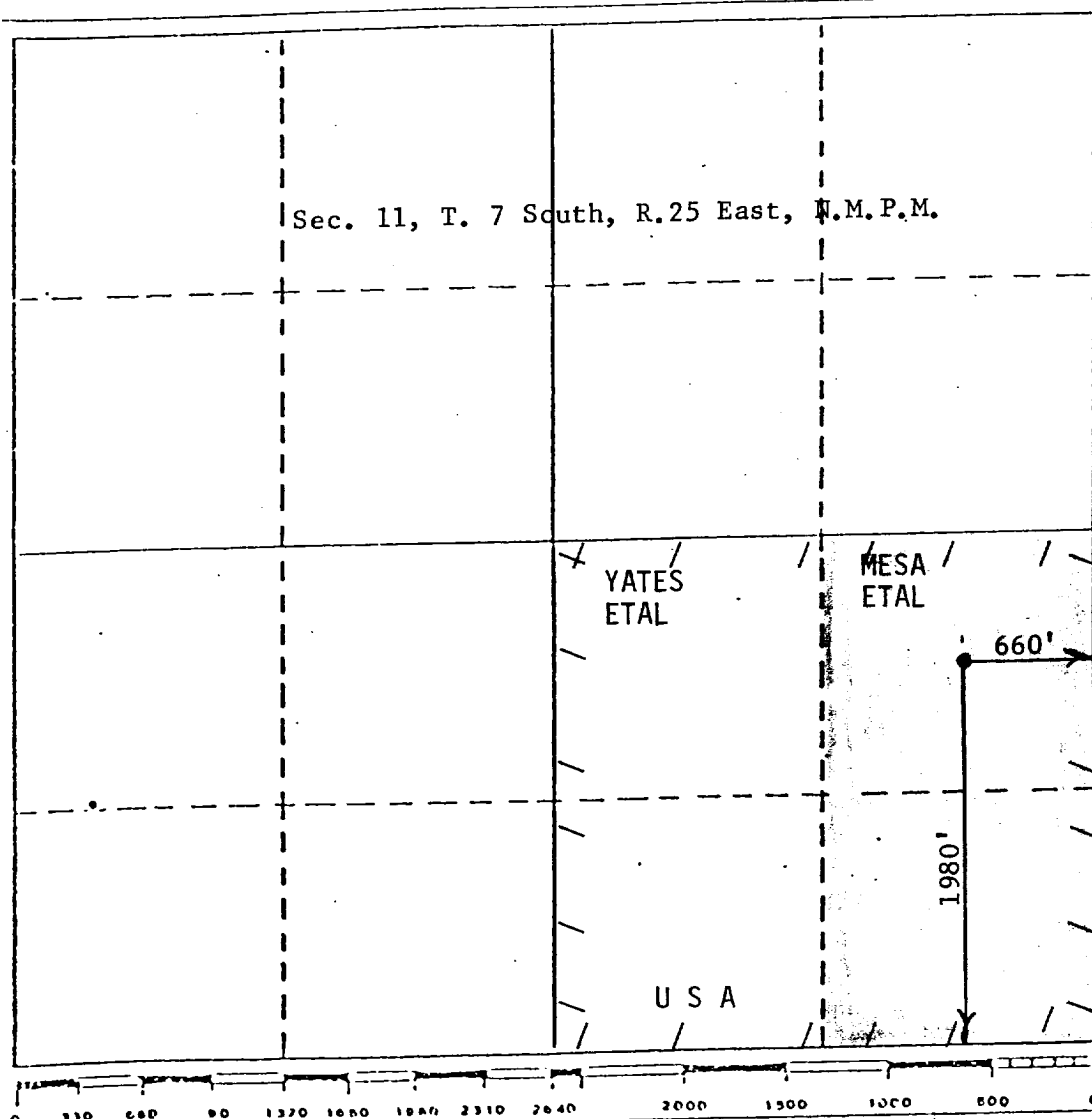

CERTIFICATION

I hereby certify that the information contained herein is true and complete to the best of my knowledge and belief.

R. E. Mathis

Name
R. E. Mathis
Position
Regulatory Coordinator
Company
Mesa Petroleum Co.
Date
10-19-81

I hereby certify that the well location shown on this plat was plotted from field notes of actual surveys made by me or under my supervision, and that the same is true and correct to the best of my knowledge and belief.

JOHN D. JACQUESS
NEW MEXICO
6290
October 9, 1981
Professional Engineer
John D. Jacquess, P.E. & L.S.
Certificate No. 6290