

NO. OF COPIES RECEIVED	
DISTRIBUTION	
SANTA FE	1
FILE	1 ✓
U.S.G.S.	2
LAND OFFICE	
OPERATOR	1

P. O. BOX 2088
SANTA FE, NEW MEXICO 87501

OCT 21 1981

O. C. D.
ARTESIA, OFFICE5A. Indicate Type of Lease
STATE ☐ FEE ☒

5. State Oil & Gas Lease No.

APPLICATION FOR PERMIT TO DRILL, DEEPEN, OR PLUG BACK

7. Unit Agreement Name

8. Farm or Lease Name

ACME

9. Well No.

8

10. Field and Pool, or Wildcat

X UNDESIGNATED ABO

12. County

CHAVES

1a. Type of Work

DRILL ☒DEEPEN ☐PLUG BACK ☐

b. Type of Well

OIL WELL ☐GAS WELL ☒

OTHER

SINGLE ZONE ☒MULTIPLE ZONE ☐

2. Name of Operator

MESA PETROLEUM CO ✓

3. Address of Operator

1000 VAUGHN BUILDING/MIDLAND, TEXAS 79701-4493

4. Location of Well

UNIT LETTER C LOCATED 660 FEET FROM THE NORTH LINE

AND 1980 FEET FROM THE WEST LINE OF SEC. 29 TWP. 8S RGE. 26E NADPM

19. Proposed Depth

4800'

19A. Formation

ABO

20. Rotary or C.T.

ROTARY

21. Elevations (Show whether DF, RT, etc.)

3725' GR

21A. Kind & Status Plug. Bond

BLANKET

21B. Drilling Contractor

DESERT DRILLING

22. Approx. Date Work will start

DECEMBER 4, 1981

PROPOSED CASING AND CEMENT PROGRAM

SIZE OF HOLE	SIZE OF CASING	WEIGHT PER FOOT	SETTING DEPTH	SACKS OF CEMENT	EST. TOP
17 1/2"	13 3/8"	48#	900'	300/200/300	SURFACE
11"	8 5/8"	24#	1600'	500/300	ISOLATE WTR, O&G
7 7/8"	4 1/2"	10.5#	4800'	500/500	COVER ALL PAY

Propose to drill 17 1/2" hole to approximately 900', set 13 3/8" surface casing and cement to surface. Will reduce hole to 11" and drill to 1600' to set 8 5/8" casing. Will reduce hole to 7 7/8", nipple up RAM type BOP's, and drill to total depth. Drilling medium will be air, foam, or mud as required.

Gas Sales are dedicated.

APPROVAL VALID FOR 180 DAYS
PERMIT EXPIRES 4-26-82
UNLESS DRILLING UNDERWAY

XC: NMOC(6), TLS, CEN RCDS, ACCTG, ROSWELL, MEC, LAND, PARTNERS, FILE, REM

IN ABOVE SPACE DESCRIBE PROPOSED PROGRAM; IF PROPOSAL IS TO DEEPEN OR PLUG BACK, GIVE DATA ON PRESENT PRODUCTIVE ZONE AND PROPOSED NEW PRODUCTION ZONE. GIVE BLOWOUT PREVENTER PROGRAM, IF ANY.

I hereby certify that the information above is true and complete to the best of my knowledge and belief.

Signed R. P. Perkins Title REGULATORY COORDINATOR Date 10-19-81

(This space for State Use)

APPROVED BY W. A. Gussit TITLE SUPERVISOR, DISTRICT II DATE OCT 26 1981

CONDITIONS OF APPROVAL, IF ANY:

All distances must be from the outer boundaries of the Section.

Operator Mesa Petroleum Co.		Lease Acme		Well No. #8
Unit Letter C	Section 29	Township 8 South	Range 26 East	County Chaves
Actual Postage Location of Well: 1980 feet from the West line and 660 feet from the North line				
Ground Level Elev. 3725	Producing Formation ABO	Pool UNDESIGNATED		Dedicated Acreage: NW/4 160 Acres

1. Outline the acreage dedicated to the subject well by colored pencil or hatchure marks on the plat below.
2. If more than one lease is dedicated to the well, outline each and identify the ownership thereof (both as to working interest and royalty).
3. If more than one lease of different ownership is dedicated to the well, have the interests of all owners been consolidated by communitization, unitization, force-pooling, etc?

☐ Yes ☐ No If answer is "yes," type of consolidation _____

If answer is "no," list the owners and tract descriptions which have actually been consolidated. (Use reverse side of this form if necessary.) _____

No allowable will be assigned to the well until all interests have been consolidated (by communitization, unitization, forced-pooling, or otherwise) or until a non-standard unit, eliminating such interests, has been approved by the Division.

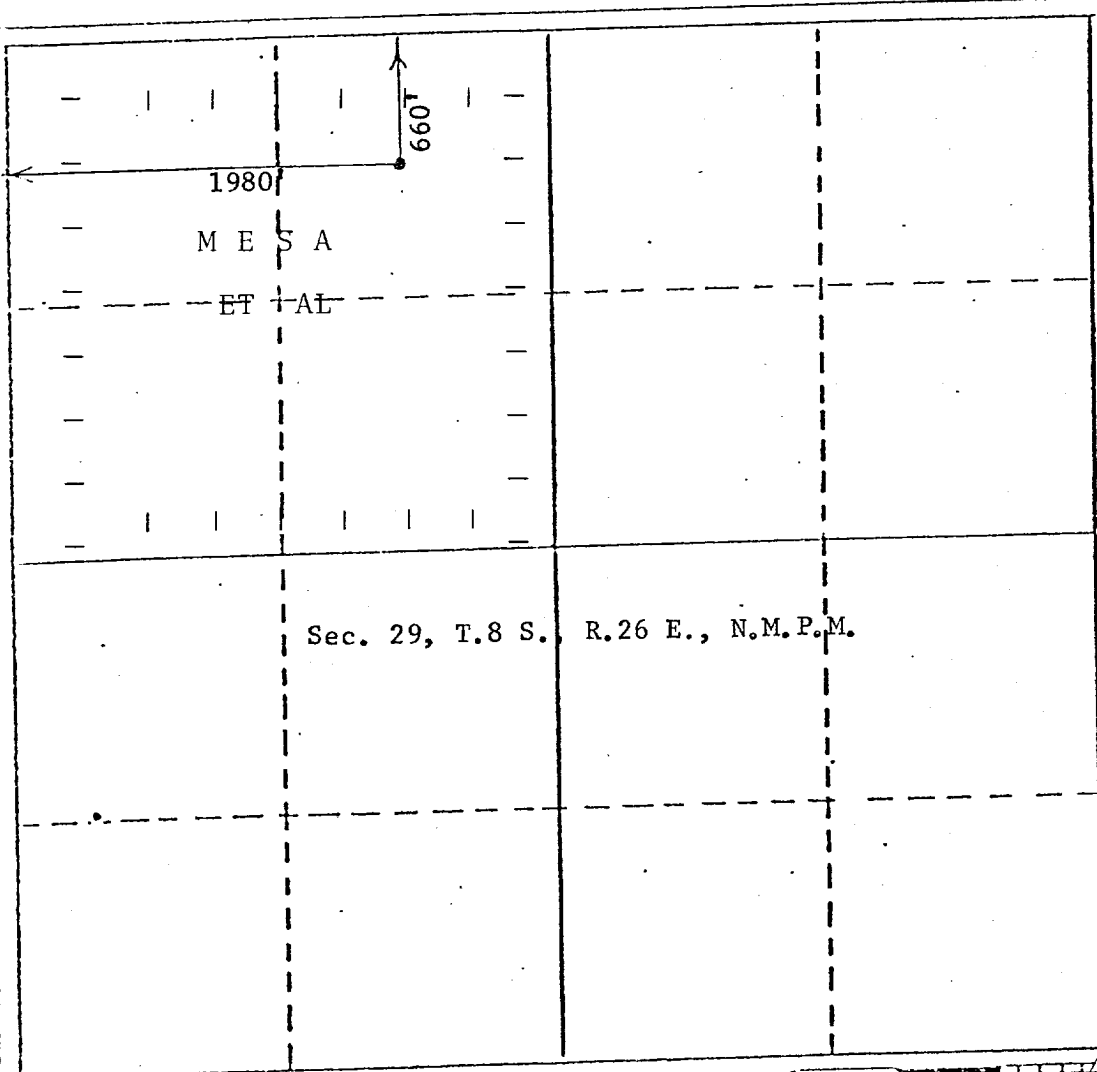

CERTIFICATION

I hereby certify that the information contained herein is true and complete to the best of my knowledge and belief.

R. E. Mathis

Name
R. E. MATHIS
Position
REGULATORY COORDINATOR
Company
MESA PETROLEUM CO.
Date
10-19-81

I hereby certify that the well location shown on this plat was plotted from field notes of actual surveys made by me or under my supervision, and that the same is true and correct to the best of my knowledge and belief.

Date Surveyed
October 16, 1981
Registered Professional Engineer and/or Land Surveyor
John D. Jaques
Certificate No.
6290

