

NO. OF COPIES RECEIVED	
DISTRIBUTION	
SANTA FE	1
FILE	1
U.S.G.S.	1
LAND OFFICE	1
OPERATOR	1

P. O. BOX 2088
SANTA FE, NEW MEXICO 87501

OCT 27 1981

O. C. D.

ARTESIA, OFFICE

APPLICATION FOR PERMIT TO DRILL, DEEPEN, OR PLUG BACK

a. Type of Work	DRILL <input checked="" type="checkbox"/> DEEPEN <input type="checkbox"/> PLUG BACK <input type="checkbox"/>	7. Unit Agreement Name	
b. Type of Well	OIL WELL <input type="checkbox"/> GAS WELL <input checked="" type="checkbox"/> OTHER <input type="checkbox"/>	8. Term or Lease Name	Bishop RY Com
2. Name of Operator	Yates Petroleum Corporation	9. Well No.	1
3. Address of Operator	207 S. 4th Street, Artesia, NM 88210	10. Field and Pool, or Wildcat	Undes. Abo
4. Location of Well	UNIT LETTER P LOCATED 660 FEET FROM THE South LINE AND 660 FEET FROM THE East LINE OF SEC. 11 TWP. 6S RGE. 25e NADPM	12. County	Chaves
19. Proposed Depth	4350'	19A. Formation	Abo
20. Rotary or C.T.			Rotary
21. Elevations (Show whether DF, RL, etc.)	3854.0 GL	21A. Kind & Status Plug. Bond	Blanket
21B. Drilling Contractor	L & M	22. Approx. Date Work will start	ASAP

23. PROPOSED CASING AND CEMENT PROGRAM

SIZE OF HOLE	SIZE OF CASING	WEIGHT PER FOOT	SETTING DEPTH	SACKS OF CEMENT	EST. TOP
15"	10 3/4"	40.5# J-55	Approx. 900'	800 sx.	circulated
7 7/8" or 6 1/4"	4 1/2" or 5 1/2"	10.5# or 15.5#	TD	350 sx.	

We propose to drill and test the Abo and intermediate formations. Approximately 900' of surface casing will be set and cement circulated to shut off gravel and casing. If needed (lost circulation) 7 5/8" intermediate casing will be run to 1500' and cemented with enough cement calculated to tie back into the surface casing. Temperature survey will be run to determine cement top. If commercial, production casing will be run and cemented with adequate cover, perforate, and stimulate as needed for production.

MUD PROGRAM: FW gel and LCM 1500', Brine to 3500'. Brine & KCL water to TD. MW 10-10.2.

BOP PROGRAM: BOP's will be installed at approximately 1500', and tested daily.

GAS NOT DEDICATED:

APPROVAL VALID FOR 180 DAYS
PERMIT EXPIRES 7-29-82
UNLESS DRILLING UNDERWAY

Posted ID-1
API + NL Book
10-30-81

IN ABOVE SPACE DESCRIBE PROPOSED PROGRAM; IF PROPOSAL IS TO DEEPEN OR PLUG BACK, GIVE DATA ON PRESENT PRODUCTIVE ZONE AND PROPOSED NEW PRODUCTIVE ZONE. GIVE BLOWOUT PREVENTER PROGRAM, IF ANY.

I hereby certify that the information above is true and complete to the best of my knowledge and belief.

Signed [Signature] Title Regulatory Manager Date 10-26-81

(This space for State Use)

APPROVED BY [Signature] TITLE SUPERVISOR, DISTRICT II DATE OCT 29 1981

CONDITIONS OF APPROVAL, IF ANY:

**NEW MEXICO OIL CONSERVATION COMMISSION
WELL LOCATION AND ACREAGE DEDICATION PLAT**

Form C-102
Supersedes C-131
Effective 1-1-65

All distances must be from the outer boundaries of the Section.

Operator YATES PETROLEUM CORPORATION			Lease Bishop "RY" Com		Well No. 1
Unit Letter P	Section 11	Township 6S	Range 25E	County Chaves	
Actual Footage Location of Well: 660' feet from the South line and 660' feet from the East line					
Ground Level Elev. 3854.0	Producing Formation Alamo		Pool Alamo		Dedicated Acreage: 1.60 Acres

1. Outline the acreage dedicated to the subject well by colored pencil or hachure marks on the plat below.
2. If more than one lease is dedicated to the well, outline each and identify the ownership thereof (both as to working interest and royalty).
3. If more than one lease of different ownership is dedicated to the well, have the interests of all owners been consolidated by communitization, unitization, force-pooling, etc?

☒ Yes ☐ No If answer is "yes," type of consolidation UNITIZATION

If answer is "no," list the owners and tract descriptions which have actually been consolidated. (Use reverse side of this form if necessary.) _____

No allowable will be assigned to the well until all interests have been consolidated (by communitization, unitization, forced-pooling, or otherwise) or until a non-standard unit, eliminating such interests, has been approved by the Commission.

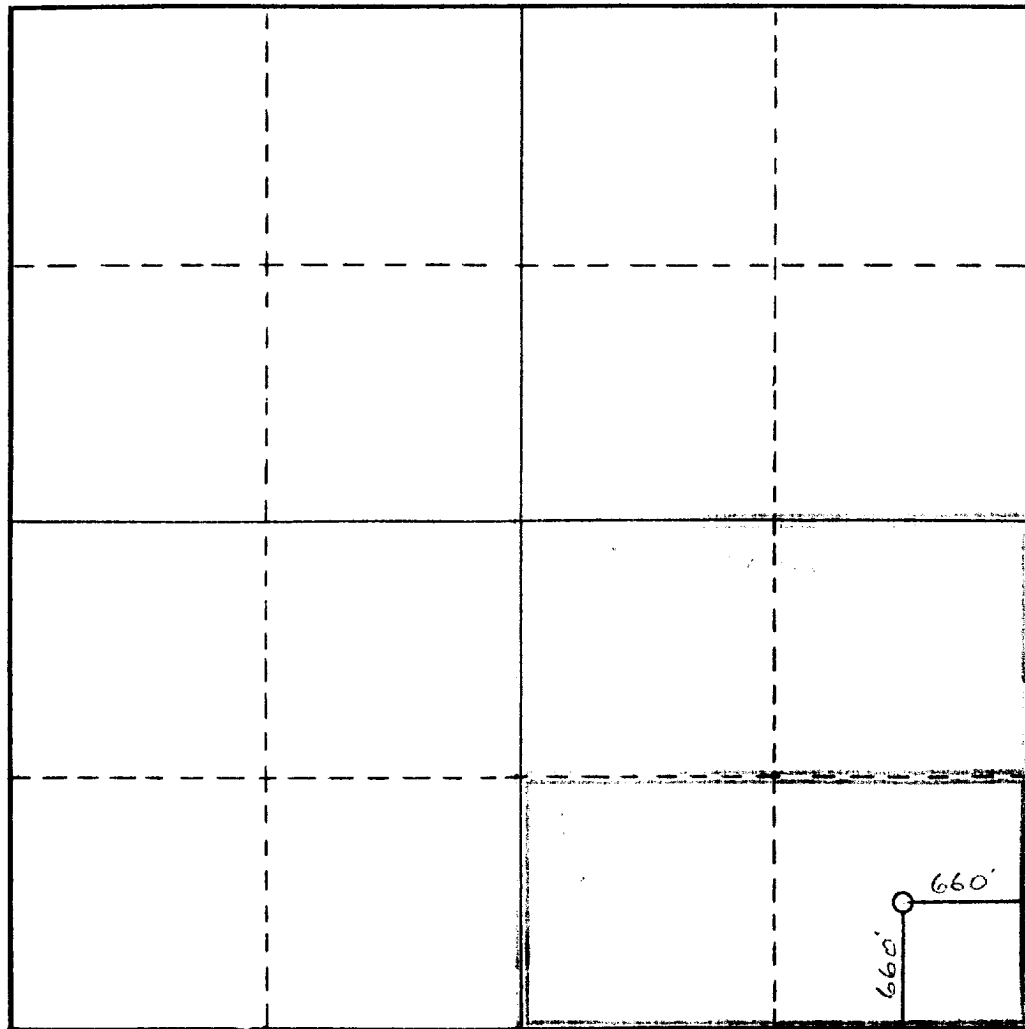

CERTIFICATION

I hereby certify that the information contained herein is true and complete to the best of my knowledge and belief.

Name
Gliserio Rodriquez
Position
Regulatory Manager
Company
Yates Petroleum Corp.
Date
10-26-81

I hereby certify that the well location shown on this plat was plotted from field notes or actual survey made by me or under my supervision and that the same is true and correct to the best of my knowledge and belief.

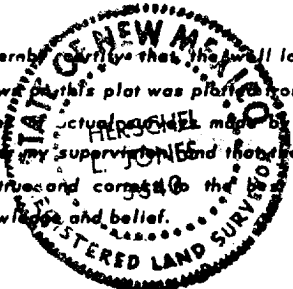

Date Surveyed
10-21-81

Registered Professional Engineer and/or Land Surveyor

[Signature]
Certificate No.
3640

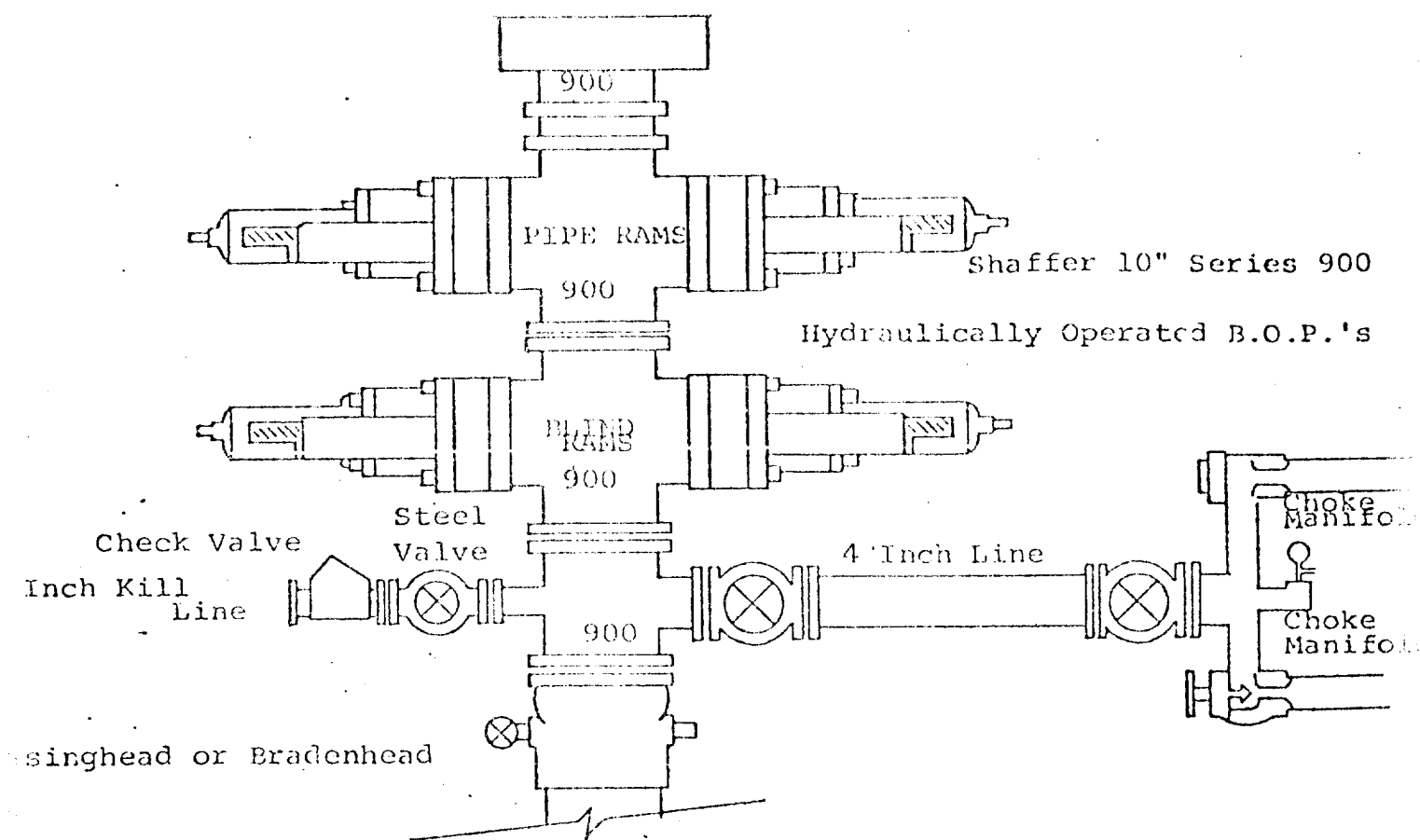

THE FOLLOWING CONSTITUTE MINIMUM BLOWOUT PREVENTER REQUIREMENTS

- All preventers to be hydraulically operated with secondary manual control installed prior to drilling out from under casing.
- Choke outlet to be a minimum of 4" diameter.
- Kill line to be of all steel construction of 2" minimum diameter.
- All connections from operating manifolds to preventers to be all steel, hole or tube a minimum of one inch in diameter.
- The available closing pressure shall be at least 15% in excess of that required with sufficient volume to operate the B.O.P.'s.
- All connections to and from preventer to have a pressure rating equivalent to that of the B.O.P.'s.
- Inside blowout preventer to be available on rig floor.
- Operating controls located a safe distance from the rig floor.
- Hole must be kept filled on trips below intermediate casing. Operator not responsible for blowouts resulting from not keeping hole full.
- B. O. P. float must be installed and used below zone of first gas intrusion.