

NO. OF COPIES RECEIVED		
DISTRIBUTION		
SANTA FE	1	
FILE	1	1
U.S.G.S.	2	
LAND OFFICE	1	
OPERATOR	1	

NEW MEXICO OIL CONSERVATION COMMISSION

30-005-61184

Form C-101
Revised 1-1-65

OCT 2 1981

O. C.

ARTESIA, GEN.

5A. Indicate Type of Lease STATE <input checked="" type="checkbox"/> FEE <input type="checkbox"/>
5. State Oil & Gas Lease No. L-6907
7. Unit Agreement Name
8. Farm or Lease Name Viking State
9. Well No. 1
10. Field and Pool, or Wildcat Wildcat Penn
12. County Chaves
19. Proposed Depth 6,200
19A. Formation Penn
20. Rotary or C.T. Rotary
21. Elevations (Show whether DF, RI, etc.) 3809 Grd.
21A. Kind & Status Plug. Bond Blanket
21B. Drilling Contractor Fred Pool
22. Approx. Date Work will start 10/25/81

APPLICATION FOR PERMIT TO DRILL, DEEPEN, OR PLUG BACK

1a. Type of Work DRILL <input checked="" type="checkbox"/> DEEPEN <input type="checkbox"/> PLUG BACK <input type="checkbox"/>
b. Type of Well OIL WELL <input type="checkbox"/> GAS WELL <input checked="" type="checkbox"/> OTHER <input type="checkbox"/> SINGLE ZONE <input type="checkbox"/> MULTIPLE ZONE <input type="checkbox"/>
2. Name of Operator ELK OIL COMPANY ✓
3. Address of Operator P. O. Box 310, Roswell, New Mexico 88201
4. Location of Well UNIT LETTER C LOCATED 990 FEET FROM THE North LINE AND 1980 FEET FROM THE West LINE OF SEC. 19 TWP. 9S RGE. 27E NMPM

PROPOSED CASING AND CEMENT PROGRAM

SIZE OF HOLE	SIZE OF CASING	WEIGHT PER FOOT	SETTING DEPTH	SACKS OF CEMENT	EST. TOP
12	8 5/8	24	950	600	circ.
7 7/8	5 1/2	15.5	6200	600	4000

BLOWOUT PREVENTION SYSTEM

See Attached

Acreage is undedicated at this time.

APPROVAL VALID FOR 180 DAYS
PERMIT EXPIRES 4-29-82
UNLESS DRILLING UNDERWAY

Posted ID-1
API & M. Arch.
10-30-81

IN ABOVE SPACE DESCRIBE PROPOSED PROGRAM: IF PROPOSAL IS TO DEEPEN OR PLUG BACK, GIVE DATA ON PRESENT PRODUCTIVE ZONE AND PROPOSED NEW PRODUCTIVE ZONE. GIVE BLOWOUT PREVENTER PROGRAM, IF ANY.

I hereby certify that the information above is true and complete to the best of my knowledge and belief.

Signed [Signature] Title President Date 10/21/81
(This space for State Use)

APPROVED BY W.A. Gressitt TITLE SUPERVISOR, DISTRICT II DATE OCT 29 1981

CONDITIONS OF APPROVAL, IF ANY:

NEW MEXICO OIL CONSERVATION COMMISSION
WELL LOCATION AND ACREAGE DEDICATION PLAT

RECEIVED

Form C-102
Supersedes C-128
Effective 1-1-65

OCT 28 1981

All distances must be from the outer boundaries of the Section.

Operator Elk Oil Company			Lease Viking State		O. C. D. ARTESIA, OFFICE	Well No. 1
Unit Letter C	Section 19	Township 9South	Range 27East	County Chaves		
Actual Footage Location of Well: 990 feet from the North line and 1980 feet from the West line						
Ground Level Elev. 3809.0'	Producing Formation Penn		Pool Wildcat	Dedicated Acreage: 320 40 Acres		

1. Outline the acreage dedicated to the subject well by colored pencil or hachure marks on the plat below.
2. If more than one lease is dedicated to the well, outline each and identify the ownership thereof (both as to working interest and royalty).
3. If more than one lease of different ownership is dedicated to the well, have the interests of all owners been consolidated by communitization, unitization, force-pooling, etc?

☒ Yes ☐ No If answer is "yes," type of consolidation Communitization

If answer is "no," list the owners and tract descriptions which have actually been consolidated. (Use reverse side of this form if necessary.)

No allowable will be assigned to the well until all interests have been consolidated (by communitization, unitization, forced-pooling, or otherwise) or until a non-standard unit, eliminating such interests, has been approved by the Commission.

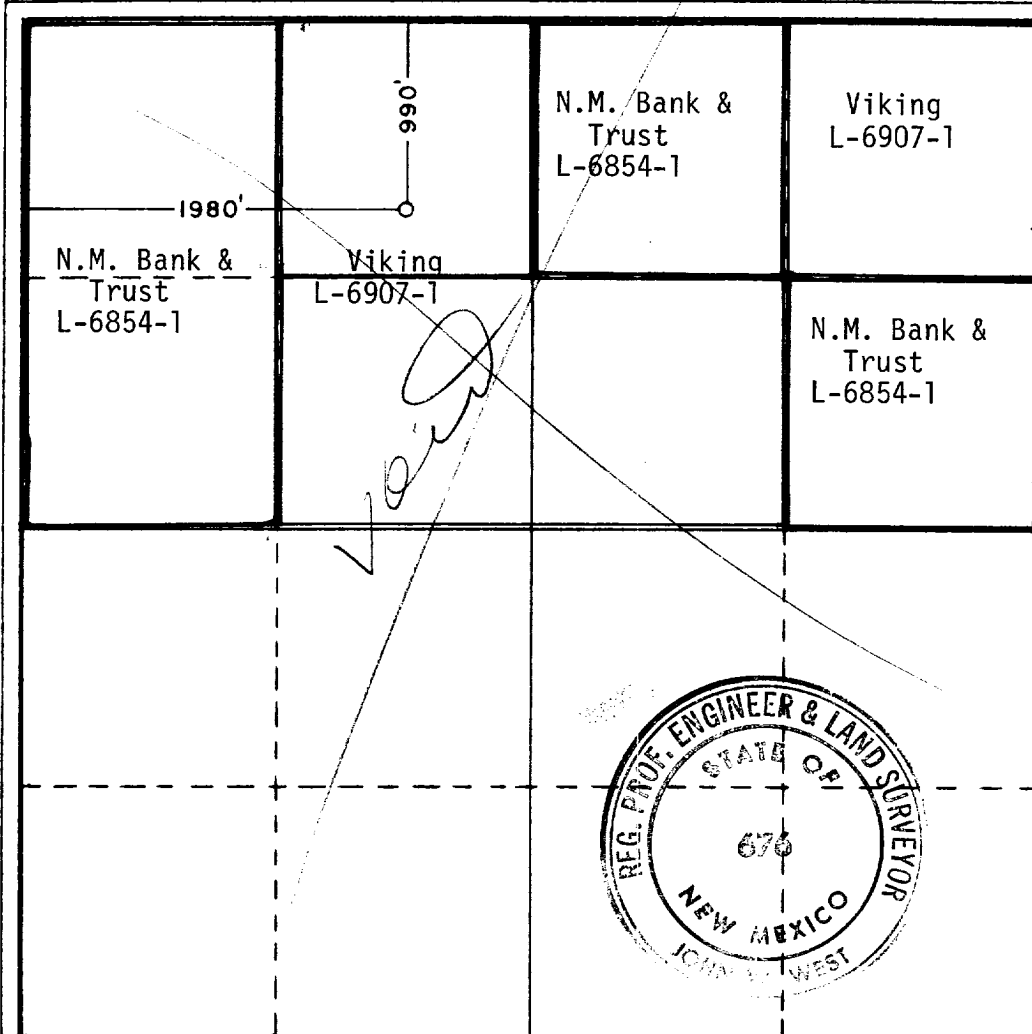

CERTIFICATION

I hereby certify that the information contained herein is true and complete to the best of my knowledge and belief.

Name
Joseph J. Kelly

Position
President

Company
Elk Oil Company

Date
10/21/81

I hereby certify that the well location shown on this plat was plotted from field notes of actual surveys made by me or under my supervision, and that the same is true and correct to the best of my knowledge and belief.

Date Surveyed
Sept. 4, 1981

Registered Professional Engineer and/or Land Surveyor

John W. West

Certificate No. **JOHN W. WEST 676**
PATRICK A. ROMERO 6663
Ronald J. Eldon 3239

0 330 660 990 1320 1650 1980 2310 2640 2970 3300 3630 3960 4290 4620 4950 5280 5610 5940 6270 6600

Fred Pool Drilling Co. Rig
Blowout Preventer Specifications

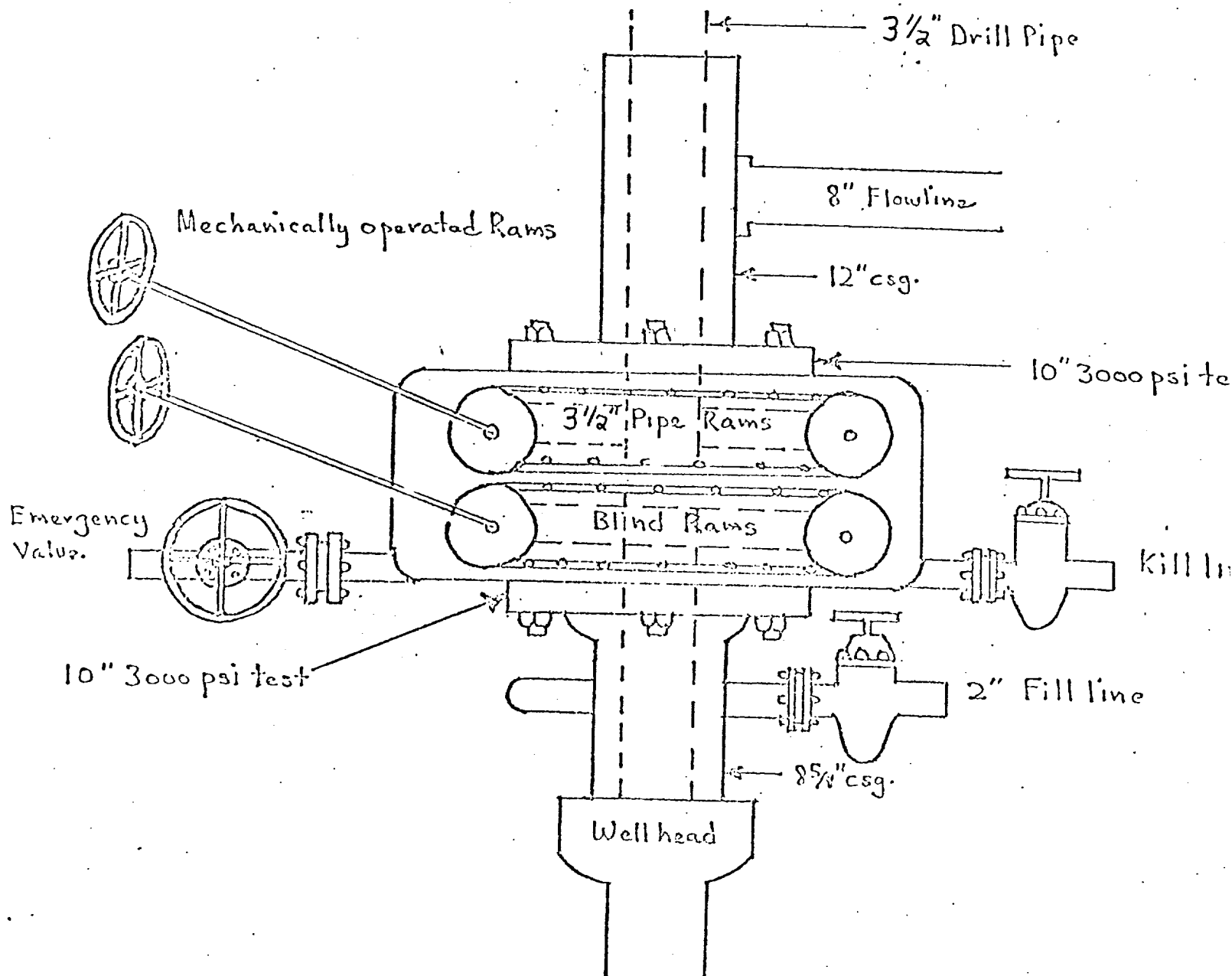

BOP's are Shaffer Double Rams Series 900, 10 inch. mechanically operated. Rated to 3000 psi. Rams consist of one 3 1/2 inch pipe rams and one blind rams. All connections and valves are 3000 psi working pressure.