

UNITED STATES
DEPARTMENT OF THE INTERIOR
GEOLOGICAL SURVEY

30-005-61189
5. LEASE DESIGNATION AND SERIAL NO.

N.M. 37845

6. IF INDIAN, ALLOTTEE OR TRIBE NAME

7. UNIT AGREEMENT NAME

8. FARM OR LEASE NAME

Sheehan Federal '30'

9. WELL NO.

10. FIELD AND POOL, OR WILDCAT

UNDESIGNATED ABO

11. SEC., T., R., M., OR BLK.
AND SURVEY OR AREA

Ut-C
Sec 30, T-5S, R-24E

12. COUNTY OR PARISH 13. STATE

Chaves N.M.

1a. TYPE OF WORK

DRILL ☒

DEEPEN ☐

PLUG BACK ☐

b. TYPE OF WELL

OIL WELL ☐

GAS WELL ☒

OTHER

SINGLE ZONE ☒

MULTIPLE ZONE ☐

2. NAME OF OPERATOR

ESTORIL PRODUCING CORP. ✓

3. ADDRESS OF OPERATOR

11th Floor Vaughn Bldg. Midland, Texas 79701

4. LOCATION OF WELL (Report location clearly and in accordance with any State requirements.)

At surface

Sec. 30, T-5S, R-24E 1980' FWL & 660' FNL

At proposed prod. zone

3850 ±

14. DISTANCE IN MILES AND DIRECTION FROM NEAREST TOWN OR POST OFFICE*

26 Miles north of Roswell, N.M.

15. DISTANCE FROM PROPOSED* LOCATION TO NEAREST PROPERTY OR LEASE LINE, FT. (Also to nearest drlg. unit line, if any)

1980' FWL & 660' FNL

18. DISTANCE FROM PROPOSED LOCATION* TO NEAREST WELL, DRILLING, COMPLETED, OR APPLIED FOR, ON THIS LEASE, FT.

N/A

16. NO. OF ACRES IN LEASE

400

17. NO. OF ACRES ASSIGNED TO THIS WELL

160

19. PROPOSED DEPTH

4000 ±

20. ROTARY OR CABLE TOOLS

Rotary

21. ELEVATIONS (Show whether DF, RT, GR, etc.)

4117.1 GR

22. APPROX. DATE WORK WILL START*

Sept. 25, 1981

23. PROPOSED CASING AND CEMENTING PROGRAM

SIZE OF HOLE	SIZE OF CASING	WEIGHT PER FOOT	SETTING DEPTH	QUANTITY OF CEMENT
17 1/2	13 3/8	48#	450 ±	595 sx Circulate
12 1/4	8 5/8	24#	1600 ±	881 sx Circulate
7 7/8	4 1/2	10.5#	4000 ±	930 sx Circulate

B.O.P.

Schaeffer model with 4 1/2" double rams: 3400 p.s.i. working pressure.

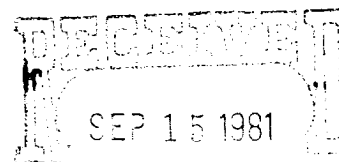

U.S. GEOLOGICAL SURVEY
ROSWELL, NEW MEXICO

Posted ID-1
API + NL Book
11-6-81

IN ABOVE SPACE DESCRIBE PROPOSED PROGRAM: If proposal is to deepen or plug back, give data on present productive zone and proposed new productive zone. If proposal is to drill or deepen directionally, give pertinent data on subsurface locations and measured and true vertical depths. Give blowout preventer program, if any.

24. SIGNED Terry W. Franklin TITLE AGENT DATE 8-27-81

(This space for Federal or State office use)

PERMIT NO. APPROVED

APPROVAL DATE

APPROVED BY

TITLE

DATE

CONDITIONS OF APPROVAL, IF ANY:

OCT 28 1981

JAMES A. CHILHAM
DISTRICT SUPERVISOR

NEW MEXICO OIL CONSERVATION COMMISSION
WELL LOCATION AND ACREAGE DEDICATION PLAT

Form C-132
Supersedes C-128
Effective 1-1-65

All distances must be from the outer boundaries of the Section

Operator ESTORIL PRODUCING CORP.			Lease SHEEHAN FED. LEASE		Well No. 12
Unit Letter C	Section 30	Township 5 SOUTH	Range 24 EAST	County CHAVES	
Actual Footage Location of Well: 1980 feet from the WEST line and 660 feet from the NORTH line					
Ground Level Elev. 4117.1	Producing Formation ABO		Pool UNDESIGNATED ABO		Dedicated Acreage: 160 Acres

- Outline the acreage dedicated to the subject well by colored pencil or hachure marks on the plat below.
- If more than one lease is dedicated to the well, outline each and identify the ownership thereof (both as to working interest and royalty).
- If more than one lease of different ownership is dedicated to the well, have the interests of all owners been consolidated by communitization, unitization, force-pooling, etc?

☐ Yes ☐ No If answer is "yes," type of consolidation _____

If answer is "no," list the owners and tract descriptions which have actually been consolidated. (Use reverse side of this form if necessary.) _____

No allowable will be assigned to the well until all interests have been consolidated (by communitization, unitization, forced-pooling, or otherwise) or until a non-standard unit, eliminating such interests, has been approved by the Commission.

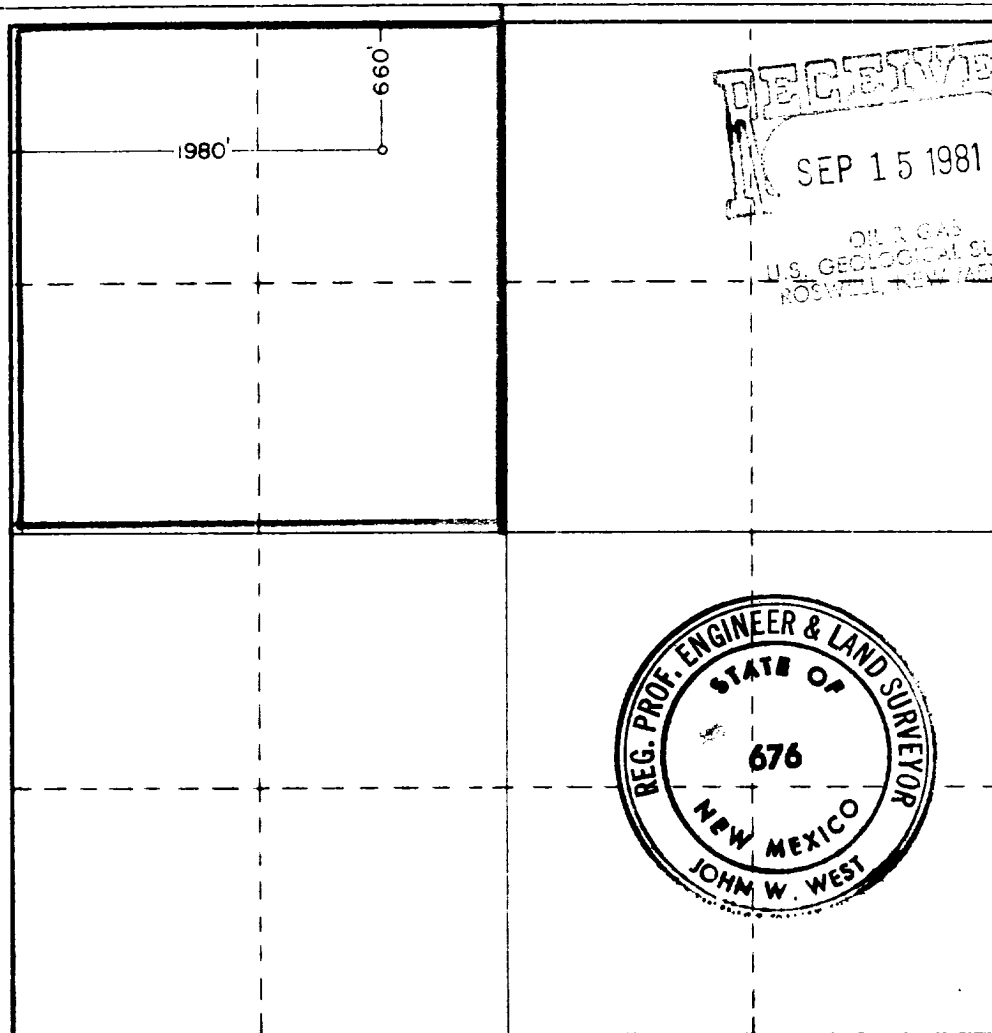

CERTIFICATION

I hereby certify that the information contained herein is true and complete to the best of my knowledge and belief.

Name **Jerry W. Franklin**

Position **AGENT**

Company **ESTORIL PRODUCING CORP.**

Date **9-2-81**

I hereby certify that the well location shown on this plat was plotted from field notes of actual surveys made by me or under my supervision, and that the same is true and correct to the best of my knowledge and belief.

Date Surveyed **8-18-81**

Registered Professional Engineer and/or Land Surveyor

John W. West

Certificate No **JOHN W. WEST 676**
PATRICK A. ROMERO 6683
Ronald J. Eidson 3239



APPLICATION TO DRILL

ESTORIL PRODUCING CORP.
Sheehan Federal '30' Well #2
1980' FWL & 660' FNL
Section 30, T-5S, R-24E
Chaves County, New Mexico

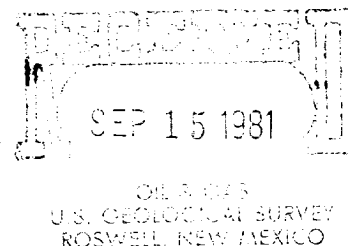

The following answers are provided for your consideration in response to your outline under Section II of Bulletin NTL-6:

1. Location: 1980' FWL & 660' FNL, Section 30, T-5S, R-24E, Chaves County, N.M.
2. Elevation Above Sea Level: 4117.1
3. Geologic Name of Surface Formation: Alluvium
4. Drilling Tools & Associated Equipment: Conventional rotary drilling tools using mud for the circulation medium.
5. Proposed Drilling Depth: 4000'
6. Estimated Geological Marker Tops: San Andres: 595'; Gloriotta: 1590' Abo: 3660'
7. Mineral Bearing Formation: Gas bearing at 3850'.
8. Casing Program: (A). Surface Casing: 13 3/8, 48# new casing.
(B). Intermediate Casing: 8 5/8, 24# new casing.
(C). Production Casing: 4 1/2, 10.5 # new casing.
9. Setting Depth of Casing & Cement for Same: (A). 13 3/8 casing set at 450'. Cement will be circulated to surface using 595 sacks of Class C cement. (B). 8 5/8 casing set at 1600'. Cement will be circulated to surface using 681 sacks of Pacesetter Lite C cement with 10 lb. of gilsonite per sack plus 1 lb. of Cello-Seal per sack, followed by 200 sacks of Class C plus 1% CaCl. (C). 4 1/2 casing set at 4000'. Cement will be circulated to surface using 730 sacks of Pacesetter Lite C plus 10 lb. salt per sack, 1/4 lb. Cello Seal, followed by 200 sacks of 50-50 Pozmix C plus 2% Gel and 6 lb. salt per sack.
10. Pressure Control Equipment: After intermediate casing is set, blowout preventers will be installed. They will be Schaeffer 4 1/2" double rams with 3400 p.s.i. working pressure. The blowout preventers will be tested to 1000 p.s.i. after they are installed.

11. Proposed Circulation Medium: Mud will be used for circulation for all depths in this well. If there is any change in the mud program, the U.S.G.S. will be notified. The following mud properties will be maintained. Viscosity sufficient to clean the hole; Weight 9.5 - 10.0 p.p.g. Viscosity 35 - 40 for good samples through the pay zone.
12. Testing, Logging, and Coring Program: (A). Testing: All testing will be commenced after the well has been drilled and casing has been set and cemented. (B). Logging: At total depth the following logs will be run; (1). Compensated Neutron Formation Density with Gamma Ray and Caliper. (2). Dual Laterolog - RXO (C). No coring is anticipated.
13. Potential Hazards: No abnormal pressure or temperature zones are anticipated.
14. Anticipated Starting Date and Duration of Operations: Sept 25 through Oct. 7 for drilling operations. Oct. 10 through Oct 20 for completion.
15. Other Facets of Operations: After running 4 1/2 casing, cased hole gamma ray correlation logs will be run from total depth over and above the pay zone. The Abo formation will then be perforated and treated. The well will then be tested for commercial production.