

STATE OF NEW MEXICO
ENERGY AND MINERALS DEPARTMENT

OIL CONSERVATION DIVISION

P. O. BOX 2086
SANTA FE, NEW MEXICO 87501

30-00561196

Form C-101
Revised 10-1-78

NO. OF COPIES RECEIVED	
DISTRIBUTION	
SANTA FE	1
FILL	1
U.S.G.S.	2
LAND OFFICE	
OPERATOR	1

OCT 28 1981

O. C. D.

ARTESIA OFFICE

APPLICATION FOR PERMIT TO DRILL, DEEPEN, OR PLUG BACK

a. Type of Work

DRILL ☒

DEEPEN ☐

PLUG BACK ☐

b. Type of Well

OIL WELL ☐

GAS WELL ☒

OTHER

SINGLE ZONE ☐

MULTIPLE ZONE ☐

c. Name of Operator

Stevens Operating Corporation

d. Address of Operator

P. O. Box 2203, Roswell, NM 88201

e. Location of Well

UNIT LETTER NE LOCATED 1980 FEET FROM THE North LINE

AND

660

FEET FROM THE West LINE OF SEC. 9 TWP. 5S RCE. 24E NMPM

5A. Indicate Type of Lease

STATE ☐

FEED ☒

5. State Oil & Gas Lease No.

7. Well Agreement Name

8. Farm or Lease Name

Sehested

9. Well No.

1

10. Field and Pool, or Wildcat

Undesignated Abo

12. County

Chaves

19. Proposed Depth

4100'

19A. Formation

Abo

20. Rotary or C.T.

Rotary

21. Elevations (show whether DE, RT, etc.)

4171.4 GR

21A. Kind & Status Plug. Bond

Statewide

21B. Drilling Contractor

Artesia Fishing Tool

22. Approx. Date Work will start

11/14/81

23.

PROPOSED CASING AND CEMENT PROGRAM

SIZE OF HOLE	SIZE OF CASING	WEIGHT PER FOOT	SETTING DEPTH	SACKS OF CEMENT	EST. TOP
14 3/4"	10 3/4"	32.75#	850'	Suff. to circ.	
9 7/8"	*	*	1300'	*	
7 7/8"	4 1/2"	10.50#	4100'	200 sacks	

- * If circulation cannot be maintained while drilling the 9 7/8" hole to 1300', 8 5/8" (24#) intermediate casing will be cemented at 1300' with 200 sacks of cement.

Will drill with water and mud to T.D., log, and if indicated productive case to T.D. Pay zones will be perforated and stimulated as needed for production.

APPROVAL VALID FOR 180 DAYS
PERMIT EXPIRES 5-5-82
UNLESS DRILLING UNDERWAY

IN ABOVE SPACE DESCRIBE PROPOSED PROGRAM: IF PROPOSAL IS TO DEEPEN OR PLUG BACK, GIVE DATA ON PRESENT PRODUCTIVE ZONE AND PROPOSED NEW PRODUCTIVE ZONE. GIVE BLOWOUT PREVENTER PROGRAM, IF ANY.

I hereby certify that the information above is true and complete to the best of my knowledge and belief.

Signed Pat Thompson Title Agent Date 10-19-81

(This space for State Use)

APPROVED BY Mike Williams TITLE DEPUTY DIRECTOR DATE NOV 15 1981

CONDITIONS OF APPROVAL, IF ANY:

Submit BOP program

Posted ID-1
API + NL Book
11-6-81

RECEIVED

NEW MEXICO OIL CONSERVATION COMMISSION
WELL LOCATION AND ACREAGE DEDICATION PLAT NOV 2 1981

Form C-102
Supersedes C-128
Effective 1-1-65

All distances must be from the outer boundaries of the Section

Operator Stevens Operating Co.			Lease Sehested		O. C. D. ARTESIA, OFFICE	Well No. 1
Unit Letter E	Section 9	Township 5 South	Range 24 East	County Chaves		
Actual Footage Location of Well: 1980 feet from the North line and 660 feet from the West line						
Ground Level Elev. 4029.0'	Producing Formation Abo		Foot Undesignated		Dedicated Acreage 160 Acres	

1. Outline the acreage dedicated to the subject well by colored pencil or hachure marks on the plat below.

2. If more than one lease is dedicated to the well, outline each and identify the ownership thereof (both as to working interest and royalty).

3. If more than one lease of different ownership is dedicated to the well, have the interests of all owners been consolidated by communitization, unitization, force-pooling, etc?

☐ Yes ☐ No If answer is "yes," type of consolidation _____

If answer is "no," list the owners and tract descriptions which have actually been consolidated. (Use reverse side of this form if necessary.) _____

No allowable will be assigned to the well until all interests have been consolidated (by communitization, unitization, forced-pooling, or otherwise) or until a non-standard unit, eliminating such interests, has been approved by the Commission.

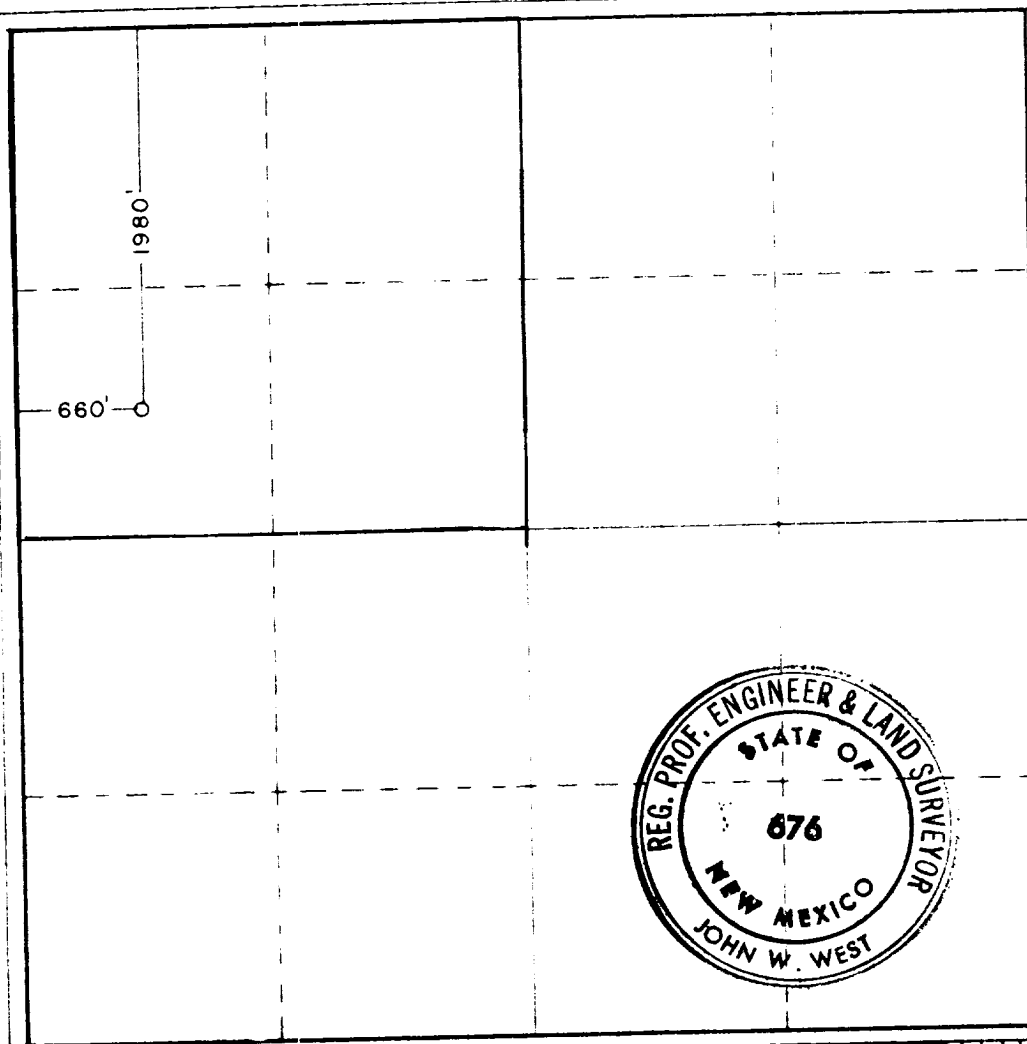

CERTIFICATION

I hereby certify that the information contained herein is true and complete to the best of my knowledge and belief.

Name

Donald G. Stevens

Position

President

Company

Stevens Oil Company

Date

10-26-81

I hereby certify that the well location shown on this plat was plotted from field notes of actual surveys made by me or under my supervision, and that the same is true and correct to the best of my knowledge and belief.

Date Surveyed

Oct. 19, 1981

Registered Professional Engineer and/or Land Surveyor

Certificate No.

JOHN W. WEST 676
PATRICK A. ROMERO 6668
Ronald J. Eidson 3239