

30-005-61128

Form C-101  
Revised 10-1-78

STATE OF NEW MEXICO  
ENERGY AND MINERALS DEPARTMENT

N.M. CONSERVATION DIVISION  
P. O. BOX 2088  
SANTA FE, NEW MEXICO 87501

NOV 03 1981

O. C. D.

NO. OF COPIES RECEIVED	
DISTRIBUTION	
SANTA FE	1
FILE	1
U.S.G.S.	2
LAND OFFICE	
OPERATOR	1

5A. Indicate Type of Lease  
STATE ☐ FEE ☒

5. State Oil & Gas Lease No.

7. Unit Agreement Name

8. Farm or Lease Name  
ACME

9. Well No.  
5

10. Field and Pool, or Wildcat  
UNDESIGNATED ABO

12. County  
CHAVES

APPLICATION FOR PERMIT TO DRILL, DEEPEN, OR PLUG BACK

1a. Type of Work  
DRILL ☒ DEEPEN ☐ PLUG BACK ☐  
b. Type of Well  
OIL WELL ☐ GAS WELL ☒ OTHER ☐ SINGLE ZONE ☒ MULTIPLE ZONE ☐

2. Name of Operator  
MESA PETROLEUM CO

3. Address of Operator  
1000 VAUGHN BUILDING/MIDLAND, TEXAS 79701-4493

4. Location of Well  
UNIT LETTER J LOCATED 1980 FEET FROM THE SOUTH LINE  
AND 1650 FEET FROM THE EAST LINE OF SEC. 25 TWP. 8S RGE. 25E NMPM

19. Proposed Depth 4700'	19A. Formation ABO	20. Rotary or C.T. ROTARY
21. Elevations (Show whether DF, RT, etc.) 3613.3	21A. Kind & Status Plug. Bond BLANKET	21B. Drilling Contractor TOM BROWN
		22. Approx. Date Work will start NOVEMBER 8, 1981

23. PROPOSED CASING AND CEMENT PROGRAM

SIZE OF HOLE	SIZE OF CASING	WEIGHT PER FOOT	SETTING DEPTH	SACKS OF CEMENT	EST. TOP
17 1/2"	13 3/8"	48#	900'	300/200/300	SURFACE
11"	8 5/8"	24#	1600'	500/300	ISOLATE WTR, O&G
7 7/8"	4 1/2"	10.5#	4700'	500/500	COVER ALL PAY

Propose to drill 17 1/2" hole to approximately 900', set 13 3/8" surface casing and cement to surface. Will reduce hole to 11" and drill to 1600' to set 8 5/8" casing. Will reduce hole to 7 7/8", nipple up RAM type BOP's, and drill to total depth. Drilling medium will be air, foam, or mud as required.

Gas Sales are dedicated.

APPROVAL VALID FOR 180 DAYS  
PERMIT EXPIRES 5-5-82  
UNLESS DRILLING UNDERWAY

XC: NMOCD(6), TLS, CEN RCDS, ACCTG, ROSWELL, MEC, LAND, PARTNERS, FILE, REM

IN ABOVE SPACE DESCRIBE PROPOSED PROGRAM: IF PROPOSAL IS TO DEEPEN OR PLUG BACK, GIVE DATA ON PRESENT PRODUCTIVE ZONE AND PROPOSED NEW PRODUCTIVE ZONE. GIVE BLOWOUT PREVENTER PROGRAM, IF ANY.

I hereby certify that the information above is true and complete to the best of my knowledge and belief.

Signed R. P. Mark Title REGULATORY COORDINATOR Date 11-2-81

(This space for State Use)

APPROVED BY Mike Williams TITLE MANAGER DATE NOV 03 1981

CONDITIONS OF APPROVAL, IF ANY:

Notify N.M.O.C.C. in sufficient time to witness cementing the 13 3/8 casing

**NEW MEXICO OIL CONSERVATION COMMISSION  
WELL LOCATION AND ACREAGE DEDICATION PLAT**

Form C-102  
Supersedes C-128  
Effective 1-1-65

All distances must be from the outer boundaries of the Section

Operator <b>Mesa Petroleum Co.</b>			Lease <b>Acme</b>		Well No. <b>5</b>
Tract Letter <b>J</b>	Section <b>25</b>	Township <b>8 South</b>	Range <b>25 East</b>	County <b>Chaves</b>	
Actual Location of Well: <div style="display: flex; justify-content: space-between;"> <span>1980 feet from the South line and</span> <span>1650 feet from the East line</span> </div>					
Ground Level Elev. <b>3613.3'</b>	Producing Formation <b>ABO</b>	Pool <b>UNDESIGNATED</b>		Dedicated Acreage: <b>SE4 160 Acres</b>	

1. Outline the acreage dedicated to the subject well by colored pencil or hachure marks on the plat below.
2. If more than one lease is dedicated to the well, outline each and identify the ownership thereof (both as to working interest and royalty).
3. If more than one lease of different ownership is dedicated to the well, have the interests of all owners been consolidated by communitization, unitization, force-pooling, etc?

☐ Yes    ☐ No    If answer is "yes," type of consolidation \_\_\_\_\_

If answer is "no," list the owners and tract descriptions which have actually been consolidated. (Use reverse side of this form if necessary.) \_\_\_\_\_

No allowable will be assigned to the well until all interests have been consolidated (by communitization, unitization, forced-pooling, or otherwise) or until a non-standard unit, eliminating such interests, has been approved by the Commission.

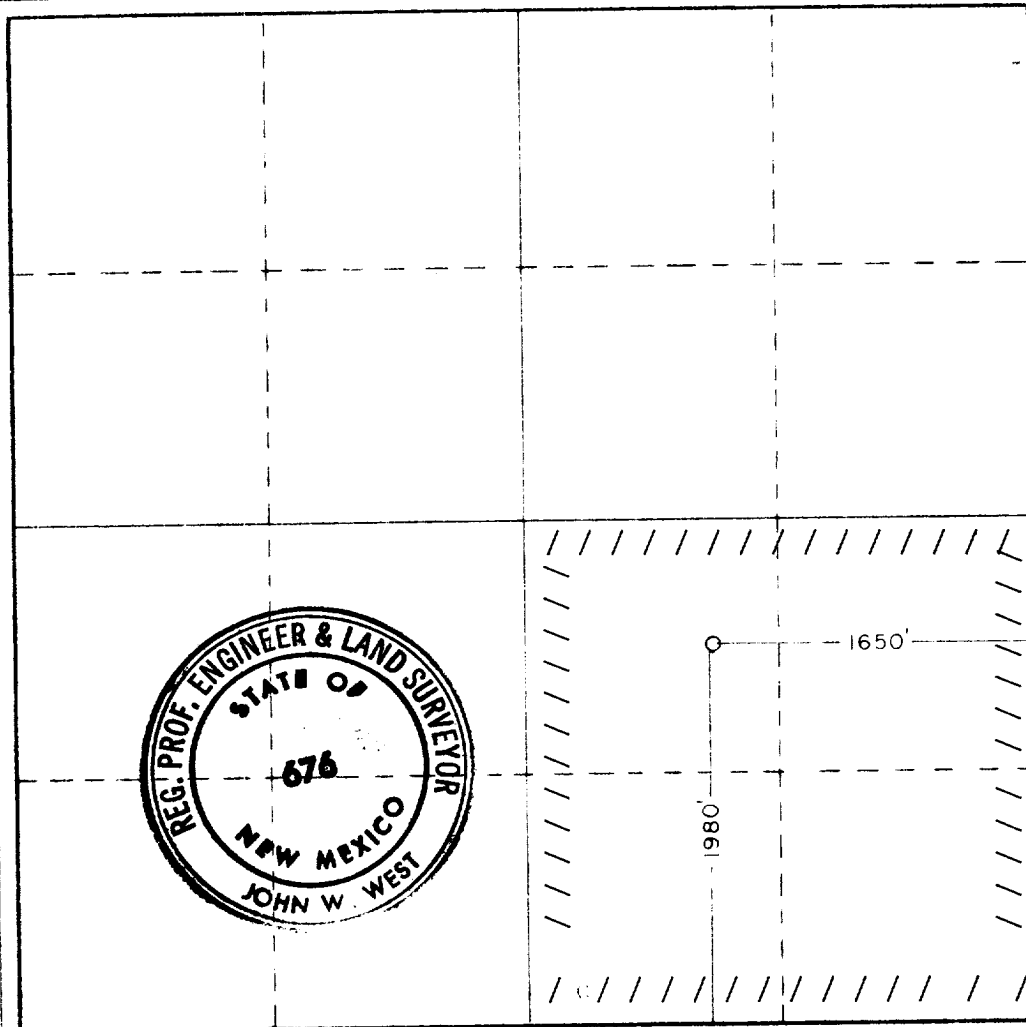

**CERTIFICATION**

I hereby certify that the information contained herein is true and complete to the best of my knowledge and belief.

*R. E. Mathis*

Name  
**R. E. MATHIS**  
Position  
**REGULATORY COORDINATOR**

Company  
**MESA PETROLEUM CO**

Date  
**11-2-81**

I hereby certify that the well location shown on this plat was plotted from field notes of actual surveys made by me or under my supervision, and that the same is true and correct to the best of my knowledge and belief.

Date Surveyed  
**Oct. 29, 1981**

Registered Professional Engineer and/or Land Surveyor

*Patrick A. Romero*

Certificate No. **JOHN W. WEST 676**  
**PATRICK A. ROMERO 8463**  
**Ronald J. Eldson 3239**