

NO. OF COPIES RECEIVED	
DISTRIBUTION	
SANTA FE	1
FILE	1
U.S.G.S.	1
LAND OFFICE	
OPERATOR	1

NEW MEXICO OIL CONSERVATION COMMISSION

RECEIVED

NOV 03 1981

O. C. D.

ARTESIA, OFFICE

30-005-61199

Form C-101
Revised 12-75

5A. Indicate Type of Lease
STATE ☐ FEDERAL ☒ XX
5. State Oil & Gas Lease No.

APPLICATION FOR PERMIT TO DRILL, DEEPEN, OR PLUG BACK

1a. Type of Work DRILL <input checked="" type="checkbox"/> DEEPEN <input type="checkbox"/> PLUG BACK <input type="checkbox"/>		7. Unit Agreement Name	
b. Type of Well OIL WELL <input checked="" type="checkbox"/> GAS WELL <input type="checkbox"/> OTHER <input type="checkbox"/> SINGLE ZONE <input type="checkbox"/> MULTIPLE ZONE <input type="checkbox"/>		8. Name of Lessee Name J. P. White	
2. Name of Operator Cibola Energy Corporation		9. Well No. 2	
3. Address of Operator P.O. Box 1668, Albuquerque, New Mexico 87103		10. Field and Locality or Well Name Race Track SA	
4. Location of Well UNIT LETTER P LOCATED 660 FEET FROM THE South LINE AND 660 FEET FROM THE East LINE OF SEC. 18 TWP. 10S RGE. 28E NMPM		11. County Chaves	
12. Proposed Depth 2275'		13A. Formation San Andres	
13B. Drilling Contractor Comanche Drilling		14. Approx. Date Work will start November 15, 1981	
21. Elevations (Show whether DF, RT, etc.) 3770.0 Gr.		21A. Kind & Status Plug. Bond Statewide	
21B. Drilling Contractor Comanche Drilling		21C. Date Work will start November 15, 1981	

23.

PROPOSED CASING AND CEMENT PROGRAM

SIZE OF HOLE	SIZE OF CASING	WEIGHT PER FOOT	SETTING DEPTH	SACKS OF CEMENT	EST. TOP
10"	8 5/8"	20#	400	85	circ.
8"	7"	20#	2275	150	2000

We propose to:

Drill a 10" hole and set 8 5/8" casing to 350'. Circulate cement to surface, WOC 18 hours. Test hole for fluid entry. If bailed dry, will commence drilling an 8" hole to 2275'. Run DLL with Mirroloaterolog, CNL-FDC-GR. We will set 7" casing to either TD or above P-1 zone depending on the outcome of the logs. In latter case, open hole completion with be attempted, in former case, casing will be perforated.

APPROVAL VALID FOR 180 DAYS
PERMIT EXPIRES 5-5-82
UNLESS DRILLING UNDERWAY

Posted ID
APE #NL Book
11-6-81

IN ABOVE SPACE DESCRIBE PROPOSED PROGRAM: IF PROPOSAL IS TO DEEPEN OR PLUG BACK, GIVE DATA ON PRESENT PRODUCTIVE ZONE AND PROPOSED NEW PRODUCTIVE ZONE. GIVE BLOWOUT PREVENTER PROGRAM, IF ANY.

I hereby certify that the information above is true and complete to the best of my knowledge and belief.

Signed Quito, D. S. S. Title Drilling Secretary Date 11-02-81

(This space for State Use)

APPROVED BY M. K. Williams TITLE OIL AND GAS INSPECTOR DATE NOV 05 1981

CONDITIONS OF APPROVAL, IF ANY:

NEW MEXICO OIL CONSERVATION COMMISSION
WELL LOCATION AND ACREAGE DEDICATION PLAT

Form C-102
Supersedes C-128
Effective 1-1-65

All distances must be from the outer boundaries of the Section.

Operator Cibola Energy Corporation Coronado Exploration Corp.		Lease J.P. White		Well No. 2
Unit Letter P	Section 18	Township 10 South	Range 28 East	County Chaves
Actual Footage Location of Well: 660 feet from the South line and 660 feet from the East line				
Ground Level Elev. 3770 Gr	Producing Formation San Andres	Pool Race Track SA	Dedicated Acreage: 40 Acres	

1. Outline the acreage dedicated to the subject well by colored pencil or hatchure marks on the plat below.
2. If more than one lease is dedicated to the well, outline each and identify the ownership thereof (both as to working interest and royalty).
3. If more than one lease of different ownership is dedicated to the well, have the interests of all owners been consolidated by communitization, unitization, force-pooling, etc?

☐ Yes ☒ No If answer is "yes," type of consolidation _____

If answer is "no," list the owners and tract descriptions which have actually been consolidated. (Use reverse side of this form if necessary.) All leases are held by operator and participating parties

No allowable will be assigned to the well until all interests have been consolidated (by communitization, unitization, forced-pooling, or otherwise) or until a non-standard unit, eliminating such interests, has been approved by the Commission.

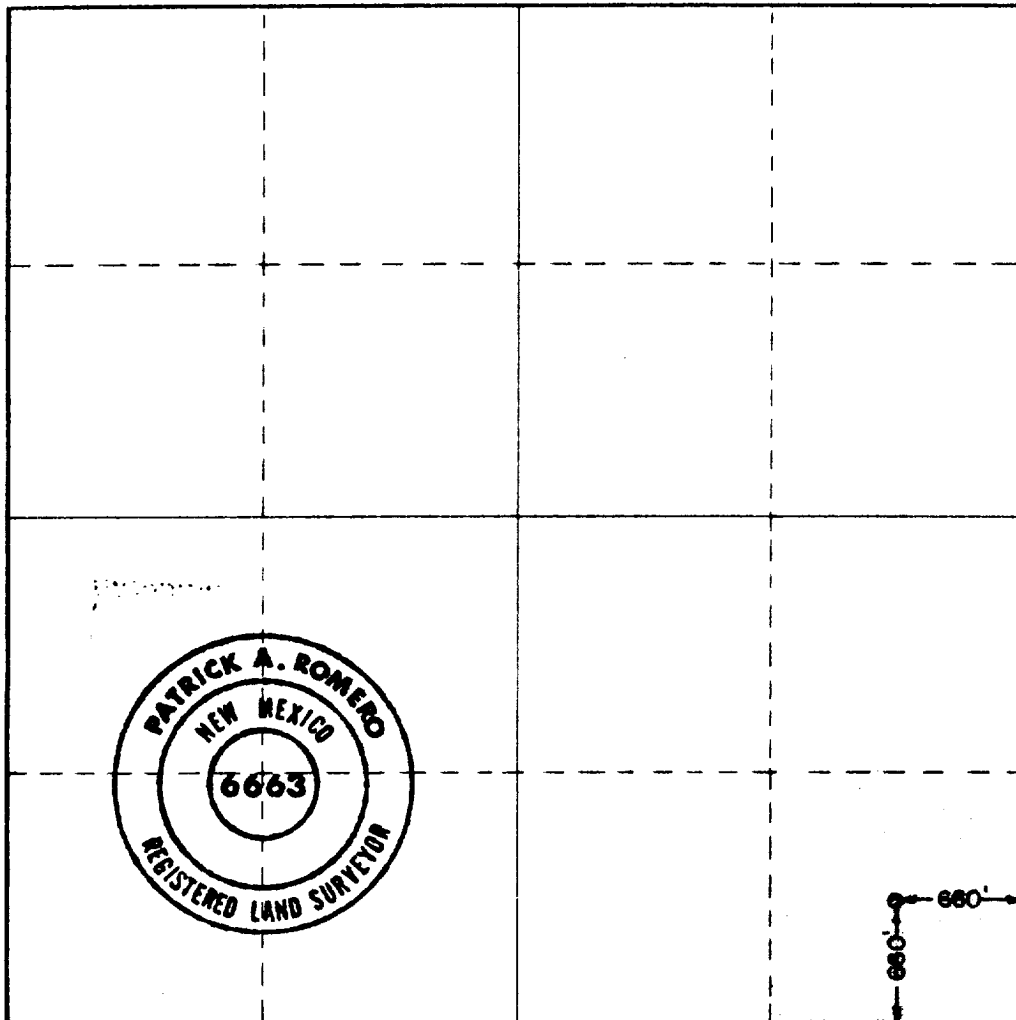

CERTIFICATION

I hereby certify that the information contained herein is true and complete to the best of my knowledge and belief.

[Signature]

Name

Phelps White

Position

Engineer

Company

**Cibola Energy Corp.
Coronado Expl. Corp.**

Date

April 28, 1980

I hereby certify that the well location shown on this plat was plotted from field notes of actual surveys made by me or under my supervision, and that the same is true and correct to the best of my knowledge and belief.

Date Surveyed

April 25, 1980

Registered Professional Engineer
and/or Land Surveyor

[Signature]

Certificate No. **JOHN W. WEST 676**
PATRICK A. ROMERO 6663
Ronald J. Eidson 3239

0 330 660 990 1320 1650 1980 2310 2640 2970 3300 3630 3960 4290 4620 4950 5280 5610 5940 6270 6600