



STATE OF NEW MEXICO  
ENERGY AND MINERALS DEPARTMENT  
OIL CONSERVATION DIVISION  
ARTESIA DISTRICT OFFICE

December 6, 1983

BRUCE KING  
GOVERNOR

LARRY KEHOE  
SECRETARY

P.O. DRAWER DD  
ARTESIA, NEW MEXICO 88210  
(505) 748-1283

Mesa Petroleum Co.  
1000 Vaughn Building  
Midland, Tx, 79701-4493

Re: Alkali Federal Com.  
#6-0-33-5-25  
Pecos Slope Abo

Gentlemen:

We are in receipt of the notice of gas connection from Transwestern Pipeline Co. dated November 9, 1982 on the above captioned well. However, no allowable will be assigned to this well until a copy of all logs run have been filed with this office.

Very truly yours,

*Leslie A. Clements*  
Leslie A. Clements  
District Supervisor

LAC/pw

N. M. OIL CONS. COMMISSION  
P. O. BOX 1980  
HOBBS, NEW MEXICO

Form Approved.  
Budget Bureau No. 42-R1424

c/SF

UNITED STATES  
DEPARTMENT OF THE INTERIOR  
GEOLOGICAL SURVEY

SUNDRY NOTICES AND REPORTS ON WELLS

(Do not use this form for proposals to drill or to deepen a well back to a different reservoir. Use Form 9-331-C for such proposals.)

1. oil ☐ well gas ☒ well other

2. NAME OF OPERATOR

Mesa Petroleum Co.

3. ADDRESS OF OPERATOR

1 Mesa Square, Amarillo Texas

4. LOCATION OF WELL (REPORT LOCATION CLEARLY. See space 17 below.)

AT SURFACE: 158 FSL and 2055 FEL

AT TOP PROD. INTERVAL:

AT TOTAL DEPTH:

16. CHECK APPROPRIATE BOX TO INDICATE NATURE OF NOTICE, REPORT, OR OTHER DATA

REQUEST FOR APPROVAL TO:

SUBSEQUENT REPORT OF:

TEST WATER SHUT-OFF ☐

FRACTURE TREAT ☐

SHOOT OR ACIDIZE ☐

REPAIR WELL ☐

PULL OR ALTER CASING ☐

MULTIPLE COMPLETE ☐

CHANGE ZONES ☐

ABANDON\* ☐

(other) To correct footage.

5. LEASE

88240 NM 40029

6. IF INDIAN, ALLOTTEE OR TRIBE NAME

7. UNIT AGREEMENT NAME

8. FARM OR LEASE NAME

Alkali Federal Com.

9. WELL NO.

6

10. FIELD OR WILDCAT NAME

Undesignated ABO

11. SEC., T., R., M., OR BLK. AND SURVEY OR AREA

Section 33, T5S., R.25E.

12. COUNTY OR PARISH 13. STATE

Chaves

New Mexico

14. API NO.

15. ELEVATIONS (SHOW DF, KDB, AND WD)

(NOTE: Report results of multiple completion or zone change on Form 9-330.)

17. DESCRIBE PROPOSED OR COMPLETED OPERATIONS (Clearly state all pertinent details, and give pertinent dates, including estimated date of starting any proposed work. If well is directionally drilled, give subsurface locations and measured and true vertical depths for all markers and zones pertinent to this work.)\*

Survey for pipeline to connect this well, found that this well was not constructed at the proper footage of,

400 FSL & 1980 FEL.

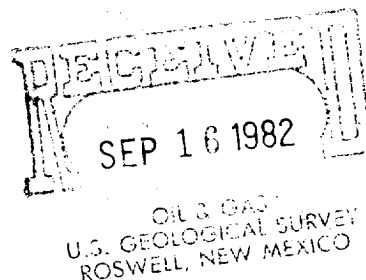

Subsurface Safety Valve: Manu. and Type \_\_\_\_\_ Set @ \_\_\_\_\_ Ft.

18. I hereby certify that the foregoing is true and correct

SIGNED [Signature] TITLE Regulatory Agent DATE 9-16-82

(This space for Federal or State office use)

APPROVED BY \_\_\_\_\_ TITLE \_\_\_\_\_ DATE \_\_\_\_\_  
CONDITIONS OF APPROVAL, IF ANY:

\*See Instructions on Reverse Side

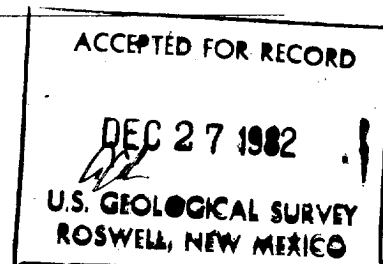

All distances must be from the outer boundaries of the Section.

Operator <b>Mesa Petroleum Co.</b>		Lease <b>Alkali Federal</b>		Well No. <b>#6</b>
Unit Letter <b>0</b>	Section <b>33</b>	Township <b>5 South</b>	Range <b>25 East</b>	County <b>Chaves</b>
Actual Postage Location of Well: <b>158</b> feet from the <b>South</b> line and <b>2055</b> feet from the <b>East</b> line				
Ground Level Elev. <b>3700</b>	Producing Formation <b>ABO</b>	Pool <b>UNDESIGNATED</b>		Dedicated Acreage: <b>SE 1/4 160 Acres</b>

1. Outline the acreage dedicated to the subject well by colored pencil or hatchure marks on the plat below.
2. If more than one lease is dedicated to the well, outline each and identify the ownership thereof (both as to working interest and royalty).
3. If more than one lease of different ownership is dedicated to the well, have the interests of all owners been consolidated by communitization, unitization, force-pooling, etc?

☐ Yes ☐ No If answer is "yes," type of consolidation \_\_\_\_\_

If answer is "no," list the owners and tract descriptions which have actually been consolidated. (Use reverse side of this form if necessary.) \_\_\_\_\_

No allowable will be assigned to the well until all interests have been consolidated (by communitization, unitization, forced-pooling, or otherwise) or until a non-standard unit, eliminating such interests, has been approved by the Division.

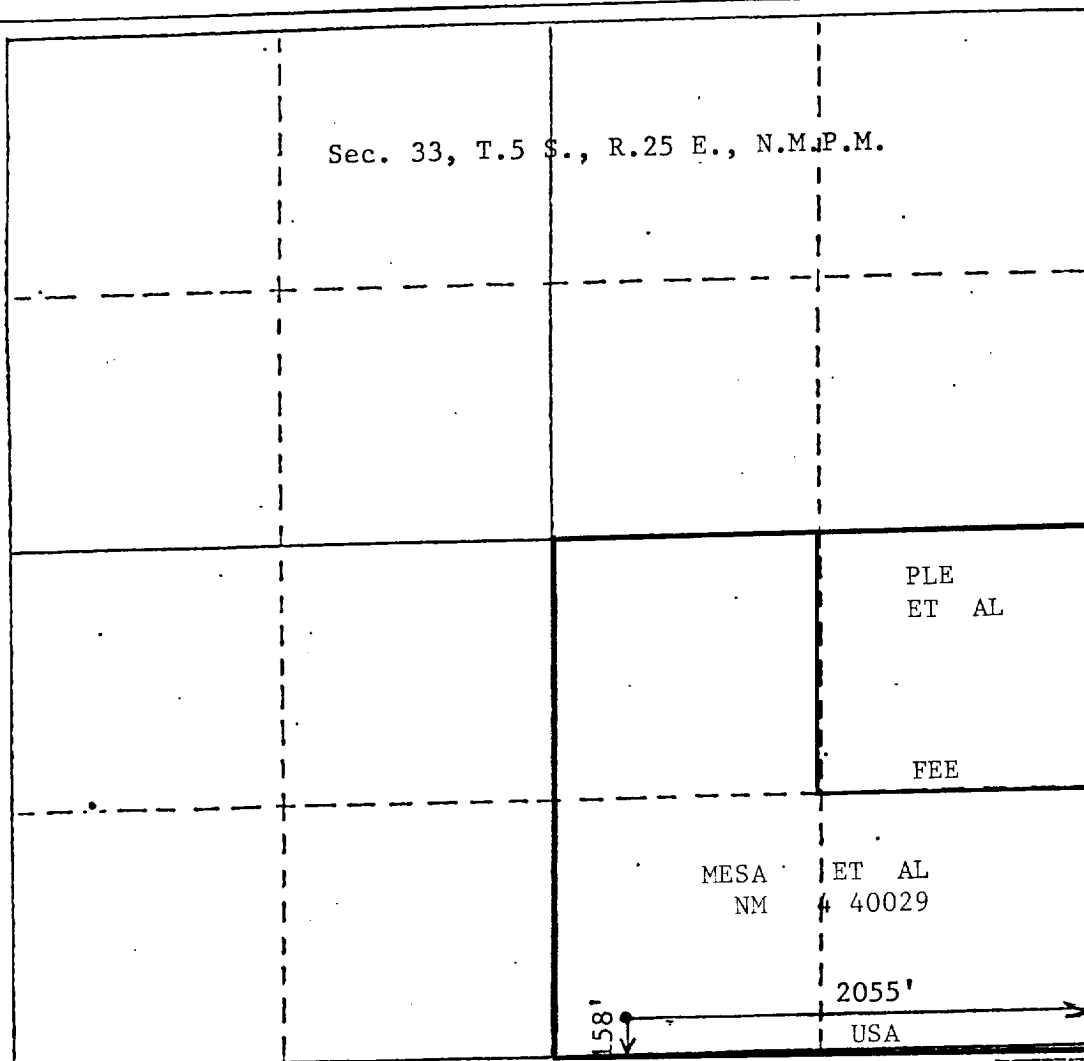

CERTIFICATION

I hereby certify that the information contained herein is true and complete to the best of my knowledge and belief.

*Lloyd Reed*  
Name

Lloyd Reed  
Position

Regulatory Agent  
Company

Mesa Petroleum Co.  
Date

16 Sept. 82

I hereby certify that the well location shown on this plat was plotted from field notes of actual surveys made by me or under my supervision, and that the same is true and correct to the best of my knowledge and belief.

JOHN D. JAKUES  
Date Surveyed  
Sept. 10 1982

Registered Professional Engineer  
and/or Land Surveyor

JOHN D. JAKUES  
Certificate No. 6290  
Professional Engineer