

STATE OF NEW MEXICO
ENERGY AND MINERALS DEPARTMENT

CONSERVATION DIVISION
P. O. BOX 2088
SANTA FE, NEW MEXICO 87501

30-005-61249
Form C-101
Revised 10-1-78

NO. OF COPIES RECEIVED	
DISTRIBUTION	
SANTA FE	1
FILE	1
U.S.G.S.	2
LAND OFFICE	1
OPERATOR	1

NOV 30 1981

O. C. D.
ARTESIA, OFFICE

5A. Indicate Type of Lease
STATE ☐ FEE ☒
5. State Oil & Gas Lease No.

APPLICATION FOR PERMIT TO DRILL, DEEPEN, OR PLUG BACK

7. Unit Agreement Name

8. Farm or Lease Name
Blanco

9. Well No.
2

10. Field and Pool, or Wildcat
Undesignated ABO

12. County
Chaves

20. Rotary or C.T.
ROTARY

22. Approx. Date Work will start
December 27, 1981

21A. Kind & Status Plug. Bond
BLANKET

21B. Drilling Contractor
Desert Drilling

21. Elevations (Show whether DF, RT, etc.)
3729' GR

19. Proposed Depth
4400'

19A. Formation
ABO

19B. Proposed Depth
4400'

19C. Formation
ABO

19D. Proposed Depth
4400'

19E. Formation
ABO

19F. Proposed Depth
4400'

19G. Formation
ABO

19H. Proposed Depth
4400'

19I. Formation
ABO

19J. Proposed Depth
4400'

19K. Formation
ABO

19L. Proposed Depth
4400'

19M. Formation
ABO

19N. Proposed Depth
4400'

19O. Formation
ABO

19P. Proposed Depth
4400'

19Q. Formation
ABO

19R. Proposed Depth
4400'

19S. Formation
ABO

19T. Proposed Depth
4400'

19U. Formation
ABO

19V. Proposed Depth
4400'

19W. Formation
ABO

19X. Proposed Depth
4400'

19Y. Formation
ABO

19Z. Proposed Depth
4400'

19AA. Formation
ABO

19AB. Proposed Depth
4400'

19AC. Formation
ABO

19AD. Proposed Depth
4400'

19AE. Formation
ABO

19AF. Proposed Depth
4400'

19AG. Formation
ABO

19AH. Proposed Depth
4400'

19AI. Formation
ABO

19AJ. Proposed Depth
4400'

19AK. Formation
ABO

19AL. Proposed Depth
4400'

19AM. Formation
ABO

19AN. Proposed Depth
4400'

19AO. Formation
ABO

19AP. Proposed Depth
4400'

19AQ. Formation
ABO

19AR. Proposed Depth
4400'

19AS. Formation
ABO

19AT. Proposed Depth
4400'

19AU. Formation
ABO

19AV. Proposed Depth
4400'

19AW. Formation
ABO

19AX. Proposed Depth
4400'

19AY. Formation
ABO

19AZ. Proposed Depth
4400'

19BA. Formation
ABO

19BB. Proposed Depth
4400'

19BC. Formation
ABO

19BD. Proposed Depth
4400'

19BE. Formation
ABO

19BF. Proposed Depth
4400'

19BG. Formation
ABO

19BH. Proposed Depth
4400'

19BI. Formation
ABO

19BJ. Proposed Depth
4400'

19BK. Formation
ABO

19BL. Proposed Depth
4400'

19BM. Formation
ABO

19BN. Proposed Depth
4400'

19BO. Formation
ABO

19BP. Proposed Depth
4400'

19BQ. Formation
ABO

19BR. Proposed Depth
4400'

19BS. Formation
ABO

19BT. Proposed Depth
4400'

19BU. Formation
ABO

19BV. Proposed Depth
4400'

19BW. Formation
ABO

19BX. Proposed Depth
4400'

19BY. Formation
ABO

19BZ. Proposed Depth
4400'

19CA. Formation
ABO

19CB. Proposed Depth
4400'

19CC. Formation
ABO

19CD. Proposed Depth
4400'

19CE. Formation
ABO

19CF. Proposed Depth
4400'

19CG. Formation
ABO

19CH. Proposed Depth
4400'

19CI. Formation
ABO

19CJ. Proposed Depth
4400'

19CK. Formation
ABO

19CL. Proposed Depth
4400'

19CM. Formation
ABO

19CN. Proposed Depth
4400'

19CO. Formation
ABO

19CP. Proposed Depth
4400'

19CQ. Formation
ABO

19CR. Proposed Depth
4400'

19CS. Formation
ABO

19CT. Proposed Depth
4400'

19CU. Formation
ABO

19CV. Proposed Depth
4400'

19CW. Formation
ABO

19CX. Proposed Depth
4400'

19CY. Formation
ABO

19CZ. Proposed Depth
4400'

19DA. Formation
ABO

19DB. Proposed Depth
4400'

19DC. Formation
ABO

19DD. Proposed Depth
4400'

19DE. Formation
ABO

19DF. Proposed Depth
4400'

19DG. Formation
ABO

19DH. Proposed Depth
4400'

19DI. Formation
ABO

19DJ. Proposed Depth
4400'

19DK. Formation
ABO

19DL. Proposed Depth
4400'

19DM. Formation
ABO

19DN. Proposed Depth
4400'

19DO. Formation
ABO

19DP. Proposed Depth
4400'

19DQ. Formation
ABO

19DR. Proposed Depth
4400'

19DS. Formation
ABO

19DT. Proposed Depth
4400'

19DU. Formation
ABO

19DV. Proposed Depth
4400'

19DW. Formation
ABO

19DX. Proposed Depth
4400'

19DY. Formation
ABO

19DZ. Proposed Depth
4400'

19EA. Formation
ABO

19EB. Proposed Depth
4400'

19EC. Formation
ABO

19ED. Proposed Depth
4400'

19EE. Formation
ABO

19EF. Proposed Depth
4400'

19EG. Formation
ABO

19EH. Proposed Depth
4400'

19EI. Formation
ABO

19EJ. Proposed Depth
4400'

19EK. Formation
ABO

19EL. Proposed Depth
4400'

19EM. Formation
ABO

19EN. Proposed Depth
4400'

19EO. Formation
ABO

19EP. Proposed Depth
4400'

19EQ. Formation
ABO

19ER. Proposed Depth
4400'

19ES. Formation
ABO

19ET. Proposed Depth
4400'

19EU. Formation
ABO

19EV. Proposed Depth
4400'

19EW. Formation
ABO

19EX. Proposed Depth
4400'

19EY. Formation
ABO

19EZ. Proposed Depth
4400'

19FA. Formation
ABO

19FB. Proposed Depth
4400'

19FC. Formation
ABO

19FD. Proposed Depth
4400'

19FE. Formation
ABO

19FF. Proposed Depth
4400'

19FG. Formation
ABO

19FH. Proposed Depth
4400'

19FI. Formation
ABO

19FJ. Proposed Depth
4400'

19FK. Formation
ABO

19FL. Proposed Depth
4400'

19FM. Formation
ABO

19FN. Proposed Depth
4400'

19FO. Formation
ABO

19FP. Proposed Depth
4400'

19FQ. Formation
ABO

19FR. Proposed Depth
4400'

19FS. Formation
ABO

19FT. Proposed Depth
4400'

19FU. Formation
ABO

19FV. Proposed Depth
4400'

19FW. Formation
ABO

19FX. Proposed Depth
4400'

19FY. Formation
ABO

19FZ. Proposed Depth
4400'

19GA. Formation
ABO

19GB. Proposed Depth
4400'

19GC. Formation
ABO

19GD. Proposed Depth
4400'

19GE. Formation
ABO

19GF. Proposed Depth
4400'

19GG. Formation
ABO

19GH. Proposed Depth
4400'

19GI. Formation
ABO

19GJ. Proposed Depth
4400'

19GK. Formation
ABO

19GL. Proposed Depth
4400'

19GM. Formation
ABO

19GN. Proposed Depth
4400'

19GO. Formation
ABO

19GP. Proposed Depth
4400'

19GQ. Formation
ABO

19GR. Proposed Depth
4400'

19GS. Formation
ABO

19GT. Proposed Depth
4400'

19GU. Formation
ABO

19GV. Proposed Depth
4400'

19GW. Formation
ABO

19GX. Proposed Depth
4400'

19GY. Formation
ABO

19GZ. Proposed Depth
4400'

19HA. Formation
ABO

19HB. Proposed Depth
4400'

19HC. Formation
ABO

19HD. Proposed Depth
4400'

19HE. Formation
ABO

19HF. Proposed Depth
4400'

19HG. Formation
ABO

19HH. Proposed Depth
4400'

19HI. Formation
ABO

19HJ. Proposed Depth
4400'

19HK. Formation
ABO

19HL. Proposed Depth
4400'

19HM. Formation
ABO

19HN. Proposed Depth
4400'

19HO. Formation
ABO

19HP. Proposed Depth
4400'

19HQ. Formation
ABO

19HR. Proposed Depth
4400'

19HS. Formation
ABO

All distances must be from the outer boundaries of the Section.

Operator Mesa Petroleum Co.			Lease Blanco		Well No. #2
Unit Letter G	Section 12	Township 7 South	Range 25 East	County Chaves	
Actual Postage Location of Well: 1980 feet from the North line and 1980 feet from the East line					
Ground Level Elev. 3729	Producing Formation ABO	Pool UNDESIGNATED		Dedicated Acreage: NE 4 160 Acres	

1. Outline the acreage dedicated to the subject well by colored pencil or hatchure marks on the plat below.
2. If more than one lease is dedicated to the well, outline each and identify the ownership thereof (both as to working interest and royalty).
3. If more than one lease of different ownership is dedicated to the well, have the interests of all owners been consolidated by communitization, unitization, force-pooling, etc?

☐ Yes ☐ No If answer is "yes," type of consolidation _____

If answer is "no," list the owners and tract descriptions which have actually been consolidated. (Use reverse side of this form if necessary.) _____

No allowable will be assigned to the well until all interests have been consolidated (by communitization, unitization, forced-pooling, or otherwise) or until a non-standard unit, eliminating such interests, has been approved by the Division.

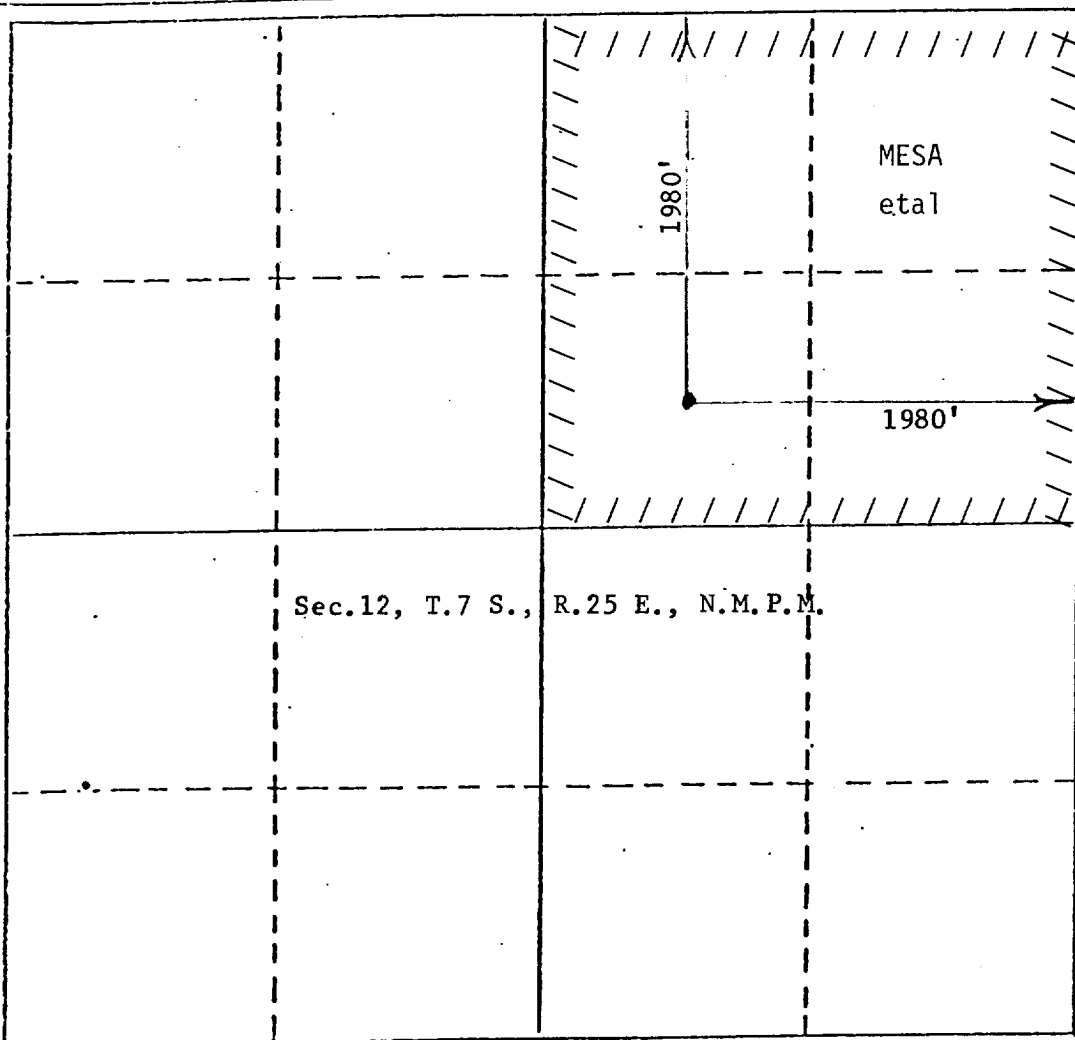

CERTIFICATION

I hereby certify that the information contained herein is true and complete to the best of my knowledge and belief.

R. E. Mathis

Name
R. E. Mathis
Position
Regulatory Coordinator
Company
Mesa Petroleum Co.
Date
11-23-81

I hereby certify that the well location shown on this plat was plotted from field notes of actual survey made by me or under my supervision, and that the same is true and correct to the best of my knowledge and belief.

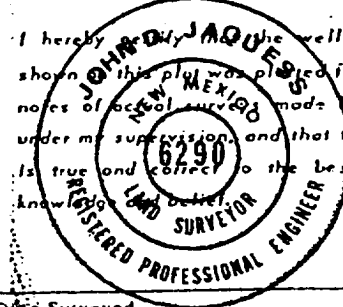

Date Surveyed
November 18, 1981
Registered Professional Engineer
and/or Land Surveyor
John D. Jaquess
John D. Jaquess, P.E. & L.S.
Certificate No.
6290

