

All distances must be from the outer boundaries of the Section.

Operator <b>Mesa Petroleum Co.</b>		Lease <b>Alkali Federal</b>		Well No. <b>7</b>
Unit Letter <b>G</b>	Section <b>22</b>	Township <b>5 South</b>	Range <b>25 East</b>	County <b>Chaves</b>
Actual Postage Location of Well: <b>2280</b> feet from the <b>North</b> line and <b>1680</b> feet from the <b>East</b> line				
Ground Level Elev. <b>3696</b>	Producing Formation <b>ABO</b>	Pool <b>UNDESIGNATED</b>		Dedicated Acreage: <b>NE 4 160</b> Acres

1. Outline the acreage dedicated to the subject well by colored pencil or hachure marks on the plat below.
2. If more than one lease is dedicated to the well, outline each and identify the ownership thereof (both as to working interest and royalty).
3. If more than one lease of different ownership is dedicated to the well, have the interests of all owners been consolidated by communitization, unitization, force-pooling, etc?

☐ Yes ☐ No If answer is "yes," type of consolidation \_\_\_\_\_

If answer is "no," list the owners and tract descriptions which have actually been consolidated. (Use reverse side of this form if necessary.) \_\_\_\_\_

No allowable will be assigned to the well until all interests have been consolidated (by communitization, unitization, forced-pooling, or otherwise) or until a non-standard unit, eliminating such interests, has been approved by the Division.

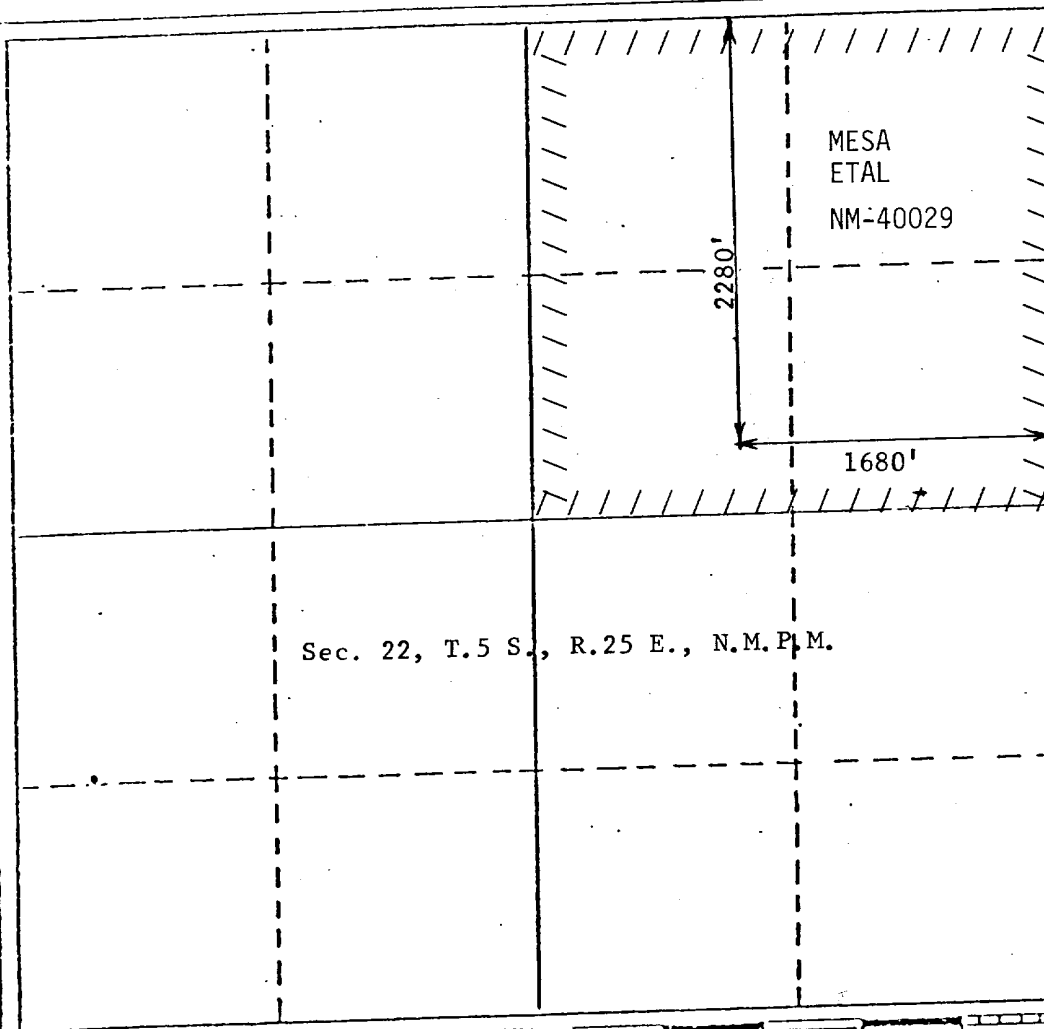

CERTIFICATION

I hereby certify that the information contained herein is true and complete to the best of my knowledge and belief.

*R. E. Mathis*

Name  
**R. E. Mathis**

Position  
**Regulatory Coordinator**

Company  
**Mesa Petroleum Co.**

Date  
**11-6-81**

I hereby certify that the well location shown on this plat was plotted from field notes of actual surveys made by me or under my supervision, and that the same is true and correct to the best of my knowledge and belief.

Date Surveyed  
**October 28 1981**

Registered Professional Engineer and/or Land Surveyor  
**John D. Jaques**

Professional Engineer  
**John D. Jaques**

Certificate No.  
**6290**

Blow-out Preventers hydril and choke manifold are all 900 Series

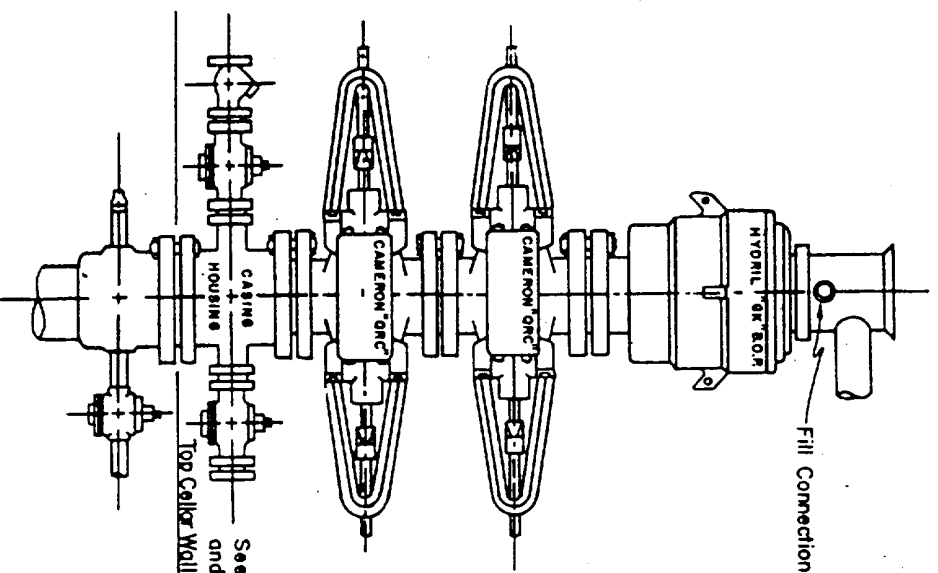

3,000 PSI WORKING PRESSURE  
BLOW-OUT PREVENTER HOOK-UP

See Detail of 4" Flow Line  
and Choke Assembly

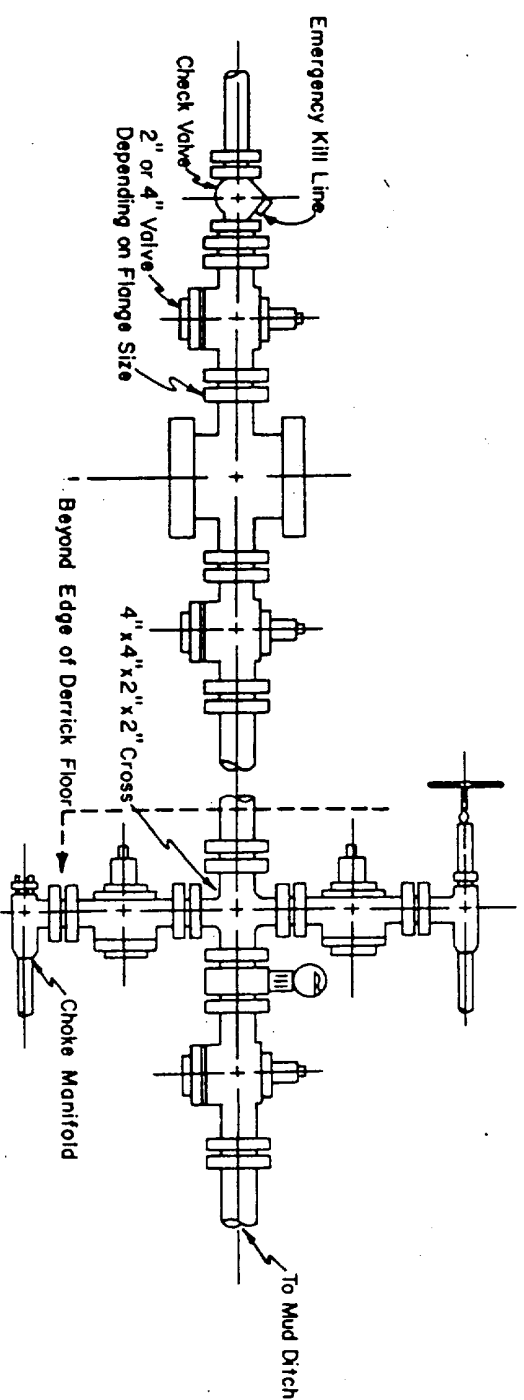

3,000 PSI WORKING PRESSURE  
KILL, CHOKE, AND FILL CONNECTIONS

DETAIL OF 4" FLOW LINE CHOKE ASSEMBLY

Minimum assembly for 3,000 PSI working pressure will consist of three preventers.  
The bottom and middle preventers may be Cameron.

NOTE: HYDRIL not installed on shallow-low pressure wells.  
RAM type BOPs are API 10" X 3000 PSI.



E X H I B I T

V I

DATE: \_\_\_\_\_ SCALE: \_\_\_\_\_