

UNITED STATES  
DEPARTMENT OF THE INTERIOR  
GEOLOGICAL SURVEYO. C. D.  
ARTESIA OFFICE30-005-61264  
5. LEASE DESIGNATION AND SERIAL NO.NM 9813  
6. IF INDIAN, ALLOTTEE OR TRIBE NAME

7. UNIT AGREEMENT NAME

8. FARM OR LEASE NAME

South Alkali "LK" Fed.

9. WELL NO.

3

10. FIELD AND POOL, OR WILDCAT

Wildcat

11. SEC., T., R., M., OR BLK.  
AND SURVEY OR AREA

Sec. 11-6-s25

12. COUNTY OR PARISH

13. STATE

Chaves NM

## 1a. TYPE OF WORK

DRILL ☒DEEPEN ☐PLUG BACK ☐

## b. TYPE OF WELL

OIL  
WELL ☐GAS  
WELL ☒

OTHER

SINGLE  
ZONE ☐MULTIPLE  
ZONE ☐

## 2. NAME OF OPERATOR

Yates Petroleum Corporation ✓

## 3. ADDRESS OF OPERATOR

207 South 4th Street, Artesia, NM 88210

## 4. LOCATION OF WELL (Report location clearly and in accordance with any State requirements.)

At surface

1980' FSL &amp; 1980' FWL

At proposed prod. zone

same

## 14. DISTANCE IN MILES AND DIRECTION FROM NEAREST TOWN OR POST OFFICE\*

32 miles north and 13½ miles east of Roswell, NM

## 15. DISTANCE FROM PROPOSED\*

LOCATION TO NEAREST  
PROPERTY OR LEASE LINE, FT.  
(Also to nearest drlg. unit line, if any)

1980

## 16. NO. OF ACRES IN LEASE

640

17. NO. OF ACRES ASSIGNED  
TO THIS WELL

160

18. DISTANCE FROM PROPOSED LOCATION\*  
TO NEAREST WELL, DRILLING, COMPLETED,  
OR APPLIED FOR, ON THIS LEASE, FT.

4000'

## 19. PROPOSED DEPTH

+  
- 4300'

## 20. ROTARY OR CABLE TOOLS

Rotary

## 21. ELEVATIONS (Show whether DF, RT, GR, etc.)

3884.2

## 22. APPROX. DATE WORK WILL START\*

ASAP

## 23. PROPOSED CASING AND CEMENTING PROGRAM

SIZE OF HOLE	SIZE OF CASING	WEIGHT PER FOOT	SETTING DEPTH	QUANTITY OF CEMENT
15"	10 3/4"	40.5# J-55	Approx. 925'	800 sx. circulated
7 7/8" or 6 1/4"	4 1/2" or 5 1/2"	10.5# or 15.5#	TD	350 sx.

We propose to drill and test the Abo and intermediate formations. Approximately 925' of surface casing will be set and cement circulated to shut off gravel and casing. If needed (lost circulation) 7 5/8" intermediate casing will be run to 1500' and cemented with enough cement calculated to tie back into the surface casing. Temperature survey will be run to determine cement top. If commercial, production casing will be run and cemented with adequate cover, perforate, and stimulate as needed for production.

MUD PROGRAM: FW gel and LCM 1500'; Brine to 3500', Salt Gel and Starch to TD.

BOP PROGRAM: BOP's will be installed on 8 5/8" casing and tested daily.

GAS NOT DEDICATED.

IN ABOVE SPACE DESCRIBE PROPOSED PROGRAM: If proposal is to deepen or plug back, give data on present productive zone and proposed new productive zone. If proposal is to drill or deepen directionally, give pertinent data on subsurface locations and measured and true vertical depths. Give blowout preventer program, if any.

24.

SIGNED

TITLE Regulatory Manager

DATE 11-23-81

(This space for Federal or State office use)

PERMIT NO.

APPROVAL DATE

APPROVED BY

TITLE

DATE

CONDITIONS OF APPROVAL

APPROVED

DEC 4 1981

JAMES A. GILLHAM  
DISTRICT SUPERVISOR

**N MEXICO OIL CONSERVATION COMMISS**  
**WELL LOCATION AND ACREAGE DEDICATION PLAT**

Form C-102  
 Supersedes C-100  
 Effective 1-1-63

All distances must be from the outer boundaries of the Section.

Operator <b>YATES Pet. Corp.</b>			Lease <b>South Alkali LK Fed.</b>		Well No. <b>3</b>
Unit Letter <b>K</b>	Section <b>11</b>	Township <b>6 South</b>	Range <b>25 East</b>	County <b>Chaves</b>	
Actual Footage Location of Well:					
1980 feet from the South line and		1980 feet from the West line			
Ground Level Elev. <b>3884.2'</b>	Producing Formation <b>ABO</b>	Pool <b>Under Abo</b>		Dedicated Acreage: <b>160</b>	Acreage

1. Outline the acreage dedicated to the subject well by colored pencil or hachure marks on the plat below.
2. If more than one lease is dedicated to the well, outline each and identify the ownership thereof (both as to working interest and royalty).
3. If more than one lease of different ownership is dedicated to the well, have the interests of all owners been consolidated by communitization, unitization, force-pooling, etc?  
☐ Yes    ☒ No    If answer is "yes," type of consolidation \_\_\_\_\_

If answer is "no," list the owners and tract descriptions which have actually been consolidated. (Use reverse side of this form if necessary.) \_\_\_\_\_

No allowable will be assigned to the well until all interests have been consolidated (by communitization, unitization, forced-pooling, or otherwise) or until a non-standard unit, eliminating such interests, has been approved by the Commission.

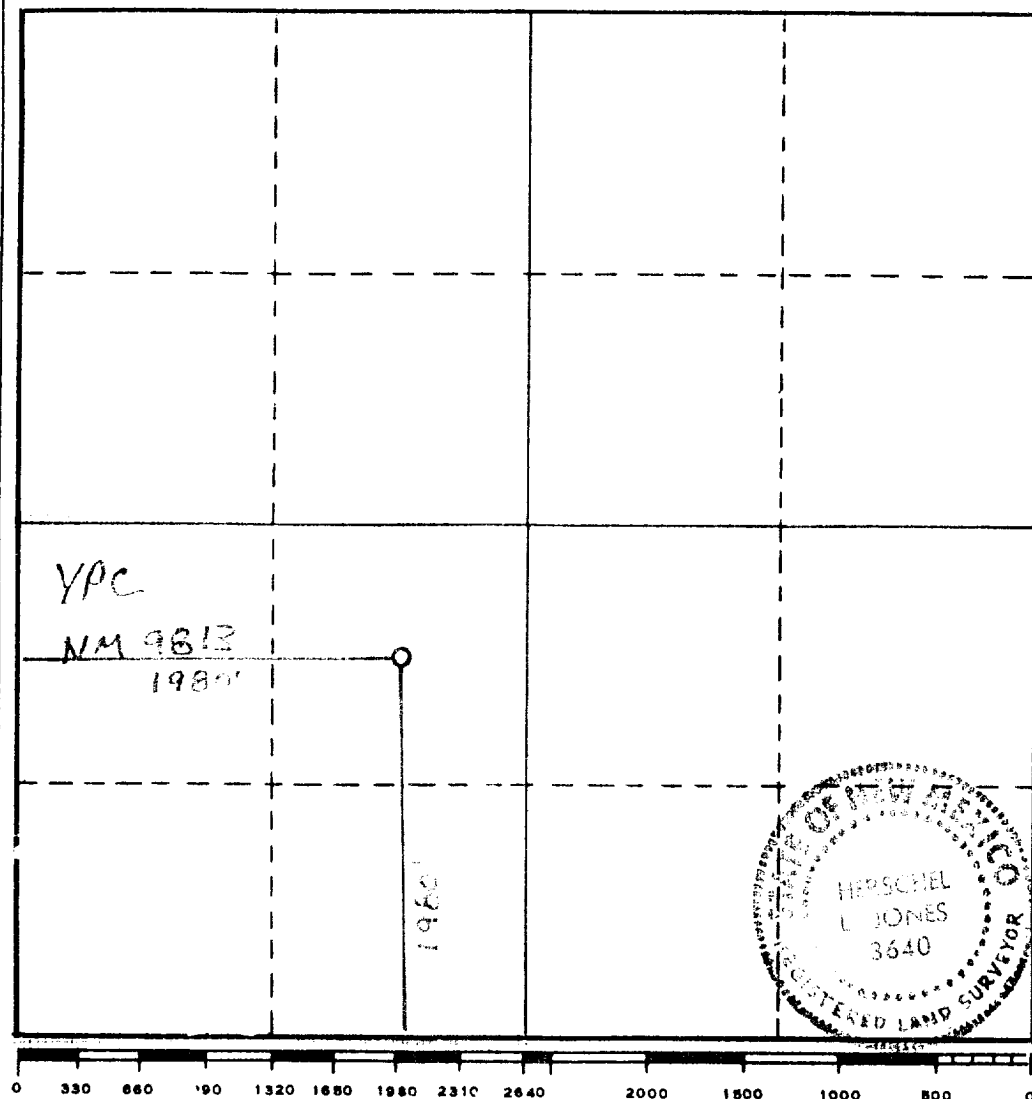

**CERTIFICATION**

I hereby certify that the information contained herein is true and complete to the best of my knowledge and belief.

*Glicerio Rodriguez*  
 Name

**GLICERIO RODRIGUEZ**  
 Position

*Yates Petroleum Corp.*  
 Company

**11-5-81**  
 Date

I hereby certify that the well location shown on this plat was plotted from field notes of actual surveys made by me or under my supervision, and that the same is true and correct to the best of my knowledge and belief.

Date Surveyed  
**September 24, 1981**

Registered Professional Engineer  
 and/or Land Surveyor

*[Signature]*

Certificate No.

**3640**

Yates Petroleum Corporation  
South Alkali "LK" Federal #3  
1980' FSL & 1980' FWL  
Section 11-T6s-R25e  
Chaves County, New Mexico

In conjunction with Form 9-331C, Application for Permit to Drill subject well, Yates Petroleum Corporation submits the following ten items of pertinent information in accordance with USGS requirements:

1. The geologic surface formation is sandy alluvium.
2. The estimate tops of geologic markers are as follows:

San Andres	548'
Glorieta	1595'
Fullerton	3010'
Abo	3664'
TD	4300'
3. The estimated depths at which anticipated water, oil, or gas formations are expected to be encountered.  
Water: Approximately 250' - 300'  
Oil or Gas: Abo 3700'
4. Proposed Casing Program: See Form 9-331C.
5. Pressure Control Equipment: See Form 9-331C and Exhibit B.
6. Mud Program: See Form 9-331C.
7. Auxiliary Equipment: Kelly Cock; pit level indicators and flow sensor equipment; sub with full-opening valve on floor, drill pipe connection.
8. Testing, Logging, and Coring Program:

Samples:	Surface casing to T.D.
DST's:	As Warranted
Logging:	Surface casing to T.D.
Coring:	CNL-FDC T.D. to casing with GR-CNL on to surface and DLL from T.D. to casing with R <sub>x</sub> O.
9. No abnormal pressures or temperatures are anticipated.
10. Anticipated starting date: As soon as possible after approval.

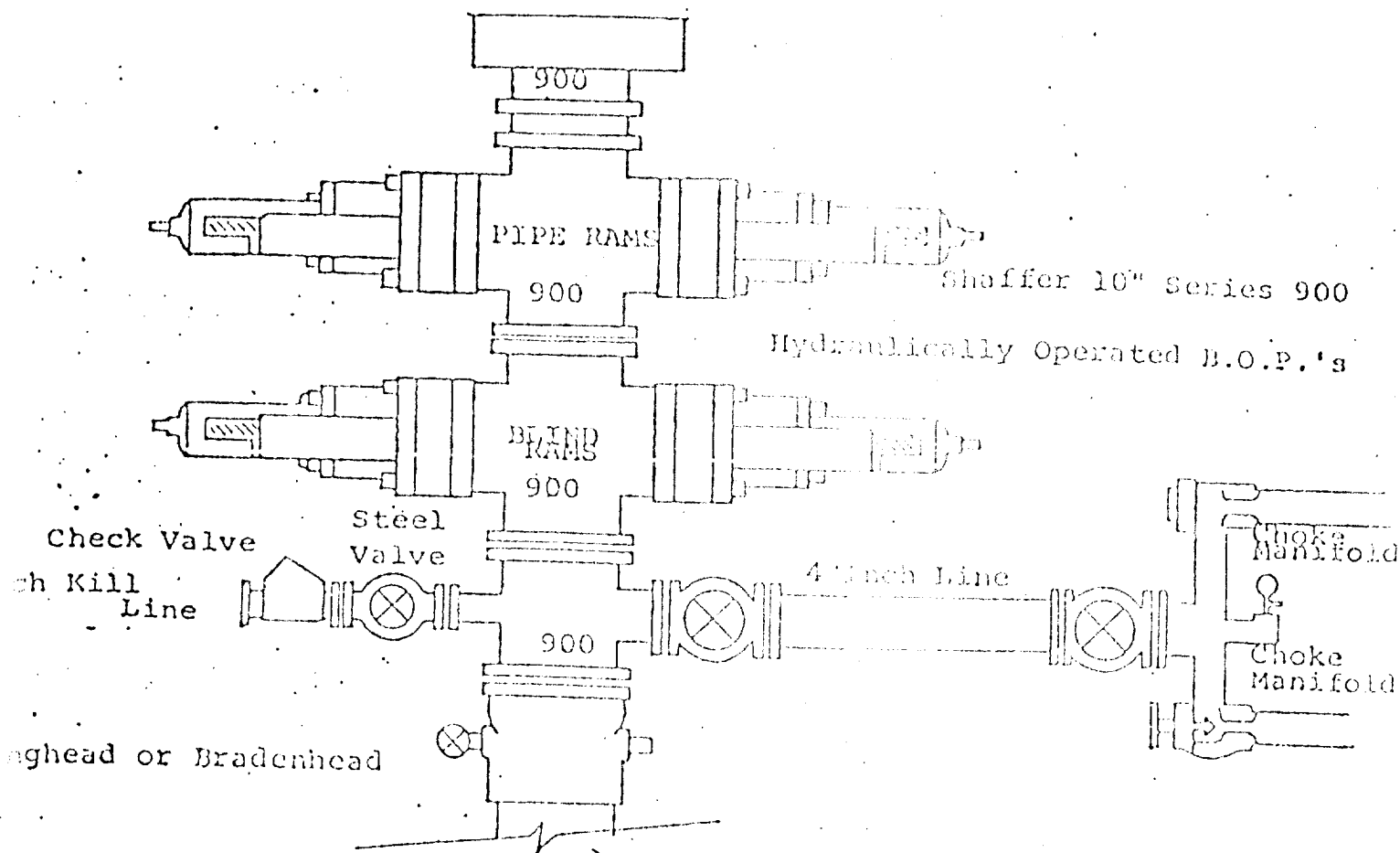

# FOLLOWING CONSTITUTE MINIMUM BLOWOUT PREVENTER REQUIREMENTS

- All preventers to be hydraulically operated with secondary manual controls installed prior to drilling out from under casing.
- Choke outlet to be a minimum of 4" diameter.
- Kill line to be of all steel construction of 2" minimum diameter.
- All connections from operating manifolds to preventers to be all steel.
- Pipe or tube a minimum of one inch in diameter.
- The available closing pressure shall be at least 15% in excess of that required with sufficient volume to operate the B.O.P.'s.
- All connections to and from preventer to have a pressure rating equivalent to that of the B.O.P.'s.
- Inside blowout preventer to be available on rig floor.
- Operating controls located a safe distance from the rig floor.
- Line must be kept filled on trips below intermediate casing. Operator not responsible for blowouts resulting from not keeping hole full.
- B.P. float must be installed and used below zone of first gas intrusion.

**ILLEGIBLE**

Diagram of a rectangular pit with a diagonal wall. The pit is 75' wide and 75' deep. A diagonal wall divides it into two sections: a 5' deep section on the left and a 6 1/2' deep section on the right. A small rectangular structure labeled "BURN PIT 5' DEEP" is shown outside the main pit. A note states: "NOTE: Inside walls must be as high and wide as outer walls of pit." A compass rose indicates North (N), South (S), East (E), and West (W).

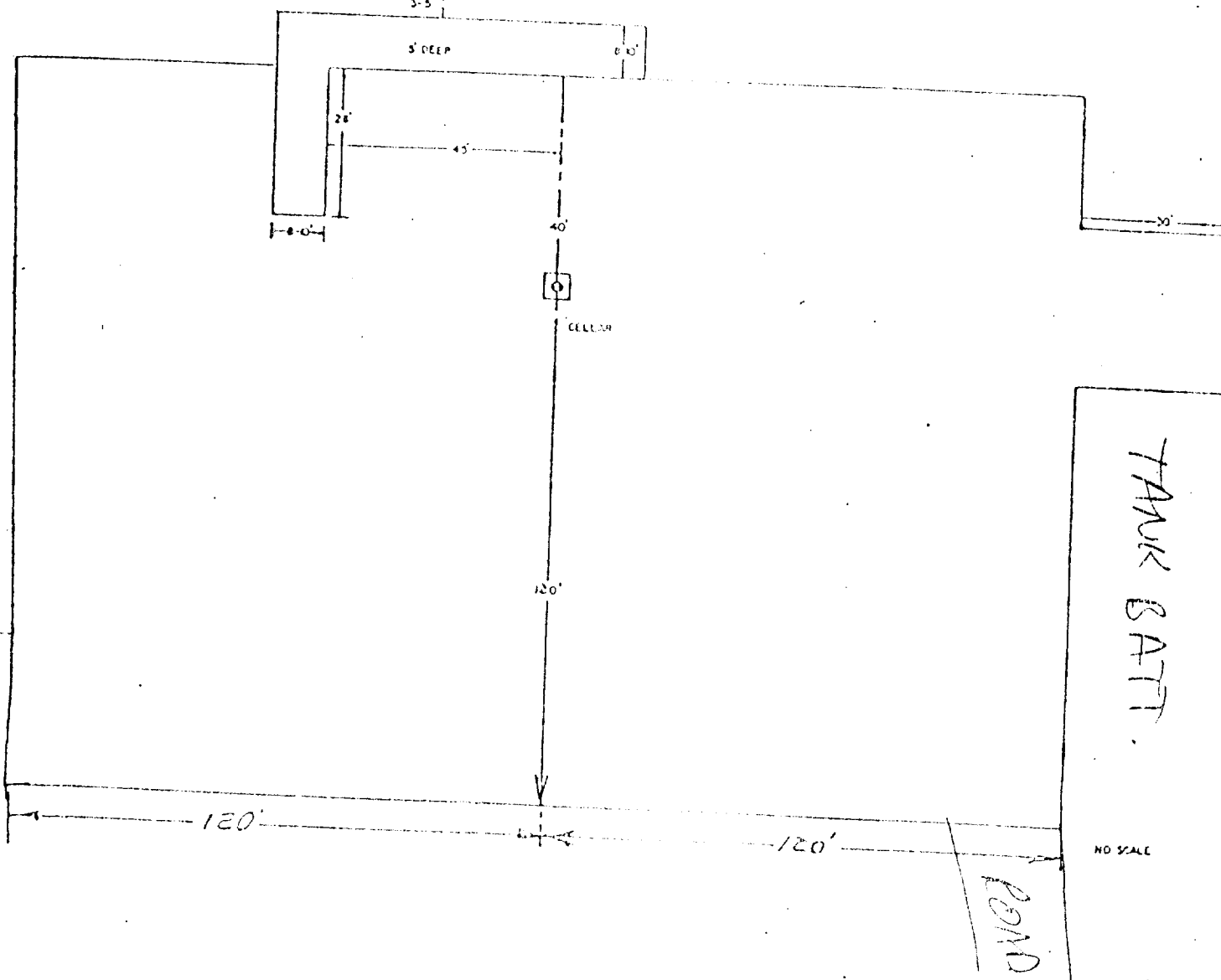



207 SOUTH FOURTH STREET  
ARTESIA, NEW MEXICO 88210

TELEPHONE (505) 746 3551

S. P. YATES  
PRESIDENT  
MARTIN YATES, III  
VICE PRESIDENT  
JOHN A. YATES  
VICE PRESIDENT  
B. W. HARPER  
SEC. TREAS.

November 10, 1981

U.S.G.S.  
P.O. Drawer U  
Artesia, NM 88210

Attention: Mr. George Stewart

Gentlemen:

Re: South Alkali "LK" Federal #3

Yates Petroleum Corporation is submitting an application to drill a well on surface patented to Corn Brothers, Inc. c/o Bronson Corn, Dunlap Star Route, Roswell, New Mexico 88210. This well will be located 1980' FSL and 1980' FWL on Section 11, T6S, R25E in Chaves County.

In a phone conversation with Mr. Bronson Corn, it was agreed that we would compensate him monetarily for the surface damaged in drilling this well. Also that in the event of a dry hole, we would leave the road intact. The pit area will be leveled after they are dry and along with the pad will be left to reseed naturally.

Sincerely,

YATES PETROLEUM CORPORATION

Rod Rodriguez  
Regulatory Manager

RR/rb