

| | |
|------------------------|---|
| NO. OF COPIES RECEIVED | |
| DISTRIBUTION | |
| SANTA FE | 1 |
| FILE | 1 |
| U.S.G.S. | 2 |
| LAND OFFICE | |
| OPERATOR | 1 |

NEW MEXICO OIL CONSERVATION COMMISSION

30-005-61267

Form C-101
Revised 1-1-65

DEC 9 1981

O. C. D.
ARTESIA, OFFICE

APPLICATION FOR PERMIT TO DRILL, DEEPEN, OR PLUG BACK

| | | |
|--|--|--|
| 1a. Type of Work DRILL <input checked="" type="checkbox"/> DEEPEN <input type="checkbox"/> PLUG BACK <input type="checkbox"/> | | 5A. Indicate Type of Lease STATE <input type="checkbox"/> FEE <input checked="" type="checkbox"/> |
| b. Type of Well OIL WELL <input checked="" type="checkbox"/> GAS WELL <input type="checkbox"/> OTHER <input type="checkbox"/> SINGLE ZONE <input type="checkbox"/> MULTIPLE ZONE <input type="checkbox"/> | | 5. State Oil & Gas Lease No. |
| 2. Name of Operator RALPH NIX | | 7. Unit Agreement Name |
| 3. Address of Operator P.O. Box 617, Artesia, New Mexico 88210 | | 8. Farm or Lease Name NANCY |
| 4. Location of Well UNIT LETTER P LOCATED 330' FEET FROM THE South LINE AND 330' FEET FROM THE East LINE OF SEC. 1 TWP. 8S RGE. 28E NMPM | | 9. Well No. #1 |
| | | 10. Field and Pool, or Willcat X BULL'S EYE SAN ANDRES |
| | | 12. County Chaves |
| | | 19. Proposed Depth 2800' |
| | | 19A. Formation San Andres |
| | | 20. Rotary or C.T. Rotary |
| 21. Elevations (Show whether DF, RT, etc.) 4050' GL | 21A. Kind & Status Plug. Bond BLANKET | 21B. Drilling Contractor Yucca Drilling Co. |
| | | 22. Approx. Date Work will start 12/14/81 |

23.

PROPOSED CASING AND CEMENT PROGRAM

| SIZE OF HOLE | SIZE OF CASING | WEIGHT PER FOOT | SETTING DEPTH | SACKS OF CEMENT | EST. TOP |
|--------------|----------------|-----------------|---------------|-----------------|-----------|
| 12 1/4" | 8 5/8" | 20# | 400' | 200 | Circulate |
| 7 7/8" | 4 1/2" | N-80 11.6# | 2800' | 250 | 1800' |

APPROVAL VALID FOR 180 DAYS
PERMIT EXPIRES 6-10-82
UNLESS DRILLING UNDERWAY

IN ABOVE SPACE DESCRIBE PROPOSED PROGRAM: IF PROPOSAL IS TO DEEPEN OR PLUG BACK, GIVE DATA ON PRESENT PRODUCTIVE ZONE AND PROPOSED NEW PRODUCTIVE ZONE. GIVE BLOWOUT PREVENTER PROGRAM, IF ANY.

I hereby certify that the information above is true and complete to the best of my knowledge and belief.

Signed Ralph Nix Jr. Title _____ Date 12-8-81

(This space for State Use)

APPROVED BY Mik Williams TITLE OIL AND GAS INSPECTOR DATE DEC 10 1981

CONDITIONS OF APPROVAL, IF ANY:

All distances must be from the outer boundaries of the Section.

| | | | | |
|--|--|--------------------------------------|---------------------------------------|-------------------------|
| Operator Ralph Nix | | Lease Nancy | | Well No. #1 |
| Unit Letter P | Section 1 | Township 8 South | Range 28 East | County Chaves |
| Actual Postage Location of Well: 330 feet from the South line and 330 feet from the East line | | | | |
| Ground Level Elev. 4050 | Producing Formation San Andres | Pool Bull's Eye San Andres | Dedicated Acreage: 40 Acres | |

1. Outline the acreage dedicated to the subject well by colored pencil or hatchure marks on the plat below.
2. If more than one lease is dedicated to the well, outline each and identify the ownership thereof (both as to working interest and royalty).
3. If more than one lease of different ownership is dedicated to the well, have the interests of all owners been consolidated by communitization, unitization, force-pooling, etc?

☐ Yes ☐ No If answer is "yes," type of consolidation _____

If answer is "no," list the owners and tract descriptions which have actually been consolidated. (Use reverse side of this form if necessary.) _____

No allowable will be assigned to the well until all interests have been consolidated (by communitization, unitization, forced-pooling, or otherwise) or until a non-standard unit, eliminating such interests, has been approved by the Division.

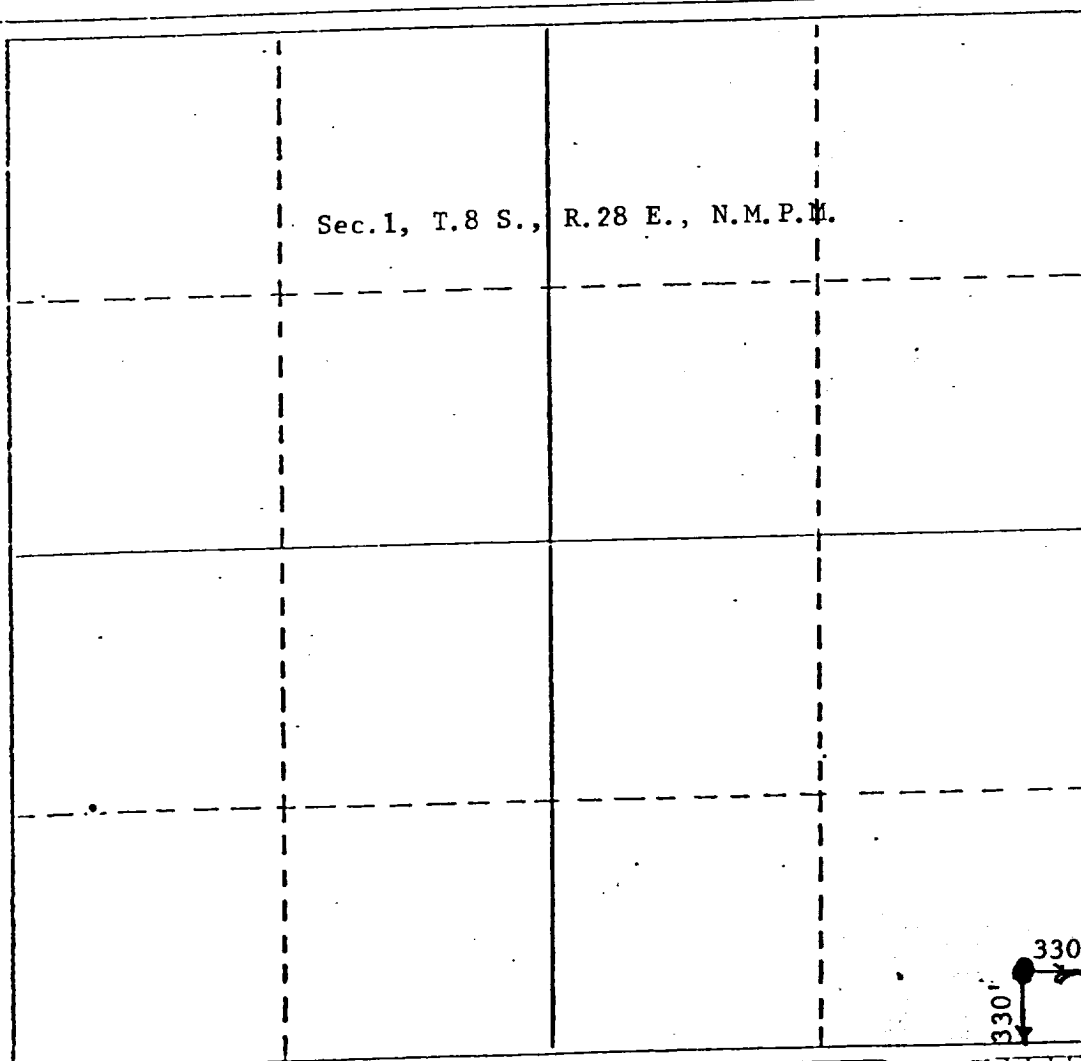

CERTIFICATION

I hereby certify that the information contained herein is true and complete to the best of my knowledge and belief.

Name

Position

Company

RALPH NIX

Date

I hereby certify that the well location shown on this plat was plotted from field notes of actual surveys made by me or under my supervision, and that the same is true and correct to the best of my knowledge and belief.

Date Surveyed

December 5, 1981

Registered Professional Engineer and/or Land Surveyor

John D. Jaquess, P.E. & L.S.
Certificate No. **6290**