

All distances must be from the outer boundaries of the Section.

Operator Fred Pool Drilling, Inc. ✓			Lease Eastland State		Well No. #2
Unit Letter K	Section 13	Township 9 South	Range 26 East	County O.C.D. ARIZONA, OFFICE	
Actual Footage Location of Well: 1980 feet from the South line and 1980 feet from the West line					
Ground Level Elev. 3820	Producing Formation Wolfcamp	Pool Foor Ranch W.C.		Dedicated Acreage: 320 Acres	

1. Outline the acreage dedicated to the subject well by colored pencil or hatchure marks on the plat below.
2. If more than one lease is dedicated to the well, outline each and identify the ownership thereof (both as to working interest and royalty).
3. If more than one lease of different ownership is dedicated to the well, have the interests of all owners been consolidated by communitization, unitization, force-pooling, etc?

☐ Yes ☐ No If answer is "yes," type of consolidation \_\_\_\_\_

If answer is "no," list the owners and tract descriptions which have actually been consolidated. (Use reverse side of this form if necessary.) \_\_\_\_\_

No allowable will be assigned to the well until all interests have been consolidated (by communitization, unitization, forced-pooling, or otherwise) or until a non-standard unit, eliminating such interests, has been approved by the Division.

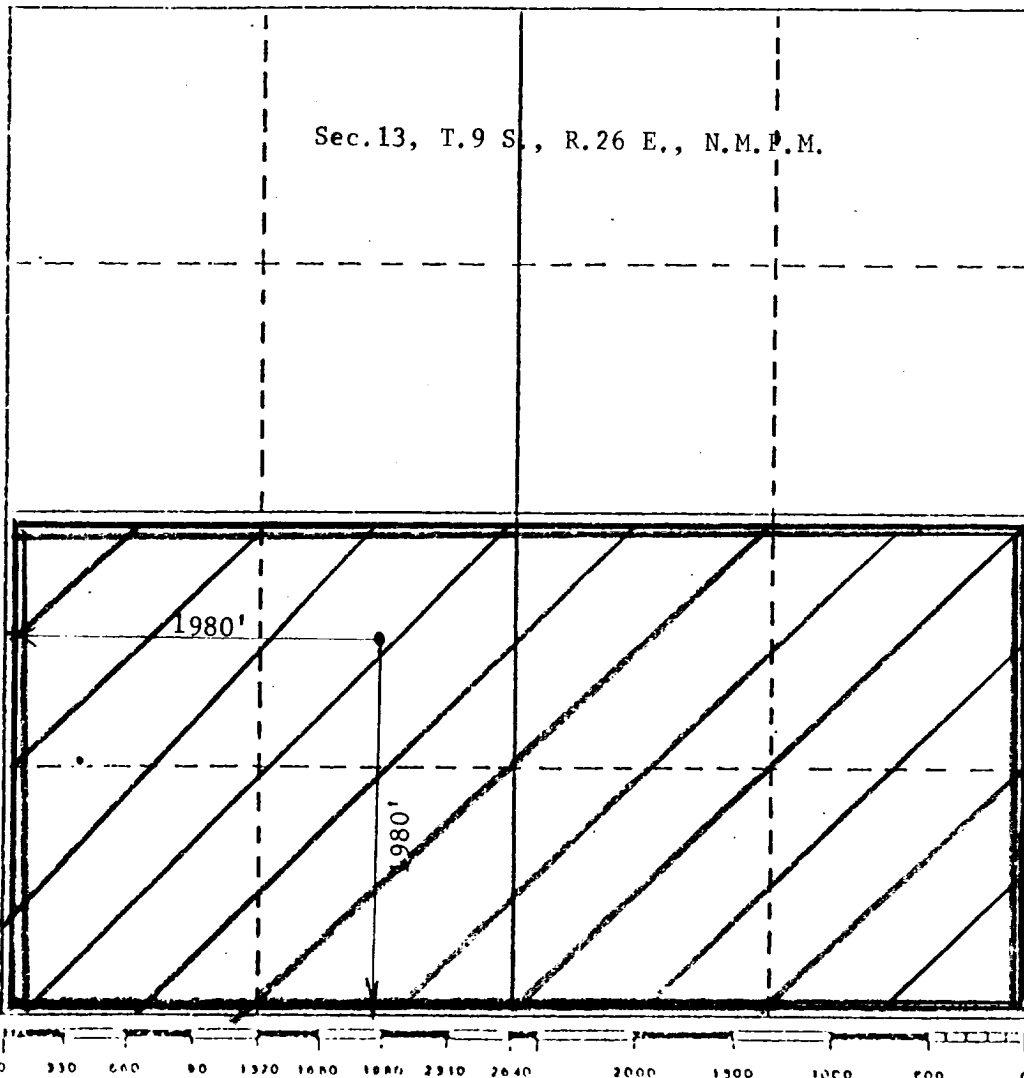

CERTIFICATION

I hereby certify that the information contained herein is true and complete to the best of my knowledge and belief.

*Fred F. Pool, III*

Name  
Fred F. Pool, III  
Position  
Engineer  
Company  
Fred Pool Drilling, Inc.

Date  
5/3/89

I hereby certify that the well location shown on this plat was plotted from field notes of actual surveys made by me or under my supervision, and that the same is true and correct to the best of my knowledge and belief.

Date Surveyed  
December 7, 1981  
Registered Professional Engineer and/or Land Surveyor  
John D. Jaquess  
Certificate No. 6290