

NEW MEXICO OIL CONSERVATION COMMISSION
WELL LOCATION AND ACREAGE DEDICATION PLAT

Form C-102
Supersedes C-128
Effective 1-1-65

All distances must be from the outer boundaries of the Section.

Operator YATES PETROLEUM CORPORATION		Lease Collins "SW" State		Well No. 1
Unit Letter D	Section 25	Township 4 South	Range 24 East	County Chaves
Actual Footage Location of Well: 660 feet from the North line and 660 feet from the West line				
Ground Level Elev. 3998.0'	Producing Formation Abo	Pool Undes. Pecos Slope Abo	Dedicated Acreage: 160 Acres	

- Outline the acreage dedicated to the subject well by colored pencil or hachure marks on the plat below.
- If more than one lease is dedicated to the well, outline each and identify the ownership thereof (both as to working interest and royalty).
- If more than one lease of different ownership is dedicated to the well, have the interests of all owners been consolidated by communitization, unitization, force-pooling, etc?

☐ Yes ☐ No If answer is "yes," type of consolidation _____

If answer is "no," list the owners and tract descriptions which have actually been consolidated. (Use reverse side of this form if necessary.) _____

No allowable will be assigned to the well until all interests have been consolidated (by communitization, unitization, forced-pooling, or otherwise) or until a non-standard unit, eliminating such interests, has been approved by the Commission.

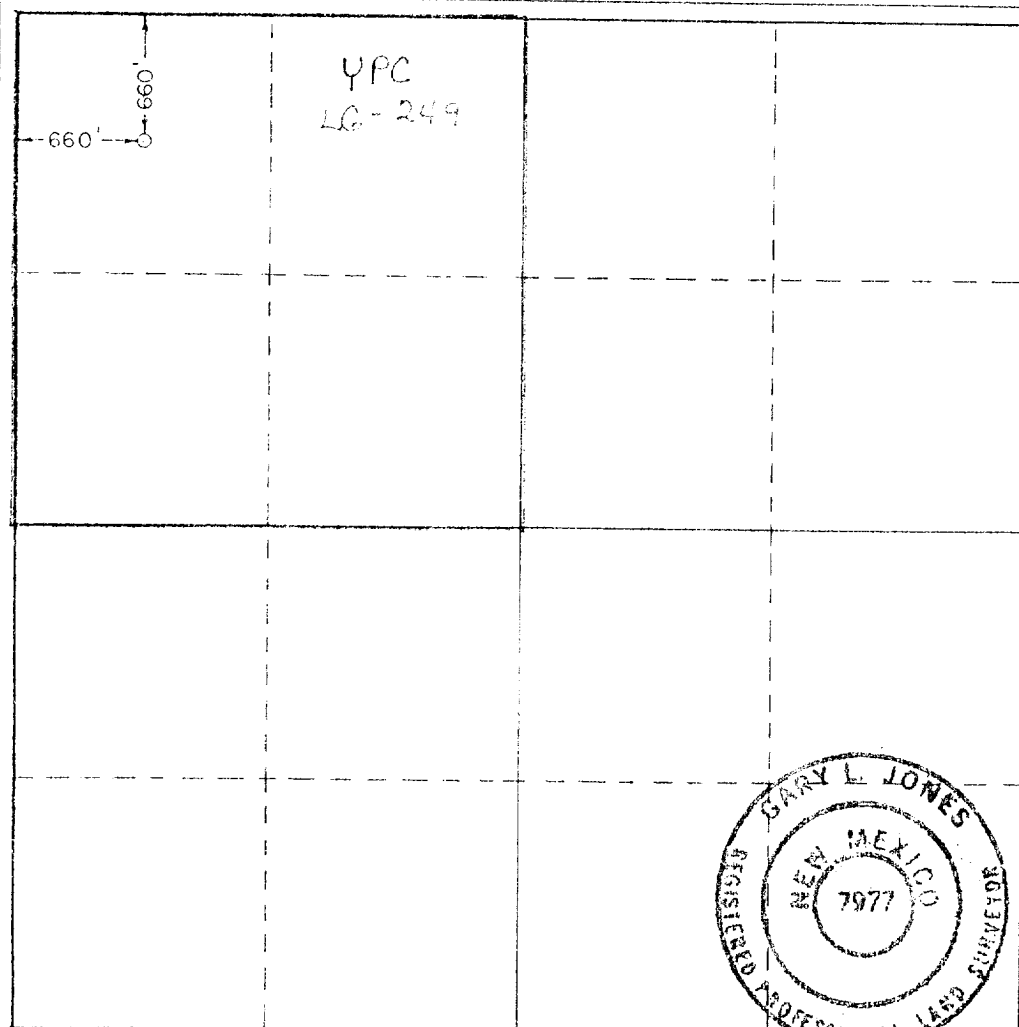

CERTIFICATION

I hereby certify that the information contained herein is true and complete to the best of my knowledge and belief.

Cy Cowan
Name
Cy Cowan
Position
Regulatory Coordinator
Company
Yates Petroleum Corporation
Date
3/29/82

I hereby certify that the well location shown on this plat was plotted from field notes of actual surveys made by me or under my supervision, and that the same is true and correct to the best of my knowledge and belief.

Date Surveyed
March 25, 1982
Registered Professional Engineer and/or Land Surveyor

Gary L. Jones
Certificate No.
7977

0 330 660 990 1320 1650 1980 2310 2640 2970 3300 3630 3960