

NM OIL COM. COMMISSION
Drawer DL
Artesia, NM 88210
UNITED STATES
DEPARTMENT OF THE INTERIOR
GEOLOGICAL SURVEYSUBMIT IN TR. DATE*
(Other instructions on
reverse side)Form approved.
Budget Bureau No. 42-R1425.

30-005-61355

APPLICATION FOR PERMIT TO DRILL, DEEPEN, OR PLUG BACK

1a. TYPE OF WORK

DRILL ☒DEEPEN ☐PLUG BACK ☐

b. TYPE OF WELL

OIL
WELL ☐GAS
WELL ☒

OTHER

SINGLE
ZONE ☒MULTIPLE
ZONE ☐

2. NAME OF OPERATOR

McClellan Oil Corporation

3. ADDRESS OF OPERATOR

P. O. Drawer 730, Roswell, New Mexico 88202

4. LOCATION OF WELL (Report location clearly and in accordance with any State requirements.)*

At surface

660' FNL & 660' FEL Unit A
At proposed prod. zone

14. DISTANCE IN MILES AND DIRECTION FROM NEAREST TOWN OR POST OFFICE*

14 miles North and 4 miles East of Roswell

15. DISTANCE FROM PROPOSED*

LOCATION TO NEAREST
PROPERTY OR LEASE LINE, FT.
(Also to nearest drlg. unit line, if any)

660'

16. NO. OF ACRES IN LEASE

1086.04

17. NO. OF ACRES ASSIGNED
TO THIS WELL

160 acres

18. DISTANCE FROM PROPOSED LOCATION*

To nearest well, drilling, completed,
or applied for, on this lease, ft.

N/A

19. PROPOSED DEPTH

4200'

20. ROTARY OR CABLE TOOLS

Rotary

21. ELEVATIONS (Show whether DF, RT, GR, etc.)

3702' G.L.

22. APPROX. DATE WORK WILL START*

March 1, 1982

23. PROPOSED CASING AND CEMENTING PROGRAM

SIZE OF HOLE	SIZE OF CASING	WEIGHT PER FOOT	SETTING DEPTH	QUANTITY OF CEMENT
*17-1/2"	13-3/8"	54.5	450'	500 SX CIRCULATE
12-1/4"	8-5/8"	23	1400'	500 SX CIRCULATE
7-7/8"	4-1/2"	10.5	4200'	250 SX

We propose to drill the Abo formation. If production is indicated, production casing will be run and the Abo cemented with adequate cover and completion will be attempted.

*If lost circulation is encountered in the 17-1/2" hole, 13-3/8" casing will be run and cement circulated. If no loss of circulation occurs, the hole will be reduced to 12-1/4", drilled to approximately 1400' and 8-5/8" casing will be run and cement circulated.

Mud program: drill to top of Abo with fresh water and native mud. Mud-up with 40 viscosity mud, 20 cc water loss, 9.6 - 9.8 lb/gal weight.

Gas on this well is dedicated.

IN ABOVE SPACE DESCRIBE PROPOSED PROGRAM: If proposal is to deepen or plug back, give data on present productive zone and proposed new productive zone. If proposal is to drill or deepen directionally, give pertinent data on subsurface locations and measured and true vertical depths. Give blowout preventer program, if any.

24.

SIGNED

Paul Ragsdale (JR)

TITLE

Engineer

DATE

12/24/81

(This space for Federal or State office use)

PERMIT NO.

Orig. Sgd. GEORGE H. STEWART

APPROVAL DATE

APPROVED BY

JAN 18 1982

CONDITIONS OF APPROVAL, IF ANY:

JAMES A. GUINAM
DISTRICT SUPERVISORAPPROVAL SUBJECT TO
GENERAL REQUIREMENTS AND
SPECIAL STIPULATIONS
ATTACHED

DATE

OIL CONSERVATION DIVISION

STATE OF NEW MEXICO
ENERGY AND MINERALS DEPARTMENTP. O. BOX 2088
SANTA FE, NEW MEXICO 87506Form C-102
Revised 10-1-78

All distances must be from the outer boundaries of the Section.

Operator McClellan Oil Corp.			Lease COYOTE DRAW FED Tyrell Federal		Well No. 4
Unit Letter A	Section 31	Township 7 South	Range 25 East	County Chaves	
Actual Footage Location of Well: 660 feet from the North line and 660 feet from the East line					
Ground Level Elev. 3702	Producing Formation Abo	Pool Pecos Slope Abo		Dedicated Acreage: 160 Acres	

1. Outline the acreage dedicated to the subject well by colored pencil or hatchure marks on the plat below.

2. If more than one lease is dedicated to the well, outline each and identify the ownership thereof (both as to working interest and royalty).

3. If more than one lease of different ownership is dedicated to the well, have the interests of all owners been consolidated by communitization, unitization, force-pooling, etc?

☐ Yes ☐ No If answer is "yes," type of consolidation _____

If answer is "no," list the owners and tract descriptions which have actually been consolidated. (Use reverse side of this form if necessary.) _____

No allowable will be assigned to the well until all interests have been consolidated (by communitization, unitization, forced-pooling, or otherwise) or until a non-standard unit, eliminating such interests, has been approved by the Division.

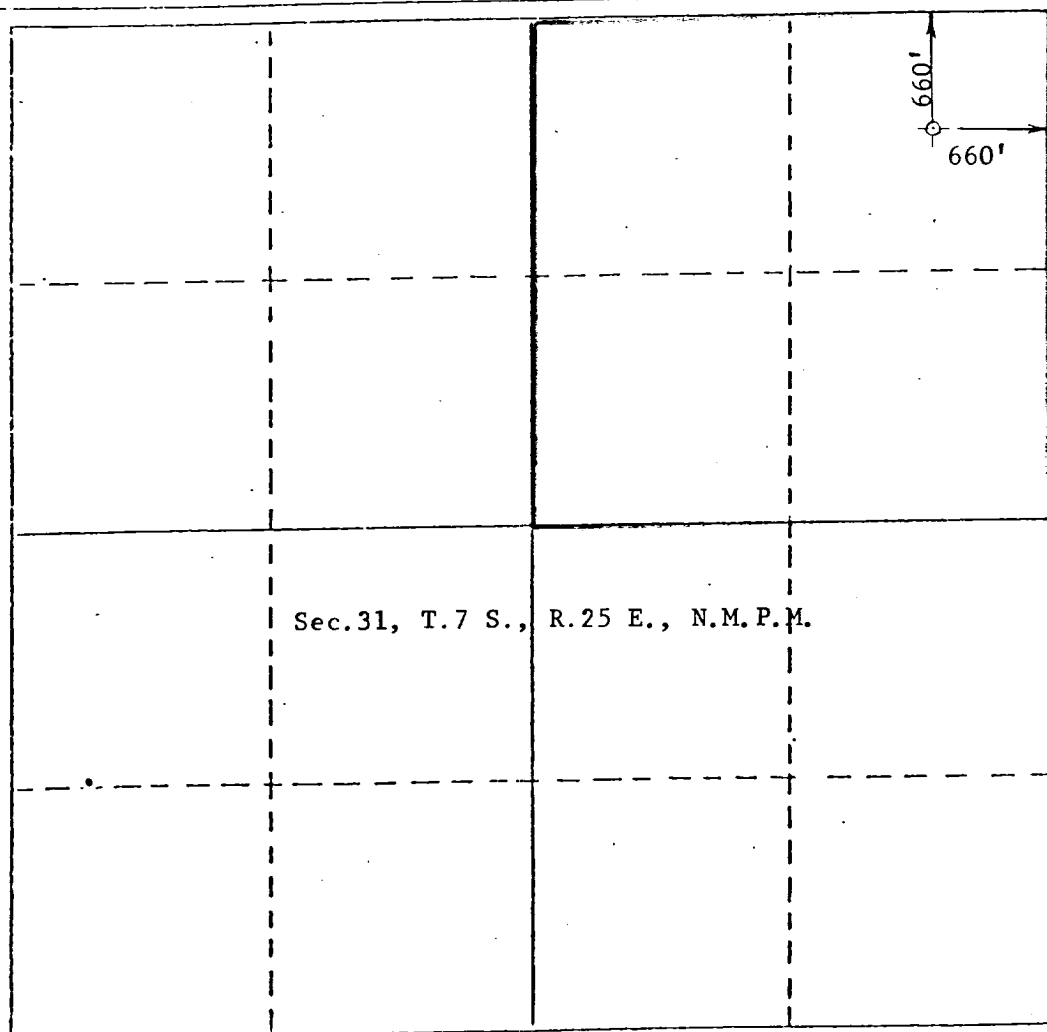

CERTIFICATION

I hereby certify that the information contained herein is true and complete to the best of my knowledge and belief.

Name
Jack L. McClellan

Position
President

Company
McClellan Oil Corp.

Date
January 4, 1982

I hereby certify that the well location shown on this plat was plotted from field notes of actual surveys made by me or under my supervision, and that the same is true and correct to the best of my knowledge and belief.

Date Surveyed
December 19, 1981

Registered Professional Engineer and/or Land Surveyor

John D. Jaquess, P.E. & L.S.
Certificate No. 6290

0 330 660 990 1320 1650 1980 2310 2640 2970 3300 3630 3960 4290 4620 4950 5280 5610 5940 6270 6600

UNITED STATES
DEPARTMENT OF THE INTERIOR
GEOLOGICAL SURVEY

COMMISSION
SUBMIT IN THE
(Other Instructions on reverse side)

Form approved.
Budget Bureau No. 42-R1424.

5. LEASE DESIGNATION AND SERIAL NO.

NM-28306

6. IF INDIAN, ALLOTTEE OR TRIBE NAME

7. UNIT AGREEMENT NAME

8. FARM OR LEASE NAME

Coyote Draw Fed.

9. WELL NO.

4

10. FIELD AND POOL, OR WILDCAT

Wildcat Und. Flow

11. SEC., T., R., M., OR BLK. AND SURVEY OR AREA

Sec. 31, T7S-R25E

12. COUNTY OR PARISH
Chaves

13. STATE
NM

1. OIL WELL ☐ GAS WELL ☒ OTHER
2. NAME OF OPERATOR
McCLELLAN OIL CORPORATION
3. ADDRESS OF OPERATOR
P.O. Drawer 730, Roswell, New Mexico 88202 ARTESIA, OFFICE
4. LOCATION OF WELL (Report location clearly and in accordance with any State requirements.* See also space 17 below.)
At surface
660' FNL & 660' FEL

14. PERMIT NO.

15. ELEVATIONS (Show whether DF, RT, GR, etc.)
3702' G.L.

16. Check Appropriate Box To Indicate Nature of Notice, Report, or Other Data

NOTICE OF INTENTION TO:

TEST WATER SHUT-OFF

FRACTURE TREAT

SHOOT OR ACIDIZE

REPAIR WELL

(Other)

PULL OR ALTER CASING

MULTIPLE COMPLETE

ABANDON*

CHANGE PLANS

SUBSEQUENT REPORT OF:

WATER SHUT-OFF

FRACTURE TREATMENT

SHOOTING OR ACIDIZING

(Other) Change of well number & name

(NOTE: Report results of multiple completion on Well Completion or Recompletion Report and Log form.)

REPAIRING WELL

ALTERING CASING

ABANDONMENT*

17. DESCRIBE PROPOSED OR COMPLETED OPERATIONS (Clearly state all pertinent details, and give pertinent dates, including estimated date of starting any proposed work. If well is directionally drilled, give subsurface locations and measured and true vertical depths for all markers and zones pertinent to this work.)*

This test has been filed as the Tyrell Federal No. 1

Request change of name and number to Coyote Draw No. 4.

RECEIVED
JAN 15 1982

OIL & GAS
U.S. GEOLOGICAL SURVEY
ROSWELL, NEW MEXICO

18. I hereby certify that the foregoing is true and correct

SIGNED

James McClellan

TITLE

Operator

DATE

1/14/82

(This space for Federal or State office use)

APPROVED BY

(Orig. Sgd.) GEORGE H. STEWART

DATE

CONDITIONS OF APPROVAL, IF ANY:

JAN 18 1982

FOR

JAMES A. GUNHAM
DISTRICT SUPERVISOR

*See Instructions on Reverse Side

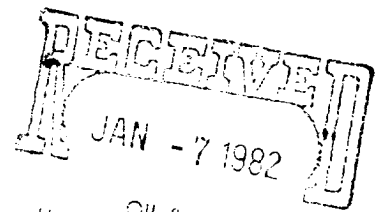

OIL & GAS
U.S. GEOLOGICAL SURVEY
ROSWELL, NEW MEXICO

SURFACE USE PLAN

McClellan Oil Corporation: ~~Tyrell~~ Federal No. 1
660' FNL & 660' FEL Section 31, T7S, R25E
Chaves County, New Mexico
Federal Lease NM-28306

1. Existing Roads

Exhibit "A" is a portion of the Chaves County road map of the New Mexico State Highway Department, showing the proposed well site in relation to nearby highways and ranch-oil field roads. U.S. Highway 285 will be used for 7.6 miles from Roswell to the ranch road. This highway is maintained by the State of New Mexico. The oil field-ranch road will be used for approximately 11 miles. This road is constructed of caliche, is approximately 12' to 35' in width and is maintained by the county, area ranchers and oil operators who utilize this road. All roads and highways to be used are marked in yellow and the proposed well site and nearby towns are marked in red.

2. Planned Access Road

Exhibit "B" shows the ranch and oil field roads. The new road to be constructed is marked in red and is approximately 500' in length. This new road will be approximately 12' wide. Existing cattleguards and fences will be left intact.

3. Location of Existing Wells

Exhibit "C" shows all of the producing wells within 2 miles of the proposed test with ownership of various tracts.

4. Location of Tank Battery, Production Facilities & Production Gathering & Service Lines

If gas production is achieved, the location of the line will be determined by the purchaser laying in the gathering system to his existing gas lines.

5. Location and Type of Water Supply

There is no useable water in this area. All water needed for drilling, testing, and completion will be trucked in by a commercial transport on existing roads as shown on Exhibit "A".

6. Source of Construction Materials

It will be necessary to use caliche on new road and location. This material will be obtained from commercial services.

7. Handling of Waste Disposal

All waste material remaining after the drilling of this well will be placed in mud pit as shown on Exhibit "D". Any combustible or biochemically degradable material will be placed in the "burn and trash pit".

8. Ancillary Facilities
No ancillary facilities are planned.
9. Well Site Layout
This information is shown on Exhibit "D".
10. Plan for Restoration of Surface
All pits will be filled in and leveled. Deadmen will be removed. The access road and location will be restored as near as possible to its natural state following instructions from appropriate governmental agency, if well is abandoned, otherwise the location will be cleared and maintained in an orderly manner.
11. Other Information
No unusual topography exists on the well site or access roads and the surface is depicted on Exhibit "B".
12. Operator Representatives
- | | | |
|-------|-------------------|---------------------------------------|
| 88202 | Paul Ragsdale | P.O. Drawer 730, Roswell, New Mexico |
| 0989) | 623-3940 Home | Mobile Unit 4128(Roswell Caprock-623- |
| | | |
| 88201 | Mark H. McClellan | 2902 W. 4th St., Roswell, New Mexico |
| | 622-3200 Office | |
| | 622-2128 Home | |
13. Certification
I certify that I, or persons under my direct supervision, have inspected the proposed drill site and access route; that I am familiar with the conditions which presently exist; that the statements made in this plan are, to the best of my knowledge, true and correct; and that the work associated with the operations proposed herein will be performed by McClellan Oil Corporation and its contractors and subcontractors in conformity with this plan and the terms and conditions under which it is approved.

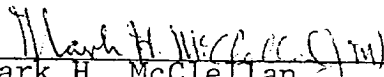

Mark H. McClellan

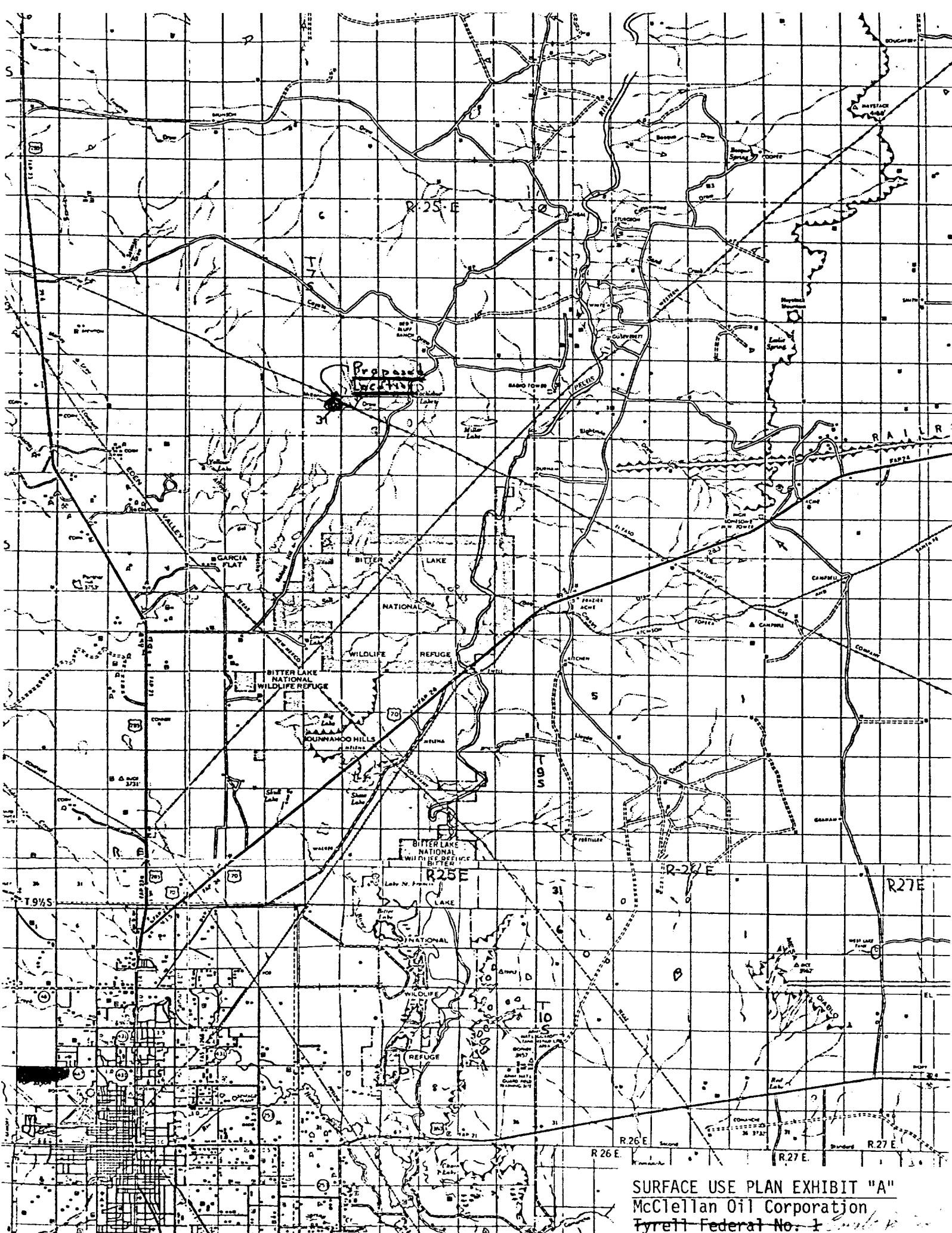

SURFACE USE PLAN EXHIBIT "A"
McClellan Oil Corporation
Tyrell Federal No. 1