

Artesia, NM 88210
UNITED STATES
DEPARTMENT OF THE INTERIOR
GEOLOGICAL SURVEY

30-005-61358

APPLICATION FOR PERMIT TO DRILL, DEEPEN, OR PLUG BACK

1a. TYPE OF WORK DRILL <input checked="" type="checkbox"/> DEEPEN <input type="checkbox"/> PLUG BACK <input type="checkbox"/>		5. LEASE DESIGNATION AND SERIAL NO. NM-22615
b. TYPE OF WELL OIL WELL <input type="checkbox"/> GAS WELL <input checked="" type="checkbox"/> OTHER <input type="checkbox"/> SINGLE ZONE <input checked="" type="checkbox"/> MULTIPLE ZONE <input type="checkbox"/>		6. IF INDIAN, ALLOTTEE OR TRIBE NAME
2. NAME OF OPERATOR MESA PETROLEUM CO. ✓		7. UNIT AGREEMENT NAME
3. ADDRESS OF OPERATOR 1000 VAUGHN BUILDING/MIDLAND, TEXAS 79701-4493		8. FARM OR LEASE NAME CAMACK FED COM
4. LOCATION OF WELL (Report location clearly and in accordance with any State requirements.) At surface 1980' FNL & 990' FWL SW NW/4 At proposed prod. zone same limit E O.C.D.		9. WELL NO. 7
14. DISTANCE IN MILES AND DIRECTION FROM NEAREST TOWN OR POST OFFICE* 40 miles North/Northeast of Roswell, New Mexico		10. FIELD AND POOL, OR WILDCAT Undesignated ABO
15. DISTANCE FROM PROPOSED* LOCATION TO NEAREST PROPERTY OR LEASE LINE, FT. (Also to nearest drlg. unit line, if any) 990'/660'		11. SEC., T., R., M., OR BLE. AND SURVEY OR AREA SEC 12, T5S, R24E
16. NO. OF ACRES IN LEASE 1640'		12. COUNTY OR PARISH CHAVES
17. NO. OF ACRES ASSIGNED TO THIS WELL 160		13. STATE NEW MEXICO
18. DISTANCE FROM PROPOSED LOCATION* TO NEAREST WELL, DRILLING, COMPLETED, OR APPLIED FOR, ON THIS LEASE, FT. 2200'		14. ROTARY OR CABLE TOOLS ROTARY
21. ELEVATIONS (Show whether DF, RT, GR, etc.) 3879' GR		22. APPROX. DATE WORK WILL START* February 8, 1982

23. PROPOSED CASING AND CEMENTING PROGRAM

SIZE OF HOLE	SIZE OF CASING	WEIGHT PER FOOT	SETTING DEPTH	QUANTITY OF CEMENT
17 1/2"	13 3/8"	48#	900'	SURFACE
11 or 12 1/4"	8 5/8"	24#	1600'	ISOLATE WATER, OIL & WATER
7 7/8"	4 1/2"	10.5#	4100'	COVER ALL PAY

Propose to drill 17 1/2" hole to approximately 900' to set 13 3/8" surface casing and cement to surface. Will reduce hole to 11" or 12 1/4" and drill to approximately 1600' to set 8 5/8" casing. Will nipple up RAM type BOPs, reduce hole to 7 7/8" and drill to total depth. Drilling medium will be air, foam, or mud as required.

Gas Sales Are Dedicated

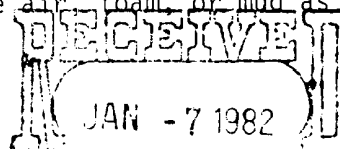
OIL & GAS
U.S. GEOLOGICAL SURVEY
ROSWELL, NEW MEXICO

XC: USGS (6), TLS, CEN RCDS, ACCGT, MEC, LAND, PARTNERS, FILE, REM, ROSWELL

IN ABOVE SPACE DESCRIBE PROPOSED PROGRAM: If proposal is to deepen or plug back, give data on present productive zone and proposed new productive zone. If proposal is to drill or deepen directionally, give pertinent data on subsurface locations and measured and true vertical depths. Give blowout preventer program, if any.

24. SIGNED <u>R. F. Martin</u> TITLE <u>REGULATORY COORDINATOR</u> DATE <u>12-28-81</u>	
(This space for Federal or State office use)	
PERMIT NO. <u>24-1</u>	APPROVAL DATE _____
APPROVED BY <u>GEORGE H. STEWART</u>	DATE _____
FOR <u>JAMES A. GILLHAM</u>	APPROVAL SUBJECT TO
DISTRICT SUPERVISOR	GENERAL REQUIREMENTS AND
	SPECIAL STIPULATIONS
	ATTACHED

See Instructions On Reverse Side

OIL CONSERVATION DIVISION

STATE OF NEW MEXICO
ENERGY AND MINERALS DEPARTMENT

P. O. BOX 2088

SANTA FE, NEW MEXICO 8750

Form C-102
Revised 10-1-78

All distances must be from the outer boundaries of the Section.

Operator Mesa Petroleum Co.		Lease Camack Federal Com		Well No. #7
Unit Letter E	Section 12	Township 5 South	Range 24 East	County Chaves
Actual Postage Location of Well: 1980 feet from the North line and 990 feet from the West line				
Ground Level Elev. 3879	Producing Formation ABO	Pool UNDESIGNATED		Dedicated Acreage: NW/4 160 Acres

1. Outline the acreage dedicated to the subject well by colored pencil or hachure marks on the plat below.
2. If more than one lease is dedicated to the well, outline each and identify the ownership thereof (both as to working interest and royalty).
3. If more than one lease of different ownership is dedicated to the well, have the interests of all owners been consolidated by communitization, unitization, force-pooling, etc?

☐ Yes ☐ No If answer is "yes," type of consolidation Communitization in Progress

If answer is "no," list the owners and tract descriptions which have actually been consolidated. (Use reverse side of this form if necessary.)

No allowable will be assigned to the well until all interests have been consolidated (by communitization, unitization, forced-pooling, or otherwise) or until a non-standard unit, eliminating such interests, has been approved by the Division.

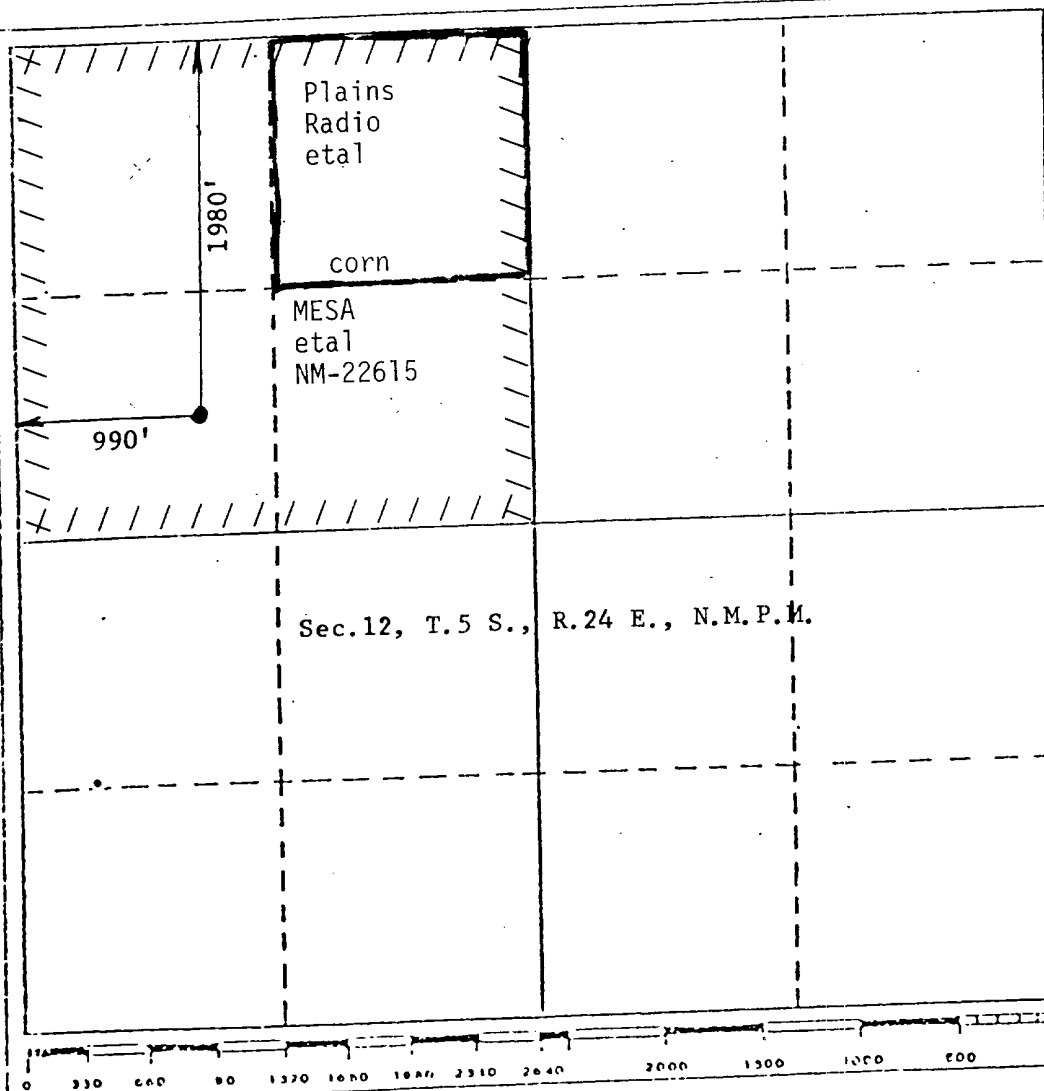

CERTIFICATION

I hereby certify that the information contained herein is true and complete to the best of my knowledge and belief.

R. E. Mathis
Name
R. E. MATHIS
Position
REGULATORY COORDINATOR
Company
MESA PETROLEUM CO.
Date
12-28-81

I hereby certify that the well location shown on this plat was plotted from field notes of actual surveys made by me or under my supervision, and that the same is true and correct to the best of my knowledge and belief.

JOHN D. JAQUESS
NEW MEXICO
Date Surveyed
December 29, 1981
Registered Professional Engineer
and/or Professional Surveyor
John D. Jaquess, P.E. & L.S.
Certificate No.
6290

APPLICATION FOR PERMIT TO DRILL

MESA PETROLEUM CO.
CAMACK FED COM #7
1980' FNL & 990' FWL, SEC 12, T5S, R24E
CHAVES COUNTY, NEW MEXICO

LEASE NO. NM-22615

In conjunction with Form 9331-C, Application For Permit to Drill subject well, the following additional information is provided:

1. Applicable portions of the GENERAL REQUIREMENTS FOR OIL AND GAS OPERATIONS ON FEDERAL LEASES, Roswell District, Geological Survey of September 1, 1980 will be adhered to.

2. Geological markers are estimated as follows:

SEVEN RIVERS	Surface
SAN ANDRES	470'
GLORIETA	1501'
TUBB	2977'
ABO	3589'

3. Hydrocarbon bearing strata may occur in the Abo formation(s). No fresh water is expected to be encountered below 900'.

4. The Casing and Blowout Preventer Program will be determined by hole conditions as encountered. See Exhibit VI. Anticipate drilling with air or foam using ram type preventer and rotating head for well control. The 13 3/8" casing will be set at approximately 900' to protect any fresh water zones and cemented to the surface. The 8 5/8" casing will be set at approximately 1600' if water zones have been encountered or omitted if not and ram type preventers installed. Sufficient amounts and kinds of cement would be used to ensure any water, gas, or oil zones encountered are isolated and shut off down to the casing point if run. The 4 1/2" production casing will be set at total depth or shallower depending upon the depth of the deepest commercial hydrocarbon bearing strata encountered.

5. No drill stem test or coring program is planned. The logging program may consist of a GR-CNL from surface total depth and FDC from casing point to total depth.

6. Anticipated drilling time is ten days with completion operations to follow as soon as a completion unit is available.

STANDARD STIPULATIONS FOR ROAD RIGHTS-OF-WAY
IN THE ROSWELL DISTRICT, BLM

Grantee agrees to comply with the following stipulations to the satisfaction of BLM's Roswell District Manager:

1. Clearing and blading necessary for construction of roads authorized will be held to the absolute minimum. Without prior authorization, these actions will not exceed those limits agreed upon at the pre-construction inspection. Vegetation removed will be "walked-down" in place.
2. Care will be taken by the grantee to assure that scenic values are not damaged in the disposal of waste materials. Any large rocks which are left in the area as a result of construction activities will be placed so that they do not detract from the scenic view and do not hinder the movement of livestock or of big game animals. These residual rocks will not be piled or left in rows.
3. In those areas where erosion control structures are required to stabilize soil conditions, the grantee will install such structures as are suitable for the specific soil conditions being encountered and which are in accordance with sound resource management practices.
4. To prevent slacking of fence wire, the grantee will brace and tie-off each existing fence to be crossed, before cutting. During construction, the opening will be protected to prevent the escape of livestock. Fences which have been cut during construction will be restored to their original condition, or better, by the grantee. Cattleguards and adjacent gates which are of suitable width will also be installed in any fence where the road constructed is to be regularly traveled.
5. If a natural barrier which is being used for livestock control, is broken during construction, the grantee will adequately fence the area to prevent drift of livestock. Such fencing will be at his own expense.
6. Public access along this right-of-way will not be restricted by the grantee, without specific written approval being granted by BLM's Roswell District Manager. Gates or cattleguards on public lands will not be locked or closed to public use.
7. All roads which are constructed under this grant, must be equal to or better than the local minimum standards. Grantee will be responsible for maintaining these roads in a condition which is acceptable to the BLM's Roswell District Manager.
8. Prior to using any mineral materials, such as caliche or sand and gravel which would be removed from any existing or proposed federal source, authorization must be obtained from the BLM Roswell District Manager or his designated representative.
9. Upon cancellation, relinquishment, or expiration of this right-of-way, the grantee will comply with those abandonment procedures as prescribed by BLM's Roswell District Manager.
10. The grantee will make a diligent effort to contact the BLM grazing permittee or lessee prior to entering the public lands on all grazing allotments.
11. Special stipulations:

BY

R. E. Markers

12-28-81

DATE

Blow-out Preventers hydril and choke manifold are all 900 Series

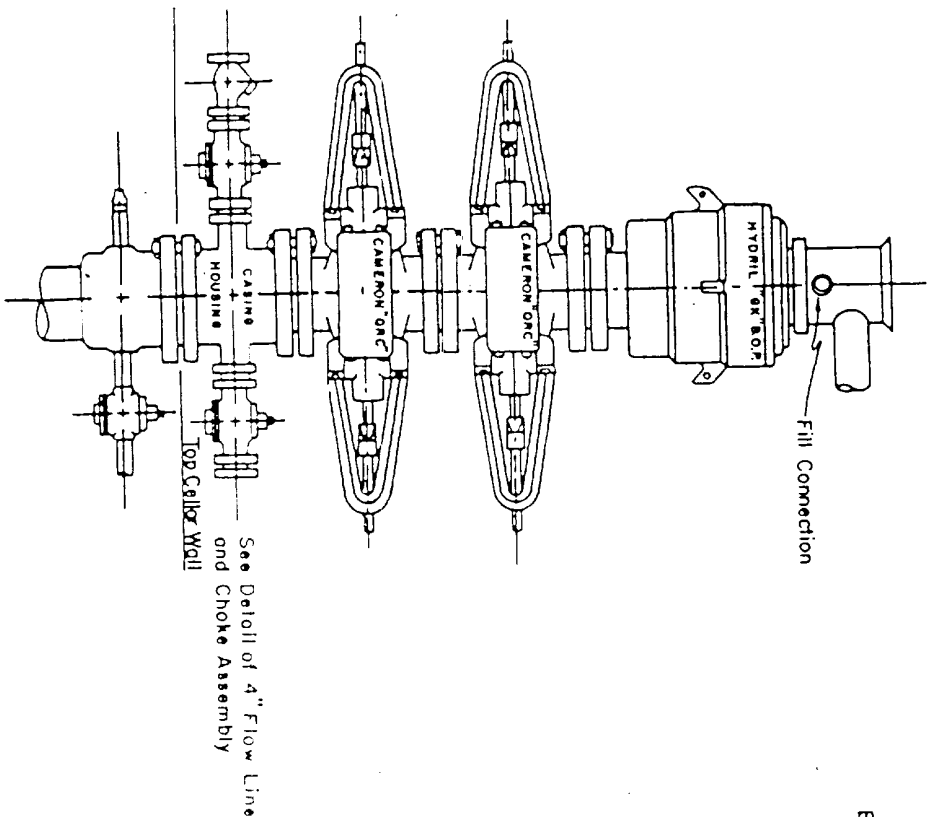

3,000 PSI WORKING PRESSURE
BLOW-OUT PREVENTER HOOK-UP

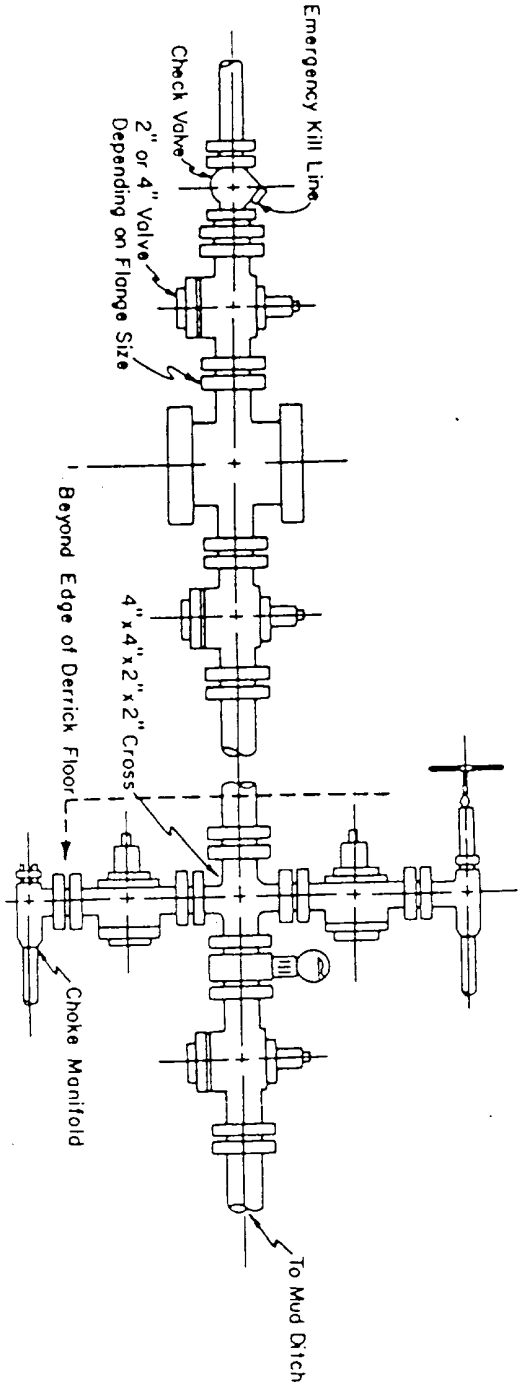

3,000 PSI WORKING PRESSURE
KILL, CHOKE, AND FILL CONNECTIONS

DETAIL OF 4" FLOW LINE CHOKE ASSEMBLY

Minimum assembly for 3,000 PSI working pressure will consist of three preventers.
The bottom and middle preventers may be Cameron.

NOTE: HYDRIL, not installed on shallow-low pressure wells.
RAM type BOPs are API 10" X 3000 PSI



E X H I B I T
V I

DATE: _____
BY: _____
REVISION: _____