

WELL LOCATION AND ACREAGE DEDICATION PLAT

 FORM 1-7-72
 Supervised C-128
 Effective 1-1-85

Operator ENSERCH EXPLORATION, INC.		Lease J.G. O'BRIEN		Well No. 4
Well Letter L	Section 31	Township 7 South	Range 29 East	County Chaves
Actual Footage Location of Well: 2130 feet from the South line and 660 feet from the West line				
Ground Level Elev. 4047.9	Producing Formation Pennsylvanian	Pool Undesignated	RECEIVED MAY 14 1982 O.C. 317-11 ARTESIA OFFICE	

- Outline the acreage dedicated to the subject well by colored pencil or hachure marks on the plat below.
- If more than one lease is dedicated to the well, outline each and identify the ownership thereof (both as to working interest and royalty).
- If more than one lease of different ownership is dedicated to the well, have the interests of all owners been consolidated by communitization, unitization, force-pooling, etc?

☐ Yes ☐ No If answer is "yes," type of consolidation _____

If answer is "no," list the owners and tract descriptions which have actually been consolidated. (Use reverse side of this form if necessary.) _____

No allowable will be assigned to the well until all interests have been consolidated (by communitization, unitization, forced-pooling, or otherwise) or until a non-standard unit, eliminating such interests, has been approved by the Commission.

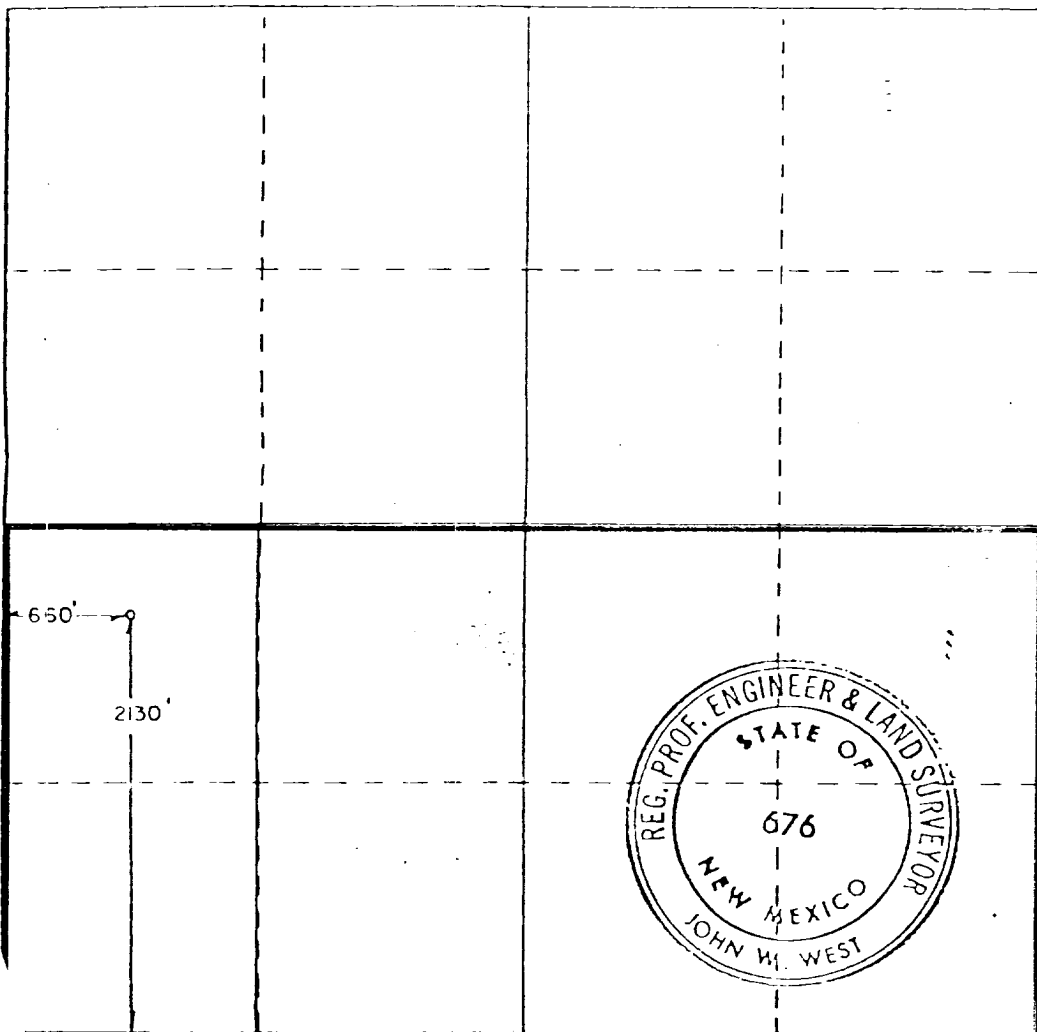

CERTIFICATION

I hereby certify that the information contained herein is true and complete to the best of my knowledge and belief.

C. H. Peeples

Name

C. H. Peeples

Position

Regional Drilling Manager

Company

Enserch Exploration, Inc.

Date

1-13-82

I hereby certify that the well location shown on this plat was plotted from field notes of actual surveys made by me or under my supervision, and that the same is true and correct to the best of my knowledge and belief.

Date Surveyed

1/9/82

 Registered Professional Engineer
 and or Land Surveyor

John W. West

 Certificate No. **JOHN W. WEST 676**
PATRICK A. ROMERO 6688
Reynold J. Eidson 3239

330 660 990 1320 1650 1980 2310 2640 2970 3300 3630 3960 4290 4620 4950 5280 5610 5940 6270 6600