

NO. OF COPIES RECEIVED	
DISTRIBUTION	
SANTA FE	
FILE	
U.S.G.S.	
LAND OFFICE	
OPERATOR	

NEW MEXICO OIL CONSERVATION COMMISSION **RECEIVED**

JAN 28 1982

O. C. D.
ARTESIA, OFFICE

30-005-61385

Form C-101
Revised 1-1-81

5A. Indicate Type of Lease
STATE ☐ FEE ☒

5. State Oil & Gas Lease Tax

APPLICATION FOR PERMIT TO DRILL, DEEPEN, OR PLUG BACK

1a. Type of Work DRILL <input checked="" type="checkbox"/> DEEPEN <input type="checkbox"/> PLUG BACK <input type="checkbox"/>				7. Unit Agreement Date	
b. Type of Well OIL WELL <input checked="" type="checkbox"/> GAS WELL <input type="checkbox"/> OTHER <input type="checkbox"/> SINGLE ZONE <input type="checkbox"/> MULTIPLE ZONE <input type="checkbox"/>				8. Farm or Lease Name Plains 29	
2. Name of Operator Cibola Energy Corporation				9. Well No. 2	
3. Address of Operator P.O. Box 1668, Albuquerque, New Mexico 87103				10. Field and Sect, or Locality NE 1/4 Sec. 10 San Andres	
4. Location of Well UNIT LETTER E LOCATED 1980 FEET FROM THE North LINE AND 660 FEET FROM THE West LINE OF SEC. 29 TWP. 10S RGE. 28E NMPM				11. County Chaves	
18. Proposed Depth 2400'		19A. Formation San Andres		20. Rotary or C.T. Cable Tool	
21A. Kind & Status Plug. Bond Statewide		21B. Drilling Contractor Comanche Drlg.		22. Approx. Date Work will start February 29, 1982	
23. Elevation (show whether OF, HI, etc.) 3725.5					

PROPOSED CASING AND CEMENT PROGRAM

SIZE OF HOLE	SIZE OF CASING	WEIGHT PER FOOT	SETTING DEPTH	SACKS OF CEMENT	EST. TOP
10"	8 5/8"	23#	320'	200 sx	surface
8"	7"	23#	2400'	300 sx	1500'

We plan to drill a 10" hole to 320' and set 8 5/8" 23# casing, a texas pattern guide shoe and insert float. Cementing with 200 sacks Class C Cement. WOC 18 hours. Then drill an 8" hole to TD (2400'). Casing and cement program will be decided after reviewing the logs.

APPROVAL VALID FOR 180 DAYS
PERMIT EXPIRES 8-2-82
UNLESS DRILLING UNDERWAY

Posted ID-1
APE + NL B
3-5-82

IN ABOVE SPACE DESCRIBE PROPOSED PROGRAM: IF PROPOSAL IS TO DEEPEN OR PLUG BACK, GIVE DATA ON PRESENT PRODUCTIVE ZONE AND PROPOSED NEW PRODUCTIVE ZONE. GIVE BLOWOUT PREVENTER PROGRAM, IF ANY.

I hereby certify that the information above is true and complete to the best of my knowledge and belief.

Signed Anta Vigil Title Drilling Secretary Date 1-27-82
(This space for State Use)

APPROVED BY Mike Walker TITLE OIL AND GAS INSPECTOR DATE FEB 2 1982
CONDITIONS OF APPROVAL, IF ANY:

NEW MEXICO OIL CONSERVATION COMMISSION
WELL LOCATION AND ACREAGE DEDICATION PLAT

Form 7-1-12
Supersedes C-124
Effective 1-1-65

All distances must be from the outer boundaries of the Section

Operator Cibola Energy Corp.		Lease Plains 29		Acres 2	
Section E	Section 29	Township 10 South	Range 28 East	County Chaves	
Actual distance from the point West 1980		Actual distance from the point East 660		Actual distance from the point North 1980	
Actual distance from the point South 3725.5'		Producing Formation San Andres		Water Right 40	
Land Owner LE Ranch		Tract Description Race Track San Andres		Section 40	

- Outline the acreage dedicated to the subject well by colored pencil or hatchure marks on the plat below.
- If more than one lease is dedicated to the well, outline each and identify the ownership thereof (both as to working interest and royalty)
- If more than one lease of different ownership is dedicated to the well, have the interests of all owners been consolidated by communitization, unitization, force-pooling, etc?

☐ Yes ☒ No If answer is "yes," type of consolidation _____

If answer is "no," list the owners and tract descriptions which have actually been consolidated (the reverse side of this form if necessary.) All leases held by operator and participating parties

No allowable will be assigned to the well until all interests have been consolidated (by communitization, unitization, forced-pooling, or otherwise) or until a non-standard unit, eliminating such interests, has been approved by the Commission.

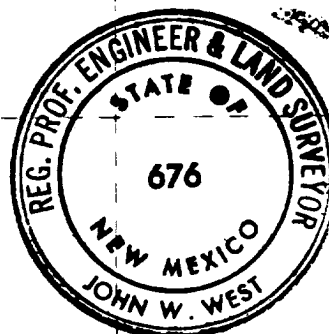
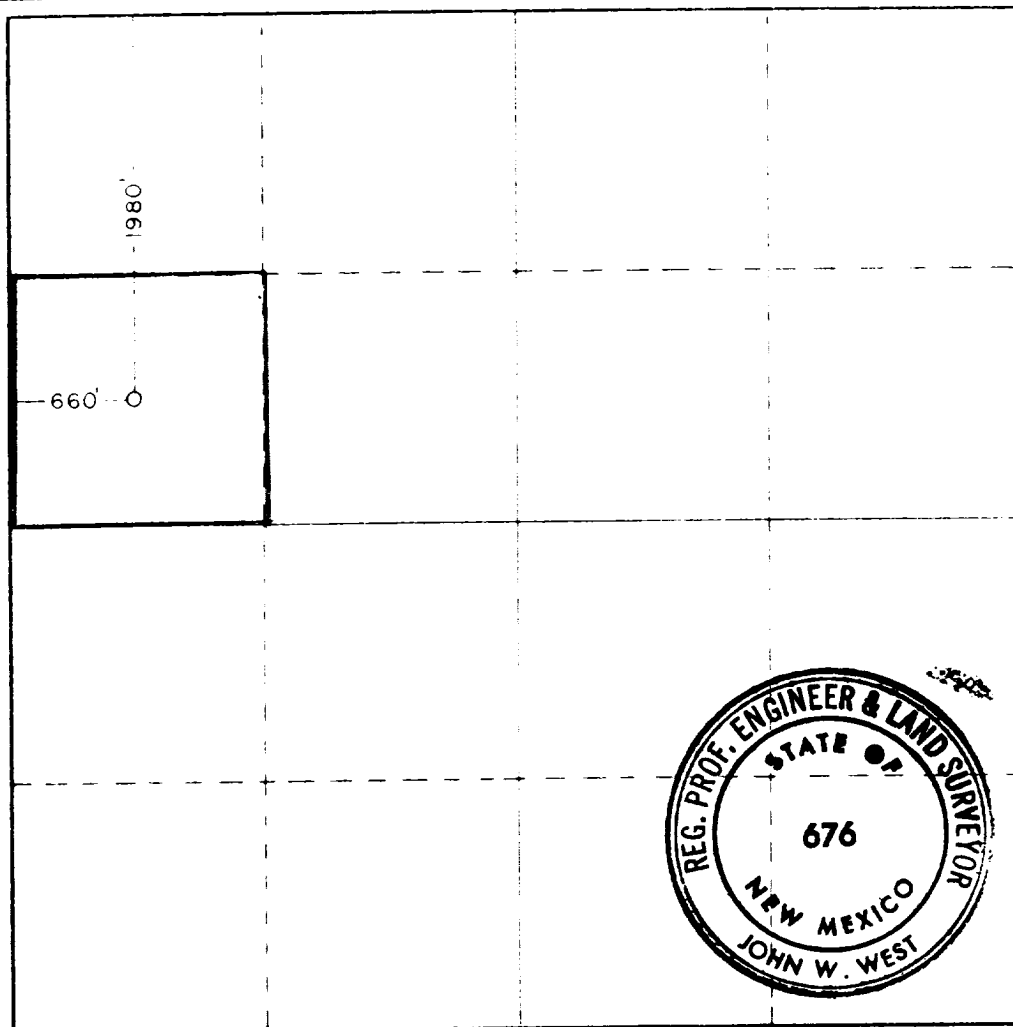

CERTIFICATION

I hereby certify that the information contained herein is true and complete to the best of my knowledge and belief.

Anita Vigil

Anita Vigil

Drilling Secretary

Cibola Energy Corporation

January 27, 1982

I hereby certify that the well location shown on this plat was plotted from field notes of actual surveys made by me or under my supervision and that the same is true and correct to the best of my knowledge and belief.

Dec. 7, 1981

Registered Professional Engineer
and Land Surveyor

John W. West

Certificate No. **JOHN W. WEST 676**
PATRICK A. ROMERO 6863
Ronald J. Eidson 3239

0 330 660 990 1320 1650 1980 2310 2640 2970 3300 3630 3960 4290 4620 4950 5280 5610 5940 6270 6600