

STATE OF NEW MEXICO
OIL AND MINERALS DEPARTMENT

CONSERVATION DIVISION
P. O. BOX 2088
SANTA FE, NEW MEXICO 87501

RECEIVED

FEB 18 1982

30-005-61292

Form C-101
Revised 10-1-78

NO. OF COPIES RECEIVED	
DISTRIBUTION	
SANTA FE	1
FILE	1
U.S.G.S.	2
LAND O	1
GENERAL	1

C. C. D.
ARTESIA, OFFICE

APPLICATION FOR PERMIT TO DRILL, DEEPEN, OR PLUG BACK

Type of Well DRILL <input checked="" type="checkbox"/> AMENDED <u>Location</u> DEEPEN <input type="checkbox"/> PLUG BACK <input type="checkbox"/>		5A. Indicate Type of Lease STATE <input checked="" type="checkbox"/> REC <input type="checkbox"/>	
Type of Well OIL <input type="checkbox"/> GAS WELL <input checked="" type="checkbox"/> OTHER <input type="checkbox"/>		5. State Oil & Gas Lease No. LG-569	
Name of Operator Yates Petroleum Corporation		7. Unit Agreement Name	
Address of Operator 207 S. 4th, Artesia, New Mexico 88210		8. Farm or Lease Name Skink "SK" State	
Location of Well UNIT LETTER <u>N</u> LOCATED <u>660'</u> FEET FROM THE <u>South</u> LINE <u>1980</u> FEET FROM THE <u>West</u> LINE OF SEC. <u>36</u> TWP. <u>7S</u> RGE. <u>25E</u> NADPM		9. Well No. 2	
		10. Field and Pool, or Wildcat <input checked="" type="checkbox"/> Undes. Pecos Slope Abo	
		17. County Chaves	
19. Proposed Depth appr. 4150'		19A. Formation Abo	
20. Rotary or C.T. Rotary		21. Kind & Status Plug Bond Blanket	
21B. Drilling Contractor L&M Drilling Co.		22. Approx. Date Work will start ASAP	

PROPOSED CASING AND CEMENT PROGRAM

SIZE OF HOLE	SIZE OF CASING	WEIGHT PER FOOT	SETTING DEPTH	SACKS OF CEMENT	EST. TOP
14 3/4"	10 3/4"	40.5 J-55	Appr. 850'	630 sx	circulated
7 7/8"	4 1/2"	10.5#	TD	350 sx	

We propose to drill and test the Abo and intermediate formations. Approximately 850' of surface casing will be set and cement circulated to shut off gravel and caving. If needed (lost circulation) 7" or 8 5/8" intermediate casing will be run to 1500' and cemented with enough cement calculated to tie back into the surface casing. Temperature survey will be run to determine cement top. If commercial, production casing will be run and cemented with adequate cover, perforate, and stimulate as needed for production.

MUD PROGRAM: FW gel and LCM to 850', Brine to 3200', Brine & KCL water to TD. MW 10-10.2

BOP PROGRAM: BOP's will be installed at approximately 1500' and tested daily.

CAS NOT DEDICATED.

APPROVAL VALID FOR 180 DAYS
PERMIT EXPIRES 8-23-82
UNLESS DRILLING UNDERWAY

OVER SPACE DESCRIBE PROPOSED PROGRAM: IF PROPOSAL IS TO DEEPEN OR PLUG BACK, GIVE DATA ON PRESENT PRODUCTIVE ZONE AND PROPOSED NEW PRODUCE. GIVE PREVENTER PROGRAM, IF ANY.

I hereby certify that the information above is true and complete to the best of my knowledge and belief.

[Signature] Title Regulatory Coordinator Date 2/17/82
(For Use by State Use)

APPROVED BY [Signature] TITLE OIL AND GAS INSPECTION DATE FEB 23 1982

CONDITIONS OF APPROVAL, IF ANY:

Notify N.M.O.C.C. in sufficient
time to witness cementing

the 1034 casing

Received ID-1
+ 100 pages
for record
2-26-82

W MEXICO OIL CONSERVATION COMMISSION
WELL LOCATION AND ACREAGE DEDICATION PLAT

Form C-102
Supersedes C-128
Effective 1-4-65

All distances must be from the outer boundaries of the Section.

Operator YATES PETROLEUM CORPORATION			Lease Skink "SK" State		Well No. 2
Unit N	Section 36	Township 7South	Range 25 East	County Chaves	
Actual Well Location of Well: 660 feet from the South line and 1980 feet from the West line					
Ground Level Elev. 3608.5	Producing Formation Abo		Pool Undes. Pecos Slope Abo		Dedicated Acreage: 160 Acres

1. Outline the acreage dedicated to the subject well by colored pencil or hachure marks on the plat below.
2. If more than one lease is dedicated to the well, outline each and identify the ownership thereof (both as to working interest and royalty).
3. If more than one lease of different ownership is dedicated to the well, have the interests of all owners been consolidated by communitization, unitization, force-pooling, etc?

☐ Yes ☐ No If answer is "yes," type of consolidation _____

If answer is "no," list the owners and tract descriptions which have actually been consolidated. (Use reverse side of this form if necessary.) _____

_____ allowable will be assigned to the well until all interests have been consolidated (by communitization, unitization, forced-pooling, or otherwise) or until a non-standard unit, eliminating such interests, has been approved by the Commission.

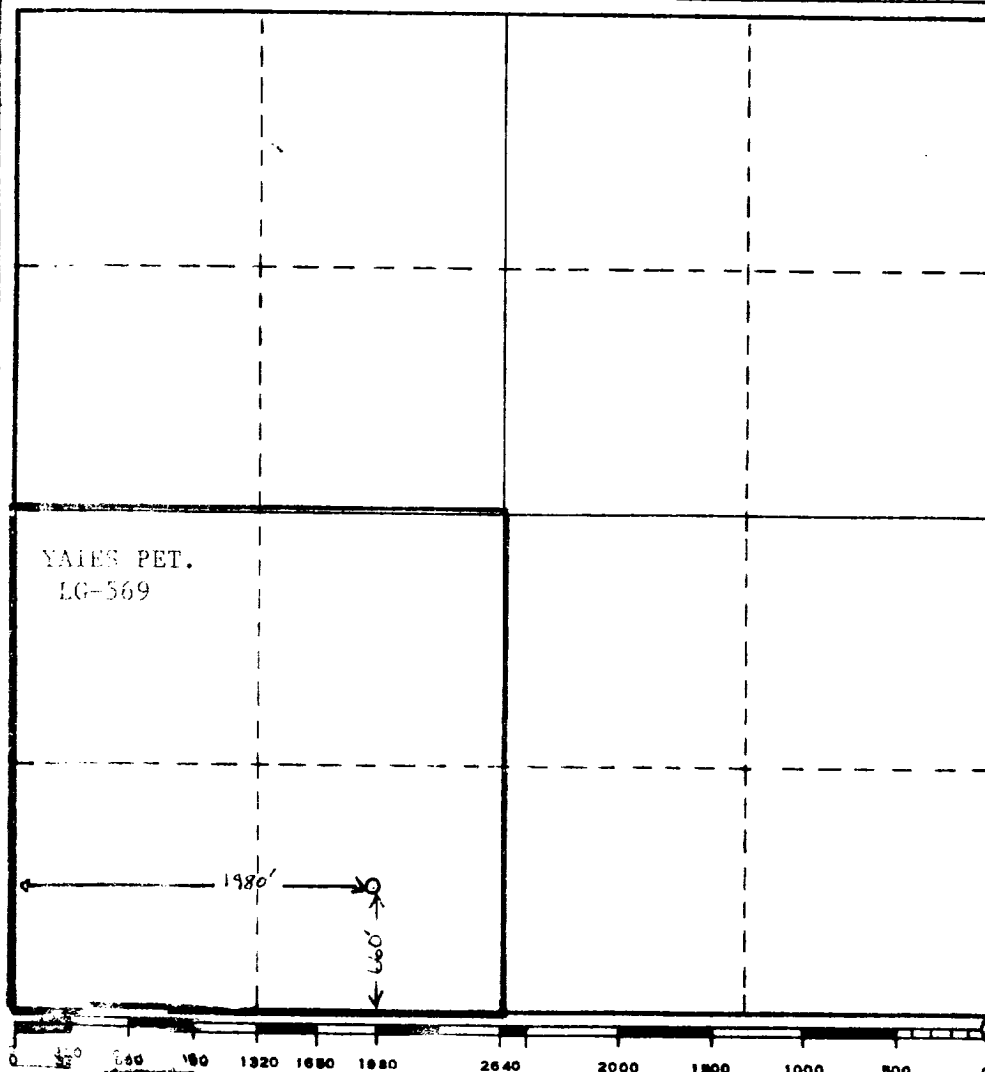

CERTIFICATION

I hereby certify that the information contained herein is true and complete to the best of my knowledge and belief.

Ken Beardemphl

Name
Ken Beardemphl
Position
Regulatory Coordinator
Company
Yates Petroleum Corporation
Date
2/17/82

I hereby certify that the well location shown on this plat was located from field notes, or under my supervision, and the same is true and correct to the best of my knowledge and belief.

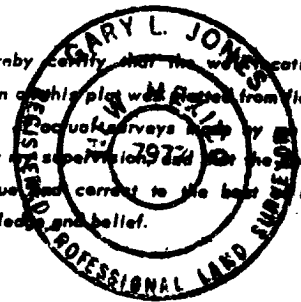

Date Surveyed
February 17, 1982

Registered Professional Engineer
and/or Land Surveyor

Gary L. Jones
Certificate No. **7977**

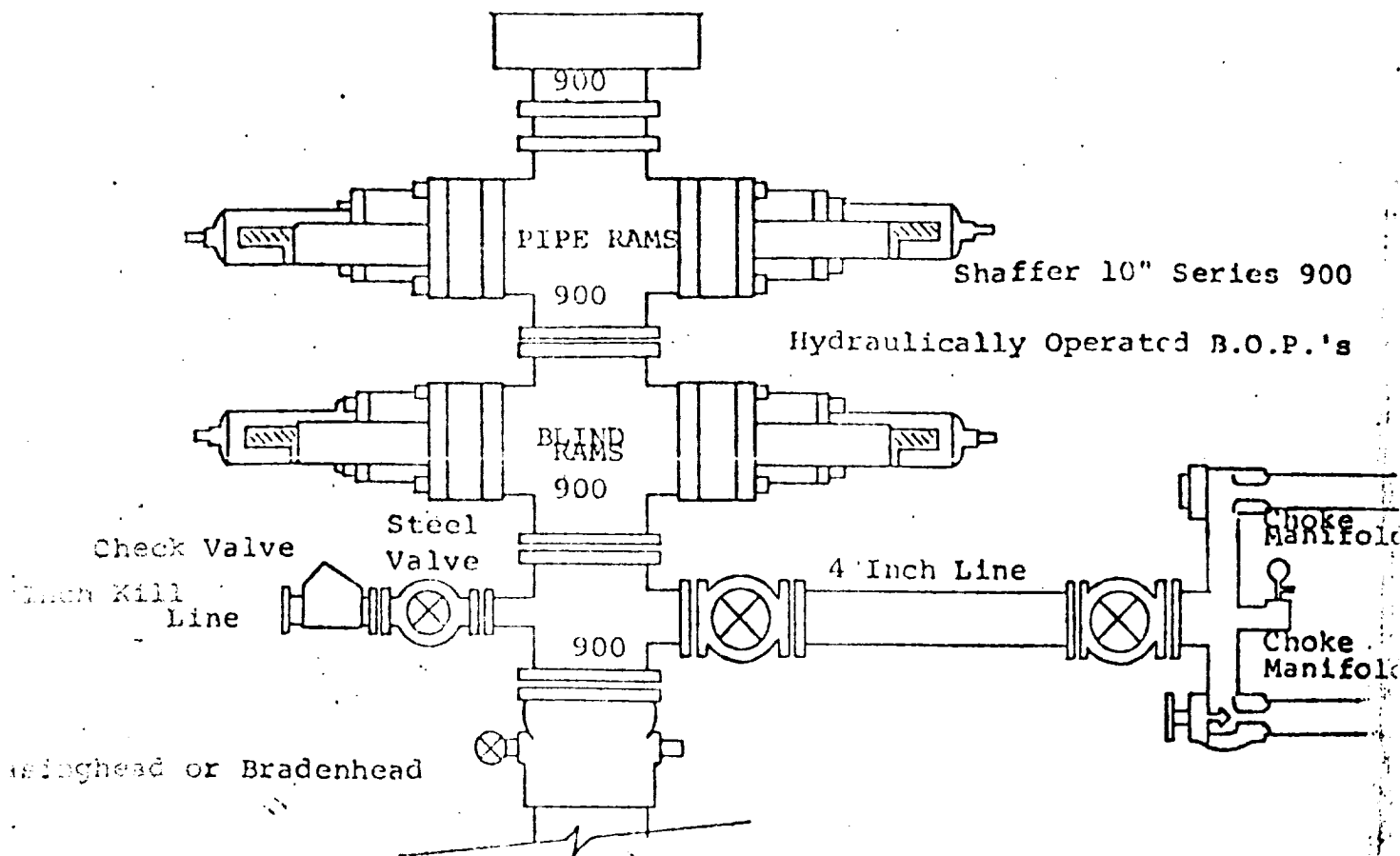

THE FOLLOWING CONSTITUTE MINIMUM BLOWOUT PREVENTER REQUIREMENTS

- All preventers to be hydraulically operated with secondary manual control installed prior to drilling out from under casing.
- Choke outlet to be a minimum of 4" diameter.
- Kill line to be of all steel construction of 2" minimum diameter.
- All connections from operating manifolds to preventers to be all steel, hole or tube a minimum of one inch in diameter.
- The available closing pressure shall be at least 15% in excess of that required with sufficient volume to operate the B.O.P.'s.
- All connections to and from preventer to have a pressure rating equivalent to that of the B.O.P.'s.
- Inside blowout preventer to be available on rig floor.
- Operating controls located a safe distance from the rig floor.
- Hole must be kept filled on trips below intermediate casing. Operator not responsible for blowouts resulting from not keeping hole full.
- B. P. float must be installed and used below zone of first gas intrusion.