

UNITED STATES
DEPARTMENT OF THE INTERIOR

GEOLOGICAL SURVEY

30-005-61399

APPLICATION FOR PERMIT TO DRILL, DEEPEN, OR PLUG BACK

1a. TYPE OF WORK

DRILL ☒DEEPEN ☐PLUG BACK ☐

b. TYPE OF WELL

OIL
WELL ☐GAS
WELL ☒OTHER ☐SINGLE
ZONE ☐RECEIVED
ZONE ☐

2. NAME OF OPERATOR

Rault Petroleum Corporation ✓

FEB 11 1982

3. ADDRESS OF OPERATOR

808 W. Missouri Street

O. C. D.

4. LOCATION OF WELL (Report location clearly and in accordance with any State requirements.)

At surface

660' FS & 990' FEL

ARTESIA, OFFICE

At proposed prod. zone

Same

14. DISTANCE IN MILES AND DIRECTION FROM NEAREST TOWN OR POST OFFICE*

Approximately 12 miles northwest of Roswell, NM

15. DISTANCE FROM PROPOSED*

LOCATION TO NEAREST
PROPERTY OR LEASE LINE, FT.

(Also to nearest drlg. unit line, if any)

660'

16. NO. OF ACRES IN LEASE

960

17. NO. OF ACRES ASSIGNED
TO THIS WELL

160

18. DISTANCE FROM PROPOSED LOCATION*

TO NEAREST WELL, DRILLING, COMPLETED,
OR APPLIED FOR, ON THIS LEASE, FT.

None

19. PROPOSED DEPTH

4300'

20. ROTARY OR CABLE TOOLS

Rotary

21. ELEVATIONS (Show whether DF, RT, GR, etc.)

4082 GR.

22. APPROX. DATE WORK WILL START*

As soon as possible

23.

PROPOSED CASING AND CEMENTING PROGRAM

SIZE OF HOLE	SIZE OF CASING	WEIGHT PER FOOT	SETTING DEPTH	QUANTITY OF CEMENT
11"	8 5/8"	24#	1600'	Circulate to surface*
7 7/8"	4 1/2"	10.5#	4300'	Sufficient to cover all pay zones and water zones (See reverse for cement)

Mud Program: See exhibit "G"

BOF Program: Series 900 exhibit "E"

Gas not dedicated.

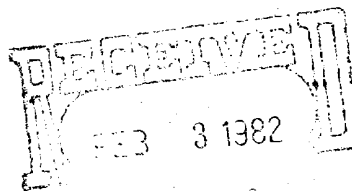
OIL & GAS
U.S. GEOLOGICAL SURVEY
ROSWELL, NEW MEXICORout 8 ID-1
API - M. Boul
2-12-82

IN ABOVE SPACE DESCRIBE PROPOSED PROGRAM: If proposal is to deepen or plug back, give data on present productive zone and proposed new productive zone. If proposal is to drill or deepen directionally, give pertinent data on subsurface locations and measured and true vertical depths. Give blowout preventer program, if any.

24.

SIGNED

Jim Childers

TITLE MANAGER

DATE 1/5/82

(This space for Federal or State office use)

PERMIT NO.

APPROVED

APPROVED BY

CONDITIONS OF APPROVAL, IF ANY

FEB 9 1982

JAMES A. GILLHAM
DISTRICT SUPERVISORAPPROVAL SUBJECT TO
GENERAL REQUIREMENTS AND
SPECIAL STIPULATIONS
ATTACHED

DATE

*See Instructions On Reverse Side

Instructions

General: This form is designed for submitting proposals to perform certain well operations, as indicated, on all types of lands and leases for appropriate action by either a Federal or a State agency, or both, pursuant to applicable Federal and/or State laws and regulations. Any necessary special instructions concerning the use of this form and the number of copies to be submitted, particularly with regard to local, area, or regional procedures and practices, either are shown below or will be issued by, or may be obtained from, the local Federal and/or State office.

Item 1: If the proposal is to redrill to the same reservoir at a different subsurface location or to a new reservoir, use this form with appropriate notations. Consult applicable State or Federal regulations concerning subsequent work proposals or reports on the well.

Item 4: If there are no applicable State requirements, locations on Federal or Indian land should be described in accordance with Federal requirements. Consult local State or Federal office for specific instructions.

Item 14: Needed only when location of well cannot readily be found by road from the land or lease description. A plat, or plats, separate or on this reverse side, showing the roads to, and the surveyed location of, the well, and any other required information, should be furnished when required by Federal or State agency offices.

Items 15 and 18: If well is to be, or has been directionally drilled, give distances for subsurface location of hole in any present or objective production zone.

Item 22: Consult applicable Federal or State regulations, or appropriate officials, concerning approval of the proposal before operations are started.

★ U.S. GOVERNMENT PRINTING OFFICE : 1963-O-711-396

Cement Program Exhibit "F"

11" hole/8 5/8" Casing:

1000sx HLW containing 5#/sx Gilsonite,
1#/sx Flocele, 4% CaCl followed with
200sx class "C" tail in cement con-
taining 2% CaCl and 1#/sx Flocele.

7 7/8" hole 4 1/2" Casing:

650sx HLW, 10#/sx salt, 1#/sx Flocele,
tail in with 350sx class "C" 5#/sx
KCL, .3% Halad 4, .2% CFR-2.

All distances must be from the outer boundaries of the Section.

Operator Rault Petroleum Corp.			Lease Tommy		Well No. #1
Unit Letter P	Section 24	Township 9 South	Range 22 East	County Chaves	
Actual Postage Location of Well: 990 feet from the East line and 660 feet from the South line					
Ground Level Elev. 4081	Producing Formation Abo		Pool Wildcat		Dedicated Acreage: 160 Acres

1. Outline the acreage dedicated to the subject well by colored pencil or hatchure marks on the plat below.
2. If more than one lease is dedicated to the well, outline each and identify the ownership thereof (both as to working interest and royalty).
3. If more than one lease of different ownership is dedicated to the well, have the interests of all owners been consolidated by communitization, unitization, force-pooling, etc?

☐ Yes ☐ No If answer is "yes," type of consolidation _____

If answer is "no," list the owners and tract descriptions which have actually been consolidated. (Use reverse side of this form if necessary.) _____

No allowable will be assigned to the well until all interests have been consolidated (by communitization, unitization, forced-pooling, or otherwise) or until a non-standard unit, eliminating such interests, has been approved by the Division.

Sec. 24, T.9 S., R.22 E., N.M.P.M.

MTS Ltd. Part. 50%
Public Lands Exp 50%

990'

660'

CERTIFICATION

I hereby certify that the information contained herein is true and complete to the best of my knowledge and belief.

George R. Smith

Name

George R. Smith

Position

Agent for

Company

Rault Petroleum Corp.

Date

February 2, 1982

I hereby certify that the well location shown on this plat was plotted from field notes of actual surveys made by me or under my supervision, and that the same is true and correct to the best of my knowledge and belief.

Date Surveyed

January 29, 1982

Registered Professional Engineer and/or Land Surveyor

John D. Jaquess
John D. Jaquess, P.E. & L.S.

Certificate No.

6290

APPLICATION FOR DRILLING
Rault Petroleum Corporation
Tommy Federal Well No. 1
Chaves County, New Mexico

In conjunction with Form 9-311C, Application for Permit to Drill subject well, Rault Petroleum Corporation submits the following ten items of pertinent information in accordance with USGS requirements:

1. The geologic surface formation is Permian.
2. The estimated tops of geologic markers are as follows:

San Andres	0'
Glorieta	661'
Yeso	858'
Tubb	2374'
Abo	2960'
Hueco	3582'
Penn	3855'
Basement	4005'

3. The estimated depths at which anticipated water, oil or gas formations are expected to be encountered:

Water: Approximately 275 feet.
Gas: Abo: Approximately 2960 feet.

4. Proposed Casing Program: See Form 9-331C and exhibit F.
5. Pressure Control Equipment: See Form 9-331C and exhibit E.
6. Mud Program: See exhibit G.
7. Auxiliary Equipment: See exhibit H.
8. Logging:

Logging unit from 1600' to TD.
Electric Log Program:

Gamma/Neutron Density Porosity Log
Gamma/Dual Laterolog 8

9. No abnormal pressures or temperatures are anticipated.
10. Anticipated starting date: As soon as possible.

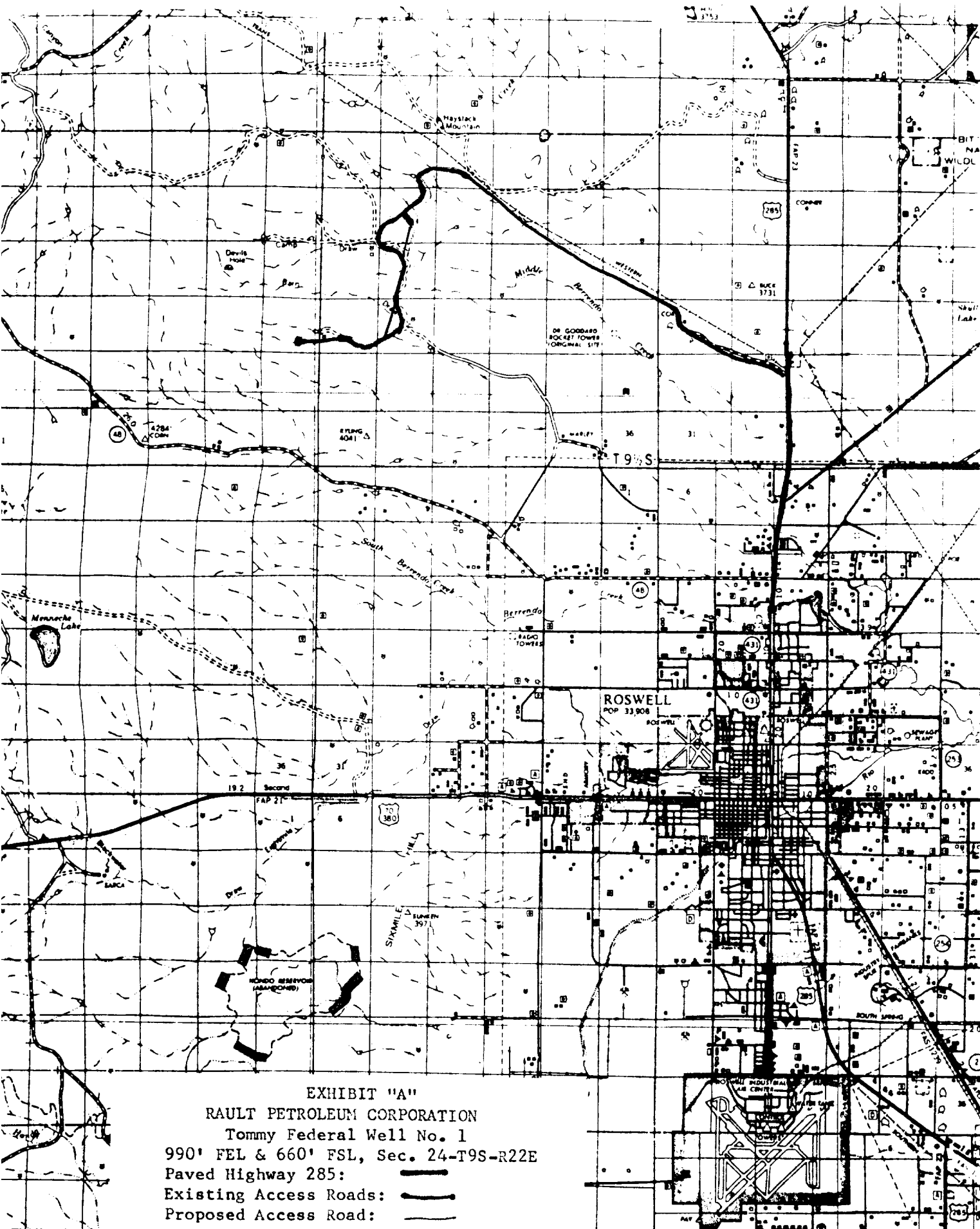
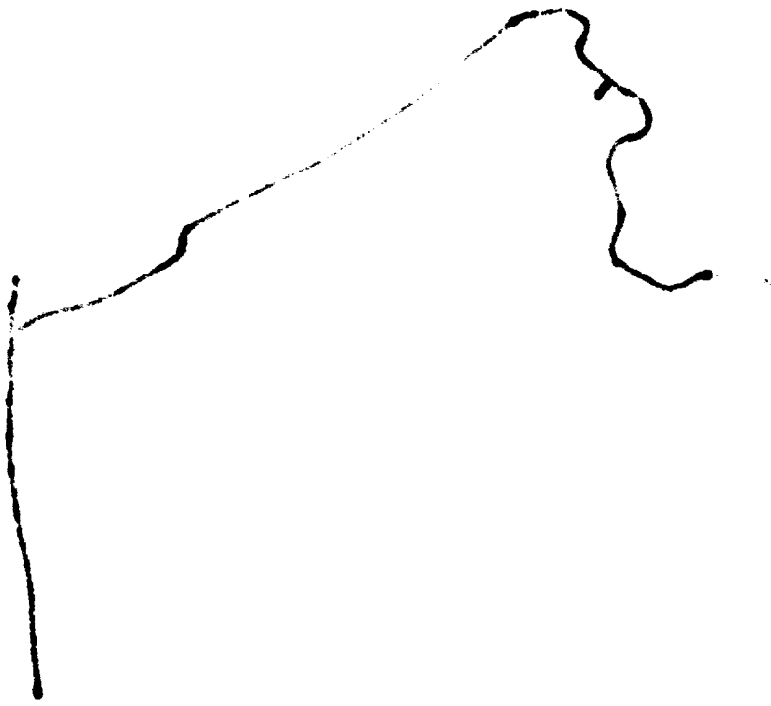
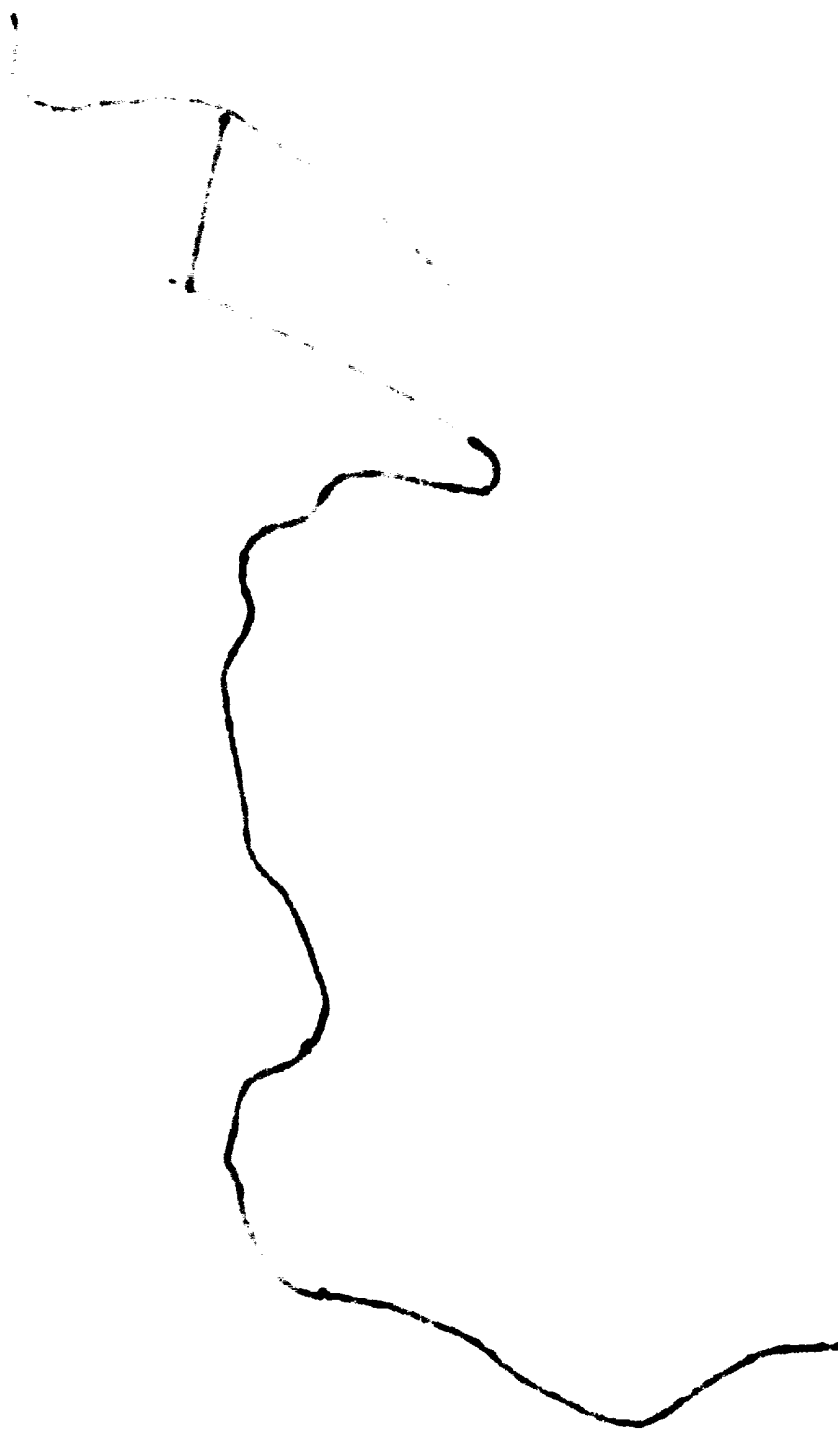

EXHIBIT "A"
 RAULT PETROLEUM CORPORATION
 Tommy Federal Well No. 1
 990' FEL & 660' FSL, Sec. 24-T9S-R22E
 Paved Highway 285:
 Existing Access Roads:
 Proposed Access Road:





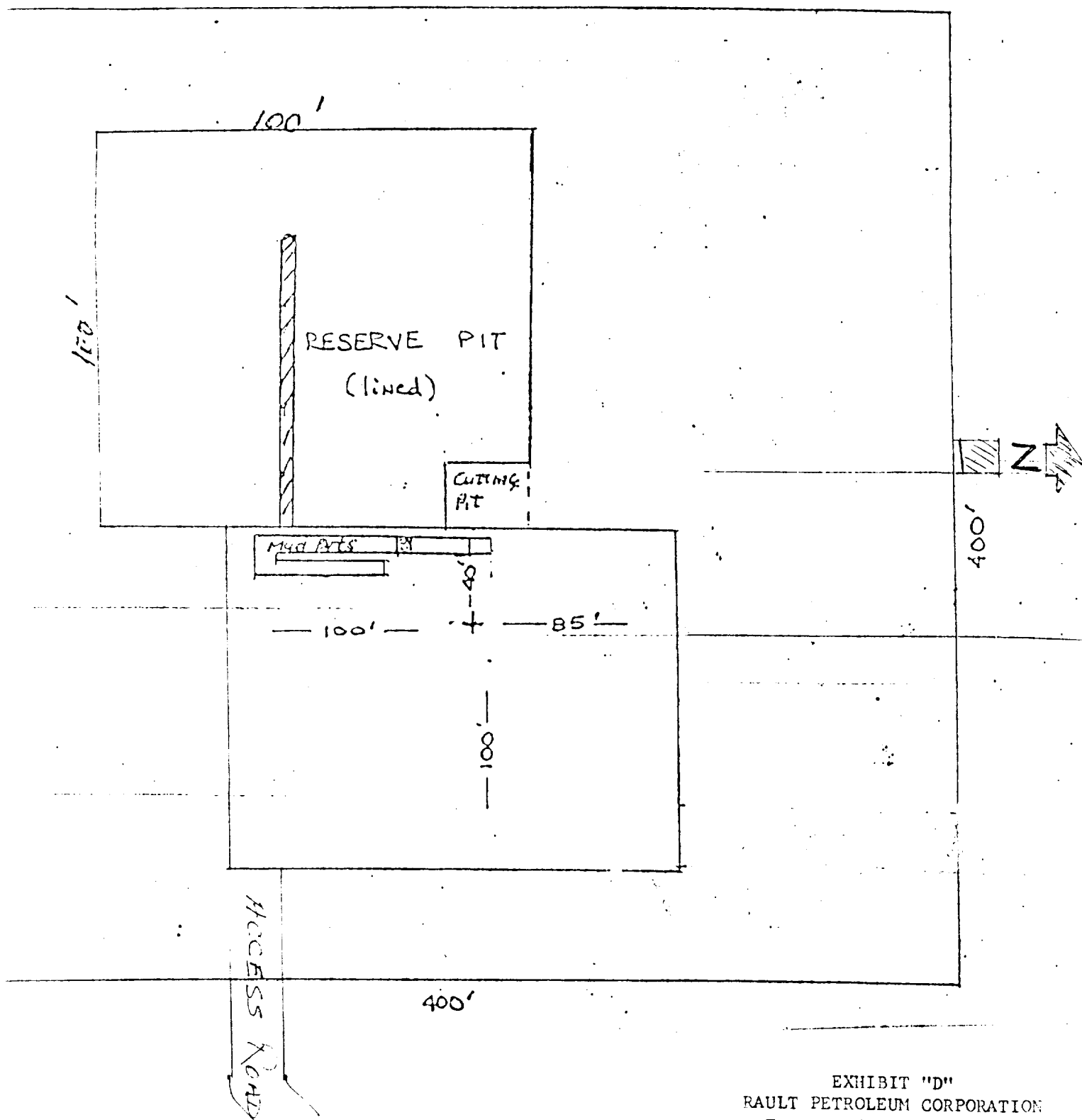
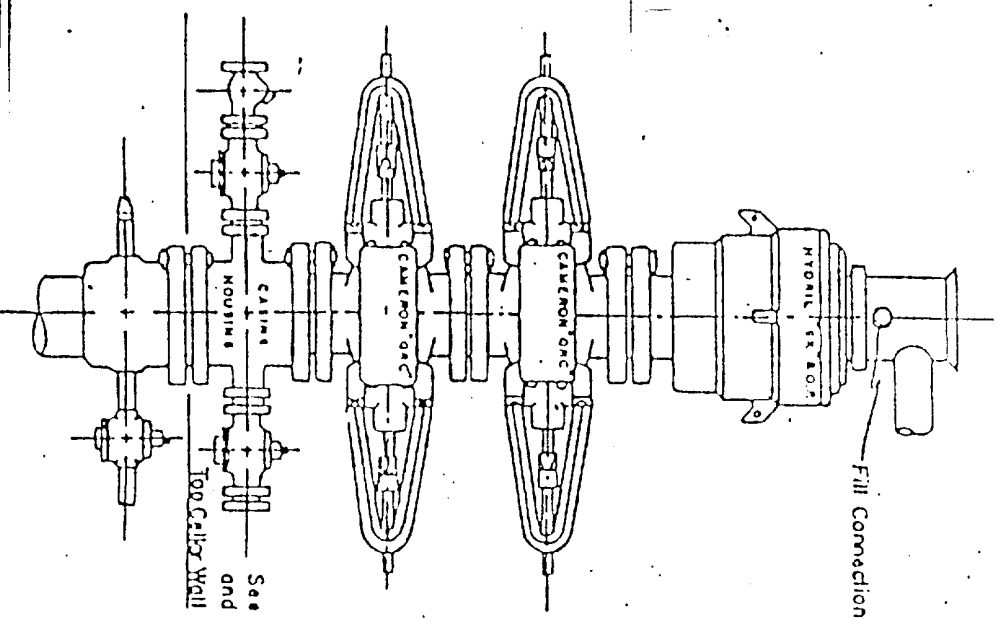
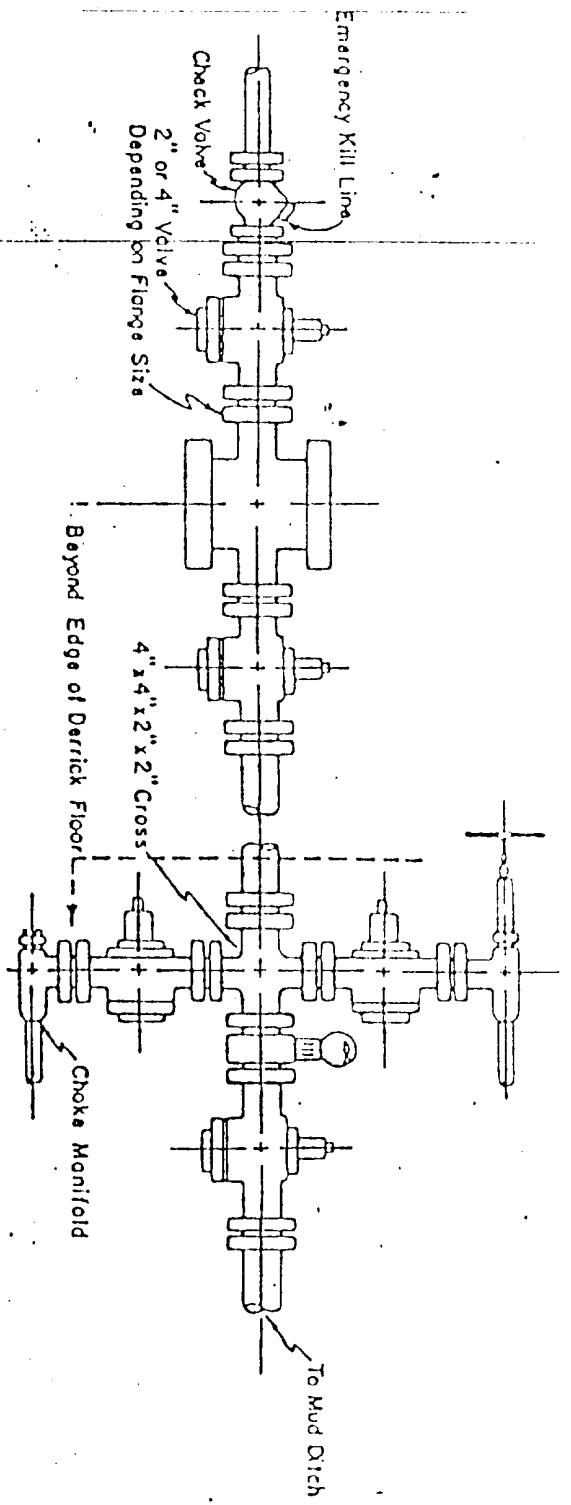

EXHIBIT "D"
 RAULT PETROLEUM CORPORATION
 Tommy Federal Well No. 1
 Chaves County, New Mexico
 Rig Layout



See Detail of 4" Flow Line and Choke Assembly

3,000 PSI WORKING PRESSURE
BLOW-OUT PREVENTER HOOK-UP



3,000 PSI WORKING PRESSURE
KILL, CHOKE, AND FILL CONNECTIONS

DETAIL OF 4" FLOW LINE CHOKE ASSEMBLY

Minimum assembly for 3,000 PSI working pressure will consist of three preventers.
The bottom and middle preventers may be Cameron.

NOTE: HYDRIL not installed on shallow-low pressure wells.
RAM type BOPs are API 10" X 5000 PSI

EXHIBIT "E"
PAUL PETROLEUM CORPORATION
Tommy Federal Well No. 1
Chaves County, New Mexico
BOP SPECIFICATIONS

RAULT PETROLEUM CORPORATION

SUMMARY

Drilling, Casing and Cementing Program

1. Drill 11" hole to 1600'±. Will be in San Andres at surface.
2. Cement 8 5/8", 24# K-55 casing with 1000sx. HOWCO Lite containing 5#/sk. Gilsonite and 1/4#/sk. Flocele, in 4% CaCl followed with 200sx. Class "C" containing 2% CaCl₂ and 1/4#/sk. Flocele. Run Texas Pattern Guide Shoe with an insert float valve in top of shoe joint. Weld first few joints of casing. Use one wooden plug to displace cement.
3. Release pressure immediately, nipple up and install BOP's. Test casing to 600psi after 18 hours and drill out cement.
4. Drill 7 7/8" hole to 4050' in Basement.
5. Cement 4 1/2", 10.5# K-55 casing with 650sx. HOWCO Lite containing 10#Salt/sk., 1/4#/sk. Flocele, and tail in with 350sx. Class "C" containing 5#/sx. KCL, .3% Holad 4, .2% CFR-2. Run Guide shoe and insert float on bottom joint, and 3-6 centralizers. Weld first few joints of casing. Use one wooden plug to displace cement.
6. Perforations, acid job, and additional stimulation to be determined after completion.

EXHIBIT "F"
RAULT PETROLEUM CORPORATION
Tommy Federal Well No. 1
Chaves County, New Mexico
Drilling, Casing And Cementing Program

EXHIBIT II

PAULT DRILLING CO.

RIG #1

INVENTORY

DERRICK: Midway 107-M210-0 Trailer Mounted Rig with Midway 107' 210,000 lbs. hydraulically raised & scoped mast.

DRAWWORKS: Midway 4500 Single drum drawworks with Parmac 22' SR Single hydromatic brake.
Power: Two 8-V71 U Detroit Diesels with Air Start & Torque Converter.

MUD PUMP: 2 Ellis Williams W440 Triplex Mud Pumps with forged fluid ends with desander. Power: 2 8V92 Detroit Diesels.

LIGHT PLANT: 2 Kato 40 LW generators powered by two Waukesha VRD310 Diesels engines.

SHALE SHAKER: Thompson Rotating type

WATER TANK: 1 500 bbl. Frac Tanks type single axle.

FUEL TRAILER: 8'W X 35' L. tandem axle fuel carrier

DRILL PIPE 6500' of 4 $\frac{1}{2}$ 16.60 lbs. Grade # Range 2 hard banded drill pipe

DRILL COLLARS 21 6 $\frac{1}{2}$ X 30' drill collars

DOG HOUSE: 7'W X 7'H X 21' L Doghouse mounted on Hobbs tandem axle float with elevating supports to drill floor height

HOUSING: Prowler 8'W X 28' L tandem axle House Trailer air-conditioned.

BOP: Reagan torus 8" 3000 PSI annular type with Tillary Parks 1 station closing unit

TWO WAY RADIOS: Motorola

MUD STORAGE: 24' tandem axle gooseneck mud storage trailer