

NM OIL CO. COMMISSION
UNITED STATES
DEPARTMENT OF THE INTERIOR
GEOLOGICAL SURVEY

SUBMIT IN TRIPLICATE*
(Other instructions on re-
verse side)

Form approved.
Budget Bureau No. 42-R1424.

5. LEASE DESIGNATION AND SERIAL NO.

32323

6. IF INDIAN, ALLOTTEE OR TRIBE NAME

7. UNIT AGREEMENT NAME

8. FARM OR LEASE NAME

Five Mile Tank Federal

9. WELL NO.

2-Z

10. FIELD AND POOL, OR WILDCAT

Abo Wildcat

11. SEC., T., R., M., OR BLK. AND
SURVEY OR AREA

Sec. 9-6S-23E

12. COUNTY OR PARISH 13. STATE

Chaves

N.M.

1. OIL ☐ GAS ☒ OTHER ☐

2. NAME OF OPERATOR

Transwestern Gas Supply Company

3. ADDRESS OF OPERATOR

P. O. Box 2521 Houston, Texas 77252

4. LOCATION OF WELL (Report location clearly and in accordance with any State requirements. See also space 17 below.)
At surface

1380' FSL & 1980' FEL, Sec. 9, T.6S, R.23E

14. PERMIT NO.

15. ELEVATIONS (Show whether DF, RT, GR, etc.)

4198' GL

NOV 1 1982

16. Check Appropriate Box To Indicate Nature of Notice, Report, or Other Data

NOTICE OF INTENTION TO:

TEST WATER SHUT-OFF

PULL OR ALTER CASING

FRACTURE TREAT

MULTIPLE COMPLETE

SHOOT OR ACIDIZE

ABANDON*

REPAIR WELL

CHANGE PLANS

(Other)

SUBSEQUENT REPORT OF:

WATER SHUT-OFF

REPAIRING WELL

FRACTURE TREATMENT

ALTERING CASING

SHOOTING OR ACIDIZING

ABANDONMENT*

(Other) Casing

(NOTE: Report results of multiple completion on Well Completion or Recompletion Report and Log form.)

17. DESCRIBE PROPOSED OR COMPLETED OPERATIONS (Clearly state all pertinent details, and give pertinent dates, including estimated date of starting any proposed work. If well is directionally drilled, give subsurface locations and measured and true vertical depths for all markers and zones pertinent to this work.)

2/3/82 Spud well @ 5:15 p.m., 2/1/82. Drld 17½" hole to 700'. Ran 17 jts., 13 3/8", 48#, H-40, 8 rd casing set @ 676.59' with 950 sx, 50-50 POZ cmt containing ¼# Flocele/sx, 5# Gilsonite/sx & 2% CaCl₂, tailed in w/150 sx Class "C", 2% CaCl₂. Plug down & WOC 10:00 p.m. 2/3/82. No returns to surface. After 6 hrs WOC, temp log indicated TOC @ 420'.

2/4/82 Cemented 13 3/8" annulus in 4 stages w/650 sx through 1" tubing.

2/6/82 Ran 27 jts. 8 5/8", 24#, K-55, ST&C casing set @ 1119' with 600 sx 50-50 POZ plus 2% CaCl₂, tailed in with 150 sx Class "C" plus 2% CaCl₂. TOC @ 840'. Spot 100 sx Class "C" plus 4% CaCl₂, wait 1 hr. Spot 200 sx Class "C" plus 4% CaCl₂. WOC 8 hrs. Cmt annulus w/50 sx Class "C" plus 4% CaCl₂, circ 5 sx. WOC 8 hrs.

2/14/82 Ran 40 jts 7", 42.40#, K-55, ST&C casing set @ 1600' with 350 sx Class "C" plus 2% CaCl₂. WOC 8 hrs.

2/20/82 Ran 89 jts. 4½", 10.5#, K-55, 8 rd ST&C casing set @ 3751' with 300 gals mud flush followed by 350 sx Class "C" 50-50 POZ plus .6% Halad 22-A plus .4% CFR2 plus 5#/sx KCL. PD @ 5:15 a.m. Rel rig. 6:32 a.m.

18. I hereby certify that the foregoing is true and correct

SIGNED

TITLE

DATE 11/9/92

(This space for Federal Records Office use)

APPROVED BY
CONDITIONS OF

(ORIG. SGD.) DAVID R. GLASS

DATE

U.S. GEOLOGICAL SURVEY
ROSWELL, NEW MEXICO

See Instructions on Reverse Side

UNITED STATES
DEPARTMENT OF THE INTERIOR
GEOLOGICAL SURVEY

5. LEASE DESIGNATION AND SERIAL NO.

NM 32323

6. IF INDIAN, ALLOTTEE OR TRIBE NAME

7. UNIT AGREEMENT NAME

8. FARM OR LEASE NAME

Fivemile Tank Federal

9. WELL NO.

2Y 22

10. FIELD AND POOL, OR WILDCAT

Abo Wildcat

11. SEC., T., R., M., OR BLK.
AND SURVEY OR AREA

Sec. 9-6S-23E

12. COUNTY OR PARISH

Chaves

13. STATE

N.M.

1a. TYPE OF WORK

DRILL ☒DEEPEN ☐PLUG BACK ☐

b. TYPE OF WELL

OIL
WELL ☐GAS
WELL ☒

OTHER

SINGLE
ZONE ☒MULTIPLE
ZONE ☐

2. NAME OF OPERATOR

TRANSWESTERN GAS SUPPLY COMPANY

3. ADDRESS OF OPERATOR

P.O. Box 2521, Houston, TX 77001

4. LOCATION OF WELL (Report location clearly and in accordance with any State requirements.)*

At surface

1800 /S 1980 /E Sec. 9-6S-23E

At proposed prod. zone

Same

14. DISTANCE IN MILES AND DIRECTION FROM NEAREST TOWN OR POST OFFICE*

29 miles north-northwest of Roswell, New Mexico

15. DISTANCE FROM PROPOSED*

LOCATION TO NEAREST
PROPERTY OR LEASE LINE, FT.
(Also to nearest drlg. unit line, if any)

760'

16. NO. OF ACRES IN LEASE

2008.1

17. NO. OF ACRES ASSIGNED

TO THIS WELL 160

18. DISTANCE FROM PROPOSED LOCATION*

TO NEAREST WELL, DRILLING, COMPLETED,
OR APPLIED FOR, ON THIS LEASE, FT.

7600'

19. PROPOSED DEPTH

4500'±

20. ROTARY OR CABLE TOOLS

Rotary

21. ELEVATIONS (Show whether DF, RT, GR, etc.)

4198' GL

22. APPROX. DATE WORK WILL START*

January 30, 1982

23.

PROPOSED CASING AND CEMENTING PROGRAM

| SIZE OF HOLE | SIZE OF CASING | WEIGHT PER FOOT | SETTING DEPTH | QUANTITY OF CEMENT |
|--------------|----------------|-----------------|---------------|--|
| 26" | 20" | 94.0# H-40 | 60' | 100 cu.ft. of Redi-Mix |
| 17 1/2" | 13 3/8" | 48.0# K-55 | 750'± | 890 sx (Circulated) |
| 12 1/4" | 8 5/8" | 24.0# K-55 | 1300'± | 385 sx (Cement back to 13 3/8") |
| 7 7/8" | 4 1/2" | 10.5# J-55 | TD | ± 225 sx (Sufficient to isolate all water, gas and oil zones) |

Fish in hole on No. 2Y well necessitated junking of hole. Approval is requested to skid rig 75' south and drill to Abo objective. See attached revised Surface Use Plan. Except for the above revised casing program the drilling and BOP plan will be identical to the plan approved for the original well.

Oral approval to start above operation was obtained from U.S.G.S. on January 30, 1982.

The gas is dedicated to Transwestern P.L. Co.

IN ABOVE SPACE DESCRIBE PROPOSED PROGRAM: If proposal is to deepen or plug back, give data on present productive zone and proposed new productive zone. If proposal is to drill or deepen directionally, give pertinent data on subsurface locations and measured and true vertical depths. Give blowout preventer program, if any.

24.

SIGNED

JERRY W. LONG

TITLE Agent

DATE January 30, 1982

(This space for Federal or State office use)

PERMIT NO.

APPROVED

APPROVAL DATE

APPROVED BY

FEB 1 1982

TITLE

DATE

JAMES A. GILLHAM
DISTRICT SUPERVISOR

*See Instructions On Reverse Side

RECEIVED
FEB 1 1982OIL & GAS
U.S. GEOLOGICAL SURVEY
ROSWELL, NEW MEXICOPosted ID-1
API + NL Book
2-19-82Post ID-1
12-3-82
Bjg. in file

All distances must be from the outer boundaries of the S.

| | | | | | |
|---|-----------------------------------|----------------------------|--|-------------------------|---|
| Operator Transwestern Gas Supply COMPANY | | | Lease Five Mile Tank Federal | | Well No. 22 244 |
| Unit Letter J | Section 9 | Township 6 South | Range 23 East | County Chaves | |
| Actual Postage Location of Well: 1880 feet from the South line, and 1980 feet from the East line | | | | | |
| Ground Level Elev. 4198 | Producing Formation ABO | | Pool UNDESIGNATED ABO | | Dedicated Acreage: (SE$\frac{1}{4}$) 160 Acres |

1. Outline the acreage dedicated to the subject well by colored pencil or hatchure marks on the plat below.

2. If more than one lease is dedicated to the well, outline each and identify the ownership thereof (both as to working interest and royalty). **Single Lease**

3. If more than one lease of different ownership is dedicated to the well, have the interests of all owners been consolidated by communitization, unitization, force-pooling, etc?

☐ Yes ☐ No If answer is "yes," type of consolidation _____

If answer is "no," list the owners and tract descriptions which have actually been consolidated. (Use reverse side of this form if necessary.) _____

No allowable will be assigned to the well until all interests have been consolidated (by communitization, unitization, forced-pooling, or otherwise) or until a non-standard unit, eliminating such interests, has been approved by the Division.

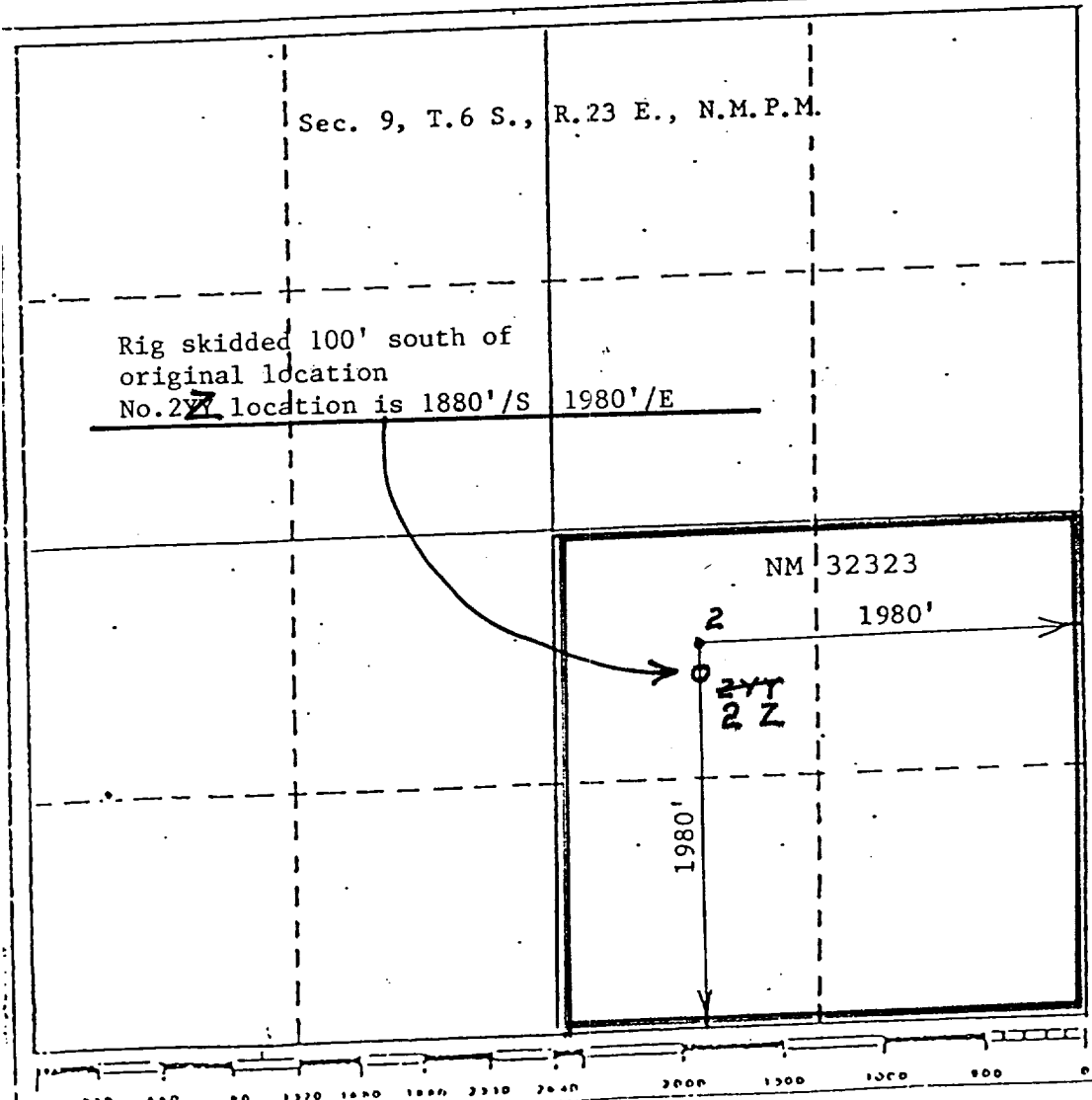

CERTIFICATION

I hereby certify that the information contained herein is true and complete to the best of my knowledge and belief.

Jerry W. Long
Name
JERRY W. LONG

Position
Agent

Company
TRANSWESTERN GAS SUPPLY CO

Date
November 24, 1981

REVISED January 30, 1982

I hereby certify that the well location shown on this plat was plotted from field notes of actual surveys made by me or under my supervision, and that the same is true and correct to the best of my knowledge and belief.

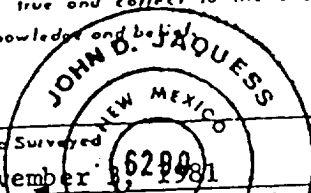

Date Surveyed
November 24, 1981

Registered Professional Engineer and/or Land Surveyor

John D. Jaquess
John D. Jaquess, P.E. & L.S.

Certificate No.
6290

REVISED SURFACE USE PLAN

22

TRANSWESTERN GAS SUPPLY COMPANY
No. ~~2Y~~ Fivemile Tank Federal
1880'/S 1980'/E Sec. 9-6S-23E
Chaves County, N.M.

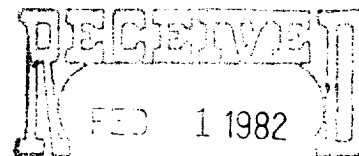

OIL & GAS
U.S. GEOLOGICAL SURVEY
ROSWELL, NEW MEXICO

NM 32323

The previously approved Surface Use Plan for the drilling of the No. 2 Fivemile Tank Federal well is revised as follows to conform to drilling of the above well. The drilling of the No. 2 ~~Y~~ well is necessitated by loss of the No. 2 and No. 2Y wells because of the inability to fish junk out of the holes.

9. WELL SITE LAYOUT:

- A. The rig and drilling components will be moved to a point 100' south of the original location and a new hole will be drilled to the Abo objective.
- B. Moving the rig will require enlarging the pad about 75' to the south and constructing new circulating and reserve pits.
- C. The original rig layout plat indicated that the pits would be on the west side of the pad. This should be corrected to indicate the east side.
- D. The new disturbed area will be within the 400' square previously cleared for archaeological impact.
- E. An agreement has been made with Mr. William D. McKnight, surface owner, regarding rehabilitation of the disturbed area.

13. CERTIFICATION:

I hereby certify that I, or persons under my direct supervision, have inspected the proposed drillsite and access route; that I am familiar with the conditions which presently exist; that the statements made in this plan are, to the best of my knowledge true and correct; and, that the work associated with the operations proposed herein will be performed by TRANSWESTERN GAS SUPPLY COMPANY and its sub-contractors in conformity with this plan and the terms and conditions under which it is approved.

January 30, 1982
Date:

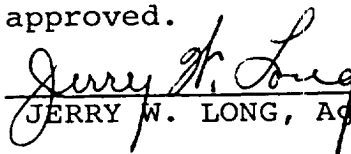
JERRY W. LONG, Agent