

NM OIL CONS. COM.
Drawer DD
Artesia, 88210

SUBMIT IN TR DATE*
(Other instructions on reverse side)

Form approved.
Budget Bureau No. 42-R1425.

UNITED STATES
DEPARTMENT OF THE INTERIOR
GEOLOGICAL SURVEY

APPLICATION FOR PERMIT TO DRILL, DEEPEN, OR PLUG BACK

1. TYPE OF WORK
DRILL ☒ DEEPEN ☐ PLUG BACK ☐

2. TYPE OF WELL
OIL WELL ☐ GAS WELL ☒ OTHER ☐ SINGLE ZONE ☐ MULTIPLE ZONE ☐

3. NAME OF OPERATOR
Yates Petroleum Corporation

4. ADDRESS OF OPERATOR
207 S. 4th, Artesia, New Mexico 88210

5. LEASE DESIGNATION AND SERIAL NO.
NMA12125

6. IF INDIAN, ALLOTTEE OR TRIBE NAME

7. UNIT AGREEMENT NAME

8. FARM OR LEASE NAME
Coffman NY Federal

9. WELL NO.
2

10. FIELD AND POOL, OR WILDCAT
Wildecat

11. SEC., T., R., M., OR BLM. AND SURVEY OR AREA
Sec. 25-T7S-R25E

12. COUNTY OR PARISH
Chaves

13. STATE
NM

14. DISTANCE IN MILES AND DIRECTION FROM NEAREST TOWN OR POST OFFICE*
approximately 25 miles NNE of Roswell, NM.

15. DISTANCE FROM PROPOSED LOCATION TO NEAREST PROPERTY OR LEASE LINE, FT. (Also to nearest drilg. unit line, if any)
660'

16. NO. OF ACRES IN LEASE
320

17. NO. OF ACRES ASSIGNED TO THIS WELL
160

18. DISTANCE FROM PROPOSED LOCATION TO NEAREST WELL, DRILLING, COMPLETED, OR APPLIED FOR, ON THIS LEASE, FT.
approx. 4200'

19. PROPOSED DEPTH
approx. 4200'

20. ROTARY OR CABLE TOOLS
rotary

21. ELEVATIONS (Show whether DF, RT, GR, etc.)
3625.7 GL

22. APPROX. DATE WORK WILL START*
ASAP

PROPOSED CASING AND CEMENTING PROGRAM

SIZE OF HOLE	SIZE OF CASING	WEIGHT PER FOOT	SETTING DEPTH	QUANTITY OF CEMENT
15"	10 3/4"	48# J-55	880'	300 sx circuate
7 7/8"	5 1/2" or 4 1/2"	15.5# or 10.5#	TD	450 sx

We propose to drill and test the Abo and intermediate formations. Approximately 880' of surface casing will be set and cement circulated to shut off gravel and caving. If needed (lost circulation) 8 5/8" intermediate casing will be run to 1500' and cemented with enough cement calculated to tie back into the surface casing. Temperature survey will be run to determine cement top. If commercial, production casing will be run and cemented with adequate cover, perforate, and stimulate as needed for production.

MUD PROGRAM: FW gel and LCM to 880', Brine to 3500', Brine & KCL water to TD

BOP PROGRAM: BOP's will be installed at the offset and tested daily

GAS NOT DEDICATED.

RECEIVED
FEB 11 1982

OIL & GAS
U.S. GEOLOGICAL SURVEY
NEW MEXICO

ABOVE SPACE DESCRIBE PROPOSED PROGRAM: If proposal is to deepen or plug back, give data on present productive zone. If proposal is to drill or deepen directionally, give pertinent data on subsurface locations and measured and true vertical depths. Give blowout preventer program, if any.

SIGNED *[Signature]* TITLE Regulatory Manager DATE 2/5/82

(This space for Federal or State office use)

PERMIT NO. **APPROVED** APPROVAL DATE

APPROVED BY **FEB 22 1982** TITLE APPROVAL SUBJECT TO GENERAL REQUIREMENTS AND SPECIAL STIPULATIONS ATTACHED DATE

CONDITIONS OF APPROVAL **JAMES A. GILLHAM** DISTRICT SUPERVISOR

Posted ID-1 API + NL Book 2-24-82

V MEXICO OIL CONSERVATION COMMISSION
WELL LOCATION AND ACREAGE DEDICATION PLAT

Form C-102
Supersedes C-128
Effective 1-1-65

All distances must be from the outer boundaries of the Section.

YATES PETROLEUM CORPORATION			Lease Coffman NY Federal		Well No. 2
Section 25	Township 7 South	Range 25 East	County Chaves		
Actual Well Location of Well:					
660 feet from the North line and		660 feet from the East line			
Ground Level Elev: 3625.7'	Producing Formation ABO	Pool Pecoslope ABO	Dedicated Acreage: 16.0 Acres		

1. Outline the acreage dedicated to the subject well by colored pencil or hachure marks on the plat below.
2. If more than one lease is dedicated to the well, outline each and identify the ownership thereof (both as to working interest and royalty).
3. If more than one lease of different ownership is dedicated to the well, have the interests of all owners been consolidated by communitization, unitization, force-pooling, etc?

☐ Yes ☐ No If answer is "yes" type of consolidation _____

If answer is "no" list the owners and tract descriptions which have actually been consolidated. (Use reverse side of this form if necessary.) _____

No allowable will be assigned to the well until all interests have been consolidated (by communitization, unitization, forced-pooling, or otherwise) or until a non-standard unit, eliminating such interests, has been approved by the Commission.

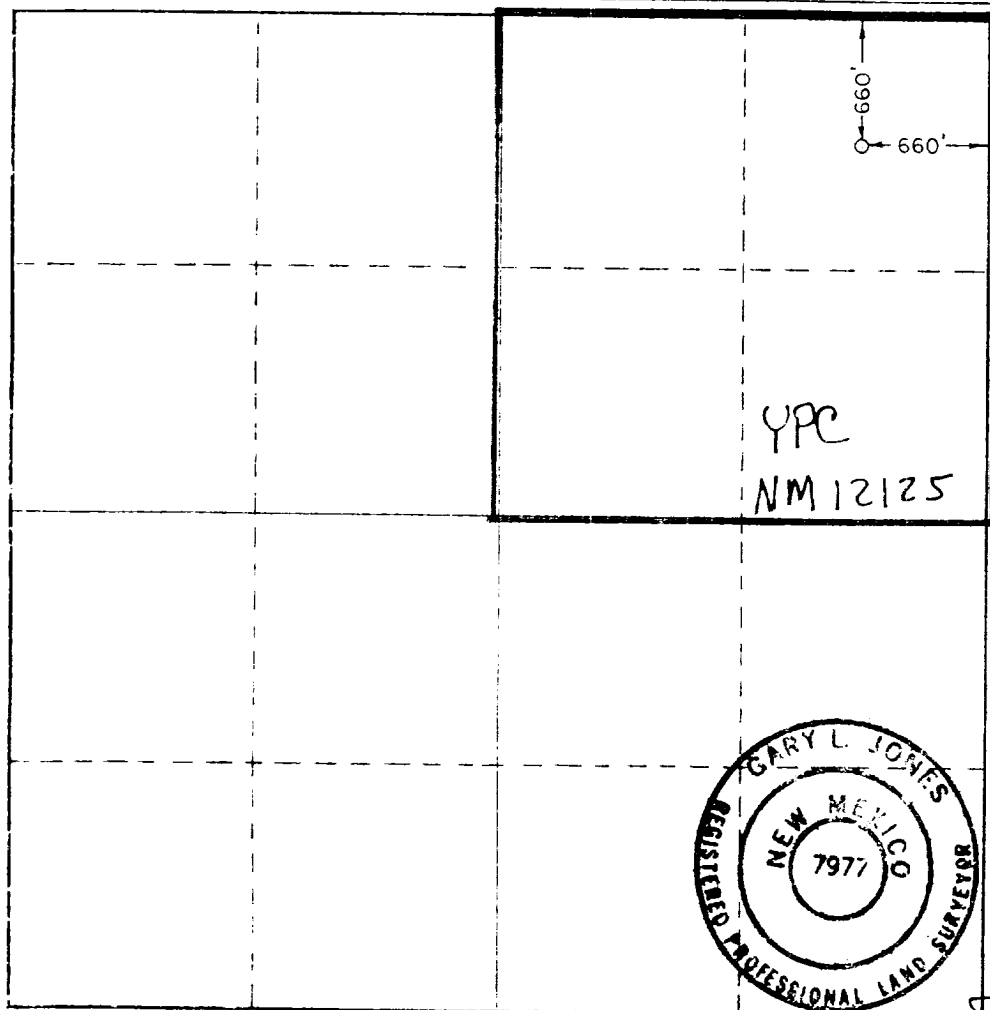

CERTIFICATION

I hereby certify that the information contained herein is true and complete to the best of my knowledge and belief.

Gliserio Rodriguez

Name
Gliserio Rodriguez
Position
Regulatory Manager
Company
Yates Petroleum Corporation
Date
1/21/82

I hereby certify that the well location shown on this plat was plotted from field notes of actual surveys made by me or under my supervision, and that the same is true and correct to the best of my knowledge and belief.

Date Surveyed
1/19/82
Registered Professional Engineer and/or Land Surveyor

Gary L. Jones
Certificate No.

7977

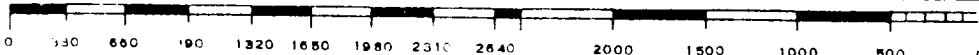

es Petroleum Corporation
Coffman "NY" Federal #2
660' FNL and 660' FEL
Section 25-T7S-R25E

In conjunction with Form 9-331C, Application for Permit to Drill subject well, Yates Petroleum Corporation submits the following tem items of pertinent information in accordance with USGS requirements:

1. The geologic surface formation is quaternary alluvium.
2. The estimated tops of geologic markers are as follows:

San Andres	400'
Glorietta	1814'
Fullerton	2925'
Abo	3625'
TD	4200'

3. The estimated depths at which anticipated water, oil, or gas formations are expected to be encountered:

Water: Approximately 70 - 150'

Oil or Gas: Abo - 3640'

4. Proposed Casing Program: See Form 9-331C
5. Pressure Control Equipment: See Form 9-331C and Exhibit B.
6. Mud Program: See Form 9-331C.
7. Auxiliary Equipment: Kelly Cock; pit level indicators and flow sensor equipment;
sub with full-opening valve on floor, drill pipe connection.
8. Testing, Logging and Coring Program:

Samples: Surface casing to TD.
DST's: As warranted.
Logging: Intermediate casing to TD
CNL-FDC TD to casing with GR-CNL on to surface and DIL from TD to casing
with selected min. R_xO
Coring: None anticipated.
9. No abnormal pressures or temperatures are anticipated.
10. Anticipated starting date: As soon as possible after approval.

582

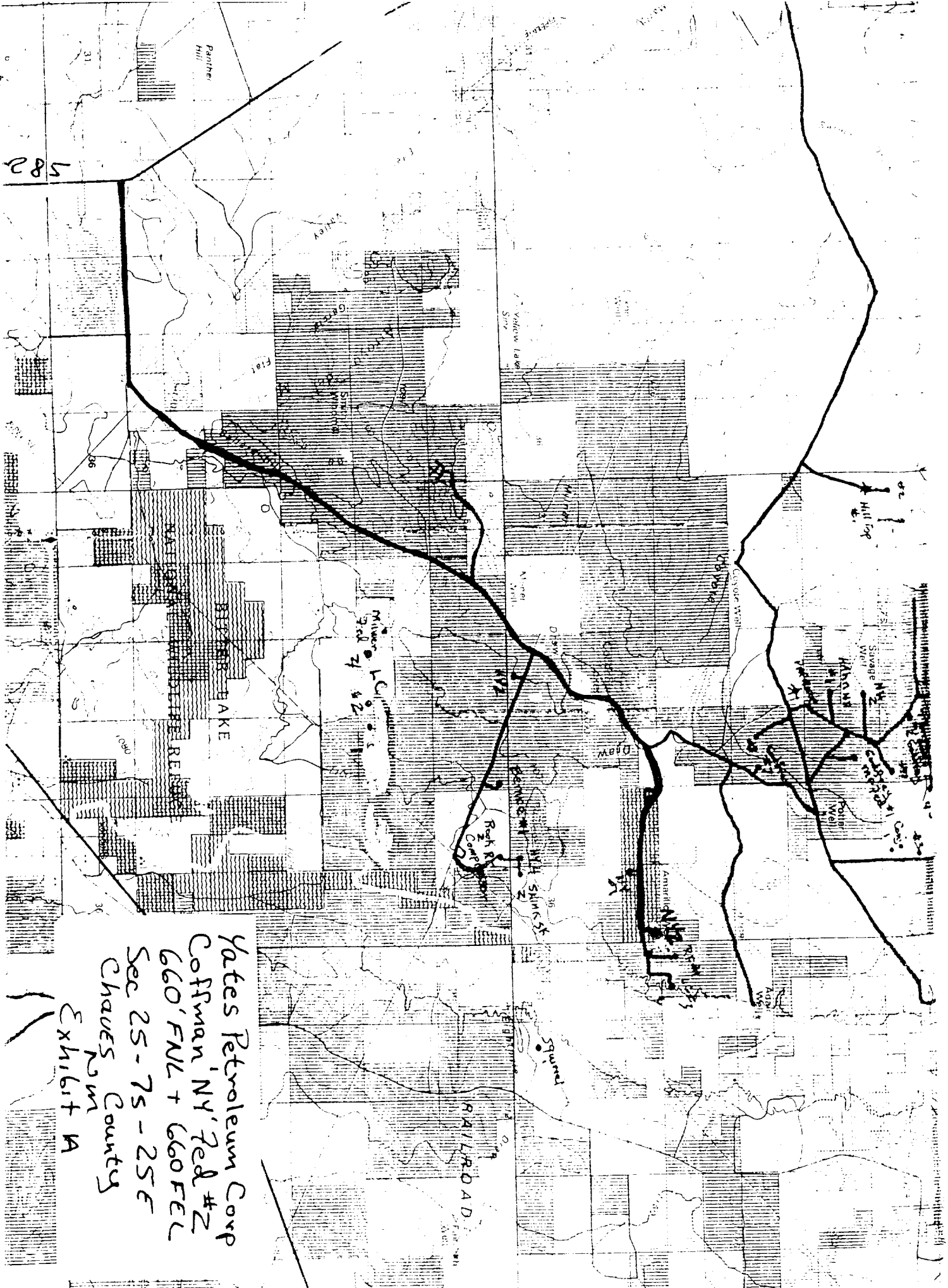

Yates Petroleum Corp
Coffman, NY, Fed #2
660' FNL + 660' FEL
Sec 25-75-25E
Chaves County
New Mexico
Exhibit A

EXHIBIT B

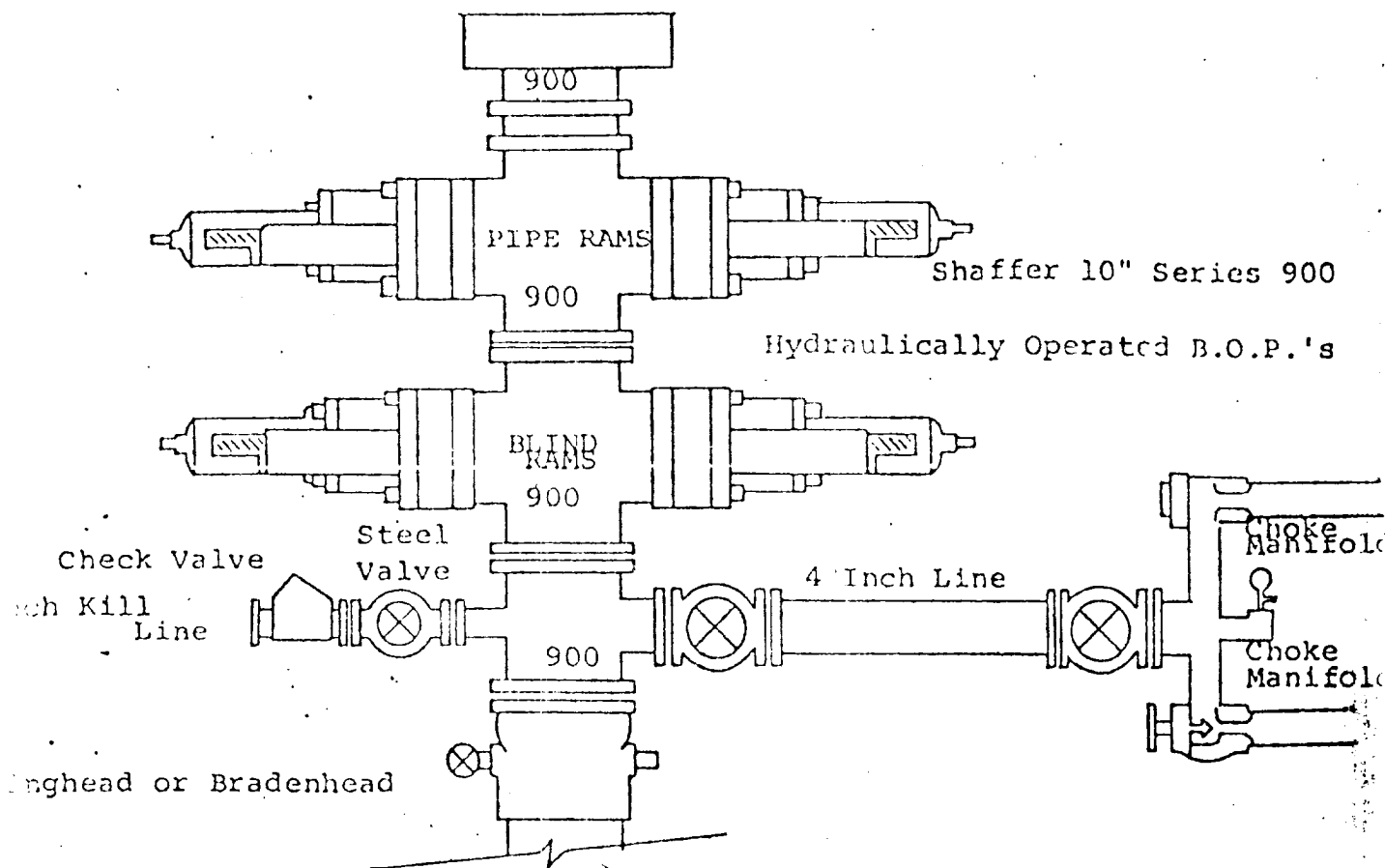

FOLLOWING CONSTITUTE MINIMUM BLOWOUT PREVENTER REQUIREMENTS

- All preventers to be hydraulically operated with secondary manual control installed prior to drilling out from under casing.
- Choke outlet to be a minimum of 4" diameter.
- Kill line to be of all steel construction of 2" minimum diameter.
- All connections from operating manifolds to preventers to be all steel. hole or tube a minimum of one inch in diameter.
- The available closing pressure shall be at least 15% in excess of that required with sufficient volume to operate the B.O.P.'s.
- All connections to and from preventer to have a pressure rating equivalent to that of the B.O.P.'s.
- Inside blowout preventer to be available on rig floor.
- Operating controls located a safe distance from the rig floor.
- Hole must be kept filled on trips below intermediate casing. Operator, not responsible for blowouts resulting from not keeping hole full.
- D. P. float must be installed and used below zone of first gas intrusion.