

NO. OF COPIES RECEIVED	
DISTRIBUTION	
SANTA FE	1
FILE	1 ✓
U.S.G.S.	2
LAND OFFICE	
OPERATOR	1

NEW MEXICO OIL CONSERVATION COMMISSION

RECEIVED

FEB 22 1982

O. C. D.

ARTESIA, OFFICE

30-005-610.25

Form C-101
Revised 10-65

5A. Indicate Type of Lease
STATE ☐ FEE ☒

5. State Oil & Gas Lease No.

APPLICATION FOR PERMIT TO DRILL, DEEPEN, OR PLUG BACK

1a. Type of Work DRILL <input checked="" type="checkbox"/> DEEPEN <input type="checkbox"/> PLUG BACK <input type="checkbox"/>		7. Unit Agreement Name
b. Type of Well OIL WELL <input checked="" type="checkbox"/> GAS WELL <input type="checkbox"/> OTHER <input type="checkbox"/> SINGLE ZONE <input type="checkbox"/> MULTIPLE ZONE <input type="checkbox"/>		8. Farm or Lease Name Kathy
2. Name of Operator Cibola Energy Corporation ✓		9. Well No. 1
3. Address of Operator P.O. Box 1668, Albuquerque, New Mexico 87103		10. Field and Foot, or Wildcat Wildcat <i>Quinn</i>
4. Location of Well UNIT LETTER <u>H</u> LOCATED <u>330</u> FEET FROM THE <u>East</u> LINE AND <u>1980</u> FEET FROM THE <u>North</u> LINE OF SEC. <u>1</u> TWP. <u>10S</u> RGE. <u>28E</u> NMPM		12. County Chaves
18. Proposed Depth 1900'		19A. Formation Penrose
19B. Drilling Contractor Brumfield Drilling		20. Rotary or C.T. CT
21. Elevations (show whether DF, KI, etc.) 3859.2	21A. Kind & Status Plug. Bond Statewide	22. Approx. Date Work will start March 1, 1982

23.

PROPOSED CASING AND CEMENT PROGRAM

SIZE OF HOLE	SIZE OF CASING	WEIGHT PER FOOT	SETTING DEPTH	SACKS OF CEMENT	EST. TOP
10"	8 5/8"	20#	400'	circulate	surface
8"	4 1/2"	9.5#	1900'	200	1000

Drill a 10" hole to 400', set 8 5/8" surface casing and circulate cement.
WOC 18 hours. Drill a 8" hole to TD and run CNL Density and Induction logs.
After logs have been reviewed we plan to either plug or set casing following
NMOCD rules and regulations.

*Posted ID-1
API + M Book
2-26-82*

APPROVAL VALID FOR 180 DAYS
PERMIT EXPIRES 8-26-82
UNLESS DRILLING UNDERWAY

IN ABOVE SPACE DESCRIBE PROPOSED PROGRAM: IF PROPOSAL IS TO DEEPEN OR PLUG BACK, GIVE DATA ON PRESENT PRODUCTIVE ZONE AND PROPOSED NEW PRODUCTIVE ZONE. GIVE BLOWOUT PREVENTER PROGRAM, IF ANY.

I hereby certify that the information above is true and complete to the best of my knowledge and belief.

Signed Quita Vigil Title Drilling Secretary Date 2-19-82

(This space for State Use)

APPROVED BY Mike Williams TITLE OIL AND GAS INSPECTOR DATE FEB 26 1982

CONDITIONS OF APPROVAL, IF ANY:

NEW MEXICO OIL CONSERVATION COMMISSION
WELL LOCATION AND ACREAGE DEDICATION PLAT

Form C-102
Supersedes C-128
Effective 1-1-65

All distances must be from the outer boundaries of the Section

Operator CIBOLA ENERGY CORP.			Lease KATHY		Well No. 1
Unit Letter H	Section 1	Township 10 SOUTH	Range 28 EAST	County CHAVES	
Actual Surface Location of Well: 1980 feet from the NORTH line and 330 feet from the EAST line					
Ground Level Elev. 3859.2	Producing Formation Penrose		Pool Wildcat Queen	Dedicated Acreage 40 Acres	

1. Outline the acreage dedicated to the subject well by colored pencil or hatchure marks on the plat below.
2. If more than one lease is dedicated to the well, outline each and identify the ownership thereof (both as to working interest and royalty).
3. If more than one lease of different ownership is dedicated to the well, have the interests of all owners been consolidated by communitization, unitization, force-pooling, etc?

☐ Yes ☒ No If answer is "yes;" type of consolidation _____

If answer is "no," list the owners and tract descriptions which have actually been consolidated. (Use reverse side of this form if necessary.) All leases held by operator and participating parties

No allowable will be assigned to the well until all interests have been consolidated (by communitization, unitization, forced-pooling, or otherwise) or until a non-standard unit, eliminating such interests, has been approved by the Commission.

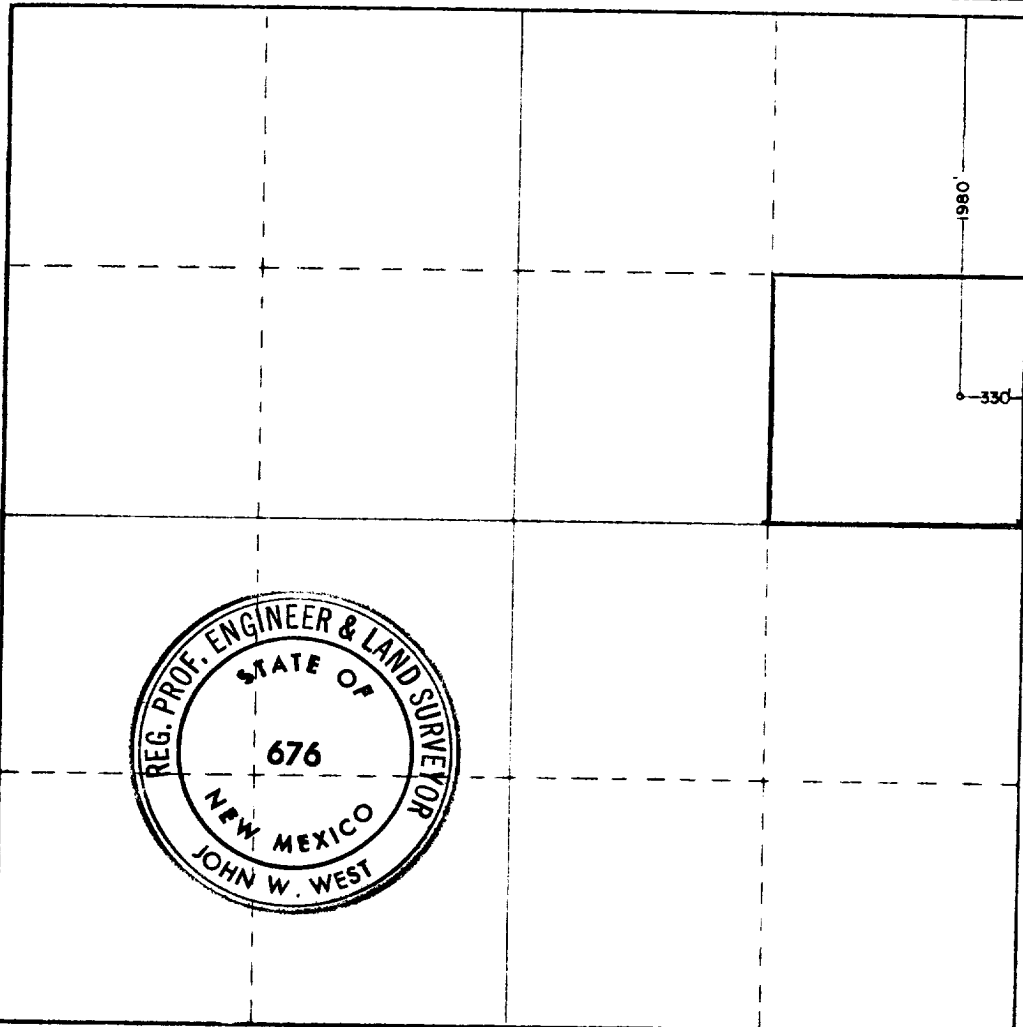

CERTIFICATION

I hereby certify that the information contained herein is true and complete to the best of my knowledge and belief

Anita Vigil

Name
Anita Vigil

Position
Drilling Secretary

Company
Cibola Energy Corporation

Date
February 19, 1982

I hereby certify that the well location shown on this plat was plotted from field notes of actual surveys made by me or under my supervision, and that the same is true and correct to the best of my knowledge and belief.

Date Surveyed

2-10-82

Registered Professional Engineer and/or Land Surveyor

John W. West

Certificate No. **JOHN W. WEST 676**
PATRICK A. ROMERO 6665
Ronald J. Eidson 3239

0 330 660 990 1320 1650 1980 2310 2640 2000 1500 1000 500