

STATE OF NEW MEXICO
ENERGY AND MINERALS DEPARTMENT

OIL CONSERVATION DIVISION REC'D
P. O. BOX 2088
SANTA FE, NEW MEXICO 87501

30-002-61427
Form C-101
Revised 10-1-78

MAR 17 1982

O. C. D.
ARTESIA, OFFICE

| | |
|------------------------|---|
| NO. OF COPIES RECEIVED | |
| DISTRIBUTION | |
| SANTA FE | 1 |
| FILE | 1 |
| U.S.G.S. | 2 |
| LAND OFFICE | 1 |
| OPERATOR | 1 |

APPLICATION FOR PERMIT TO DRILL, DEEPEN, OR PLUG BACK

| | | | |
|--|--|---|--|
| a. Type of Work DRILL <input checked="" type="checkbox"/> DEEPEN <input type="checkbox"/> PLUG BACK <input type="checkbox"/> | | AMENDED LOCATION | |
| b. Type of Well OIL WELL <input type="checkbox"/> GAS WELL <input checked="" type="checkbox"/> OTHER <input type="checkbox"/> | | SINGLE ZONE <input type="checkbox"/> MULTIPLE ZONE <input type="checkbox"/> | |
| c. Name of Operator Yates Petroleum Corporation ✓ | | 7. Unit Agreement Name | |
| d. Address of Operator 207 S. 4th, Artesia, New Mexico 88210 | | 8. Farm or Lease Name Papalote "OI" State | |
| e. Location of Well UNIT LETTER C LOCATED 660 FEET FROM THE North LINE 1980 FEET FROM THE West LINE OF SEC. 16 TWP. 7S RGE. 25E NMPM | | 9. Well No. 3 | |
| | | 10. Field and Pool, or Wildcat Pecos Slope Abo | |
| | | 12. County Chaves | |
| 19. Proposed Depth 4250' | | 19A. Formation Abo | |
| 20. Rotary or C.T. Rotary | | | |
| 21A. Kind & Status Plug. Bond Blanket | | 21B. Drilling Contractor LaRue #1 | |
| 22. Approx. Date Work will start ASAP | | | |

PROPOSED CASING AND CEMENT PROGRAM

| SIZE OF HOLE | SIZE OF CASING | WEIGHT PER FOOT | SETTING DEPTH | SACKS OF CEMENT | EST. TOP |
|--------------|----------------|-----------------|---------------|-----------------|------------|
| 12 1/4" | 10 3/4" | 40.5# J-55 | 900' | 750 sx | circulated |
| 7 7/8" | 4 1/2" | 9.5# | TD | 350 sx | |

We propose to drill and test the Abo and intermediate formations. Approximately 900' of surface casing will be set and cement circulated to shut off gravel and caving. If needed (lost circulation) 8 5/8" intermediate casing will be run to 1500' and cemented with enough cement calculated to tie back into the surface casing. If commercial, production casing will be run and cemented with adequate cover, perforate, and stimulate as needed for production.

MUD PROGRAM: FW gel and LCM to 900', Brine to 3500', Brine & KCL water to TD.

BOP PROGRAM: BOP's will be installed at the offset and tested daily.

GAS NOT DEDICATED.

APPROVAL VALID FOR 180 DAYS
PERMIT EXPIRES 9-19-82
UNLESS DRILLING UNDERWAY

ABOVE SPACE DESCRIBE PROPOSED PROGRAM; IF PROPOSAL IS TO DEEPEN OR PLUG BACK, GIVE DATA ON PRESENT PRODUCTIVE ZONE AND PROPOSED NEW PRODUCTIVE ZONE. GIVE BLOWOUT PREVENTER PROGRAM, IF ANY.

I hereby certify that the information above is true and complete to the best of my knowledge and belief.

Signed Cly Cowan Title Regulatory Coordinator Date 3/17/82

(This space for State Use)

PROVED BY Mike Wilkins TITLE OIL AND GAS INSPECTOR DATE MAR 19 1982

CONDITIONS OF APPROVAL, IF ANY:

Notify N.M.O.C.C. in sufficient
time to witness cementing
the 10 3/4" casing

NEW MEXICO OIL CONSERVATION COMMISSION
WELL LOCATION AND ACREAGE DEDICATION PLAT

Form C-102
Supersedes C-128
Effective 1-1-65

All distances must be from the outer boundaries of the Section.

| | | | | | |
|--|----------------------------|---------------------|------------------------------|------------------|---------------------------------|
| Operator YATES PETROLEUM CORPORATION | | | Lease Papalote "OI" State | | Well No. 3 |
| Unit Letter E | Section 16 | Township 7 South | Range 25 East | County Chaves | |
| Actual Footage Location of Well: 660' feet from the North line and 1980 feet from the West line | | | | | |
| Ground Level Elev. 3890.2 | Producing Formation Abo | | Pool Pecos Slope Abo | | Dedicated Acreage: 160 Acres |

1. Outline the acreage dedicated to the subject well by colored pencil or hachure marks on the plat below.
2. If more than one lease is dedicated to the well, outline each and identify the ownership thereof (both as to working interest and royalty).
3. If more than one lease of different ownership is dedicated to the well, have the interests of all owners been consolidated by communitization, unitization, force-pooling, etc?

☐ Yes ☐ No If answer is "yes," type of consolidation _____

If answer is "no," list the owners and tract descriptions which have actually been consolidated. (Use reverse side of this form if necessary.) _____

No allowable will be assigned to the well until all interests have been consolidated (by communitization, unitization, forced-pooling, or otherwise) or until a non-standard unit, eliminating such interests, has been approved by the Commission.

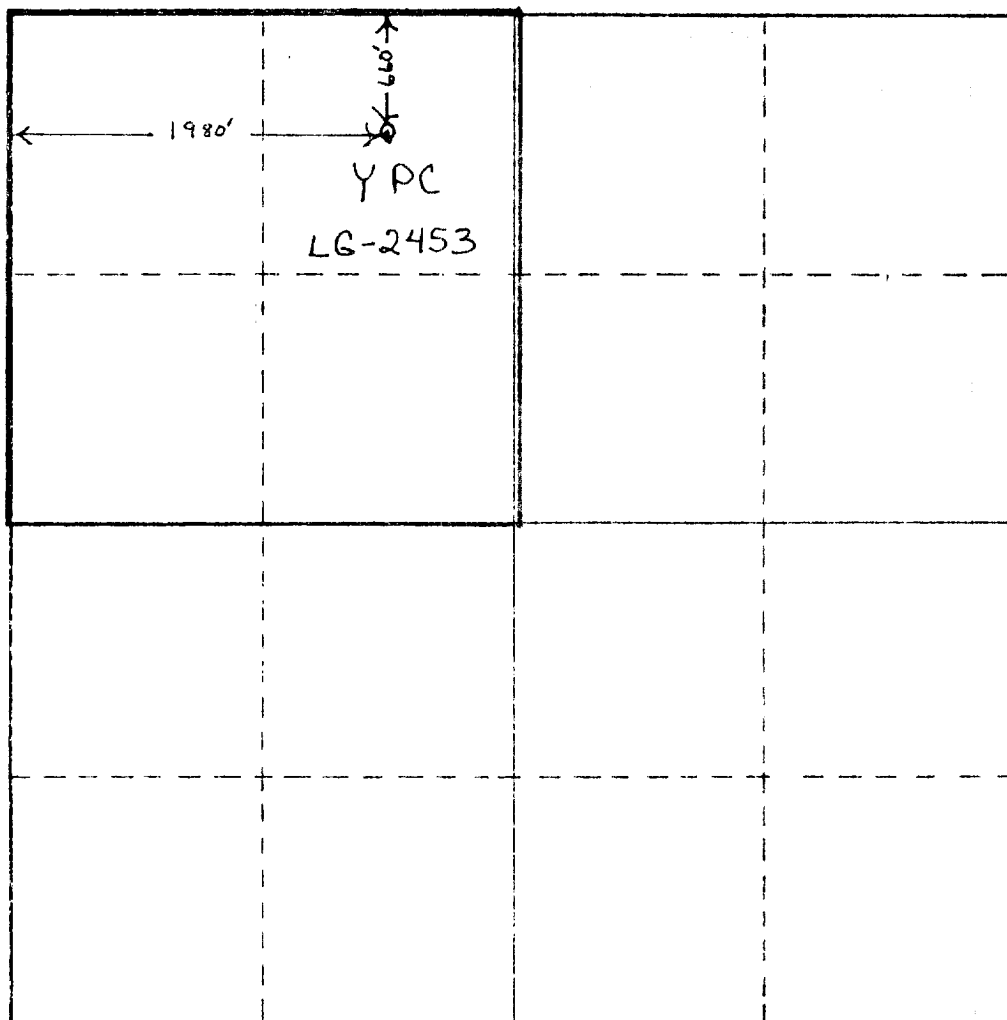

CERTIFICATION

I hereby certify that the information contained herein is true and complete to the best of my knowledge and belief.

Name
Cy Cowan
Position
Regulatory Coordinator
Company
Yates Petroleum Corporation
Date
3/17/82

I hereby certify that the well location shown on this plat was plotted from field notes of actual survey made by me or under my supervision, and that the same is true and correct to the best of my knowledge and belief.

Date Surveyed
March 16, 1982
Registered Professional Engineer
and/or Land Surveyor

Certificate No.

7977

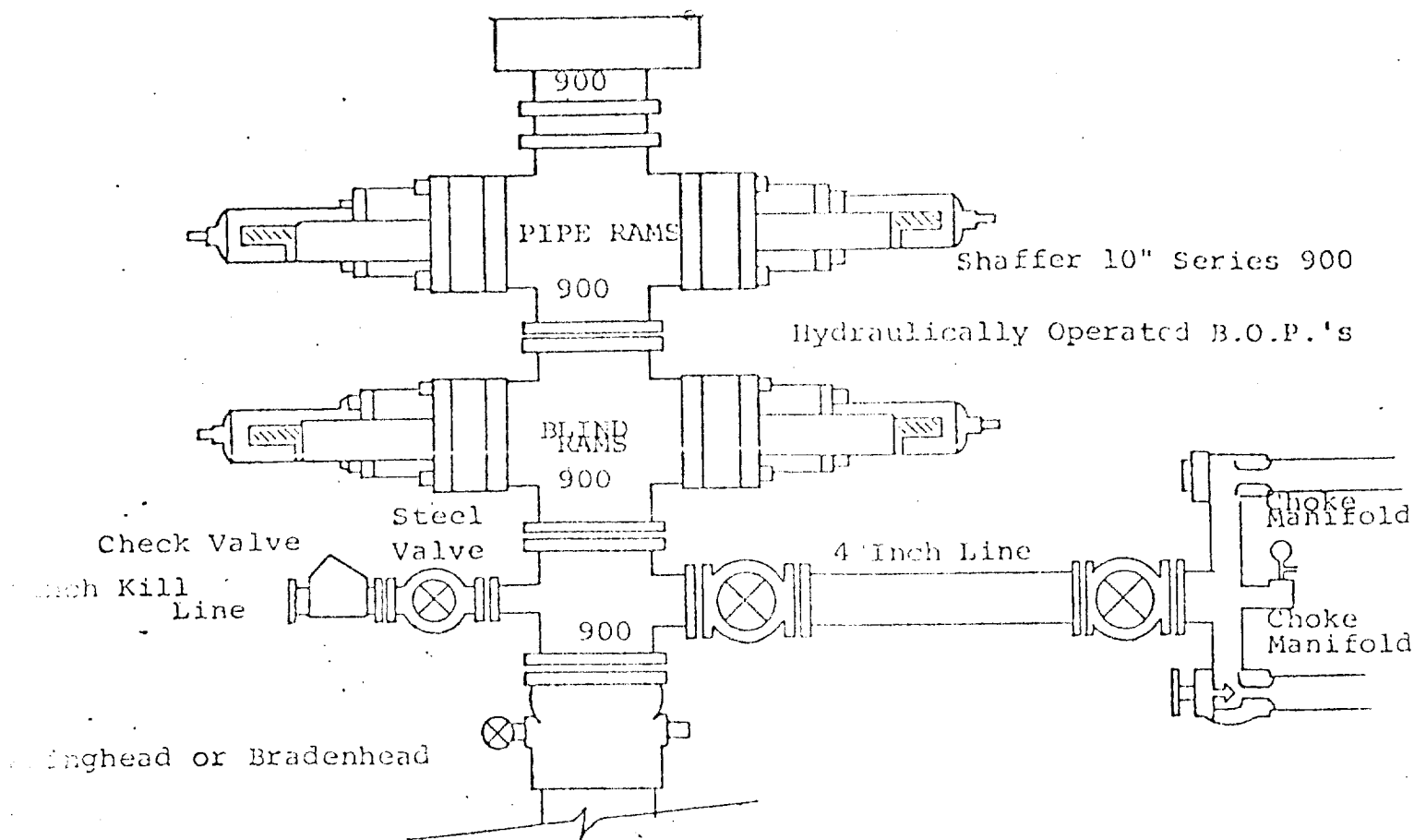

THE FOLLOWING CONSTITUTE MINIMUM BLOWOUT PREVENTER REQUIREMENTS

1. All preventers to be hydraulically operated with secondary manual controls installed prior to drilling out from under casing.
2. Choke outlet to be a minimum of 4" diameter.
3. Kill line to be of all steel construction of 2" minimum diameter.
4. All connections from operating manifolds to preventers to be all steel.
5. Hole or tube a minimum of one inch in diameter.
6. The available closing pressure shall be at least 15% in excess of that required with sufficient volume to operate the B.O.P.'s.
7. All connections to and from preventer to have a pressure rating equivalent to that of the B.O.P.'s.
8. Inside blowout preventer to be available on rig floor.
9. Operating controls located a safe distance from the rig floor.
10. Hole must be kept filled on trips below intermediate casing. Operator not responsible for blowouts resulting from not keeping hole full.
11. B. P. float must be installed and used below zone of first gas intrusion.