

NM OIL & GAS COMMISSION
Drawer DD
Artesia, UNITED STATES
DEPARTMENT OF THE INTERIORSUBMIT IN T ICATE*
(Other instructions on
reverse side)Form approved.
Budget Bureau No. 42-R1425.

GEOLOGICAL SURVEY

APPLICATION FOR PERMIT TO DRILL, DEEPEN, OR PLUG BACK

1a. TYPE OF WORK

DRILL ☒DEEPEN ☐PLUG BACK ☐

b. TYPE OF WELL

OIL
WELL ☐GAS
WELL ☒OTHER ☐SINGLE
ZON ☐MULTIPLE
ZONE ☐

2. NAME OF OPERATOR

STEVENS OPERATING CORPORATION

3. ADDRESS OF OPERATOR

P. O. Box 2203, Roswell, New Mexico 88201

4. LOCATION OF WELL (Report location clearly and in accordance with any State requirements.)*

At surface

660 FNL & 660 FEL, Sec. 13, T8S, R25E

At proposed prod. zone

same as above

14. DISTANCE IN MILES AND DIRECTION FROM NEAREST TOWN OR POST OFFICE*

19.2 airmiles northeast of Roswell, New Mexico

15. DISTANCE FROM PROPOSED*

LOCATION TO NEAREST

PROPERTY OR LEASE LINE, FT.

(Also to nearest drlg. unit line, if any)

660'

16. NO. OF ACRES IN LEASE

680

17. NO. OF ACRES ASSIGNED

TO THIS WELL

160

18. DISTANCE FROM PROPOSED LOCATION*

TO NEAREST WELL, DRILLING, COMPLETED,
OR APPLIED FOR, ON THIS LEASE, FT.

N/A

19. PROPOSED DEPTH

4400'

20. ROTARY OR CABLE TOOLS

Rotary

21. ELEVATIONS (Show whether DF, RT, GR, etc.)

24. PROPOSED CASING AND CEMENTING PROGRAM

SIZE OF HOLE	SIZE OF CASING	WEIGHT PER FOOT	SETTING DEPTH	QUANTITY OF CEMENT
11"	8 5/8"	24.0#	900'	Sufficient to circ
7 7/8"	4 1/2"	9.5#	4400'	300 sacks or 500' above pay

Well will be drilled to a total depth of 4400' and all potential zones will be evaluated. If commercial production is indicated, well will be selectively perforated and stimulated.

Attached are:

1. Well Location and Dedication Plat
2. Supplemental Drilling Data
3. Surface Use Plan.

Gas is not dedicated to a pipeline.

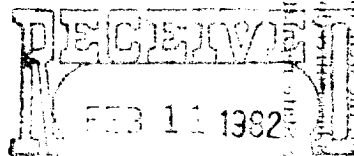
OIL & GAS
U.S. GEOLOGICAL SURVEY
ROSWELL, NEW MEXICO

IN ABOVE SPACE DESCRIBE PROPOSED PROGRAM: If proposal is to deepen or plug back, give data on present productive zone and proposed new productive zone. If proposal is to drill or deepen directionally, give pertinent data on subsurface locations and measured and true vertical depths. Give blowout preventer program, if any.

24.

SIGNED

TITLE

Production Coordinator

DATE 2-10-82

(This space for Federal or State office use)

PERMIT NO.

APPROVED

APPROVAL SUBJECT TO

GENERAL REQUIREMENTS AND

SPECIAL STIPULATIONS

ATTACHED

APPROVED BY

TITLE

CONDITIONS OF APPROVAL, IF ANY

MAR 1 1982

JAMES A. OILLHAM

DISTRICT SUPERVISOR

*See Instructions On Reverse Side

30-005-61445

5. LEASE DESIGNATION AND SERIAL NO.

NM 29417

6. IF INDIAN ALLOTTEE OR TRIBE NAME

N/A

7. UNIT AGREEMENT NAME

N/A

8. EARM OR LEASE NAME

Paul-Hicks Federal

9. WELL NO.

2

10. FIELD AND POOL, OR WILDCAT

Wildcat

11. SEC. T. R. M. OR BLK.

AND SURVEY OR AREA

Sec. 13, T8S, R25E

12. COUNTY OR PARISH

Chaves

13. STATE

NM

NEW MEXICO OIL CONSERVATION COMMISSION
WELL LOCATION AND ACREAGE DEDICATION PLAT

Form O-128
Supersedes O-128
Effective 1-1-85

All distances must be from the outer boundaries of the Section

Operator Stevens Operating Company			Lease Paul Hicks Fed.			Well No. 2		
Unit Letter A	Section 13	Township 8 South	Range 25 East	County Chaves				
Actual Footage Location of Well: 660 feet from the north line and 660 feet from the east line								
Ground Level Elev. 3563.0'	Producing Formation Abo		Pool Wildcat			Dedicated Acreage 160		

1. Outline the acreage dedicated to the subject well by colored pencil or hachure marks on the plat below.
2. If more than one lease is dedicated to the well, outline each and identify the ownership thereof (both as to working interest and royalty).
3. If more than one lease of different ownership is dedicated to the well, have the interests of all owners been consolidated by communitization, unitization, force-pooling, etc?
☐ Yes ☐ No If answer is "yes," type of consolidation _____

If answer is "no," list the owners and tract descriptions which have actually been consolidated. (Use reverse side of this form if necessary.) _____
 No allowable will be assigned to the well until all interests have been consolidated (by communitization, unitization, forced-pooling, or otherwise) or until a non-standard unit, eliminating such interests, has been approved by the Commission.

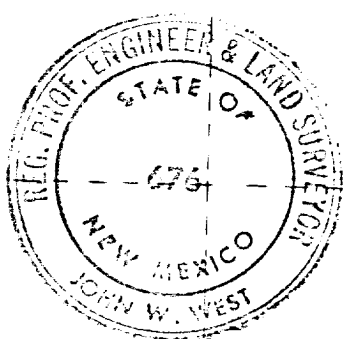
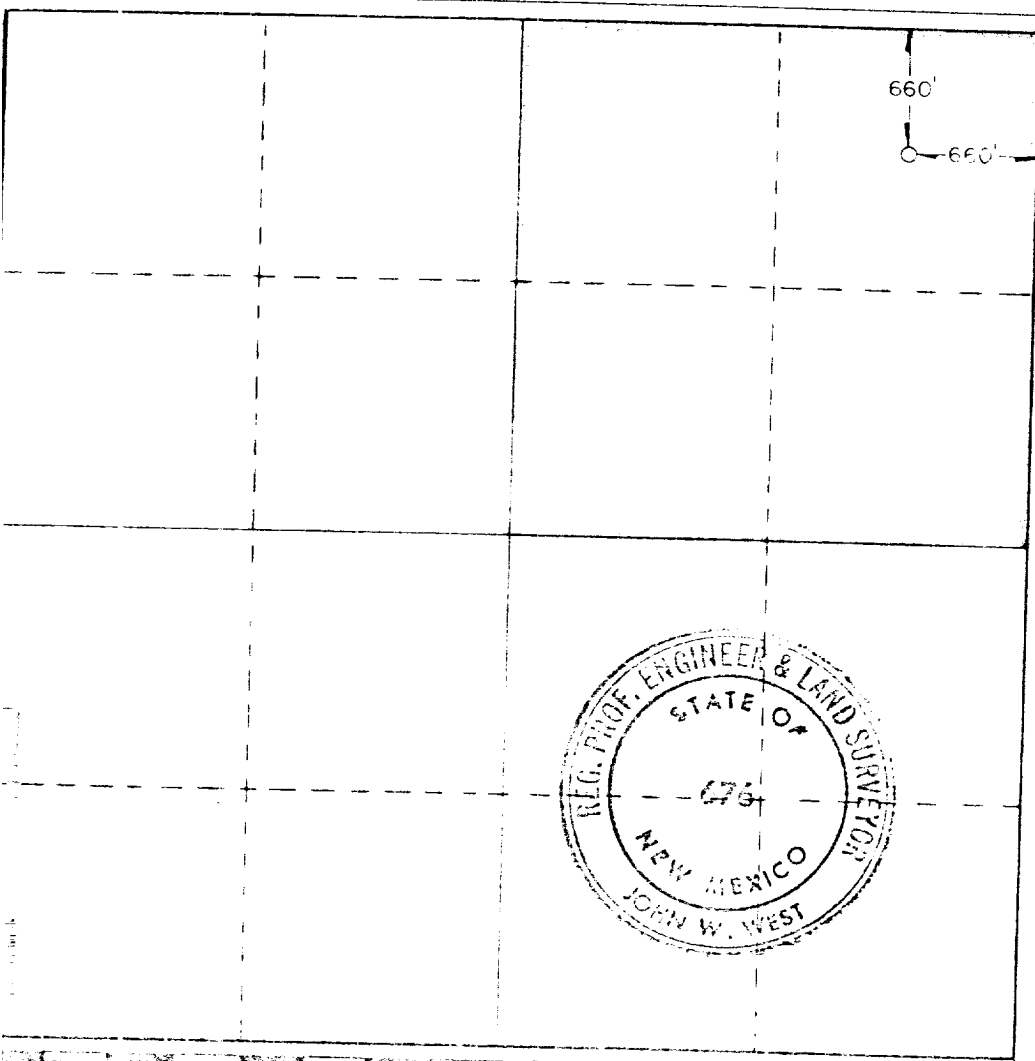

CERTIFICATION	
I hereby certify that the information contained herein is true and complete to the best of my knowledge and belief.	
Signature <i>Pat Thompson</i>	Position Production Coordinator
Company Stevens Operating Corp.	
Date 2-10-82	
I hereby certify that the well location shown on this plat was plotted from field notes of actual surveys made by me or under my supervision, and that the same is true and correct to the best of my knowledge and belief.	
Date Surveyed 1-8-82	
Registered Professional Engineer and Land Surveyor <i>John W. West</i>	
JOHN W. WEST 676 REGISTERED PROFESSIONAL ENGINEER & LAND SURVEYOR	

SUPPLEMENTAL DRILLING DATA

STEVENS OPERATING CORPORATION
WELL #2 PAUL HICKS FEDERAL
660' FEL & 660' FNL, SEC. 13, T-8-S, R-25-E
CHAVES COUNTY, NEW MEXICO

1. SURFACE FORMATION: Alluvium.

2. ESTIMATED TOPS OF GEOLOGIC MARKERS:

Queen	150'	Glorietta	1800'
San Andres	600'	ABO	3850'

3. ANTICIPATED POROSITY ZONES:

Water	40'
Oil	1100'
Gas	3950'

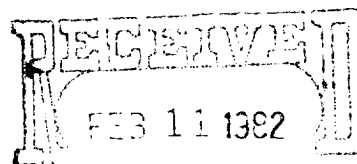

4. CASING DESIGN:

<u>Size</u>	<u>Interval</u>	<u>Weight</u>	<u>Grade</u>	<u>Joint</u>	<u>Condition</u>
8 5/8"	0- 900'	24.0#	K55	STC	New
4 1/2"	0-4400'	9.5#	K55	STC	New

5. SURFACE CONTROL EQUIPMENT: A double ram-type preventer (900 series). A sketch of BOP stack is attached.

6. CIRCULATING MEDIUM:

0-900'	Freshwater mud with gel added if needed for viscosity.
900'-TD	Saltwater mud, conditioned as necessary for control of viscosity and water loss.

7. AUXILIARY EQUIPMENT: Drill string safety valve.

8. TESTING, LOGGING AND CORING PROGRAMS:

DST's:	As warranted.
Coring:	None Planned.
Logging:	A compensated Neutron/Formation Density Log w/Gamma Ray and a Dual Laterolog/Micro-Spherically Focused Log.

9. ABNORMAL PRESSURES, TEMPERATURES OR GASES: None anticipated.

10. ANTICIPATED DATES: It is planned that drilling operations will commence about February 25, 1982. Duration of drilling and completion operations should be 20 to 60 days.

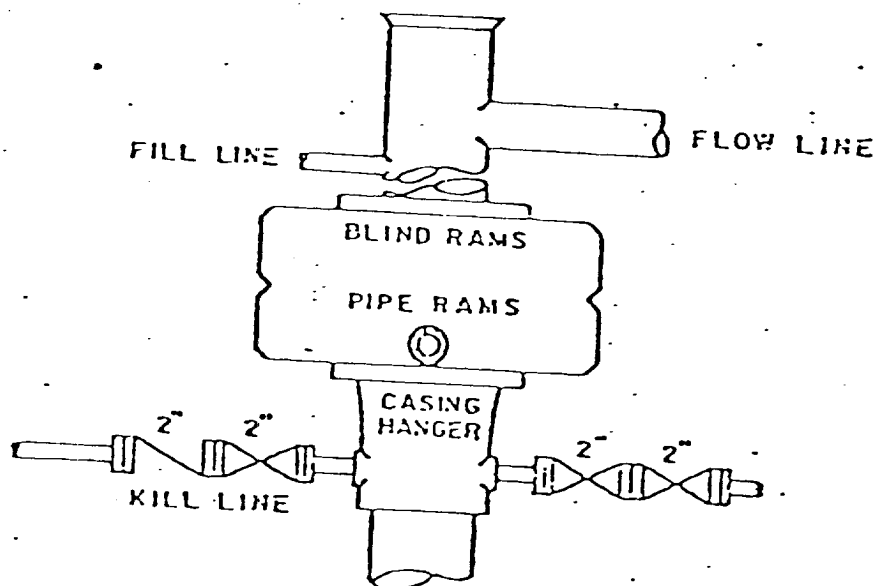

DUAL RAM-TYPE PREVENTER

900 Series

BLOWOUT PREVENTER SKETCH
 STEVENS OPERATING CORPORATION
 WELL # 2 PAUL HICKS FEDERAL
 660' FNL & 660' FEL, SEC. 13, T-8-S, R-25-E
 CHAVES COUNTY, NEW MEXICO

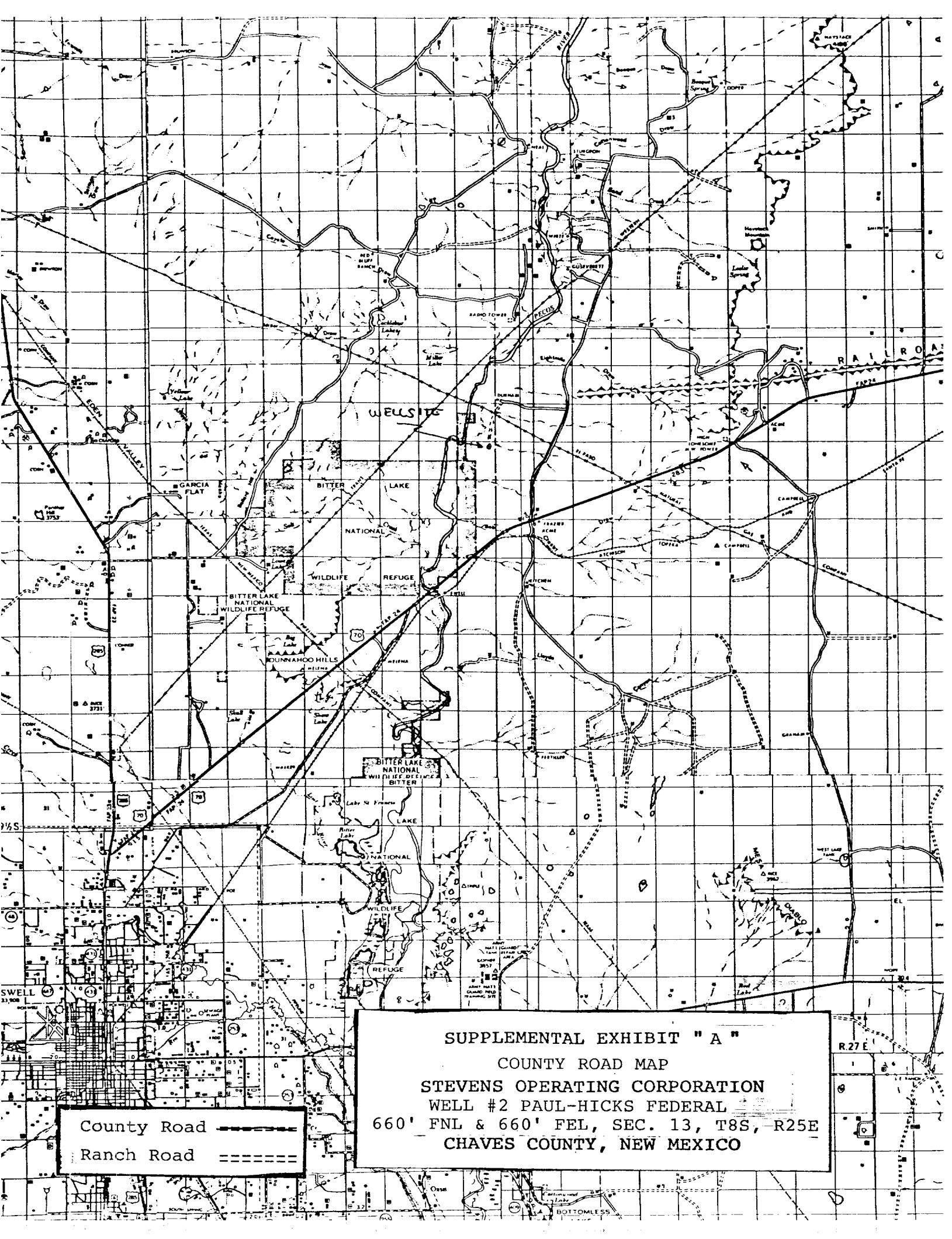

SUPPLEMENTAL EXHIBIT "A"

COUNTY ROAD MAP

STEVENS OPERATING CORPORATION

WELL #2 PAUL-HICKS FEDERAL



660' FNL & 660' FEL, SEC. 13, T8S, R25E

CHAVES COUNTY, NEW MEXICO

County Road

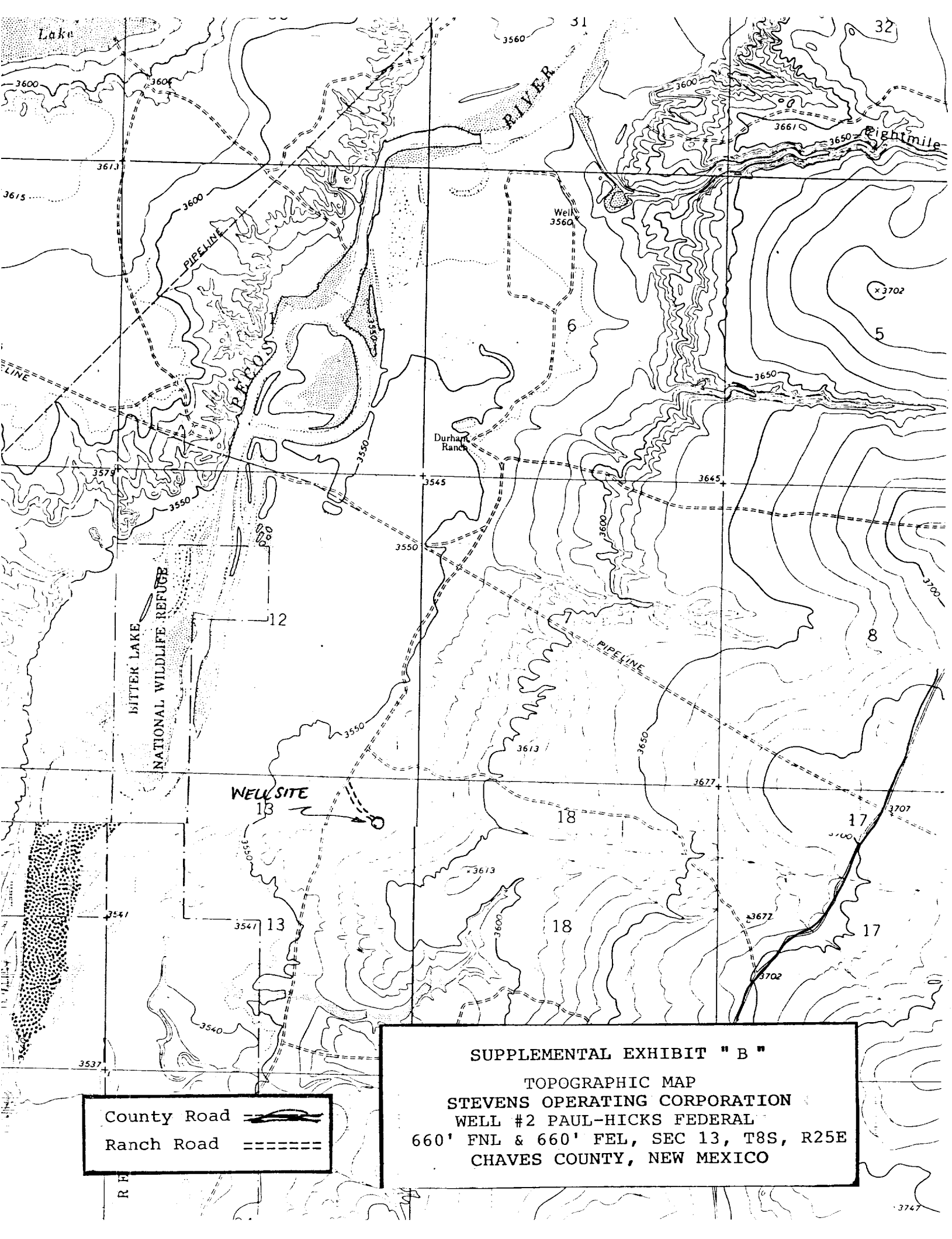
Ranch Road



County Road 
Ranch Road 

SUPPLEMENTAL EXHIBIT " B "

TOPOGRAPHIC MAP
STEVENS OPERATING CORPORATION
WELL #2 PAUL-HICKS FEDERAL
660' FNL & 660' FEL, SEC 13, T8S, R25E
CHAVES COUNTY, NEW MEXICO

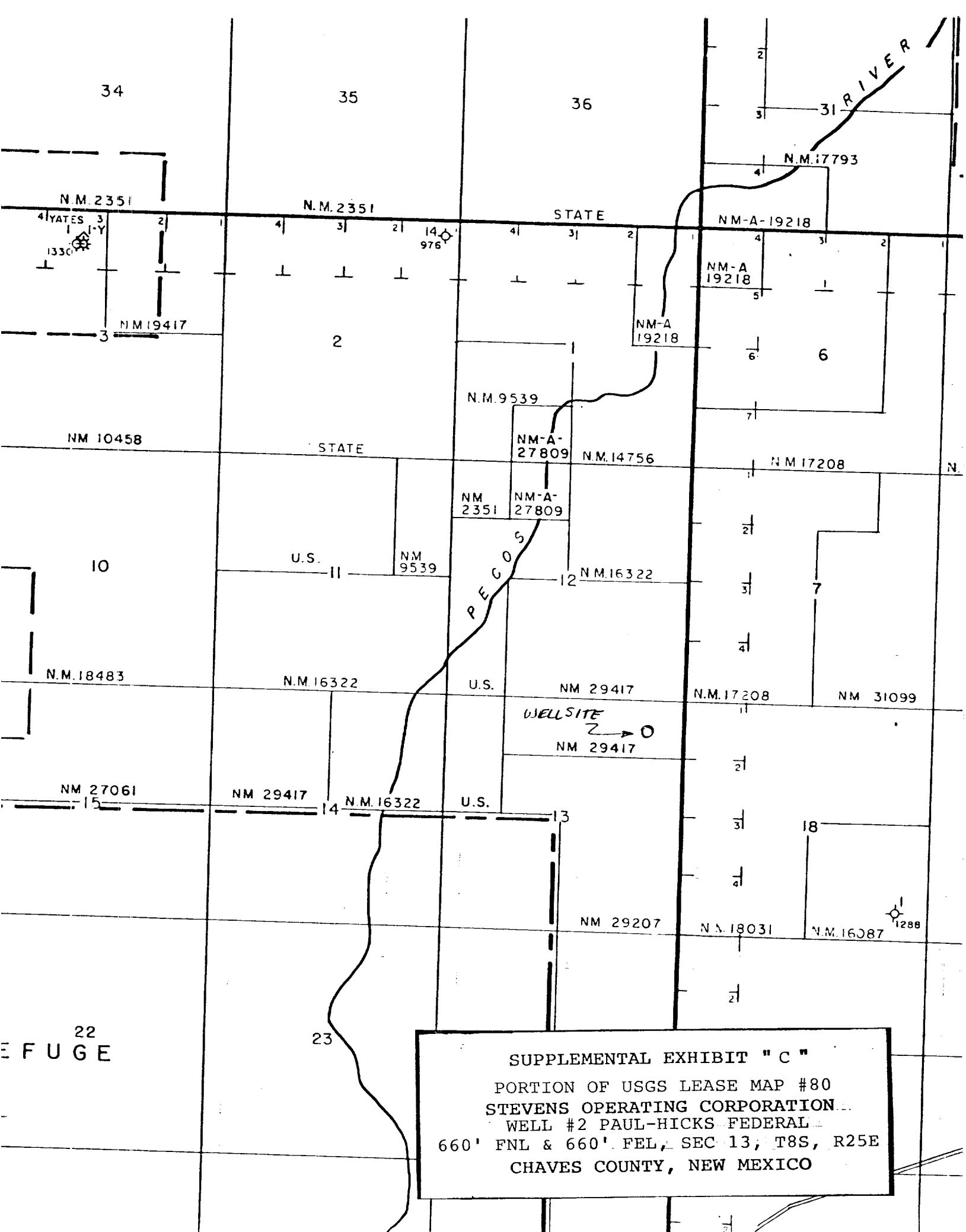

SUPPLEMENTAL EXHIBIT " C "

PORTION OF USGS LEASE MAP #80

STEVENS OPERATING CORPORATION

WELL #2 PAUL-HICKS FEDERAL

660' FNL & 660' FEL, SEC 13, T8S, R25E

CHAVES COUNTY, NEW MEXICO