

NO. OF COPIES RECEIVED	
DISTRIBUTION	
SANTA FE	1
FILE	1
U.S.G.S.	2
LAND OFFICE	1
OPERATOR	1

NEW MEXICO OIL CONSERVATION COMMISSION

RECEIVED

30-005-61493  
Form C-101  
Revised 1-1-65

MAR 22 1982

O. C. D.

ARTESIA, OFFICE

5A. Indicate Type of Lease  
STATE ☒ FEE ☐

5. State Oil &amp; Gas Lease No.

LG-0001

## APPLICATION FOR PERMIT TO DRILL, DEEPEN, OR PLUG BACK

1a. Type of Work DRILL <input checked="" type="checkbox"/> DEEPEN <input type="checkbox"/> PLUG BACK <input type="checkbox"/>		7. Unit Agreement Name
b. Type of Well OIL WELL <input type="checkbox"/> GAS WELL <input checked="" type="checkbox"/> OTHER <input type="checkbox"/> SINGLE ZONE <input type="checkbox"/> MULTIPLE ZONE <input type="checkbox"/>		8. Farm or Lease Name Hanlad State
2. Name of Operator Rault Petroleum Corporation		9. Well No. 1
3. Address of Operator 103 N. Pennsylvania Ave., Roswell, New Mexico 88201		10. Field and Pool, or Wildcat Wildcat-Abo
4. Location of Well UNIT LETTER M LOCATED 660 FEET FROM THE South LINE AND 660 FEET FROM THE West LINE OF SEC. 13 TWP. 8 South RGE 27 East NMPM		12. County Chaves
19. Proposed Depth 5500		19A. Formation ABO
20. Rotary or C.T. Rotary		21. Elevations (Show whether DE, RT, etc.) 3936 GR
21A. Kind & Status Plug. Bond Blanket		21B. Drilling Contractor Rault Drilling Company
22. Approx. Date Work will start 3/31/82		

## 23. PROPOSED CASING AND CEMENT PROGRAM

SIZE OF HOLE	SIZE OF CASING	WEIGHT PER FOOT	SETTING DEPTH	SACKS OF CEMENT	EST. TOP
12"	8 5/8	24	1400	1000	Circ.
7 7/8"	4 1/2	10.5	5500	400	4400

It may be necessary to commence initial drilling operations with cable tools while waiting on Rault Drilling Co. Rig No.1. In such event we plan to drill a 17 1/2" hole to approximately 40' and cement 16" conductor pipe, cementing same to surface.

Blowout Preventer Diagram is attached.

Acreage is undisgnated at this time.

APPROVAL VALID FOR 180 DAYS  
PERMIT EXPIRES 9-23-82  
UNLESS DRILLING UNDERWAY

Posted ID-1  
APE + AL Book  
3-26-82

IN ABOVE SPACE DESCRIBE PROPOSED PROGRAM: IF PROPOSAL IS TO DEEPEN OR PLUG BACK, GIVE DATA ON PRESENT PRODUCTIVE ZONE AND PROPOSED NEW PRODUCTIVE ZONE. GIVE BLOWOUT PREVENTER PROGRAM, IF ANY.

I hereby certify the information above is true and complete to the best of my knowledge and belief.

Signed Carl Shyr Title Agent Date March 19, 1982

(This space for State Use)

APPROVED BY Mike Walker TITLE OIL AND GAS INSPECTOR DATE MAR 23 1982

CONDITIONS OF APPROVAL, IF ANY:

All distances must be from the outer boundaries of the Section.

Operator <b>Rault Petroleum Corp.</b>			Lease <b>Hanlad State</b>		Well No. <b>#1</b>
Unit Letter <b>M</b>	Section <b>13</b>	Township <b>8 South</b>	Range <b>27 East</b>	County <b>Chaves</b>	
Actual Footage Location of Well: <b>660</b> feet from the <b>South</b> line and <b>660</b> feet from the <b>West</b> line					
Ground Level Elev. <b>3936</b>	Producing Formation <b>Abo</b>		Pool <b>Wildcat</b>		Dedicated Acreage: <b>160.00</b> Acres

1. Outline the acreage dedicated to the subject well by colored pencil or hatchure marks on the plat below.
2. If more than one lease is dedicated to the well, outline each and identify the ownership thereof (both as to working interest and royalty).
3. If more than one lease of different ownership is dedicated to the well, have the interests of all owners been consolidated by communitization, unitization, force-pooling, etc?

☐ Yes ☐ No If answer is "yes," type of consolidation \_\_\_\_\_

If answer is "no," list the owners and tract descriptions which have actually been consolidated. (Use reverse side of this form if necessary.) \_\_\_\_\_

No allowable will be assigned to the well until all interests have been consolidated (by communitization, unitization, forced-pooling, or otherwise) or until a non-standard unit, eliminating such interests, has been approved by the Division.

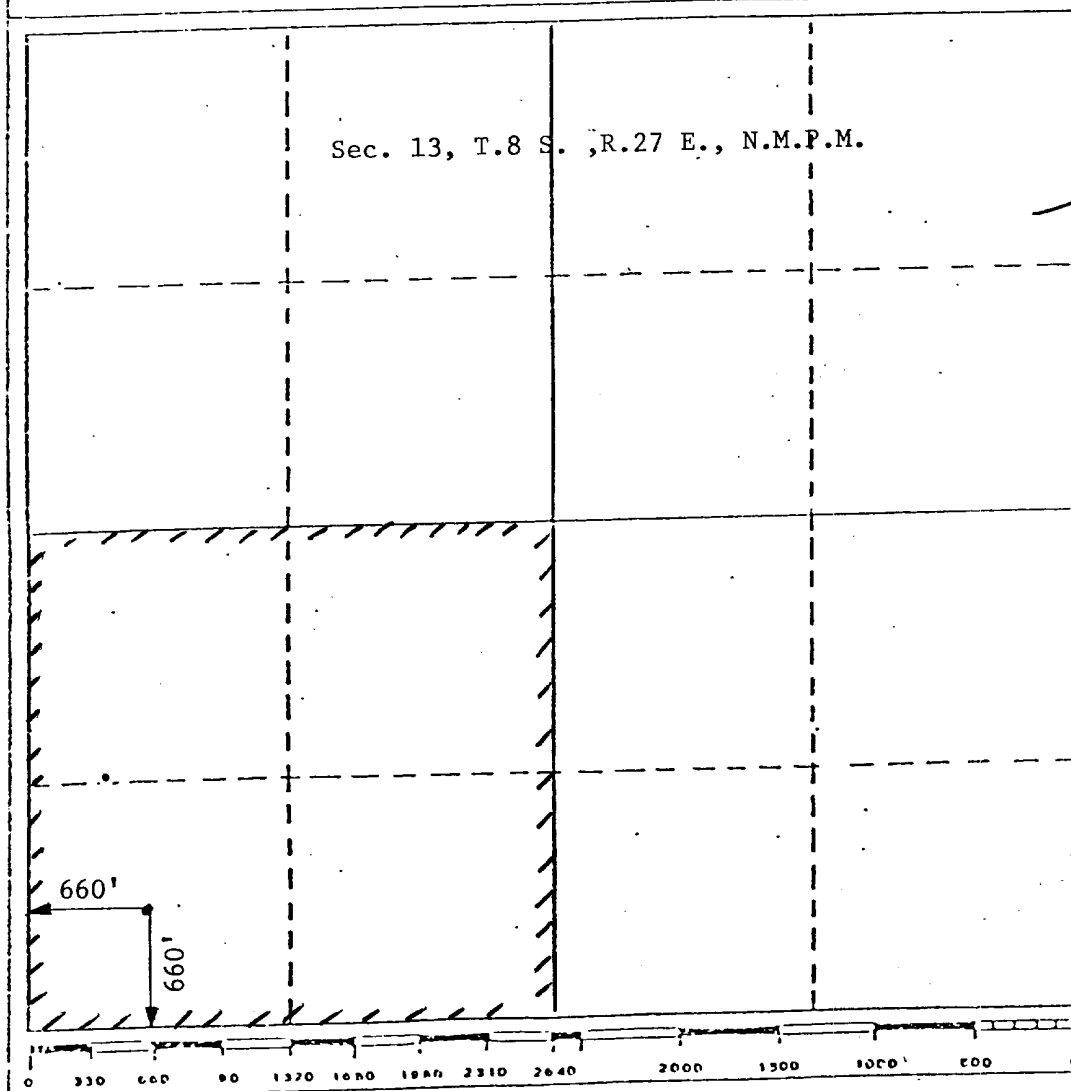

CERTIFICATION

I hereby certify that the information contained herein is true and complete to the best of my knowledge and belief.

Name  
**Carl A. Schellinger**

Position  
**Agent**

Company  
**Rault Petroleum Corporation**

Date  
**March 19, 1982**

I hereby certify that the well location shown on this plat was plotted from field notes of actual surveys made by me or under my supervision, and that the same is true and correct to the best of my knowledge and belief.

Date Surveyed  
**March 19, 1982**

Registered Professional Engineer  
and/or Land Surveyor  
**JOHN D. JACQUES, P.E. & L.S.**

Certification No.  
**6290**

RAULT DRILLING COMPANY - Rig 1

BLOWOUT PREVENTER DIAGRAM

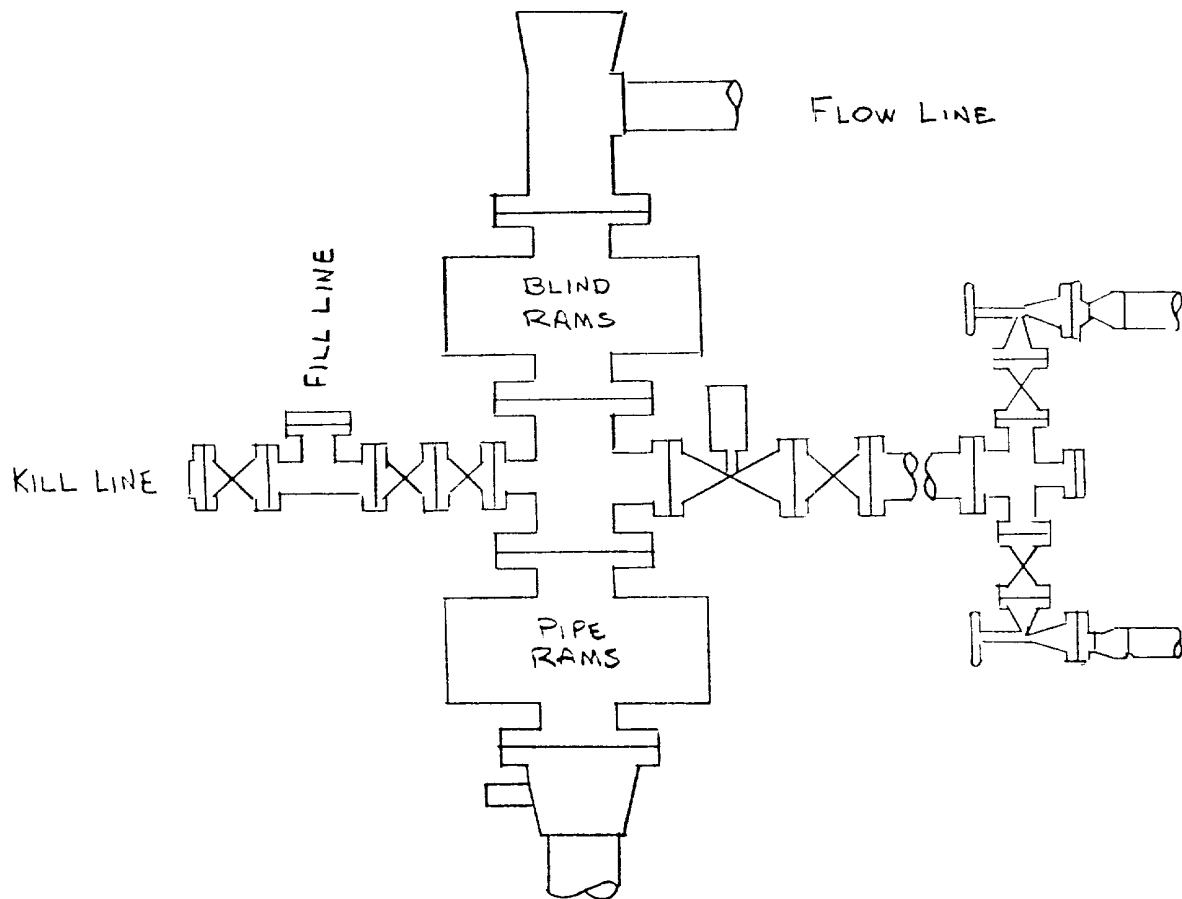

BOP is 10" Series 900 Type "E" Cameron  
Double Hydraulic 6000psi test, 3000psi  
working pressure.

CARL A. SCHELLINGER

BUS. (505) 623-2328

RES. (505) 623-2329

*Oil Properties-Licensed Broker*

March 19, 1982

RECEIVED

MAR 22 1982

O. C. D.  
ARTESIA, OFFICE

Mr. W. A. Gressett  
New Mexico Oil Conservation Division  
P. O. Drawer DD  
Artesia, New Mexico 88210

Re: Rault Petroleum Corp.  
Hanlad State No. 1  
Chaves County, NM

Dear Mr. Gressett:

We are enclosing six (6) copies of the C-101  
covering the Rault Petroleum Corporation No. 1 Hanlad  
State for your approval.

In the event you need something further from  
us, please advise.

Very truly yours,

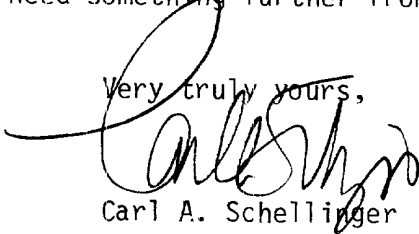
  
Carl A. Schellinger

CAS/s  
Encl.

**★ SLIPPER:** Complete items 1, 2, and 3.  
Add your address in the "RETURN TO" space or reverse.

1. The following service is requested (check one) \_\_\_\_\_  
☒ Show to whom and date delivered.....  
☐ Show to whom, date and address of delivery.....  
☐ RESTRICTED DELIVERY  
☐ Show to whom and date delivered.....  
☐ RESTRICTED DELIVERY  
☐ Show to whom, date, and address of delivery \$\_\_\_\_

(CONSULT POSTMASTER FOR FEES)  
 LG-0001

2. ARTICLE ADDRESSED TO: of Public Lands  
 Commissioner of New Mexico  
 State of New Mexico 87501  
 P.O. Box 1148  
 Santa Fe, New Mexico

3. ARTICLE DESCRIPTION: Registered No. 036133	CERTIFIED NO.	INSURED NO.
--	---------------	-------------

(Always obtain signature of addressee or agent.)  
 I have received the article described above.  
 SIGNATURE [Signature] Addressee Authorized agent

4. DATE OF DELIVERY MAR 17 1982

5. ADDRESS (Complete only if requested)

6. UNABLE TO DELIVER BECAUSE:

POSTMARK'S INITIALS

☆ GPO : 1979-300-755