

NO. OF COPIES RECEIVED	5
DISTRIBUTION	
SANTA FE	1
FILE	1
U.S.G.S.	2
LAND OFFICE	
OPERATOR	1

MAR 29 1982

RECEIVED

5A. Indicate Type of Lease
STATE <input type="checkbox"/> REC <input checked="" type="checkbox"/>

5. State Oil & Gas Lease No.

APPLICATION FOR PERMIT TO DRILL, DEEPEN, OR PLUG BACK

a. Type of Work

ARTESIA, OFFICE

b. Type of Well

DRILL ☒DEEPEN ☐PLUG BACK ☐OIL WELL ☐GAS WELL ☒

OTHER

SINGLE ZONE ☐MULTIPLE ZONE ☐

c. Name of Operator

Yates Petroleum Corporation ✓

d. Address of Operator

207 S. 4th, Artesia, New Mexico 88210

e. Location of Well

UNIT LETTER N

LOCATED 1980

FEET FROM THE West

LINE

f. NO 660'

FEET FROM THE South

LINE OF SEC. 9

TWP. 5S

RGE. 25E

NMPM

17. County

Chaves

18. Unit Agreement Name

19. Field and Pool, or Wildcat

Undes. Pecos Slope Abo

20. Rotary or C.T.

Rotary

1. Elevations (show whether DE, RT, etc.)

3813.3 GL

21A. Kind & Status Plug. Bond

Blanket

21B. Drilling Contractor

LaRue

22. Approx. Date Work will start

ASAP

PROPOSED CASING AND CEMENT PROGRAM

SIZE OF HOLE	SIZE OF CASING	WEIGHT PER FOOT	SETTING DEPTH	SACKS OF CEMENT	EST. TOP
14 3/4"	10 3/4"	40.5# J-55	950'	850 sx	circulated
7 7/8"	4 1/2"	9.5#	TD	350 sx	

We propose to drill and test the Abo and intermediate formations. Approximately 950' of surface casing will be set and cement circulated to shut off gravel and caving. If needed (lost circulation) 8 5/8" intermediate casing will be run to 1500' and cemented with enough cement calculated to tie back into the surface casing. If commercial, production casing will be run and cemented with adequate cover, perforated and stimulated as needed for production.

MUD PROGRAM: FW gel and LCM to 950', Brine to 3500', Drispak & starch to TD.

BOP PROGRAM: BOP's will be installed at the offset and tested daily.

GAS NOT DEDICATED.

APPROVAL VALID FOR 180 DAYS
PERMIT EXPIRES 9-30-82
UNLESS DRILLING UNDERWAY

ABOVE SPACE DESCRIBE PROPOSED PROGRAM: IF PROPOSAL IS TO DEEPEN OR PLUG BACK, GIVE DATA ON PRESENT PRODUCTIVE ZONE AND PROPOSED NEW PRODUCTION ZONE. GIVE BLOWOUT PREVENTER PROGRAM, IF ANY.

I hereby certify that the information above is true and complete to the best of my knowledge and belief.

By [Signature] Title Regulatory Coordinator Date 3/29/82

(This space for State Use)

PROVED BY [Signature] TITLE OIL AND GAS INSPECTOR DATE MAR 30 1982

CONDITIONS OF APPROVAL, IF ANY:

NEW MEXICO OIL CONSERVATION COMM. ON
WELL LOCATION AND ACREAGE DEDICATION PLATMAR 29 1982 Form C-102
Supersedes C-128
Effective 1-1-65

All distances must be from the outer boundaries of the Section.

O. C. D.

Operator YATES PETROLEUM CORPORATION			Lease BLYTHE "SV"			ARTESIA, OFFICE		
Unit Letter H	Section 9	Township 5 South	Range 25 East	County Chaves				
Actual Footage Location of Well:								
1980 feet from the West line and		660 feet from the South line						
Ground Level Elev. 3813.3	Producing Formation Abo		Pool Undes. Pecos Slope Abo			Dedicated Acreage: 160 Acres		

1. Outline the acreage dedicated to the subject well by colored pencil or hachure marks on the plat below.
2. If more than one lease is dedicated to the well, outline each and identify the ownership thereof (both as to working interest and royalty).
3. If more than one lease of different ownership is dedicated to the well, have the interests of all owners been consolidated by communitization, unitization, force-pooling, etc?

☐ Yes ☐ No If answer is "yes," type of consolidation _____

If answer is "no," list the owners and tract descriptions which have actually been consolidated. (Use reverse side of this form if necessary.) _____

No allowable will be assigned to the well until all interests have been consolidated (by communitization, unitization, forced-pooling, or otherwise) or until a non-standard unit, eliminating such interests, has been approved by the Commission.

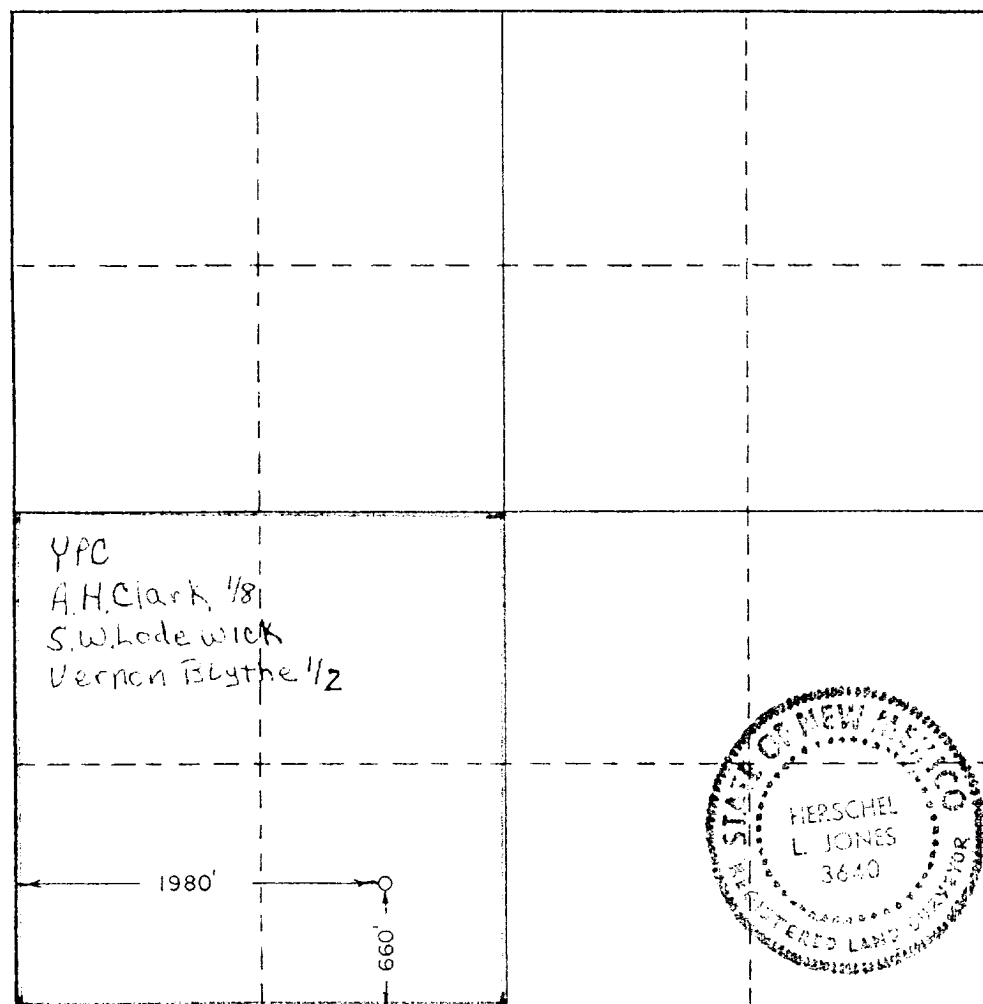

CERTIFICATION

I hereby certify that the information contained herein is true and complete to the best of my knowledge and belief.

Name
Cy Cowan
Position
Regulatory Coordinator
Company
Yates Petroleum Corporation
Date
3/29/82

I hereby certify that the well location shown on this plat was plotted from field notes of actual surveys made by me or under my supervision, and that the same is true and correct to the best of my knowledge and belief.

Date Surveyed
3/20/82

Registered Professional Engineer
and/or Land Surveyor

Certificate No.

3640

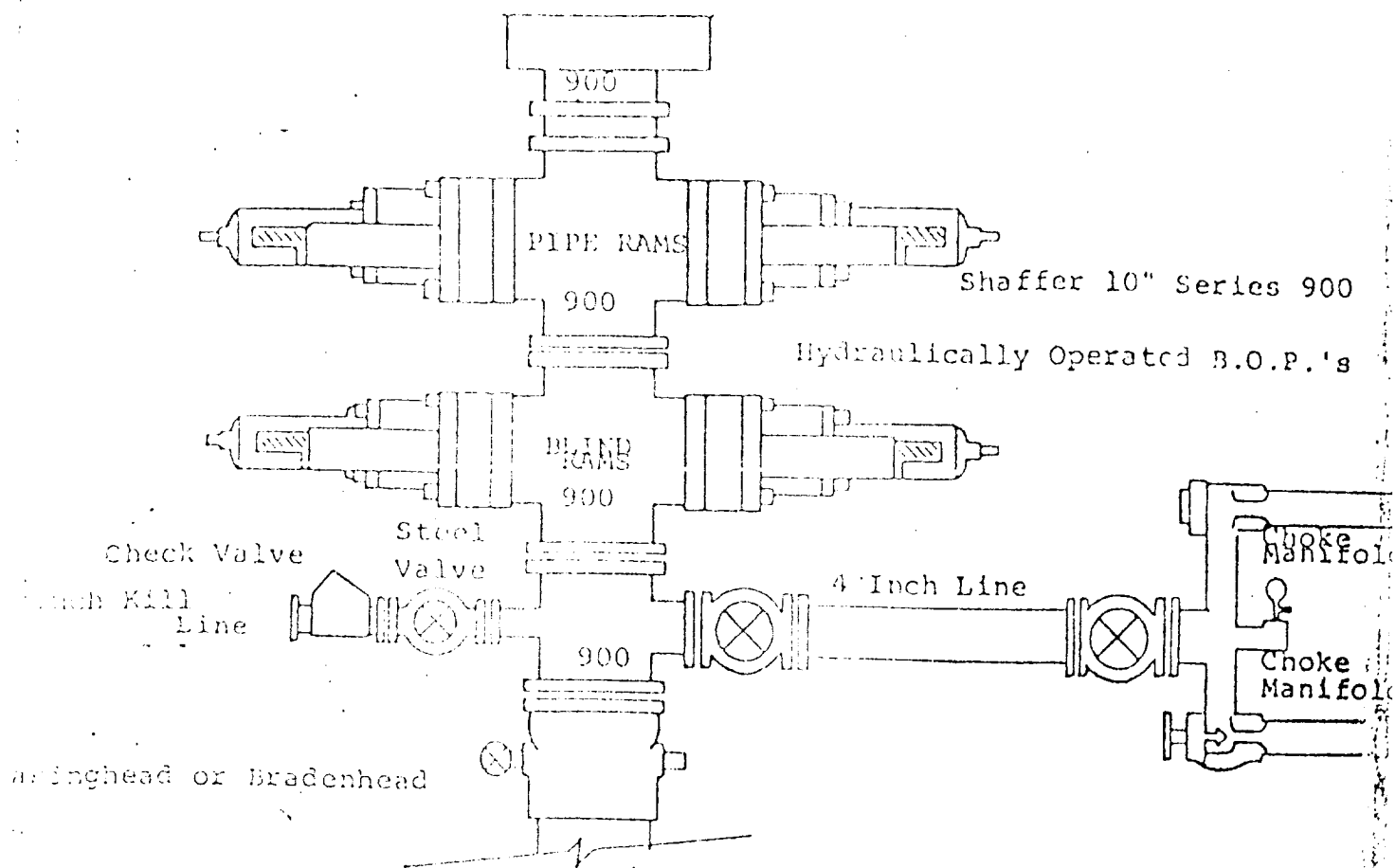

THE FOLLOWING CONSTITUTE MINIMUM BLOWOUT PREVENTER REQUIREMENTS

- . All preventers to be hydraulically operated with secondary manual control installed prior to drilling out from under casing.
- . Choke outlet to be a minimum of 4" diameter.
- . All line to be of all steel construction of 2" minimum diameter.
- . All connections from operating manifolds to preventers to be all steel.
- . Hole or tube a minimum of one inch in diameter.
- . The available closing pressure shall be at least 15% in excess of that required with sufficient volume to operate the B.O.P.'s.
- . All connections to and from preventer to have a pressure rating equivalent to that of the B.O.P.'s.
- . Inside blowout preventer to be available on rig floor.
- . Operating controls located a safe distance from the rig floor.
- . Hole must be kept filled on trips below intermediate casing. Operator not responsible for blowouts resulting from not keeping hole full.
- . B. O. P. float must be installed and used below zone of first gas intrusion.