

ARTESIA, NEW MEXICO  
DEPARTMENT OF THE INTERIOR  
GEOLOGICAL SURVEY

(Other instruction on  
reverse side)

5. LEASE DESIGNATION AND SERIAL NUMBER  
USA-NM-11795 RECEIVED

6. IF INDIAN, ALLOTTEE OR TRIBE NAME  
N/A APR 5 1982

7. UNIT AGREEMENT NAME  
N/A O. C. D.

8. FARM OR LEASE NAME  
Hobbs Canyon Federal ARTESIA OFFICE

9. WELL NO.

4

10. FIELD AND POOL, OR WILDCAT  
Pecos Slope Abo Gas

11. SEC., T., R., M., OR BLK.  
AND SURVEY OR AREA

Sec. 12, T 6 S - R 24 E

12. COUNTY OR PARISH 13. STATE  
Chaves NM

APPLICATION FOR PERMIT TO DRILL, DEEPEN, OR PLUG BACK

1a. TYPE OF WORK  
DRILL ☒ DEEPEN ☐ PLUG BACK ☐

b. TYPE OF WELL  
OIL WELL ☐ GAS WELL ☒ OTHER ☐ SINGLE ZONE ☐ MULTIPLE ZONE ☐

2. NAME OF OPERATOR  
Jack Grynberg and Associates

3. ADDRESS OF OPERATOR  
1050 17th Street, Suite 1950, Denver, Colorado 80265

4. LOCATION OF WELL (Report location clearly and in accordance with any State requirements.)\*  
At surface

660' FNL and 660' FEL of Sec. 12, T 6 S - R 24 E

At proposed prod. zone  
660' FNL and 660' FEL of Sec. 12, T 6 S - R 24 E

14. DISTANCE IN MILES AND DIRECTION FROM NEAREST TOWN OR POST OFFICE\*  
25 Miles NNE of Roswell, New Mexico

15. DISTANCE FROM PROPOSED\*  
LOCATION TO NEAREST  
PROPERTY OR LEASE LINE, FT. 660'  
(Also to nearest drlg. unit line, if any)

16. NO. OF ACRES IN LEASE  
2,360.00

17. NO. OF ACRES ASSIGNED  
TO THIS WELL 160

18. DISTANCE FROM PROPOSED LOCATION\*  
TO NEAREST WELL, DRILLING, COMPLETED,  
OR APPLIED FOR, ON THIS LEASE, FT. 2640'

19. PROPOSED DEPTH  
4200'

20. ROTARY OR CABLE TOOLS  
Rotary

21. ELEVATIONS (Show whether DF, RT, GR, etc.)  
4118.0

22. APPROX. DATE WORK WILL START\*  
April 5, 1982

23. PROPOSED CASING AND CEMENTING PROGRAM

SIZE OF HOLE	SIZE OF CASING	WEIGHT PER FOOT	SETTING DEPTH	QUANTITY OF CEMENT
13-1/2"	10-3/4"	32.75	900'	good returns to surface, circulated
7-7/8"	4-1/2"	10.75	4200'	500' above top of pay

1. Spud well, drill 13-1/2" hole to 900', run 10-3/4' surface casing.
2. Drill 7-7/8" hole to 4,200', checking B.O.P. daily.
3. Run tests and logs as needed.
4. Run 4-1/2" production casing to 4,200' if warranted.
5. Perforate and stimulate as needed.

In the event that circulation is lost while drilling 7-7/8" hole and intermediate casing is needed, the hole will be reamed and 1,500' of 7-7/8" intermediate casing will be set.

B.O.P. Diagram Attached - Exhibit "A"

Gas is not dedicated

IN ABOVE SPACE DESCRIBE PROPOSED PROGRAM: If proposal is to deepen or plug back, give data on present productive zone and proposed new productive zone. If proposal is to drill or deepen directionally, give pertinent data on subsurface locations and measured and true vertical depths. Give blowout preventer program, if any.

24. SIGNED \_\_\_\_\_ TITLE LAND MANAGER DATE 3/29/82  
(This space for Federal or State office use)

PERMIT NO. APPROVED APPROVAL DATE

(Orig. S.A.) GEORGE H. STEWART

APPROVED BY \_\_\_\_\_ TITLE \_\_\_\_\_ DATE \_\_\_\_\_

CONDITIONS OF APPROVAL, IF ANY:

APR 2 1982  
FOR  
JAMES A. GILLHAM  
DISTRICT SUPERVISOR

\*See Instructions On Reverse Side

Posted ID-1  
API + NL Book  
4-9-82

All distances must be from the outer boundaries of the section.

Operator <b>Jack Grynberg &amp; Associates</b>			Lease <b>Hobbs Canyon Federal</b>		Well No. <b>4</b>
Unit Letter <b>A</b>	Section <b>12</b>	Township <b>6-S</b>	Range <b>24-E</b>	County <b>Chaves</b>	
Actual Footage Location of Well: <b>660</b> feet from the <b>NORTH</b> line and <b>660</b> feet from the <b>EAST</b> line					
Ground Level Elev. <b>4118.0</b>	Producing Formation <b>ABO</b>	Pool <del>Pool</del> <b>Undesignated ABO</b>		Dedicated Acreage: <b>160</b> Acres	

1. Outline the acreage dedicated to the subject well by colored pencil or hatchure marks on the plat below.
2. If more than one lease is dedicated to the well, outline each and identify the ownership thereof (both as to working interest and royalty).
3. If more than one lease of different ownership is dedicated to the well, have the interests of all owners been consolidated by communitization, unitization, force-pooling, etc?

☐ Yes ☐ No If answer is "yes," type of consolidation \_\_\_\_\_

If answer is "no," list the owners and tract descriptions which have actually been consolidated. (Use reverse side of this form if necessary.) \_\_\_\_\_

No allowable will be assigned to the well until all interests have been consolidated (by communitization, unitization, forced-pooling, or otherwise) or until a non-standard unit, eliminating such interests, has been approved by the Division.

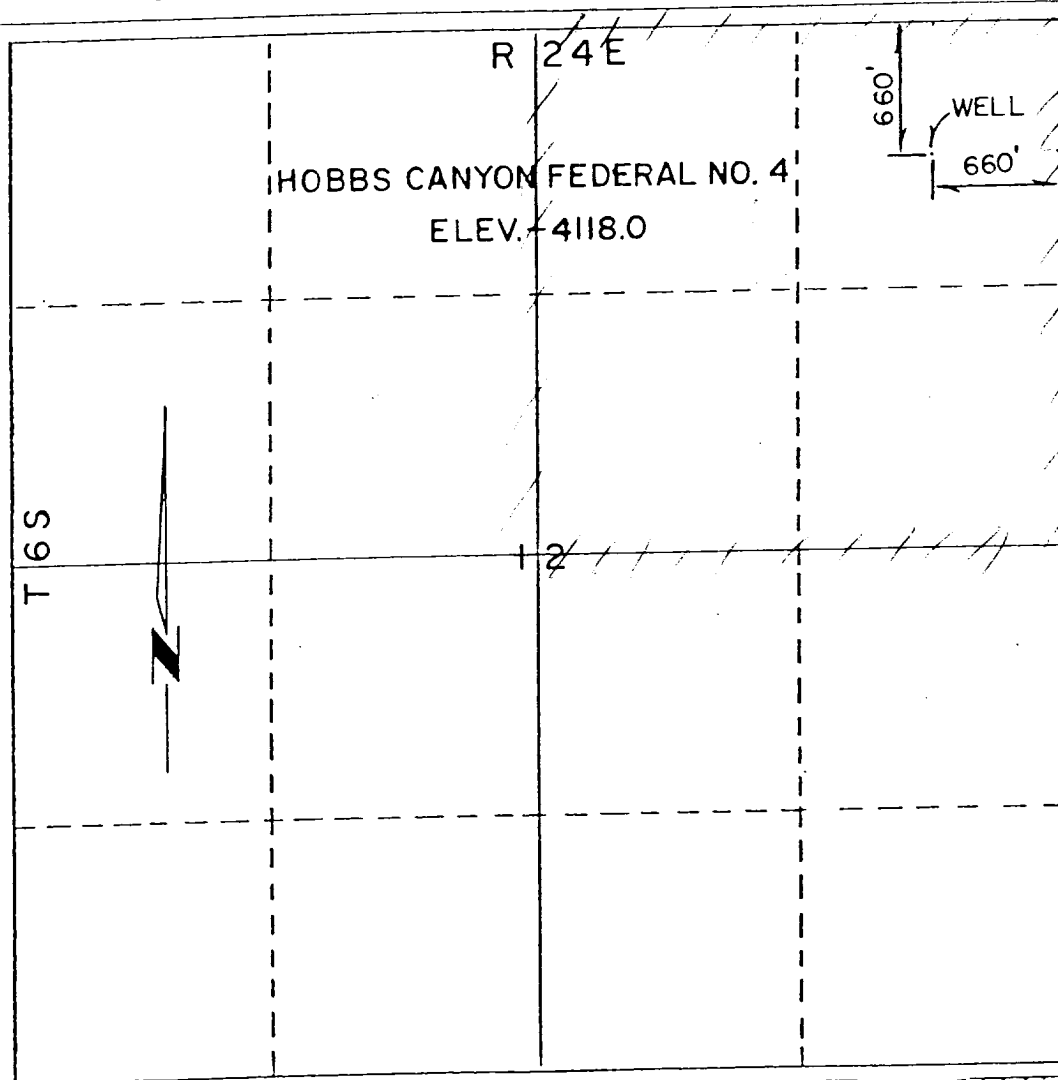

CERTIFICATION

I hereby certify that the information contained herein is true and complete to the best of my knowledge and belief.

Name  
Agent  
Position  
**Jack Grynberg & Associates**  
Company  
Date  
**3-24-82**

I hereby certify that the well location shown on this plat was plotted from field notes of actual surveys made by me or under my supervision, and that the same is true and correct to the best of my knowledge and belief.

27 March 1982

Date Surveyed  
Registered Professional Engineer  
and/or Land Surveyor  
**Gordon J. Douglas, PLS**  
N.M. License No. **6054**  
Certificate No. **DOUGLAS**

0 330 660 990 1320 1650 1980 2310 2640 2970 3300 3630 3960 4290 4620 4950 5280 5610 5940 6270 6600

TEN POINT COMPLIANCE PROGRAM  
Attachment to Form 9-133C, Application for Permit to Drill

Jack Grynberg and Associates  
#4 Hobbs Canyon Federal  
660' FNL and 660' FEL  
Section 12, T 6 S - R 24 E  
Chaves County, New Mexico

1. Geologic Surface Formation  
Sandy Residuum

2. Estimated Tops of Important Geologic Marker

San Andres	550'
Glorieta	1400'
ABO	3600'
TD	4200'

3. Estimated Depths of Anticipated Water, Oil, Gas or Other Minerals

Gas	3600' - 4200'
-----	---------------

4. Proposed Casing Program

<u>Hole Size</u>	<u>Casing Size</u>	<u>Interval</u>	<u>Grade</u>	<u>Wt./Ft.</u>	<u>New or Used</u>
13-1/2"	10-3/4"	0-900	H-40	32.75	New
7-7/8"	4-1/2"	0-4200	J-55	10.75	New
9-1/4" (contingency)	7-7/8"	0-1500	K-55	26.40	New

5. Operator's Minimum Specifications for Pressure Control  
Exhibit "A" is a schematic diagram of the blowout preventor equipment. The BOP's will be hydraulically tested to the full working pressure after nipping up and after any use under pressure. Pipe rams will be operationally checked each 24 hour period, as will blind rams each time pipe is pulled out of the hole.

6. Type and Characteristic of Proposed Circulating Mediums  
Adequate stocks of sorptive agents will be on site to handle possible spills of fuel and oil on the surface. Heavier muds will be on location to be added if pressure requires.

<u>Interval</u>	<u>Type</u>	<u>Weight #/Gal.</u>	<u>Visc.-Sec./Qt.</u>	<u>Fluid Loss-CC</u>
0-900	Native Mud	-	-	-
900-3200	Native Mud	-	-	-
3200-TD	Brine Base	10.2	32-40	20-30 CC Wtr.

7. Auxiliary Equipment

Kelly cock, a float will be used at the bit, pit level indicators and flow sensor equipment, sub with full-opening valve on floor, drill pipe connection.

8. Testing, Logging and Coring Program

- A. DST's as warranted.
- B. The logging program will consist of a CNL-FDC and Dual Lateral Log-MSFL.
- C. No coring is anticipated.
- D. Stimulation procedures will be determined after evaluation of logs.  
If treatment is indicated, appropriate Sundry Notice will be submitted.

9. Anticipated Abnormal Pressures or Temperatures

No abnormal pressures or temperatures are anticipated.

10. The well will be spudded around April 5, 1982 ~~or~~ as soon as permit and surface use program are approved by M.M.S. and B.L.M.

Exhibit " A "  
Jack Gryberg & Associates  
#4 Hobbs Canyon Federal  
660'FNL and 660'FEL  
Section 12, T 6 S-R 24 E  
Chaves County, New Mexico

# BOP Stack

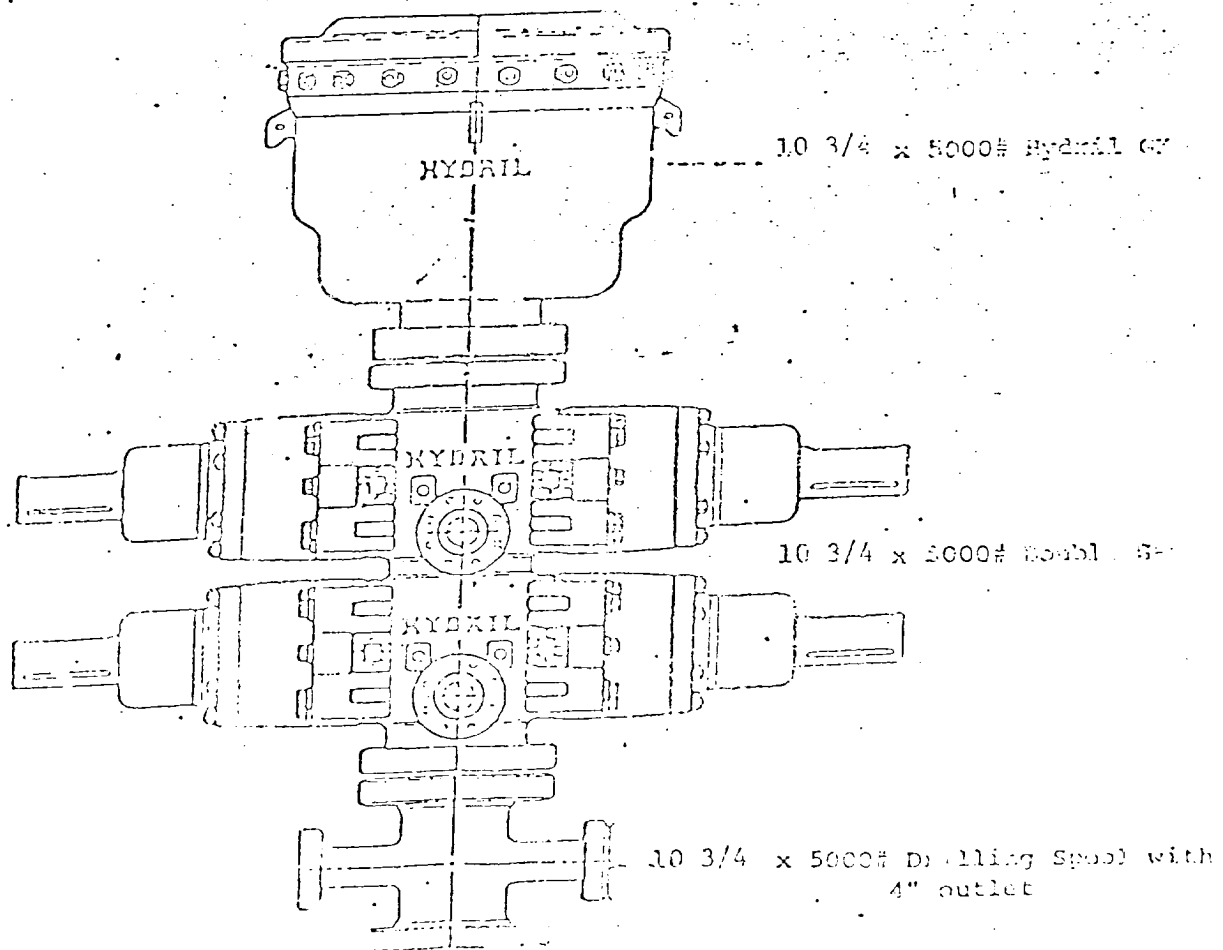

All items NPS trimmed

Exhibit " B "  
Jack Grynberg & Associates  
#4 Hobbs Canyon Federal  
660' FNL and 660' FEL  
Section 12, T 6 S-R 24 E  
Chaves, County, New Mexico

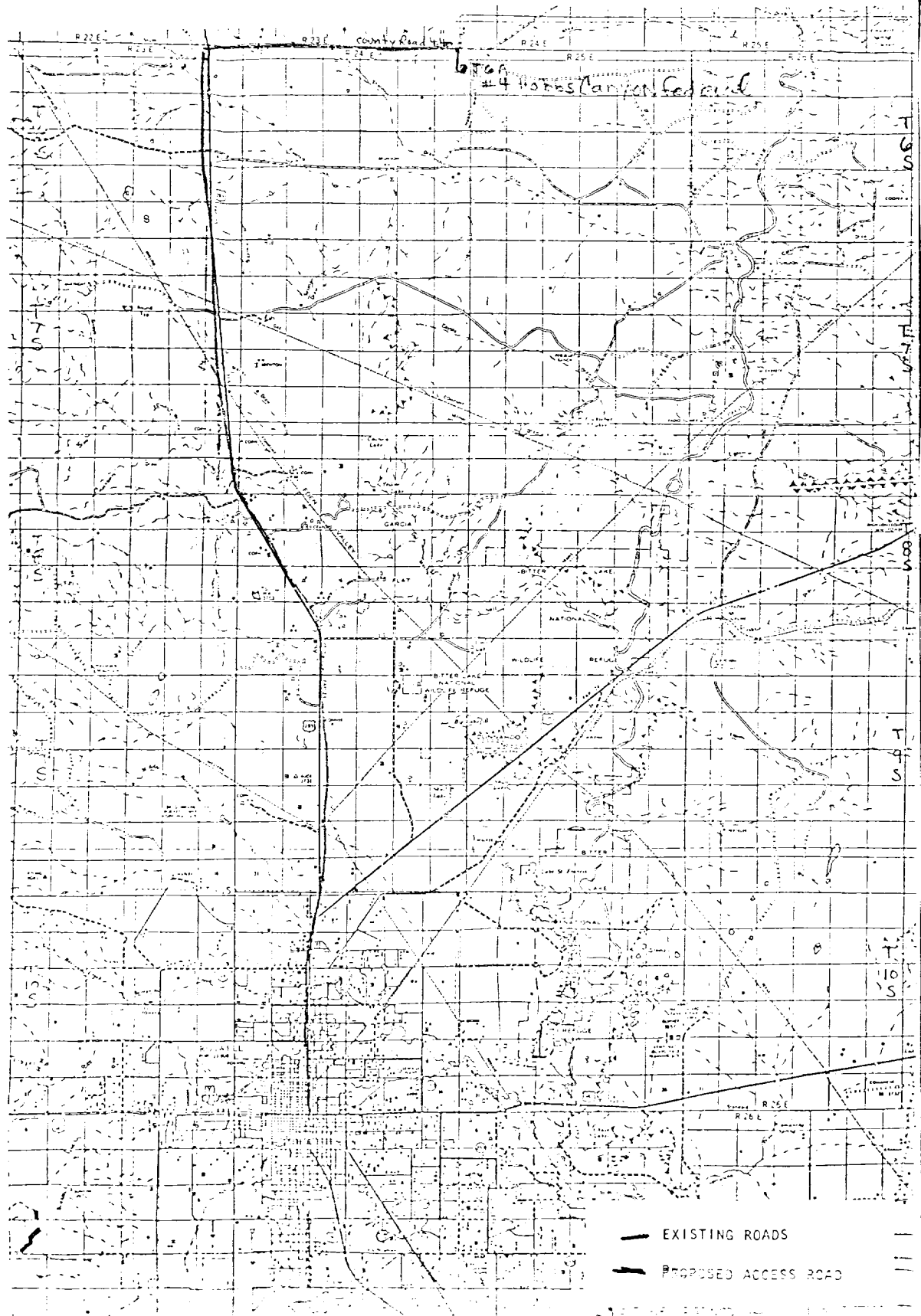

EXHIBIT "C"

Jack Grynberg and Associates  
#4 Hobbs Canyon Federal  
660' FNL and 660' FEL  
Sec. 12, T 6 S - R 24 E  
Chaves County, New Mexico

