

**NEW MEXICO OIL CONSERVATION COMMISSION
WELL LOCATION AND ACREAGE DEDICATION PLAT**

Form C-102
Supersedes C-128
Effective 1-1-65

All distances must be from the outer boundaries of the Section.

Owner: <u>U-Mex Inc.</u>			Lease: <u>CANNON #5</u>		Well No.: <u>#5</u>
Section: <u>A</u>	County: <u>17</u>	Township: <u>10 S.</u>	Range: <u>25 E</u>	County: <u>Chaves</u>	
Distance from the corner of Well: <u>330</u> feet from the <u>North</u> line and <u>330</u> feet from the <u>East</u> line					
Section: <u>3516</u>	Underlying Formation: <u>San Andres</u>		Pool: <u>West Bitter Lakes</u>		Dedicated Acreage: <u>40</u> Acres

- Outline the acreage dedicated to the subject well by colored pencil or hatchure marks on the plat below.
- If more than one lease is dedicated to the well, outline each and identify the ownership thereof (both as to working interest and royalty).
- If more than one lease of different ownership is dedicated to the well, have the interests of all owners been consolidated by communitization, unitization, force-pooling, etc?

☐ Yes ☐ No If answer is "yes," type of consolidation _____

If answer is "no," list the owners and tract descriptions which have actually been consolidated. (Use reverse side of this form if necessary.) _____

No allowable will be assigned to the well until all interests have been consolidated (by communitization, unitization, forced-pooling, or otherwise) or until a non-standard unit, eliminating such interests, has been approved by the Commission.

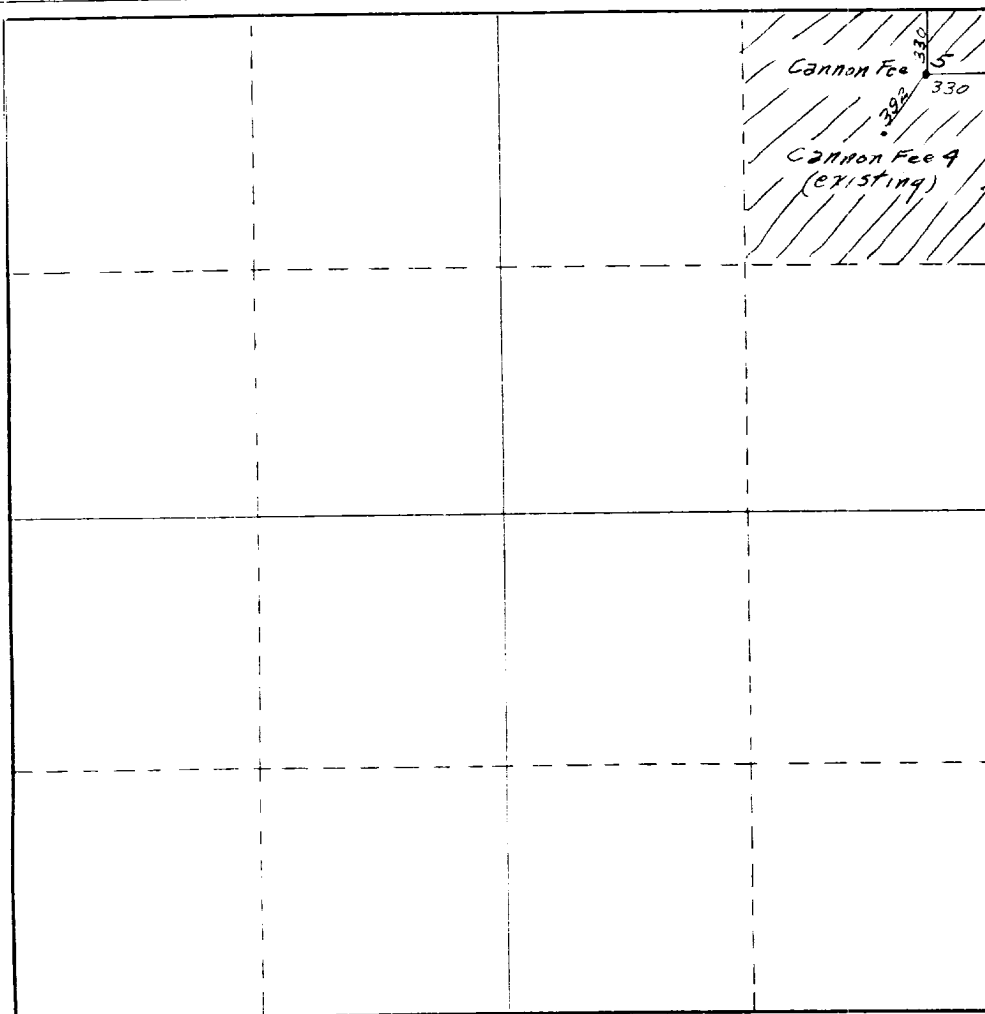

CERTIFICATION

I hereby certify that the information contained herein is true and complete to the best of my knowledge and belief.

Reverie B. Oshulata
Name
Office Manager
Position
Cook Oil & Gas Production
Company
April 2, 1982
Date

I hereby certify that the well location shown on this plat was plotted from field notes of actual surveys made by me or under my supervision, and that the same is true and correct to the best of my knowledge and belief.

Date Surveyed: April 2, 1982
Registered Professional Engineer and/or Land Surveyor: [Signature]
P.R. Feller
Certificate No.: 8112

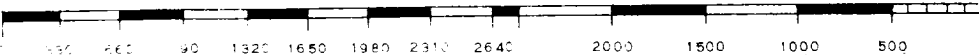

Submit 3 Copies To Appropriate District
Office
District I
1625 N. French Dr., Hobbs, NM 88240
District II
1301 W. Grand Ave., Artesia, NM 88210
District III
1000 Rio Brazos Rd., Aztec, NM 87410
District IV
1220 S. St. Francis Dr., Santa Fe, NM
87505

State of New Mexico
Energy, Minerals and Natural Resources

Form C-103
Revised March 25, 1999

OIL CONSERVATION DIVISION
1220 South St. Francis Dr.
Santa Fe, NM 87505

WELL API NO. 30-005-61500
5. Indicate Type of Lease STATE <input type="checkbox"/> FEE <input checked="" type="checkbox"/>
6. State Oil & Gas Lease No.
7. Lease Name or Unit Agreement Name: CANNON FEE
8. Well No. #5
8. Pool name or Wildcat W. BITTERLAKE SA

SUNDRY NOTICES AND REPORTS ON WELLS
(DO NOT USE THIS FORM FOR PROPOSALS TO DRILL OR TO DEEPEN OR PLUG BACK TO A DIFFERENT RESERVOIR. USE "APPLICATION FOR PERMIT" (FORM C-101) FOR SUCH PROPOSALS.)

1. Type of Well:
Oil Well ☒ Gas Well ☐ Other ☐

2. Name of Operator
UMEX INC.

3. Address of Operator
P.O. DRAW 1517 ROSWELL, N.M. 88210

4. Well Location

Unit Letter A _____: 330' feet from the NORTH line and 330' feet from the EAST line

Section 17 Township 10s Range 25e NMPM CHAVES County

10. Elevation (Show whether DR, RKB, RT, GR, etc.)

11. Check Appropriate Box to Indicate Nature of Notice, Report or Other Data

NOTICE OF INTENTION TO:

PERFORM REMEDIAL WORK ☐ PLUG AND ABANDON ☐
TEMPORARILY ABANDON ☐ CHANGE PLANS ☐
PULL OR ALTER CASING ☐ MULTIPLE COMPLETION ☐
OTHER: ☐

SUBSEQUENT REPORT OF:

REMEDIAL WORK ☐ ALTERING CASING ☐
COMMENCE DRILLING OPNS. ☐ PLUG AND ABANDONMENT ☒
CASING TEST AND CEMENT JOB ☐
OTHER: FINAL REPORT PLUGGING & ABANDONMENT ☐

12. Describe proposed or completed operations. (Clearly state all pertinent details, and give pertinent dates, including estimated date of starting any proposed work). SEE RULE 1103. For Multiple Completions: Attach wellbore diagram of proposed completion or recompilation.

7/10/01 RIGGED UP MAYO MARRS CASING PULLING INC.
RIH AND TAGGED TD AT 535'. SPOTTED 95SX CEMENT PLUG
FROM 535' TO SURFACE. ERECTED DRYHOLE MARKER.
LEVELED PIT CLEARED LOCATION.

I hereby certify that the information above is true and complete to the best of my knowledge and belief.

SIGNATURE mae's wellfield TITLE Envir. Eng. Spec. I DATE 8/23/01

Type or print name _____ Telephone No. _____
(This space for State use)

APPROVED BY mae's wellfield TITLE Envir. Eng. Spec. I DATE 8/23/01
Conditions of approval, if any: