

NO. OF COPIES RECEIVED		
DISTRIBUTION		
SANTA FE	1	
FILE	1	✓
U.S.G.S.	2	
LAND OFFICE	1	
OPERATOR	1	

RECEIVED 30-005-61542  
 NEW MEXICO OIL CONSERVATION COMMISSION  
 APR 13 1982  
 O. C. D.  
 ARTESIA, OFFICE  
 Form C-101  
 Revised 1-1-65

APPLICATION FOR PERMIT TO DRILL, DEEPEN, OR PLUG BACK			
1a. Type of Work DRILL <input checked="" type="checkbox"/> DEEPEN <input type="checkbox"/> PLUG BACK <input type="checkbox"/>		7. Unit Agreement Name	
b. Type of Well OIL WELL <input type="checkbox"/> GAS WELL <input checked="" type="checkbox"/> OTHER <input type="checkbox"/> SINGLE ZONE <input checked="" type="checkbox"/> MULTIPLE ZONE <input type="checkbox"/>		8. Farm or Lease Name ROUND TOP STATE	
2. Name of Operator MESA PETROLEUM CO. ✓		9. Well No. 6	
3. Address of Operator 1000 VAUGHN BUILDING/MIDLAND, TEXAS 79703-4493		10. Field and Pool, or Wildcat ✓ UNDESIGNATED ABO	
4. Location of Well UNIT LETTER <u>L</u> LOCATED <u>1980</u> FEET FROM THE <u>SOUTH</u> LINE AND <u>660</u> FEET FROM THE <u>WEST</u> LINE OF SEC. <u>10</u> TWP. <u>7S</u> RGE. <u>23E</u> NMPM		12. County CHAVES	
19. Proposed Depth 3400'		19A. Formation ABO	20. Rotary or C.T. ROTARY
21. Elevations (Show whether DF, RT, etc.) 3400' GR	21A. Kind & Status Plug. Bond BLANKET	21B. Drilling Contractor TOM BROWN DRILLING	22. Approx. Date Work will start APRIL 30, 1982

23. PROPOSED CASING AND CEMENT PROGRAM

SIZE OF HOLE	SIZE OF CASING	WEIGHT PER FOOT	SETTING DEPTH	SACKS OF CEMENT	EST. TOP
12 1/4"	8 5/8"	24#	1400'	300/300/300	SURFACE
7 7/8"	4 1/2"	10.5#	3400'	500/500	ISOLATE WTR, O&G

Propose to drill 12 1/4" hole to approximately 1400' more or less and set 8 5/8" surface casing and cement to surface. Will reduce hole to 7 7/8", nipple up RAM type BOP's and drill to total depth. Drilling medium will be air, foam, or mud as required.

Operator's Gas Sales Are Dedicated.

APPROVAL VALID FOR 180 DAYS  
 PERMIT EXPIRES 10-16-82  
 UNLESS DRILLING UNDERWAY

XC: NMOCD (6), TLS, CEN RCDS, ACCTG, MEC, LAND, ROSWELL, REM, FILE (PARTNERS)

IN ABOVE SPACE DESCRIBE PROPOSED PROGRAM: IF PROPOSAL IS TO DEEPEN OR PLUG BACK, GIVE DATA ON PRESENT PRODUCTIVE ZONE AND PROPOSED NEW PRODUCTIVE ZONE. GIVE BLOWOUT PREVENTER PROGRAM, IF ANY.

I hereby certify that the information above is true and complete to the best of my knowledge and belief.

Signed R. E. Nathan Title REGULATORY COORDINATOR Date 4-12-82

(This space for State Use)

APPROVED BY Mike Walker TITLE Notify NMOCD DATE APR 16 1982

CONDITIONS OF APPROVAL, IF ANY:

time to witness cementing  
 the 8 5/8 casing

Post ID-1  
 API Book & NL  
 4-16-82

MEXICO OIL CONSERVATION COMMISS  
WELL LOCATION AND ACREAGE DEDICATION PLAT

Form C-102  
Supersedes C-128  
Effective 1-1-65

All distances must be from the outer boundaries of the Section

Operator <b>Mesa Petroleum Co.</b>			Lease <b>Round Top St.</b>			Well No. <b>6</b>		
Unit Letter <b>L</b>	Section <b>10</b>	Township <b>7 South</b>	Range <b>23 East</b>	County <b>Chaves</b>				
Actual Footage Location of Well: <b>1980</b> feet from the <b>south</b> line and <b>660</b> feet from the <b>west</b> line								
Ground Level Elev. <b>3978.5</b>	Producing Formation <b>ABO</b>		Pool <b>UNDESIGNATED</b>		Dedicated Acreage: <b>SW/4 160</b> Acres			

1. Outline the acreage dedicated to the subject well by colored pencil or hachure marks on the plat below.
2. If more than one lease is dedicated to the well, outline each and identify the ownership thereof (both as to working interest and royalty).
3. If more than one lease of different ownership is dedicated to the well, have the interests of all owners been consolidated by communitization, unitization, force-pooling, etc?

☐ Yes ☐ No If answer is "yes," type of consolidation \_\_\_\_\_

If answer is "no," list the owners and tract descriptions which have actually been consolidated. (Use reverse side of this form if necessary.) \_\_\_\_\_

No allowable will be assigned to the well until all interests have been consolidated (by communitization, unitization, forced-pooling, or otherwise) or until a non-standard unit, eliminating such interests, has been approved by the Commission.

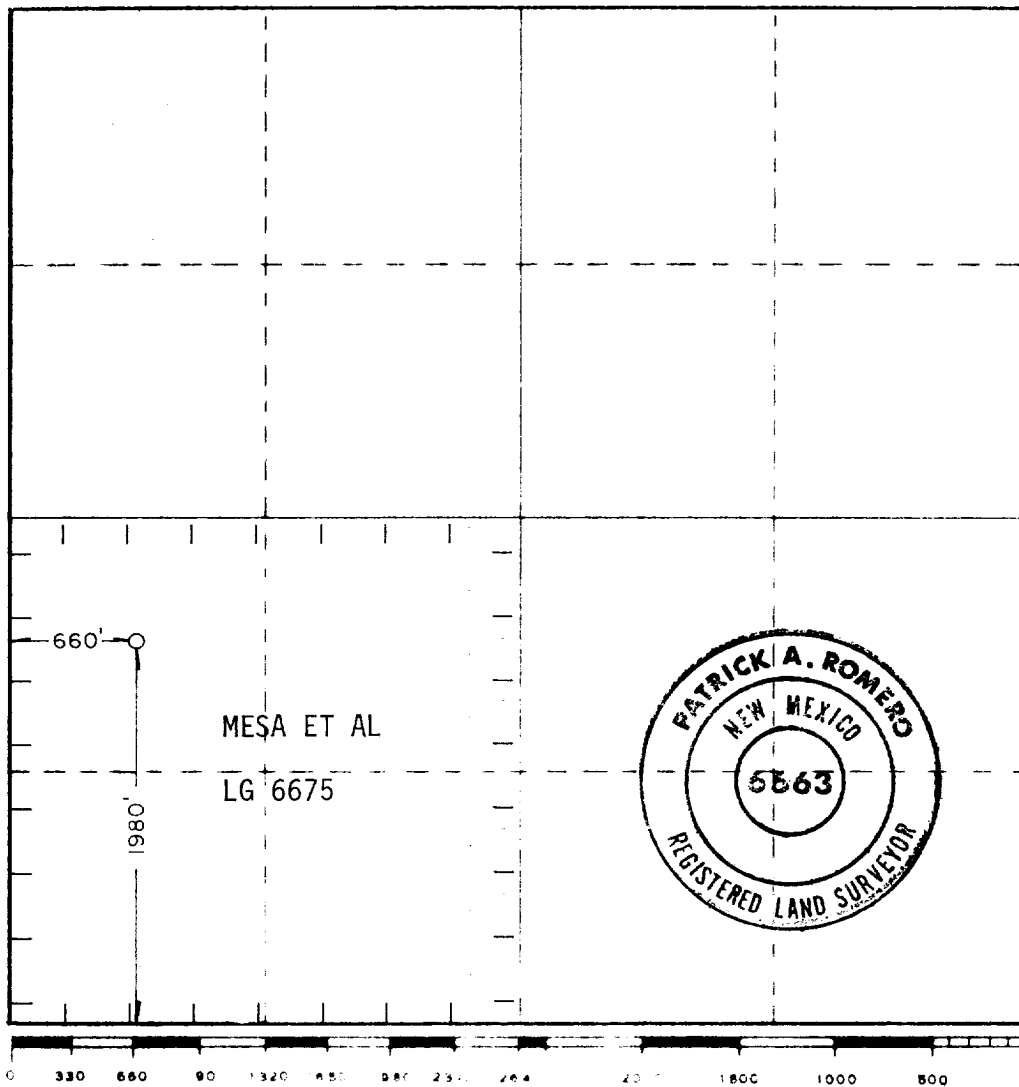

CERTIFICATION

I hereby certify that the information contained herein is true and complete to the best of my knowledge and belief.

*R. E. Mathis*

Name

**R. E. MATHIS**

Position

**REGULATORY COORDINATOR**

Company

**MESA PETROLEUM CO.**

Date

**APRIL 12, 1982**

I hereby certify that the well location shown on this plat was plotted from field notes of actual surveys made by me or under my supervision, and that the same is true and correct to the best of my knowledge and belief.

Date Surveyed

**4-8-82**

Registered Professional Engineer and/or Land Surveyor

*Patrick A. Romero*

Certificate No

**JOHN W. WEST 676**  
**PATRICK A. ROMERO 6663**  
**Ronald J. Eidson 3239**