

NO. OF COPIES RECEIVED	
DISTRIBUTION	
SANTA FE	1
FILE	1
U.S.G.S.	2
LAND OFFICE	1
OPERATOR	1

NEW MEXICO OIL CONSERVATION COMMISSION

APR 1 1982

O. C. C.
ARTESIA, OFFICE

30-005-61551
Form C-101
Revised 1-1-85

5A. Indicate Type of Lease	STATE <input checked="" type="checkbox"/> FEE <input type="checkbox"/>
5. State Oil & Gas Lease No.	L-2464

APPLICATION FOR PERMIT TO DRILL, DEEPEN, OR PLUG BACK

1a. Type of Work		7. Unit Agreement Name	
b. Type of Well DRILL <input checked="" type="checkbox"/> DEEPEN <input type="checkbox"/> PLUG BACK <input type="checkbox"/> OIL WELL <input type="checkbox"/> GAS WELL <input checked="" type="checkbox"/> OTHER <input type="checkbox"/> SINGLE ZONE <input type="checkbox"/> MULTIPLE ZONE <input type="checkbox"/>		8. Farm or Lease Name Tolmac State	
2. Name of Operator McClellan Oil Corporation		9. Well No. 2	
3. Address of Operator P.O. Drawer 730, Roswell, New Mexico		10. Field and Pool, or Wildcat Penjack Abo	
4. Location of Well UNIT LETTER N LOCATED 990 FEET FROM THE South LINE AND 1980 FEET FROM THE West LINE OF SEC. 36 TWP. 9S RGE. 25E NMPM		12. County Chaves	
21. Elevations (Show whether DF, RT, etc.) 3657' GL		19. Proposed Depth 4500'	19A. Formation Abo
21A. Kind & Status Plug. Bond Statewide		20. Rotary or C.T. Rotary	22. Approx. Date Work will start 6-1-82
21B. Drilling Contractor WEK			

PROPOSED CASING AND CEMENT PROGRAM

SIZE OF HOLE	SIZE OF CASING	WEIGHT PER FOOT	SETTING DEPTH	SACKS OF CEMENT	EST. TOP
17-1/2"	13-3/8"	48	40'	5 yds.	Circ.
12-1/4"	8-5/8"	23	1100'	700 sx	Circ.
7-7/8"	4-1/2"	10.5	4500'	300 sx	3500'

Propose to drill and test the Abo formation. If production is indicated will run 4-1/2" production casing and attempt completion.

Estimated Geologic Tops: San Andres 740' Tubb 3210'
Glorieta 1750' Abo 3965'

Mud Program: Will use native mud to top of Abo. Mud-up 100' above top of Abo with salt base gel having a water loss of 10cc, viscosity of 30-40. Gas is not dedicated.

APPROVAL VALID FOR 180 DAYS
PERMIT EXPIRES 10-20-82
UNLESS DRILLING UNDERWAY

IN ABOVE SPACE DESCRIBE PROPOSED PROGRAM: IF PROPOSAL IS TO DEEPEN OR PLUG BACK, GIVE DATA ON PRESENT PRODUCTIVE ZONE AND PROPOSED NEW PRODUCTIVE ZONE. GIVE BLOWOUT PREVENTER PROGRAM, IF ANY.

I hereby certify that the information above is true and complete to the best of my knowledge and belief.

Signed Paul R. Ragsdale Title Engineer Date 4/1/82

(This space for State Use)

APPROVED BY Mike Walker TITLE OIL AND GAS INSPECTOR

DATE APR 20 1982

CONDITIONS OF APPROVAL, IF ANY:

Notify N.M.O.C.C. in sufficient time to witness cementing

the 3 5/8 casing

Posted ID-1
API + NL Book
4-23-82

6/13/82

TD. w/ 12 1/4 hole @ 1199'. Ran

1098' of 8 5/8" 24# K-55 csg.

Pumped 600 sxs. cmt.

350 HL w/ 1/4# flocele, 2% CaCl.

& 250 Cl. C w/ 2% CaCl.

Circ. 65 sxs. to the pit

Jerry Brooks

plug down. 5:30 pm. no loss of returns
cmt. station @ 1199'

All distances must be from the outer boundaries of the Section.

Operator McClellan Oil Corp		Lease Tolmac State		Well No. #2
Unit Letter N	Section 36	Township 9 South	Range 25 East	County Chaves
Actual Footage Location of Well: 1980 feet from the West line and 990 feet from the South line				
Ground Level Elev. 3657	Producing Formation abo		Pool 10.2	Dedicated Acreage: 10.2 Acres

1. Outline the acreage dedicated to the subject well by colored pencil or hatchure marks on the plat below.
2. If more than one lease is dedicated to the well, outline each and identify the ownership thereof (both as to working interest and royalty).
3. If more than one lease of different ownership is dedicated to the well, have the interests of all owners been consolidated by communitization, unitization, force-pooling, etc?

☐ Yes ☐ No If answer is "yes," type of consolidation _____

If answer is "no," list the owners and tract descriptions which have actually been consolidated. (Use reverse side of this form if necessary.) _____

No allowable will be assigned to the well until all interests have been consolidated (by communitization, unitization, forced-pooling, or otherwise) or until a non-standard unit, eliminating such interests, has been approved by the Division.

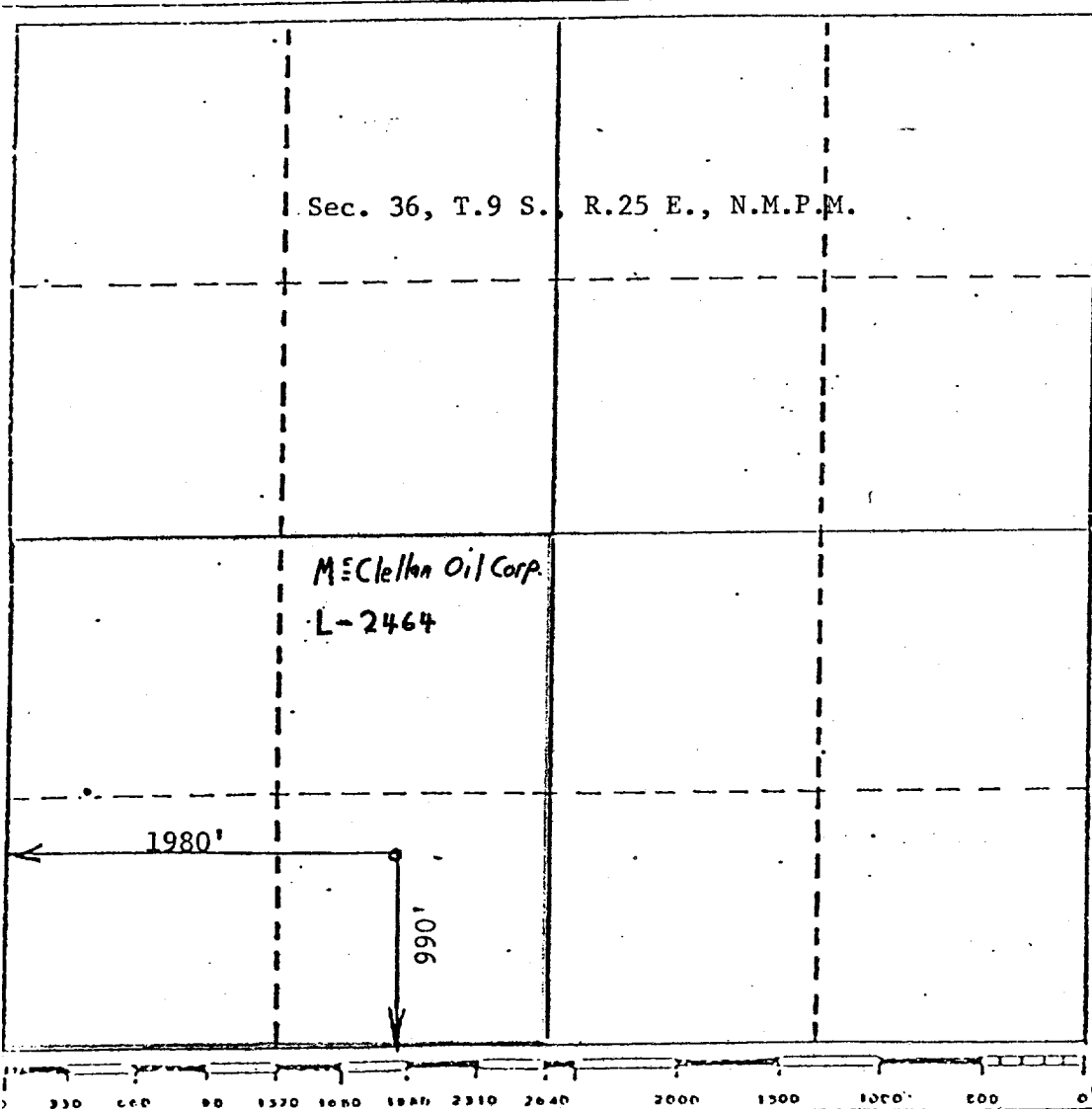

CERTIFICATION

I hereby certify that the information contained herein is true and complete to the best of my knowledge and belief.

Mark McClellan

Name
Mark McClellan
Position
Geologist
Company
McClellan Oil Corporation
Date
April 1, 1982

I hereby certify that the well location shown on this plot was plotted from field notes of actual surveys made by me or under my supervision, and that the same is true and correct to the best of my knowledge and belief.

JOHN D. JAQUES
NEW MEXICO
March 29, 1982
6290
Registered Professional Engineer
and Oil Well Surveyor
John D. Jaques, P.E. & L.S.
Certificate No. 6290