

NO. OF COPIES RECEIVED	
DISTRIBUTION	
SANTA FE	1
FILE	1 ✓
U.S.G.S.	2
LAND OFFICE	
OPERATOR	1

NEW MEXICO OIL CONSERVATION COMMISSION

RECEIVED

Form C-101
Revised 1-1-65

APR 21 1982

O. C. D.
ARTESIA, OFFICE

5A. Indicate Type of Lease
STATE ☐ FEE ☒

5. State Oil & Gas Lease No.

APPLICATION FOR PERMIT TO DRILL, DEEPEN, OR PLUG BACK

1a. Type of Work DRILL <input checked="" type="checkbox"/> DEEPEN <input type="checkbox"/> PLUG BACK <input type="checkbox"/>		7. Unit Agreement Name
b. Type of Well OIL WELL <input type="checkbox"/> GAS WELL <input checked="" type="checkbox"/> OTHER <input type="checkbox"/> SINGLE ZONE <input checked="" type="checkbox"/> MULTIPLE ZONE <input type="checkbox"/>		8. Farm or Lease Name PETE COM
2. Name of Operator MESA PETROLEUM CO.		9. Well No. 1
3. Address of Operator 1000 VAUGHN BUILDING/MIDLAND, TEXAS 79703-4493		10. Field and Pool, or Adapt UNDESIGNATED ABO
4. Location of Well UNIT LETTER <u>E</u> LOCATED <u>1980</u> FEET FROM THE <u>NORTH</u> LINE AND <u>660</u> FEET FROM THE <u>WEST</u> LINE OF SEC. <u>17</u> TWP. <u>7S</u> RGE. <u>26E</u> NMPM		12. County CHAVES
19. Proposed Depth 4450'		19A. Formation ABO
20. Rotary or C.T. ROTARY		
21. Elevations (Show whether DF, RT, etc.) 3589' GR	21A. Kind & Status Plug. Bond BLANKET	21B. Drilling Contractor TOM BROWN DRILLING
22. Approx. Date Work will start April 22, 1982		

23.

PROPOSED CASING AND CEMENT PROGRAM

SIZE OF HOLE	SIZE OF CASING	WEIGHT PER FOOT	SETTING DEPTH	SACKS OF CEMENT	EST. TOP
14 3/4"	10 3/4"	40.5#	950'	700/300	SURFACE
9 1/2"	7 5/8"/7"	26.4#/23#	1600'	700/300	TIE BACK
7 7/8"/6 1/2"/6 1/4"	4 1/2"/5 1/2"	10.5#/15.5#	4450'	300	COVER ABO

Propose to drill 14 3/4" hole with mud or air to approximately 950' and run 10 3/4" casing. Will cement to surface and test casing with cementing head to 600 psi. Will reduce hole to 9 1/2" and drill on mud or air to approximately 1600' and run 7 5/8" casing if circulation has been lost and cement with sufficient amounts to tie-back to 10 3/4" casing. Will then reduce hole to 6 1/2" or 6 1/4", test BOP's and casing and drill to total depth. If hole conditions are favorable, the 7 5/8" casing will be omitted and the hole will be reduced to 7 7/8" and drilled to total depth. Either 4 1/2" or 5 1/2" casing will be run as production casing depending upon hole sized drilled to TD.

Operator's gas sales are dedicated.

APPROVAL VALID FOR 180 DAYS
PERMIT EXPIRES 10-21-82
UNLESS DRILLING UNDERWAY

XC: NMOCD (6), TLS, CEN RCDS, ACCTG, MEC, LAND, ROSWELL, REM, FILE (PARTNERS

IN ABOVE SPACE DESCRIBE PROPOSED PROGRAM: IF PROPOSAL IS TO DEEPEN OR PLUG BACK, GIVE DATA ON PRESENT PRODUCTIVE ZONE AND PROPOSED NEW PRODUCTIVE ZONE. GIVE BLOWOUT PREVENTER PROGRAM, IF ANY.

I hereby certify that the information above is true and complete to the best of my knowledge and belief.

Signed R. E. Markis Title REGULATORY COORDINATOR Date 4-20-82

(This space for State Use)

APPROVED BY Mark W. Walker TITLE Oil and Gas Inspector DATE 4-21-82
CONDITIONS OF APPROVAL, IF ANY: Notify N.M.O.C.C. in sufficient time to witness cementing

10 3/4

Posted ID-1
API + NL Book
4-23-82

OIL CONSERVATION DIVISION

P. O. BOX 2008

Form C-102
Revised 10-1-78STATE OF NEW MEXICO
ENERGY AND MINERALS DEPARTMENT

SANTA FE, NEW MEXICO 87501

All distances must be from the outer boundaries of the Section.

Operator Mesa Petroleum Co.		Lease Pete Com		Well No. #1
Unit Letter E	Section 17	Township 7 South	Range 26 East	County Chaves
Actual Footage Location of Well: 660 feet from the West line and 1980 feet from the North line				
Ground Level Elev. 3589	Producing Formation ABO	Pool Undesignated Pecos Slope		Dedicated Acreage: NW 160 Acres

1. Outline the acreage dedicated to the subject well by colored pencil or hatchure marks on the plat below.

2. If more than one lease is dedicated to the well, outline each and identify the ownership thereof (both as to working interest and royalty).

3. If more than one lease of different ownership is dedicated to the well, have the interests of all owners been consolidated by communitization, unitization, force-pooling, etc?

☐ Yes ☐ No If answer is "yes," type of consolidation Communitization in progress

If answer is "no," list the owners and tract descriptions which have actually been consolidated. (Use reverse side of this form if necessary.)

No allowable will be assigned to the well until all interests have been consolidated (by communitization, unitization, forced-pooling, or otherwise) or until a non-standard unit, eliminating such interests, has been approved by the Division.

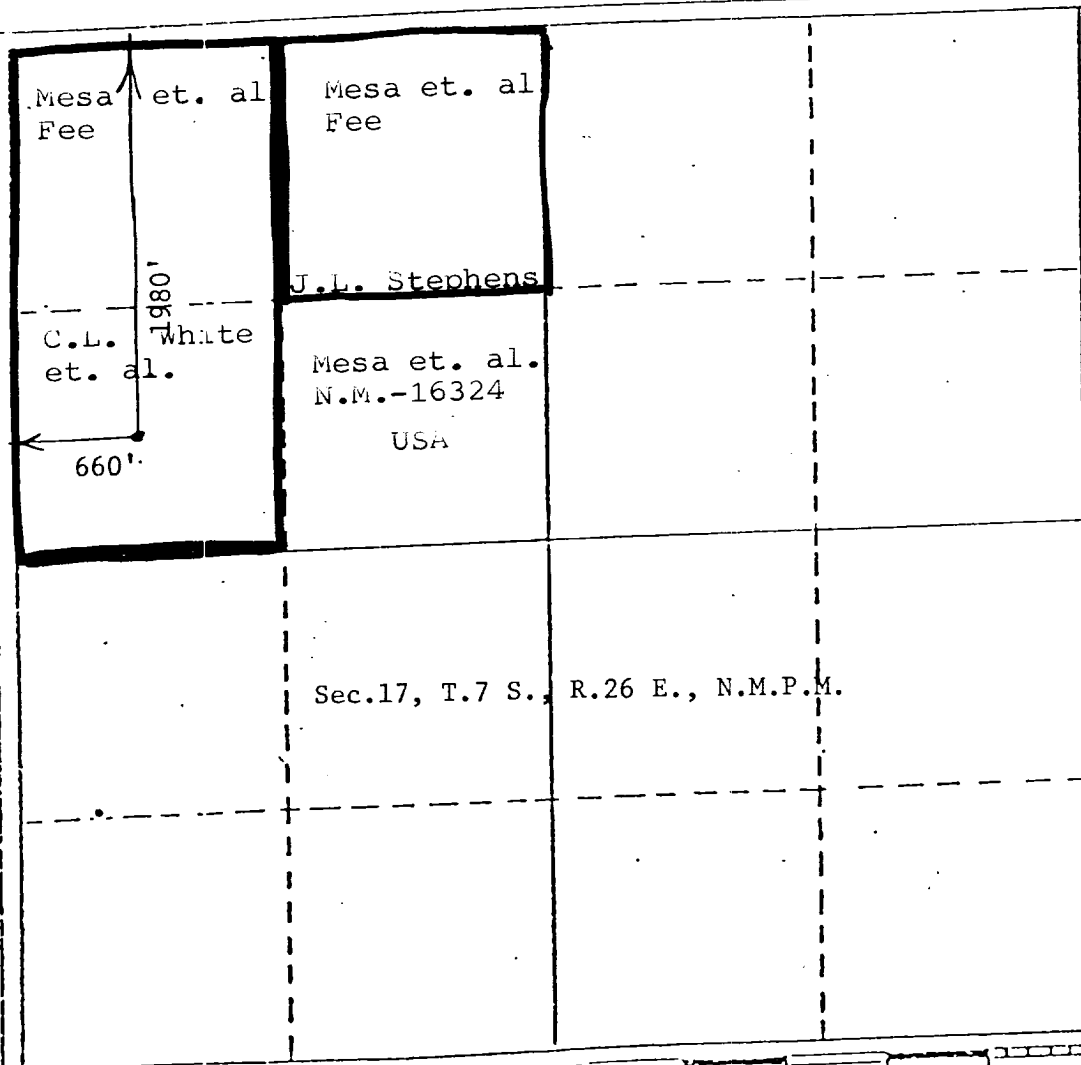

CERTIFICATION

I hereby certify that the information contained herein is true and complete to the best of my knowledge and belief.

Name

Lloyd Reed

Position

Regulatory Agent

Company

Mesa Petroleum Co.

Date

4/20/82

I hereby certify that the well location shown on this plat was plotted from field notes of actual surveys made by me or under my supervision, and that the same is true and correct to the best of my knowledge and belief.

Date Surveyed

April 20, 1982

Registered Professional Engineer and/or Land Surveyor

John D. Jaquess

John D. Jaquess, F.E.S.

Certificate No.

6290