

STATE OF NEW MEXICO  
ENERGY AND MINERALS DEPARTMENT

CONSERVATION DIVISION  
P. O. BOX 2088  
SANTA FE, NEW MEXICO 87501

30-005-61566

Form C-101  
Revised 10-1-78

NO. OF COPIES RECEIVED	
DISTRIBUTION	
SANTA FE	1
FILE	1
U.S.G.S.	2
LAND OFFICE	
OPERATOR	1

RECEIVED

APR 26 1982

O. C. D.

ARTESIA, OFFICE

APPLICATION FOR PERMIT TO DRILL, DEEPEN, OR PLUG BACK

1. Type of Work		7. Unit Agreement Name	
Type of Well OIL WELL <input type="checkbox"/> GAS WELL <input checked="" type="checkbox"/> OTHER <input type="checkbox"/>		8. Farm or Lease Name McCrea "TU" Com	
Name of Operator Yates Petroleum Corporation ✓		9. Well No. 1	
Address of Operator 207 S. 4th, Artesia, New Mexico 88210		10. Field and Pool or Wildcat Undes. Pecos Slope	
Location of Well UNIT LETTER B LOCATED 660 FEET FROM THE North LINE		11. County Chaves	
12. 1980 FEET FROM THE East LINE OF SEC. 32 TWP. 8S RGE. 26E NMPM		13. Proposed Depth 4850'	
14. Elevations (Show whether DF, KT, etc.) 3760.5' GL		15. Formation Abo	
21A. Kind & Status Plug. Bond Blanket		20. Rotary or C.T. Rotary	
21B. Drilling Contractor not determined		22. Approx. Date Work will start ASAP	

PROPOSED CASING AND CEMENT PROGRAM

SIZE OF HOLE	SIZE OF CASING	WEIGHT PER FOOT	SETTING DEPTH	SACKS OF CEMENT	EST. TOP
14 3/4"	10 3/4"	40.5# J-55	1000'	850 sx	circulated
7 7/8"	4 1/2"	9.5#	TD	350 sx	

We propose to drill and test the Abo and intermediate formations. Approximately 1000' of surface casing will be set and cement circulated to shut off gravel and caving. If needed (lost circulation) 8 5/8" intermediate casing will be run to 1500' and cemented with enough cement calculated to tie back into the surface casing. If commercial, production casing will be run and cemented with adequate cover, perforated and stimulated as needed for production.

MUD PROGRAM: FW gel and LCM to 1000', Brine to 3200', Brine & KCL water to TD.

BOP PROGRAM: BOP's will be installed at the offset and tested daily.

GAS NOT DEDICATED.

APPROVAL VALID FOR 180 DAYS  
PERMIT EXPIRES 10-27-82  
UNLESS DRILLING UNDERWAY

ABOVE SPACE DESCRIBE PROPOSED PROGRAM; IF PROPOSAL IS TO DEEPEN OR PLUG BACK, GIVE DATA ON PRESENT PRODUCTIVE ZONE AND PROPOSED NEW PRODUCTION ZONE. GIVE BLOWOUT PREVENTER PROGRAM, IF ANY.

I hereby certify that the information above is true and complete to the best of my knowledge and belief.

and [Signature] Title Regulatory Manager Date 4/23/82

(This space for State Use)

PROVED BY [Signature] TITLE OIL AND GAS INSPECTOR DATE APR 27 1982

CONDITIONS OF APPROVAL, IF ANY:

Posted ID-1  
API + NL Book  
4-30-82

N MEXICO OIL CONSERVATION COMMISS  
WELL LOCATION AND ACREAGE DEDICATION PLAT

Form C-102  
Supersedes C-128  
Effective 1-1-65

All distances must be from the outer boundaries of the Section.

Operator <b>YATES PETROLEUM CORPORATION</b>			Lease <b>McCrea "TU" Com</b>		Well No. <b>1</b>
Unit Letter <b>B</b>	Section <b>32</b>	Township <b>8 South</b>	Range <b>26 East</b>	County <b>Chaves</b>	
Actual Footage Location of Well: <b>1980</b> feet from the <b>East</b> line and <b>660</b> feet from the <b>North</b> line					
Ground Level Elev. <b>3760.5'</b>	Producing Formation <b>Abo</b>		Pool <b>Undes. <del>Pecos Slope</del> Abo</b>		Dedicated Acreage: <b>160</b> Acres

1. Outline the acreage dedicated to the subject well by colored pencil or hachure marks on the plat below.
2. If more than one lease is dedicated to the well, outline each and identify the ownership thereof (both as to working interest and royalty).
3. If more than one lease of different ownership is dedicated to the well, have the interests of all owners been consolidated by communitization, unitization, force-pooling, etc?

☐ Yes ☐ No If answer is "yes," type of consolidation \_\_\_\_\_

If answer is "no," list the owners and tract descriptions which have actually been consolidated. (Use reverse side of this form if necessary.) \_\_\_\_\_

No allowable will be assigned to the well until all interests have been consolidated (by communitization, unitization, forced-pooling, or otherwise) or until a non-standard unit, eliminating such interests, has been approved by the Commission.

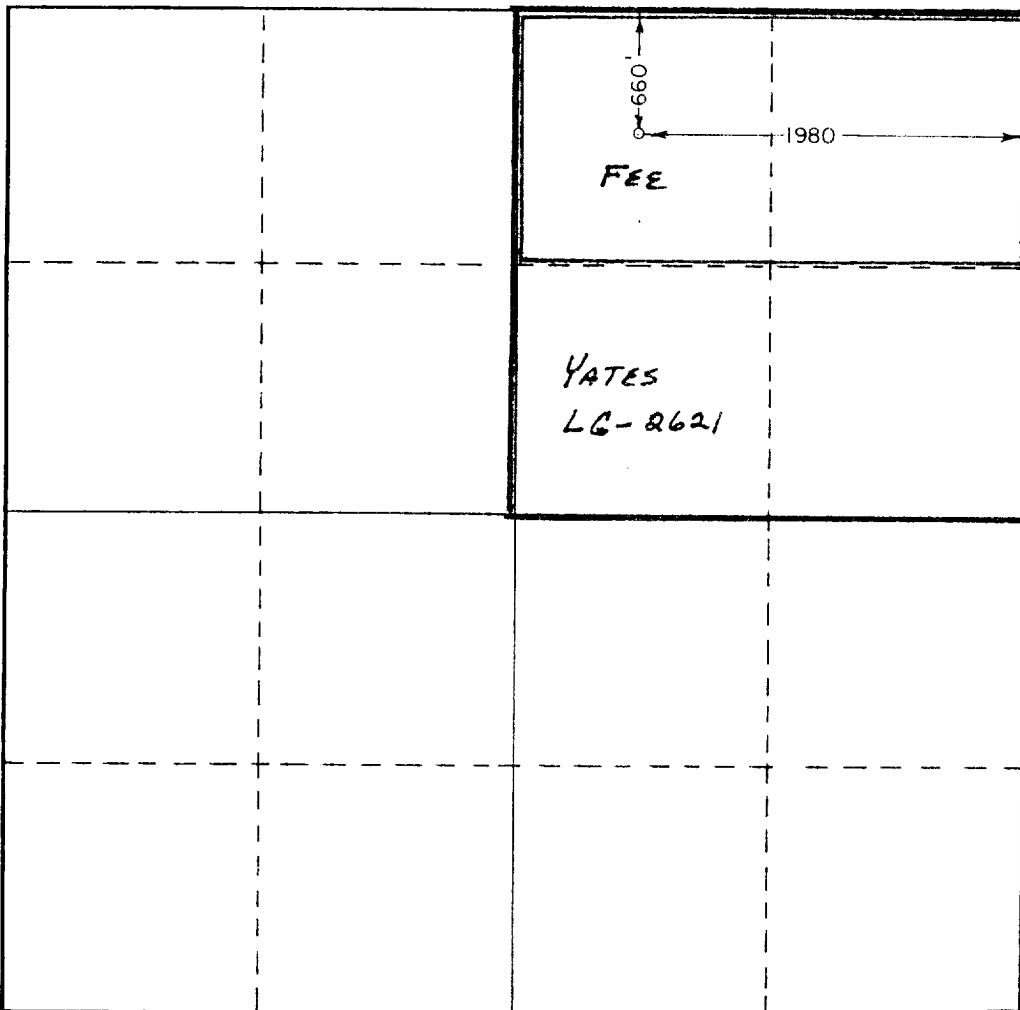

**CERTIFICATION**

I hereby certify that the information contained herein is true and complete to the best of my knowledge and belief.

Name  
**Gliserio Rodriguez**  
Position  
**Regulatory Manager**  
Company  
**Yates Petroleum Corp.**  
Date  
**4/23/82**

I hereby certify that the well location shown on this plat was plotted from field notes of actual surveys made by me or under my supervision in 1977 and that the same is true and correct to the best of my knowledge and belief.

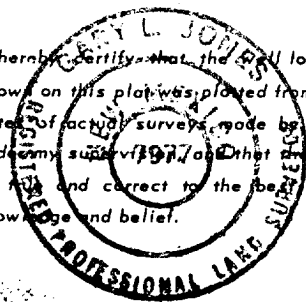

Date Surveyed  
**April 14, 1982**  
Registered Professional Engineer  
and/or Land Surveyor

Certificate No.  
**7977**

0 330 660 990 1320 1650 1980 2310 2640 2970 3300 3630 3960 4290 4620 4950 5280 5610 5940 6270 6600

# Exhibit F

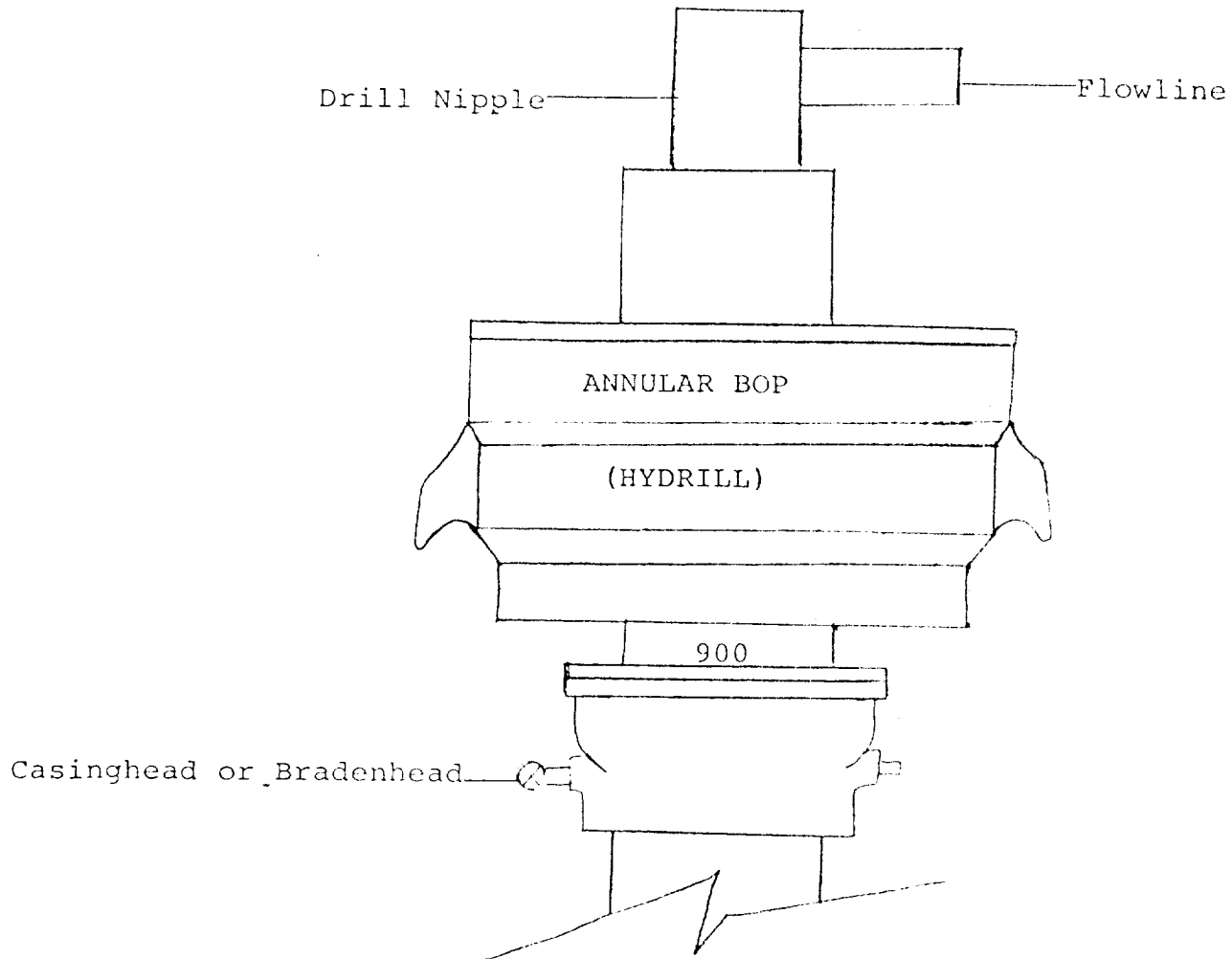

## THE FOLLOWING CONSTITUTE MINIMUM BLOWOUT PREVENTER REQUIREMENTS

1. All preventers to be hydraulically operated with secondary manual controls installed prior to drilling out from under casing.
2. All connections from operating manifolds to preventers to be all steel. Hole or tube a minimum of one inch in diameter.
3. The available closing pressure shall be at least 15% in excess of that required with sufficient volume to operate the BOP's.
4. All connections to and from preventer to have a pressure rating equivalent to that of the BOP's.
5. Hole must be kept filled on trips below intermediate casing. Operator not responsible for blowouts resulting from not keeping hole full.