

UNITED STATES
DEPARTMENT OF THE INTERIOR
GEOLOGICAL SURVEY

SUNDRY NOTICES AND REPORTS ON WELLS

(Do not use this form for proposals to drill or to deepen or plug back to a different reservoir. Use Form 9-331-C for such proposals.)

1. oil well ☐ gas well ☒ other ☐

2. NAME OF OPERATOR
Stevens Operating Corporation

3. ADDRESS OF OPERATOR
P. O. Box 2408, Roswell, New Mexico 88201

4. LOCATION OF WELL (REPORT LOCATION CLEARLY. See space 17 below.)
AT SURFACE: 1650' FSL, 660' FWL, Sec. 15, 7S, 26E
AT TOP PROD. INTERVAL: Same
AT TOTAL DEPTH: Same

16. CHECK APPROPRIATE BOX TO INDICATE NATURE OF NOTICE, REPORT, OR OTHER DATA

REQUEST FOR APPROVAL TO:

TEST WATER SHUT-OFF ☐
FRACTURE TREAT ☐
SHOOT OR ACIDIZE ☐
REPAIR WELL ☐
PULL OR ALTER CASING ☐
MULTIPLE COMPLETE ☐
CHANGE ZONES ☐
ABANDON* ☐

SUBSEQUENT REPORT OF:

(other) Set wireline bridge plug X

5. LEASE

NM 27634

6. IF INDIAN, ALLOTTEE OR TRIBE NAME

7. UNIT AGREEMENT NAME

8. FARM OR LEASE NAME

Hanagan Federal

9. WELL NO.

4

10. FIELD OR WILDCAT NAME

Undesignated Abo

11. SEC., T., R., M., OR BLK. AND SURVEY OR AREA

Sec. 15, T-7-S, R-26-E

12. COUNTY OR PARISH

Chaves

13. STATE

NM

14. API NO.

15. ELEVATIONS (SHOW DF, KDB, AND WD)
3700.8 GR

(NOTE: Report results of multiple completion or zone change on Form 9-330.)

17. DESCRIBE PROPOSED OR COMPLETED OPERATIONS (Clearly state all pertinent details, and give pertinent dates, including estimated date of starting any proposed work. If well is directionally drilled, give subsurface locations and measured and true vertical depths for all markers and zones pertinent to this work.)*

9-8-82 Set Wireline Bridge Plug at 4700' w/10' of cement on top.

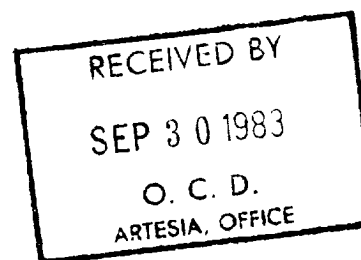

Subsurface Safety Valve: Manu. and Type _____ Set @ _____ Ft.

18. I hereby certify that the foregoing is true and correct

SIGNED P. W. Chester TITLE Prod. Coordinator DATE 9-28-82

ACCEPTED FOR RECORD (This space for Federal or State office use)

APPROVED BY PETER W. CHESTER

CONDITIONS OF APPROVAL, IF ANY:

SEP 29 1983

TITLE _____ DATE _____

NEW MEXICO OIL CONSERVATION COMMISSION
WELL LOCATION AND ACREAGE DEDICATION PLAT

Form C-128
Supersedes C-128
Effective 1-1-65

All distances must be from the outer boundaries of the Section

Operator Stevens Operating Co.		Lease Hanagan Fed.		Well No. 14
Section L	Range 15	Meridian 7 South	County 26 East	Chaves
Distance from the south line 1650		Distance from the west line 660		
Area of the well 3700.8'		Area of the well Undesignated Abo		Dedicated Acreage 160 Acres

- Outline the acreage dedicated to the subject well by colored pencil or hatchure marks on the plat below.
- If more than one lease is dedicated to the well, outline each and identify the ownership thereof (both as to working interest and royalty).
- If more than one lease of different ownership is dedicated to the well, have the interests of all owners been consolidated by communitization, unitization, force-pooling, etc?

☐ Yes ☐ No If answer is "yes" type of consolidation _____

If answer is "no" list the owners and tract descriptions which have actually been consolidated. (Use reverse side of this form if necessary) _____

No allowable will be assigned to the well until all interests have been consolidated (by communitization, unitization, forced-pooling, or otherwise) or until a non-standard unit, eliminating such interests, has been approved by the Commission.

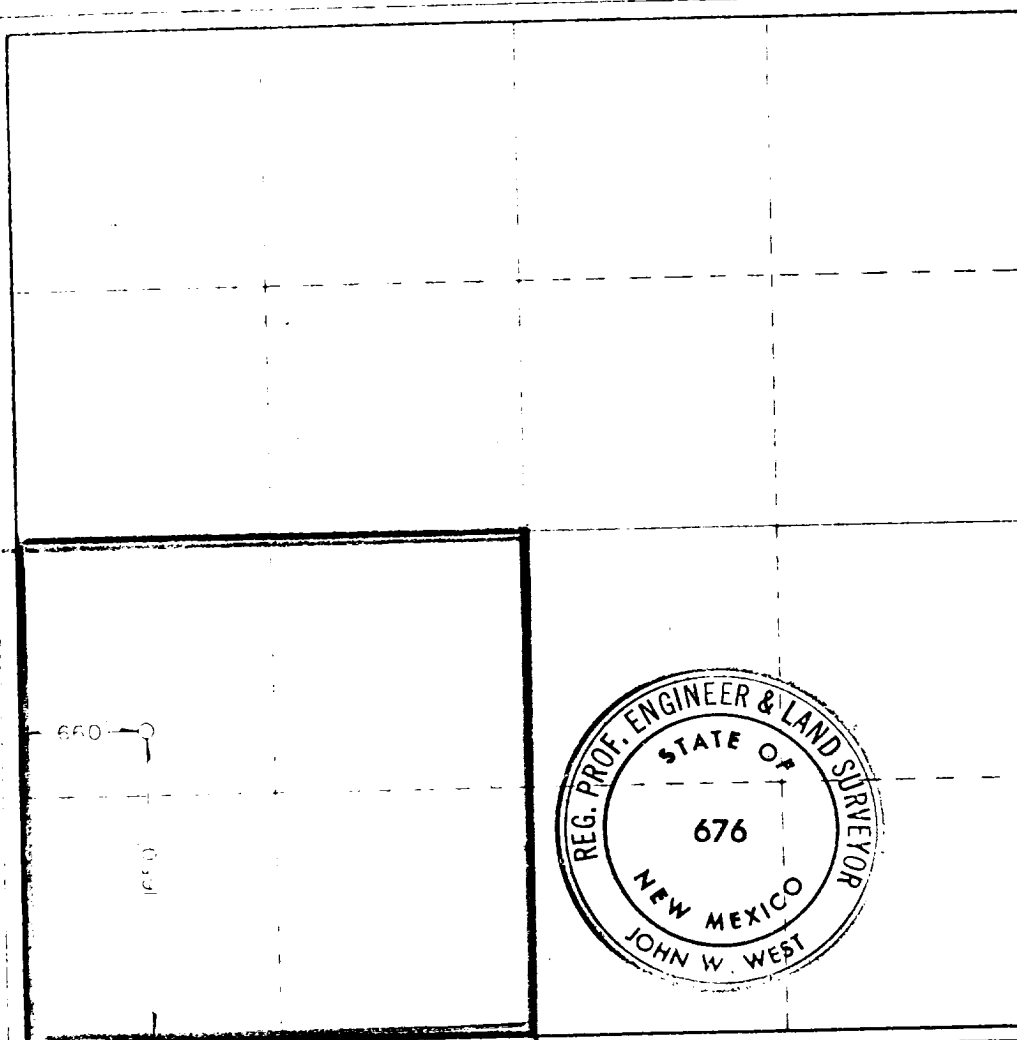

CERTIFICATION

I hereby certify that the information contained herein is true and complete to the best of my knowledge and belief.

Pat Thompson
Name

Pat Thompson

Position

Production Coordinator

Company

Stevens Operating Corporation

Date

9-28-82

I hereby certify that the well location shown on this plat was plotted from field notes of actual surveys made by me or under my supervision, and that the same is true and correct to the best of my knowledge and belief.

RE-DEDICATION - GAS

Date Surveyed

4-13-82

Registered Professional Engineer and/or Land Surveyor

John W. West

Certificate No. **JOHN W. WEST 676**
PATRICK A. ROMERO 6865
Ronald J. Eidson 3239