

UNITED STATES
DEPARTMENT OF THE INTERIOR
GEOLOGICAL SURVEYMAIL CONS. COMMISSION
Drawer DD
Artesia, NM 88210

APPLICATION FOR PERMIT TO DRILL, DEEPEN, OR PLUG BACK

1a. TYPE OF WORK

DRILL ☒DEEPEN ☐PLUG BACK ☐

b. TYPE OF WELL

OIL
WELL ☐GAS
WELL ☒OTHER ☐

MAY 20 1982

SINGLE
ZONE ☒MULTIPLE
ZONE ☐

2. NAME OF OPERATOR

JACK GRYNBERG AND ASSOCIATES

O. C. D.

3. ADDRESS OF OPERATOR

ARTESIA, OFFICE

1050 17th Street, Suite 1950, Denver, CO 80265

4. LOCATION OF WELL (Report location clearly and in accordance with any State requirements.)*

At surface

660' FNL and 1980' FEL of Sec. 13 T6S-R24E

At proposed prod. zone

AS ABOVE

14. DISTANCE IN MILES AND DIRECTION FROM NEAREST TOWN OR POST OFFICE*

25 Miles NNE of Roswell, New Mexico

15. DISTANCE FROM PROPOSED*

LOCATION TO NEAREST
PROPERTY OR LEASE LINE, FT.
(Also to nearest drlg. unit line, if any)

660'

16. NO. OF ACRES IN LEASE

2,360.00

17. NO. OF ACRES ASSIGNED
TO THIS WELL

160

18. DISTANCE FROM PROPOSED LOCATION*

TO NEAREST WELL, DRILLING, COMPLETED,
OR APPLIED FOR, ON THIS LEASE, FT.

Approx. 2640'

19. PROPOSED DEPTH

4,200'

20. ROTARY OR CABLE TOOLS

Rotary

21. ELEVATIONS (Show whether DF, RT, GR, etc.)

22. APPROX. DATE WORK WILL START*

May 15, 1982

23.

PROPOSED CASING AND CEMENTING PROGRAM

SIZE OF HOLE	SIZE OF CASING	WEIGHT PER FOOT	SETTING DEPTH	QUANTITY OF CEMENT
13-1/2"	10 3/4"	32.75	900'	good returns to surface, circulate
7- 7/8"	4 1/2"	10.50	4,200'	500' above top of pay

1. Spud well, drill 13-1/2" hole to 900'; run 10 3/4" surface casing
2. Drill 7 7/8" hole to 4,200', checking BOP daily
3. Run tests and logs as needed
4. Run 4 1/2" production casing to 4,200' if warranted
5. Perforate and stimulate as needed

In the event that circulation is lost while drilling 7 7/8" hole and intermediate casing is needed, the hole will be reamed and 1,500' of 7 7/8" intermediate casing will be set.

BOP Diagram Attached - Exhibit "A"

Gas is not dedicated

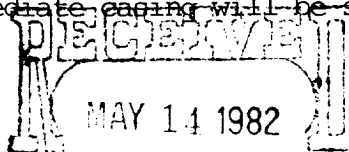
OIL & GAS
U.S. GEOLOGICAL SURVEY
ROSWELL, NEW MEXICO

IN ABOVE SPACE DESCRIBE PROPOSED PROGRAM: If proposal is to deepen or plug back, give data on present productive zone and proposed new productive zone. If proposal is to drill or deepen directionally, give pertinent data on subsurface locations and measured and true vertical depths. Give blowout preventer program, if any.

24.

SIGNED

TITLE

Land Manager

DATE

5/12/82

(This space for Federal or State office use)

(Orig. Sgd.) GEORGE T. D.

PERMIT NO.

APPROVAL DATE

APPROVED BY

TITLE

DATE

CONDITIONS OF APPROVAL ANY:

JAMES A. GILLIAM
DISTRICT SUPERVISOR

*See Instructions On Reverse Side

All distances must be from the outer boundaries of the Section.

Operator Jack Grynberg & Associates			Lease Hobbs Canyon Federal		Well No. 6
Unit Letter B	Section 13	Township 6-S	Range 24-E	County Chaves	
Actual Footage Location of Well: 660 feet from the NORTH line and 1980 feet from the EAST line					
Ground Level Elev. 3982'	Producing Formation ABO		Pool Pecos Slope ABO Gas		Dedicated Acreage: 160 Acres

1. Outline the acreage dedicated to the subject well by colored pencil or hatchure marks on the plat below.
2. If more than one lease is dedicated to the well, outline each and identify the ownership thereof (both as to working interest and royalty).
3. If more than one lease of different ownership is dedicated to the well, have the interests of all owners been consolidated by communitization, unitization, force-pooling, etc?

☐ Yes ☐ No If answer is "yes," type of consolidation _____

If answer is "no," list the owners and tract descriptions which have actually been consolidated. (Use reverse side of this form if necessary.) _____

No allowable will be assigned to the well until all interests have been consolidated (by communitization, unitization, forced-pooling, or otherwise) or until a non-standard unit, eliminating such interests, has been approved by the Division.

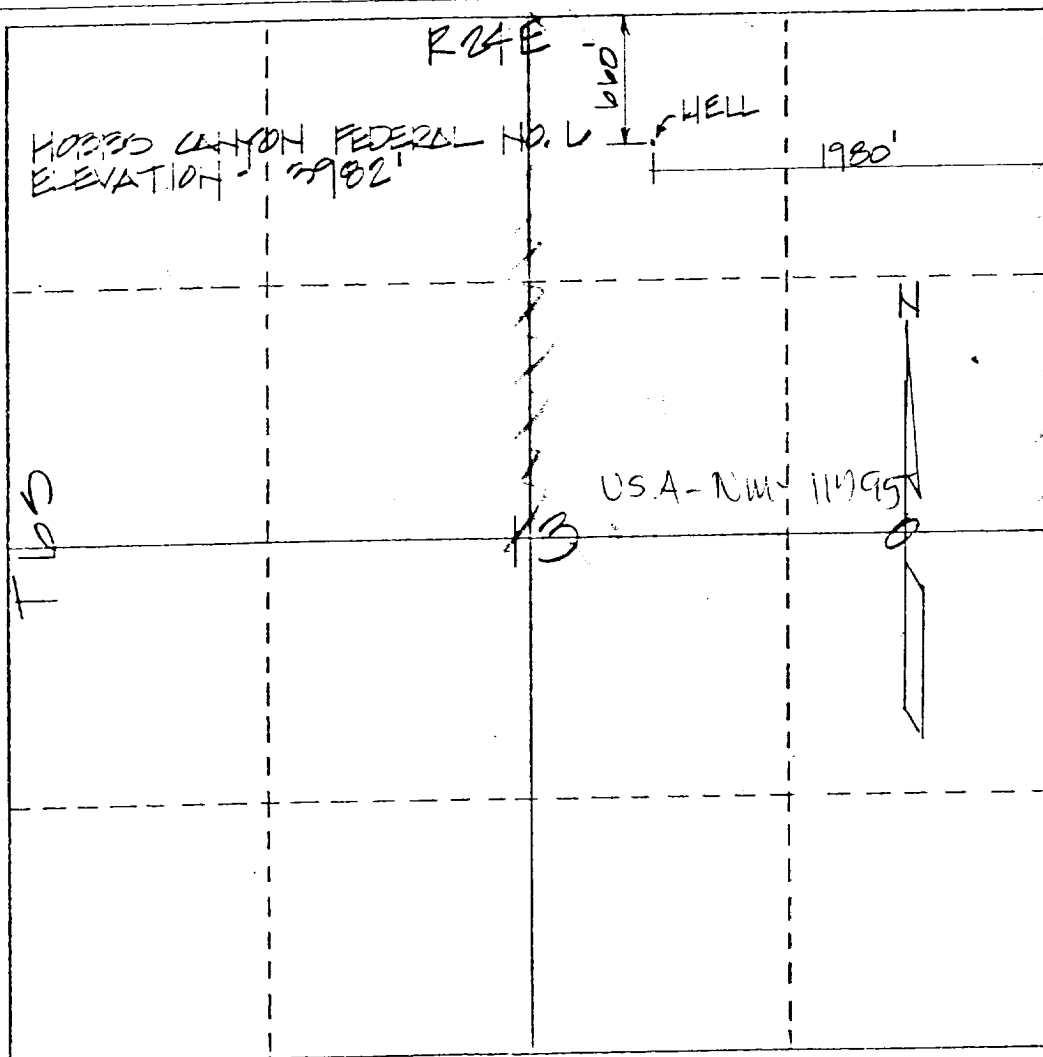

CERTIFICATION

I hereby certify that the information contained herein is true and complete to the best of my knowledge and belief.

Name

Agent
Position

Jack Grynberg & Associates
Company

Date

DAVID C. CLAUSEN
REGISTERED PROFESSIONAL ENGINEER
AND/OR LAND SURVEYOR
NEW MEXICO
6547
I hereby certify that the well location shown on this plat was plotted from field notes of actual surveys made by me or under my supervision, and that the same are true and correct to the best of my knowledge and belief.

13 May 1982

Date Surveyed

Registered Professional Engineer
and/or Land Surveyor
David C. Clausen, P.L.S.

N.M. License No. 6547

Certificate No.

TEN POINT COMPLIANCE PROGRAM
Attachment to Form 9-133C, Application for Permit to Drill

Jack Grynberg and Associates
Hobbs Canyon Federal # 6
560' FNL; 1980" FEL
Section 13, T 6 S - R 24 E
Chaves County, New Mexico

1. Geologic Surface Formation
Sandy Residium

2. Estimated Tops of Important Geologic Marker

San Andres	550'
Glorieta	1400'
ABO	3600'
TD	4200'

3. Estimated Depths of Anticipated Water, Oil, Gas or Other Minerals
Gas 3600' - 4200'

4. Proposed Casing Program

Hole Size	Casing Size	Interval	Grade	Wt./Ft.	New or Used
13-1/2"	10-3/4"	0-900	H-40	32.75	New
7-7/8"	4-1/2"	0-4200	J-55	10.75	New
9-1/4" (contingency)	7-7/8"	0-1500	K-55	26.40	New

5. Operator's Minimum Specifications for Pressure Control
Exhibit "A" is a schematic diagram of the blowout preventor equipment. The BOP will be hydraulically tested to the full working pressure after nipping up and after any use under pressure. Pipe rams will be operationally checked each 24 hour period, as will blind rams each time pipe is pulled out of the hole.

6. Type and Characteristic of Proposed Circulating Mediums
Adequate stocks of sorptive agents will be on site to handle possible spills of fuel and oil on the surface. Heavier muds will be on location to be added if pressure requires.

Interval	Type	Weight #/Gal.	Visc.-Sec./Qt.	Fluid Loss-CC
0-900	Native Mud	-	-	-
900-3200	Native Mud	10.2	32-40	20-30 CC Wtr.
3200-TD	Brine Base	-	-	-

7. Auxiliary Equipment
Kelly cock, a float will be used at the bit, pit level indicators and flow sensor equipment, sub with full-opening valve on floor, drill pipe connection.
8. Testing, Logging and Coring Program
 - A. DST's as warranted.
 - B. The logging program will consist of a CNL-FDC and Dual Lateral Log-MSFL.
 - C. No coring is anticipated.
 - D. Stimulation procedures will be determined after evaluation of logs.
If treatment is indicated, appropriate Sundry Notice will be submitted.
9. Anticipated Abnormal Pressures or Temperatures
No abnormal pressures or temperatures are anticipated.
10. The well will be spudded around **May 15, 1982** or as soon as permit and surface use program are approved by M.M.S. and B.L.M.

EXHIBIT "A"

Jack Grynberg and Associates
#6 Hobbs Canyon Federal

BOP Stack

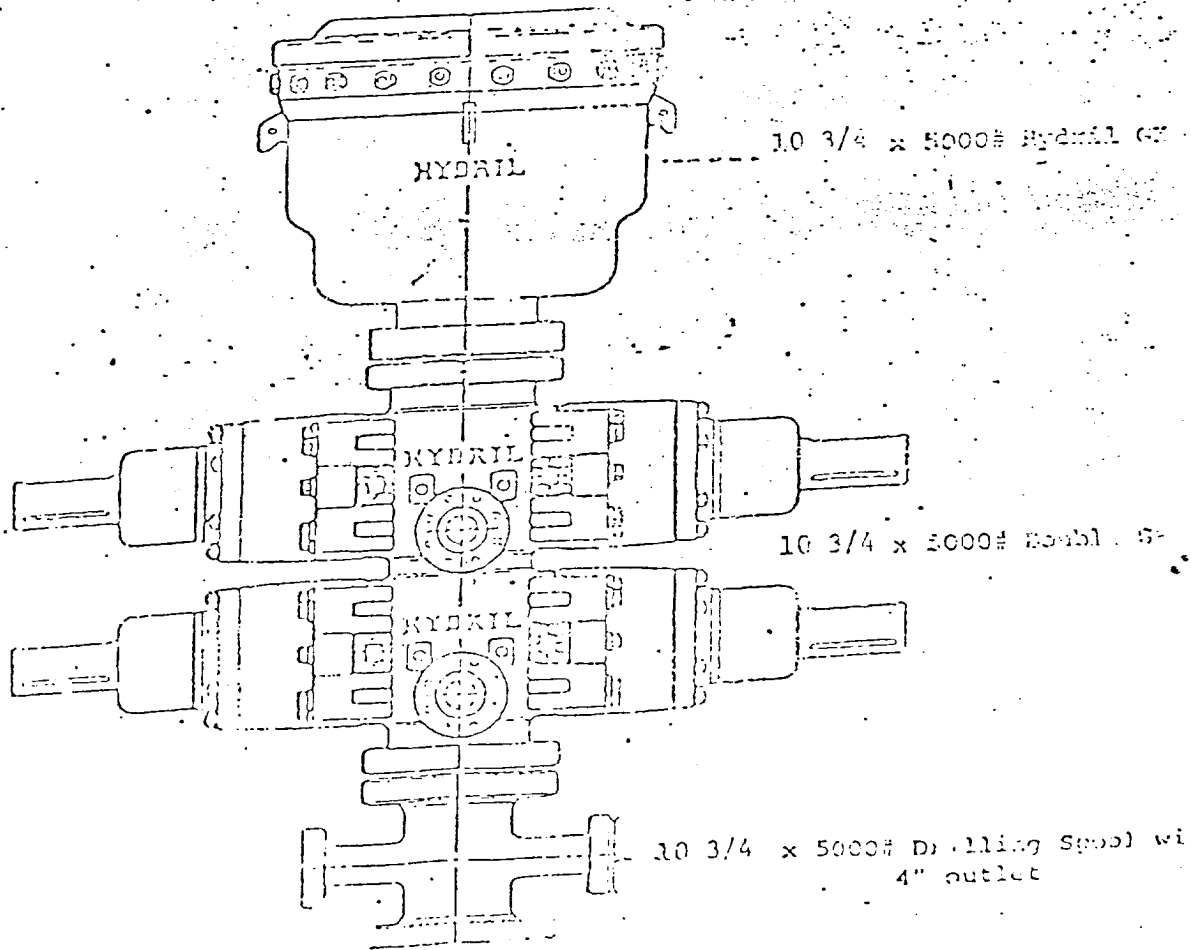

All items NPS trimmed

Scale: 1" = 5000'

CONTOUR INTERVAL = 10 FEET

LEGEND

EXHIBIT 'D'

WELL LOCATION

WELL DRILLED, CASING SET

LOCATION

DRY & ABANDONED

PRODUCING GAS WELL

USPENDED OPERATIONS

C.C.G. WI

100 %

50%

37.5%

25%

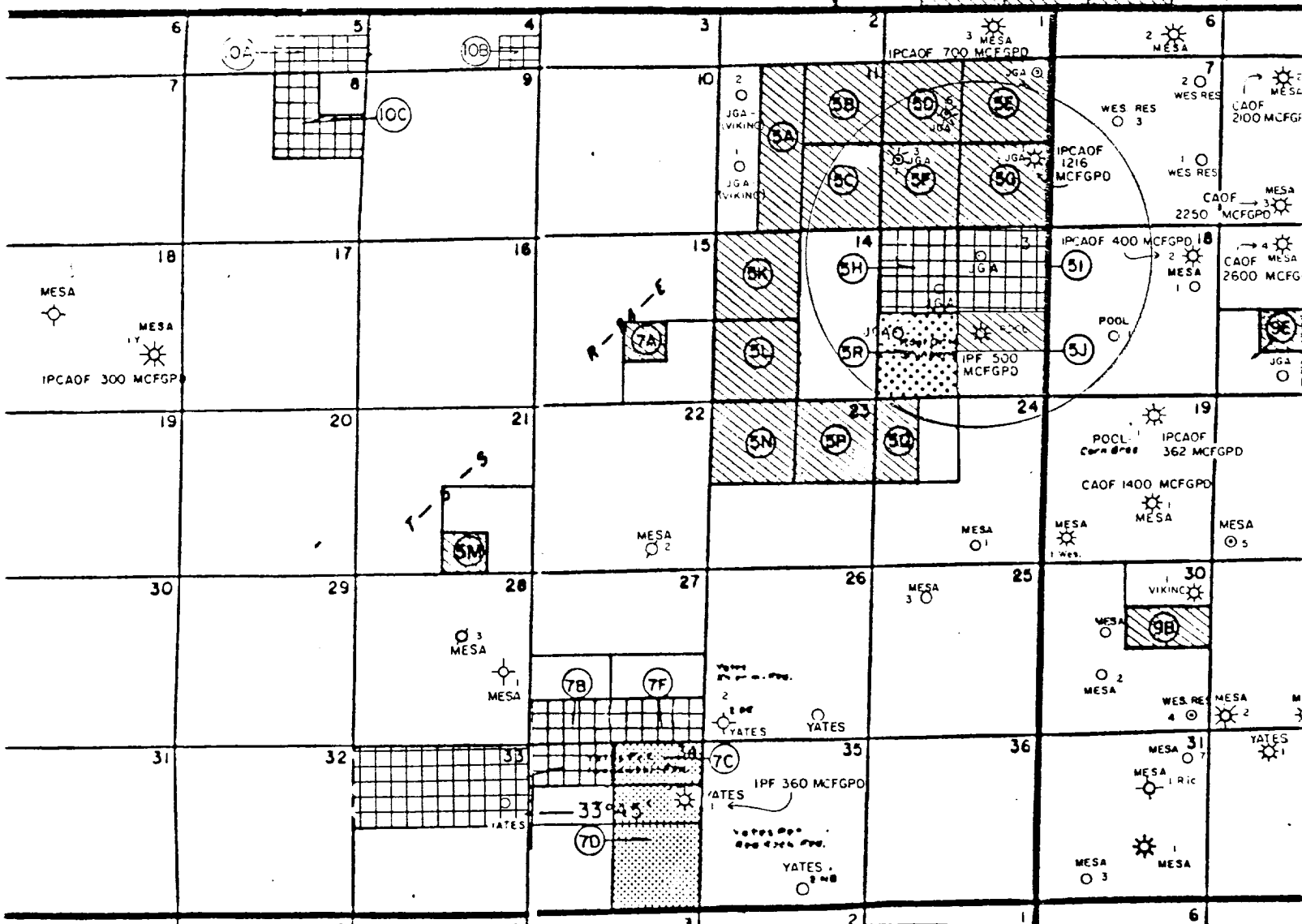

EXHIBIT "E"

JACK GRYBERG & ASSOCIATES
6 Hobbs Canyon Federal

